

### FRYERS

**Frymaster**  
A WELBILT Company

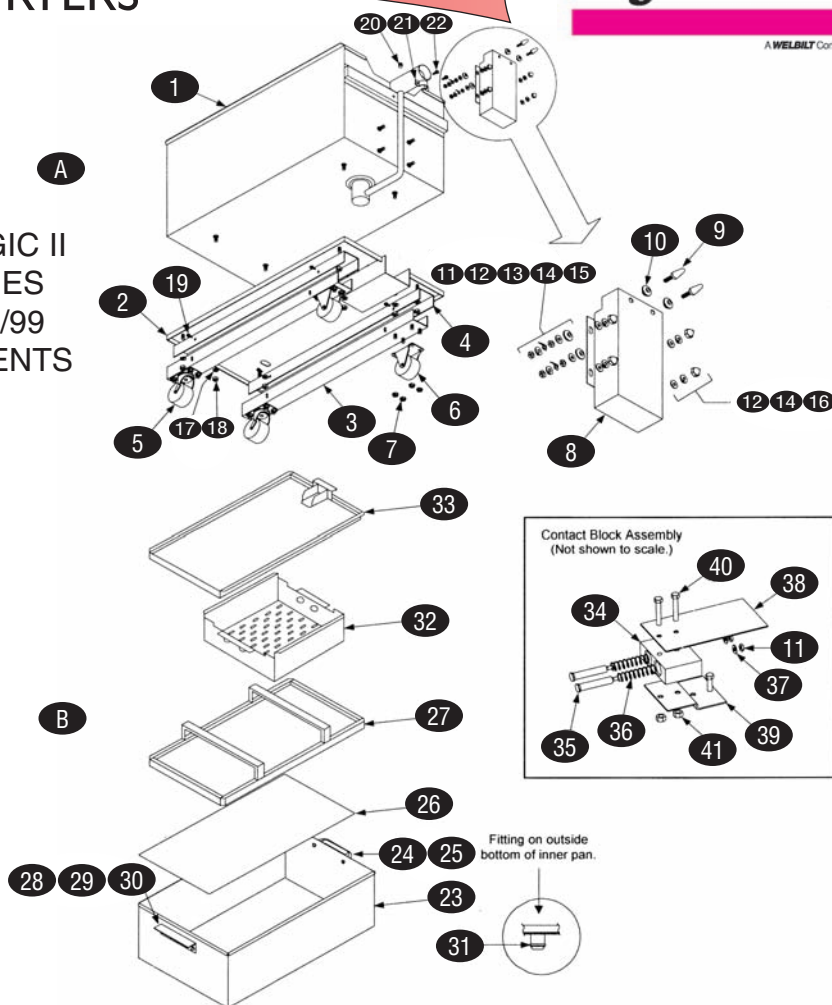

**FILTER MAGIC II ASSEMBLIES BEFORE 2/99 & COMPONENTS**



KEY	PART #	DESCRIPTION	KEY	PART #	DESCRIPTION
A	FM806-7411SP	Outer Pan Assembly FMII (incl items 1-22 below)	n/s	FM811-0746	Tape, Aluminum, 50yds
1	FM823-1360SP	Outer Pan	n/s	FM810-0441	Clamp, Heater, Aluminum
2	FM823-2332	Base, Filter Pan	21	FM910-1350	Clamp, Suction Tube
3	FM806-9471	Channel, Caster Mounting	22	FM826-1371	Screw, Hex Head Drill Point, #8x1/2", pkg of 25
4	FM900-2805	Channel, Caster Lift Base	B	FM806-5282SP	Inner Pan Assembly (incl items 23-31 below)
5	FM810-2805	Caster, Swivel	23	FM823-1731SP	Inner Pan
6	FM810-2807	Caster, Rigid	24	FM810-0180	Handle, Filter Pan
7	FM826-1376	Nut, #10-32, pkg of 10	25	FM809-0024	Screw, Slotted Round Head, #10-24x5/16"
8	FM824-0291	Cover, Suction Tube	26	FM900-8827	Filter Screen, SanaGrid
9	FM810-0695	Contact Pin	27	FM810-1406	Ring, Hold Down
10	FM807-1270	Washer, Insulated Shoulder	28	FM910-1366	Handle, Filter Pan
11	FM809-0053	Nut, Hex, #10-32	29	FM809-0117	Screw, Slotted Truss Head, #10-32x5/16"
12	FM809-0184	Washer, Locking, #10	30	FM809-0045	Nut, Hex Cap, #10-32
13	FM826-1337	Tab, Terminal, pkg of 5	31	FM816-0117	O-Ring, Inner Pan
14	FM809-0185	Washer, Flat, #10	32	FM824-0416	Crumb Screen, 13"x11-1/2"
15	FM807-1367	Washer, Flat, Non-Conductive	33	FM823-1390	Cover, Filter Pan
16	FM809-0020	Nut, Cap, #10-24	C	FM806-4694SP	Contact Block Assembly (incl items 11 & 34-41)
17	FM809-0189	Washer, Flat, 1/4"	34	FM810-0694	Block, Contact
18	FM826-1362	Nut, Hex, 1/4"-20, pkg of 10	35	FM810-0693	Pin, Contact
19	FM826-1374	Screw, Hex Head, #10x1/2", pkg of 25	36	FM810-0696	Spring, Contact Pin
20	FM813-0411	Plug, Hex Head Pipe, 1/8"	37	FM809-0185	Washer, Flat, #10
n/s	FM806-4373	Heater Pan-Line, 24V, 25W, 18"	40	FM809-0291	Screw, 1/4"-20x1-1/2"
n/s	FM811-0681	Foam Insulation, Heater Strip	41	FM826-1372	Nut, Hex Grip, 1/4"-20