

# warming

## MIRACLE STEAMER 255

# HAGAR

### STEAMERS

**roundup**  
FOOD EQUIPMENT DIVISION

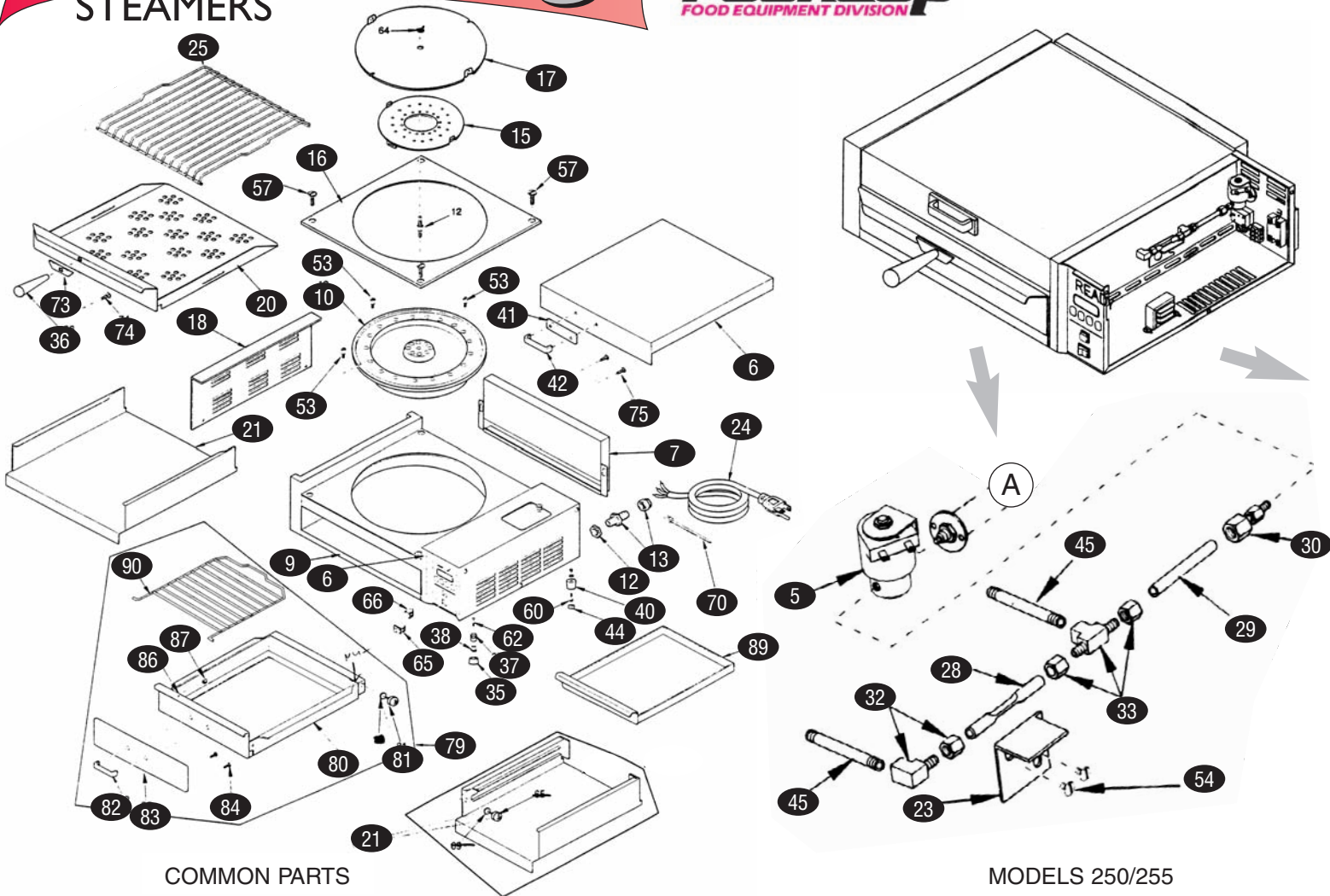

COMMON PARTS

MODELS 250/255

| KEY | PART #    | DESCRIPTION                          | KEY | PART #    | DESCRIPTION                            |
|-----|-----------|--------------------------------------|-----|-----------|--|
| 1   | RU0010759 | Filter Assembly, Water Tank (MS-150) | 24  | RU0700452 | Power Cord, NEMA 6-20P                 |
| 2   | RU0010583 | Relay Heat Sink                      | 25  | RU0800359 | Trivet, Spatula (MS-150/250 only)      |
| 3   | RU0010584 | Inlet Hose Assembly (MS-250)         | n/s | RU1000967 | Label, Marking                         |
| 4   | RU0011114 | Pump/Tube Assembly, 24v (MS-150)     | 27  | RU1001036 | Label, Control Panel                   |
| 5   | RU0011123 | Solenoid Valve Assembly (MS-250)     | 28  | RU2000203 | Tube, Restrictor, 1/4"                 |
| 6   | RU0011289 | Top Cover Assembly                   | 29  | RU2000207 | Tube, Inlet, 1/4"x2-1/2"L (MS250)      |
| 7   | RU0011314 | Chimney Assembly                     | 30  | RU2040103 | Connector, Male, 1/4"x1/8" NPT (MS250) |
| 9   | RU0021179 | Access Cover Weldment (MS-150)       | 31  | RU2040106 | Adapter Tube Hose (MS-150)             |
| 10  | RU7000245 | Generator, 208V-3300W                | 32  | RU2040145 | Elbow, Female 1/8"x1/4"                |
|     | RU7000246 | Generator, 230V-3300W                | 33  | RU2040146 | Tee, Female 1/8"x1/4"                  |
|     | RU7000300 | Generator, 120V-3300W                | 34  | RU2090101 | Filter, Water Line (NLA)               |
| n/s | RU0300129 | Stud, Cover, Hold Down               | 35  | RU210K108 | Rubber Foot, 4 pk                      |
| 12  | RU0400138 | Nut, Lock, 1/2"                      | 36  | RU2100119 | Handle, Spatula (MS-150/250 only)      |
| 13  | RU0400251 | Strain Relief                        | 37  | RU2100158 | Leg Cup                                |
| 14  | RU0502199 | Spacer                               | 38  | RU2100159 | Adjuster, Leg                          |
| 15  | RU0503431 | Diffuser, Steam                      | 39  | RU2100170 | Knob, Chrome (MS-150)                  |
| 16  | RU0503432 | Bracket, Filler                      | 40  | RU2100230 | Bumper, Recess Leg, 1"                 |
| 17  | RU0503433 | Cover, Generator                     | 41  | RU2100258 | Handle, Guard                          |
| 18  | RU0503434 | Cover, End Housing                   | 42  | RU2100257 | Grip, Guard Handle                     |
| 19  | RU0503435 | Retainer, Thermocouple               | 43  | RU2110101 | Clamp, Hose, 3/8" (MS-150)             |
| 20  | RU0503438 | Spatula (MS-150/250 only)            | 44  | RU2110103 | Clamp, Hose, 1/2" (MS-150)             |
| 21  | RU0503440 | Liner, Cavity (MS-150/250 only)      | 45  | RU2180145 | Bumper Cover, Leg                      |
| 22  | RU0503441 | Access Cover (MS-250)                | 46  | RU7000449 | Generator Tube, Teflon, 4-1/2" large   |
| 23  | RU0503472 | Bracket, Hi-Limit Support            | 47  | RU2190105 | Generator Tube                         |

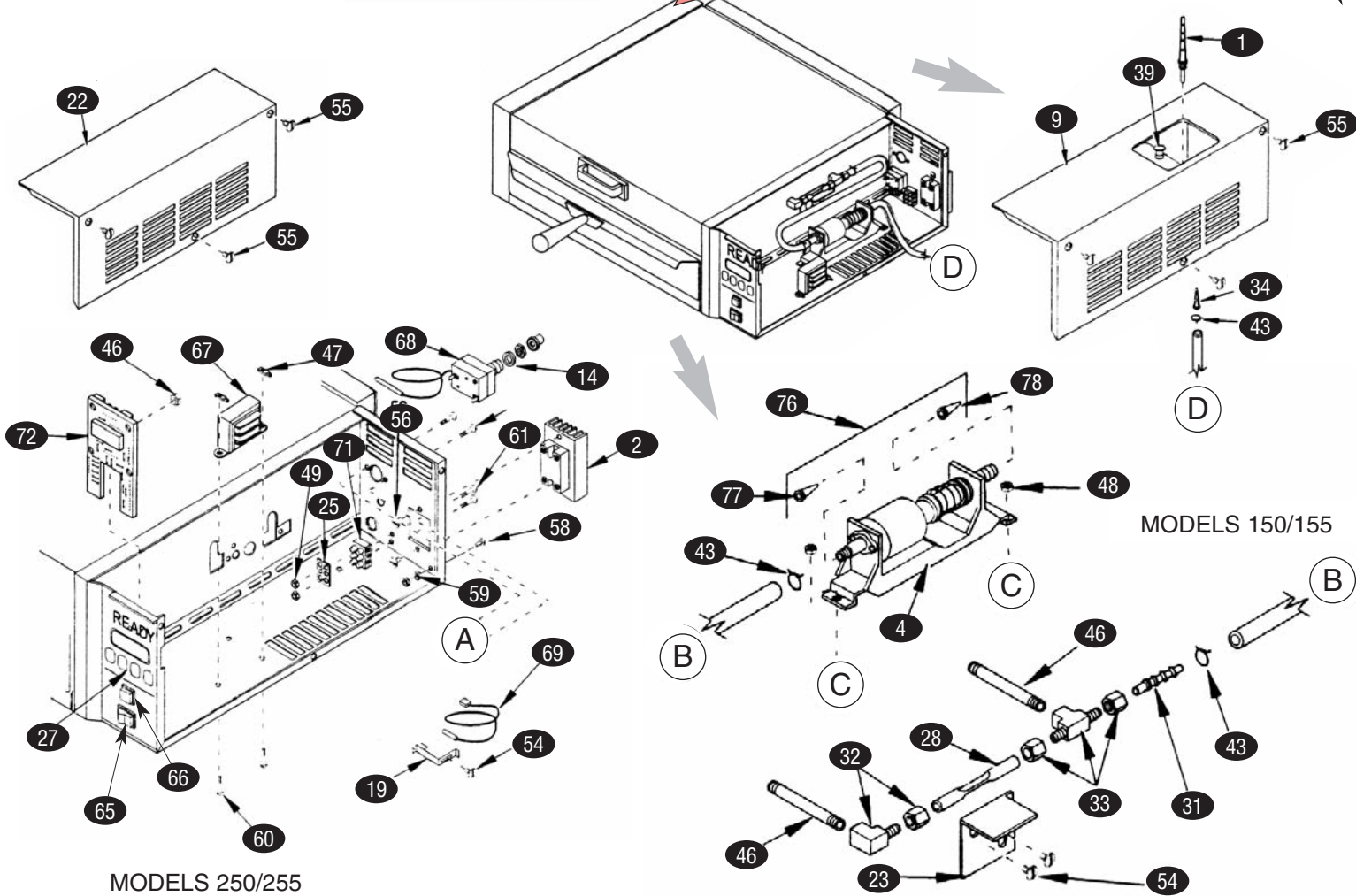

MODELS 250/255

MODELS 150/155

| KEY | PART #     | DESCRIPTION                                    | KEY | PART #     | DESCRIPTION  |
|-----|------------|--|-----|------------|--|
| 48  | RU300P102* | Nut, Speed, "U", #8-32                         | 76  | RU7000170  | Water Pump Valve Kit (incl. 77 & 78 below)         |
| 49  | RU304P105* | Nut, Hex, KEPS, #4-40, Zinc                    | 77  | RU4040108  | Valve, Discharge Side, White                       |
| 53  | RU306P130* | Nut, Hex, KEPS, #6-32                          | 78  | RU4040148  | Valve, Intake Side, Clear                          |
| 54  | RU306P134* | Screw, Machine, #6-32x3/8"                     | 79  | RU7000239  | Drawer Assembly (MS-155/255 only)                  |
| 55  | RU308P103* | Screw, Machine, #8-32x1/4" (MS-150)            | 80  | RU0011471  | Drawer Weldment (MS-155/255 only)                  |
| 56  | RU308P103* | Screw, Machine, #8-32x1/4" (MS-150)            | 81  | RU210K195  | Bearing, Nylon Roller (MS-155/255 only)            |
| 58  | RU308P120* | Screw, Machine, #8-32x5/8"                     | 82  | RU2100257  | Handle (MS-155/255 only)                           |
| 59  | RU308P124* | Screw, Machine, #8-32x1/2", 1-way              | 83  | RU2100264  | Guard, Handle (MS-155/255 only)                    |
| 60  | RU308P143* | Nut, Hex, KEPS, #32-1/2"                       | 84  | RU325P132* | Screw, Machine, 1/4-20x1/2", 2pk (MS-155/255 only) |
| 61  | RU310P136* | Screw, Machine, #10-32x1-1/4"                  | n/s | RU05P2291  | Spacer (MS-155/255 only)                           |
| 62  | RU310P149* | Screw, Machine, #10-32x7/8" (MS-250)           | 86  | RU306P107* | Stud, PEM, #6-32x3/8" (MS-155/255 only)            |
| 65  | RU7000542  | Rocker Switch, Power On/Off, 25A-250V          | 87  | RU306P137* | Nut, Acorn, #6-32 (MS-155/255 only)                |
| 66  | RU4010166  | Switch, Momentary                              | n/s | RU0021237  | Liner Weldment (MS-155/255 only)                   |
| 67  | RU7000319  | Transformer, 115-230/24V                       | 89  | RU0503536  | Drip Pan (MS-155/255 only)                         |
| 68  | RU7000135  | Thermostat, Hi-Limit                           | n/s | RU7000333  | Strainer Kit, In Line                              |
| 69  | RU4050209  | Thermocouple, Type-K                           | n/s | RU7000314  | Pressure Regulator Kit                             |
| 70  | RU4060107  | Cable Tie                                      | n/s | RU7000306  | Water Pressure Gauge Kit                           |
| 71  | RU4060304  | Terminal Block, 3-Pole                         | n/s | RU2080117  | Quick Disconnect, Female                           |
| 72  | RU7000317  | Control Board, Temperature/Timer, 24V, 50/60Hz | n/s | RU7000139  | Quick Disconnect w/Check Valve, Male               |
| 73  | RU2100240  | Guard, Handle (MS-150/250 only)                | n/s | RU0010584  | Inlet Hose w/Strainer & Male QD (no Regulator)     |
| 74  | RU338P102* | Bolt, Handle Mounting (MS-150/250 only)        |     |            |  |
| 75  | RU325P109* | Bolt, 1/4"-20x1/2"                             |     |            |  |

\*only available in 10 pk quantities