

warming

STEAMERS

DFWT-200

HAGAR

roundup
FOOD EQUIPMENT DIVISION

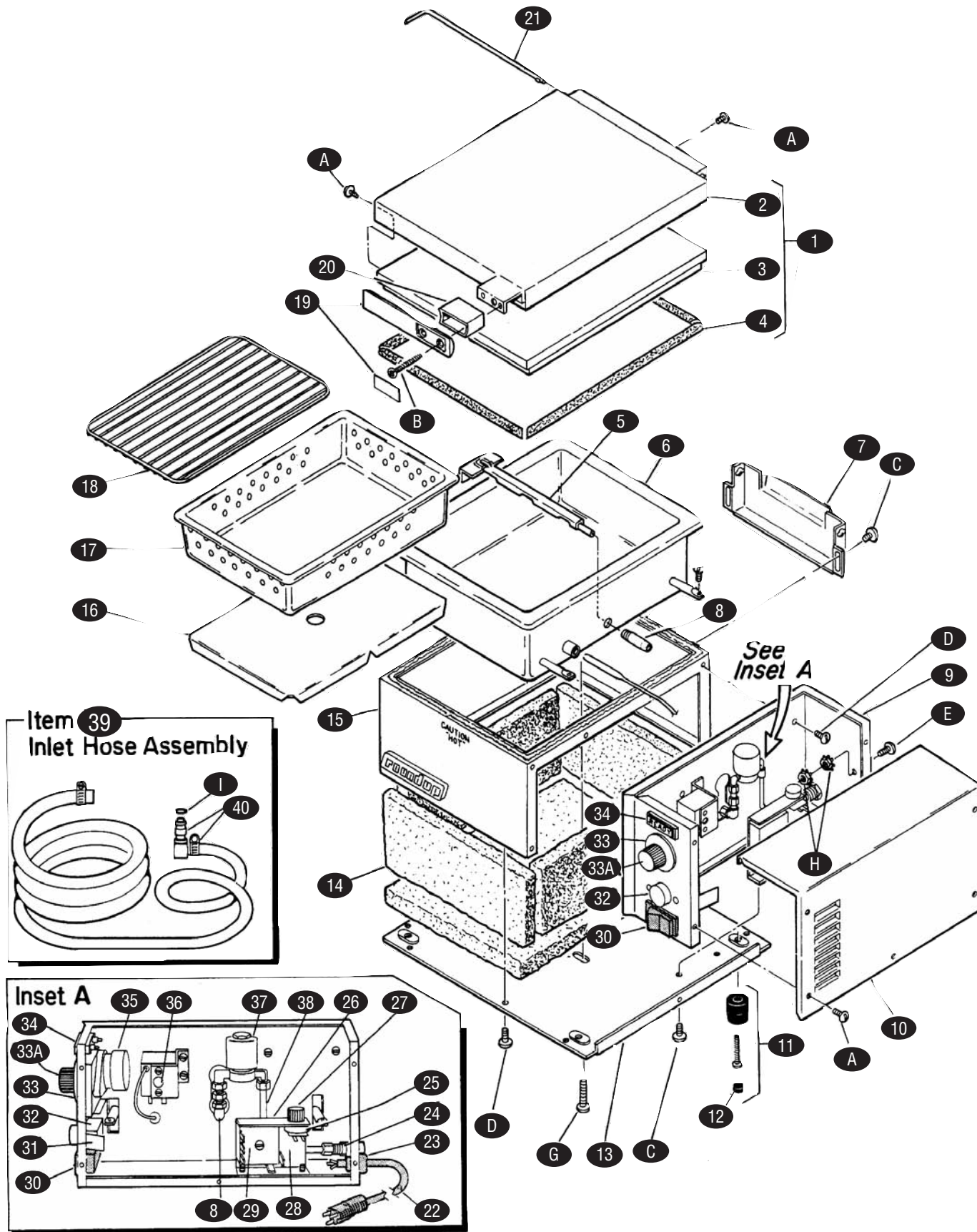



KEY	PART #	DESCRIPTION	KEY	PART #	DESCRIPTION
1	RU0011154	Top Cover Assembly	36	RU403K157	Thermostat Kit
2	RU0020577	Top Cover Shell	37	RU0020699	Solenoid Kit, 120 VAC (incl. 90° Elbows)
3	NLA	Top Cover Liner (incl. #1)	38	RU200K133	Inlet Tube Kit
4	RU020K105	Gasket, Top Cover	39	RU0010584	Inlet Hose Assembly
5	RU0010146	Spray Tube Assembly	40	RU7000139	Quick Disconnect Kit
6	RU7000126	Steam Generator, 120 VAC			
7	RU0501569	Top Cover Hinge			Note: Following items available in pkgs. of 10
8	RU200K132	Steam Generator Tube (incl. Tube, 90° Elbow & connector Fittings)	A	RU308P103	Screw, #8-32x1/4", Stainless Steel
9	NLA	Electrical Housing (Timer models)	B	RU308P132	Screw, #8-32x3/4" Flat, Stainless Steel
	NLA	Electrical Housing (Non-Timer models)	C	RU308P104	Screw, #8-32x3/8", Stainless Steel
10	RU0501541	Access Cover Assembly	D	RU308P116	Screw, #8-32x1/4", Zinc
11	RU7000130	Leg Kit	E	RU308P105	Screw, #8-32x1/2", Stainless Steel
12	RU2180145	Cover	G	RU325P106	Screw, 1/4"-20x2", Zinc
13	NLA	Base Plate	H	RU306P143	Hex Nut, #8-32 "KEPS"
14	RU7000132	Insulation Kit	I	RU020P117	O-Ring
15	NLA	Main Housing			
16	RU0500323	Diffuser Pan			
17	RU2130103	Perforated Pan			
18	RU0800109	Trivet			
19	RU7000133	Handle Kit			
20	RU0020964	Handle Bracket Cover			
21	RU0800219	Top Cover Hinge Pan			
22	RU0700300	Power Cord, 120 VAC			
	RU0700375	Power Cord, 240 VAC			
23	RU040P121	Strain Relief, pkg. of 10			
24	RU208K106	Quick Disconnect Body			
25	RU0020194	Time Shot Control, TS Model (incl. items #26 & 27)			
	RU0020526	Time Shot Control, all other models (incl. items #26 & 27)			
26	NLA	Label (k0.5 seconds)			
27	RU2100115	Knob			
28	NLA	Time Shot Control Bracket			
29	NLA	Solid State Timer, Cube, 220-240 VAC, 50 Hz			
30	RU4010104	Power Switch, 120 VAC			
	RU4010105	Power Switch, 220-240 VAC			
31	NLA	Insulator (215/260)			
32	RU4010106	Operate Switch			
33	NLA	Timer Dial, 15 Min., (incl. item #33A)			
	NLA	Timer Dial, 60 Min., (incl. item #33A)			
33A	NLA	Timer Dial Center Button			
34	RU4060102	"READY" Light, 120 VAC			
	RU4060123	"READY" Light, 220-240 VAC, 50 Hz			
35	NLA	Main Timer, 15 Min., 120 VAC			
	NLA	Main Timer, 60 Min., 120 VAC			
	RU402K108	Main Timer, 60 Min., 230 VAC, 50 Hz			