



30 Pine Street • New Rochelle • New York • 10801

914 / 576 - 0200

914 / 576 - 0605 fax

1 - 800 - 431 - 2745 US & Canada

www.bakerspride.com web address

# BCO-G & GDCO-G

## Full Size Gas Convection Oven

### PARTS LIST

# Cyclone

SERIES



Model Number: **BCO-G & GDCO-G**

Type of Gas: Natural

L.P.

Other

Serial Number: \_\_\_\_\_

Voltage/Phase: 115/1

208-240/1

230/1 (CE)

(Not Shown)

Exterior / Interior / Controls / Doors

Part #	Description
E8752A	KIT, 25" LEGS BLACK W/3" ADJ FEET
E8753A	KIT, 25" LEGS BLACK W/PLATE CASTER
E8754A	KIT, 25" LEGS S/S W/3" ADJ FEET
E8755A	KIT, 25" LEGS S/S W/PLATE CASTERS
E5756A	KIT, STACKING W/6" ADJ LEGS
E8759A	KIT, STACKING W/PLATE CASTER
T8097A	KIT, UNDERSHELF
T8026A	KIT, OPEN RACK STAND
E8765A	KIT, CONVERSION TO LP
E8766A	KIT, CONVERSION TO NAT

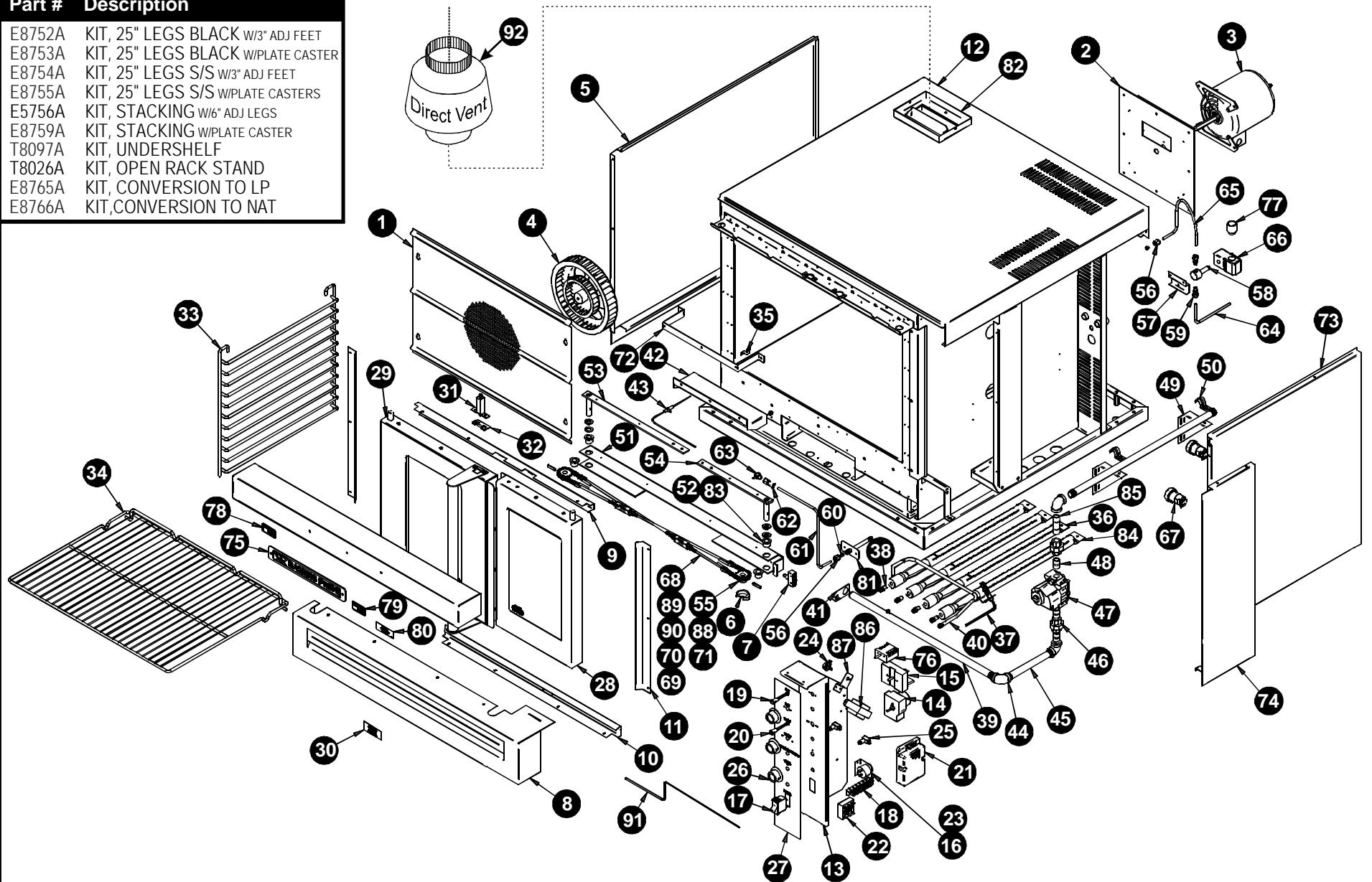

Item	Part #	Description	Quan	Item	Part #	Description	Quan
1	E8189A	BAFFLE PLATE	1	47	R3164A	VALVE, COMBINATION (NAT.)	1
2	E8138A	MOTOR MOUNT	1		R3165A	VALVE, COMBINATION (L.P.)	1
3	M9208A	MOTOR 115V 850/1725 RPM	1	48	N5019A	NIPPLE, 1/2" X 1-1/8" STEEL PIPE	3
4	S1195A	BLOWER WHEEL	1	49	E8188A	BRACKET, SUPPORT	1
5	E8160A	PANEL, LEFT OUTER	1	50	P9900A	CLIP JIFFY 1/2"	2
6	S6810A	CAM, SWITCH	1	51	E8144A	BOTTOM CHANNEL	6
7	M1102A	SWITCH, DOOR	1	52	S0420A	THRUST BEARING	4
8	E8170A	BOTTOM TRIM	1	53	S6819A	ARM, 60 WELDMENT	1
9	E8178A	SEAL, TOP	1	54	S6821A	ARM, 40 WELDMENT	1
10	E8177A	SEAL, BOTTOM DOOR	1	55	S6805A	SPROCKET, DOOR	2
11	E8176A	SEAL (BETWEEN LEFT & RIGHT DOOR)	2	56	N7103A	FITTING, NUT S/S COMP 1/4 TUBE (STEAM OPTION ONLY)	2
12	E8156A	PANEL, TOP OUTER	1	57	E8778A	BRACKET, MOUNTING (STEAM OPTION ONLY)	1
13	E8193A	CONTROL PANEL ASSY.	1	58	M1114A	SOLENOID VALVE, 1/8 X 1/8 (STEAM OPTION ONLY)	1
14	M1332A	TIMER, 60 MINUTE	1	59	N3041A	FITTING 1/4 COMP X 1/8 MPT (STEAM OPTION ONLY)	2
15	M0110A	THERMOSTAT, FASTRON G6	1	60	N5815A	FITTING, 1/4" Tube Sleeve S/S FERRULE (STEAM OPTION ONLY)	2
16	E6895A	BRACKET, BUZZER	1	61	N8788A	STEAM TUBE (STEAM OPTION ONLY)	1
17	M1352A	SWITCH, ROCKER	1	62	N3041A	FITTING, FEM SS COMP 1/4 TUBE TO 1/8 PIPE (STEAM OPTION ONLY)	1
18	P7200A	TERMINAL BLOCK	1	63	N1019A	STEAM INJECTION NOZZLE (STEAM OPTION ONLY)	1
19	P9600A	PILOT LIGHT GREEN (POWER)	1	64	N8789A	TUBE, SUPPLY (STEAM OPTION ONLY)	1
20	P1167A	LIGHT, INDICATOR 250V, AMBER	1	65	N8791A	TUBE, VALVE TO OVEN (STEAM OPTION ONLY)	1
21	M2138A	IGNITION MODULE	1	66	M1115A	SOLENOID COIL 120/240 V, 17/12 W, 50/60Hz (STEAM OPTION ONLY)	1
22	M1175A	TIMER, SOLID STATE, 120 VAC, .5-60 SEC (STEAM OPTION ONLY)	1	67	P1144A	SNAP IN LIGHT ASSY 130V/15W	2
23	M1335A	AUDIO ALARM	1	68	S6816A	EYE HOOK, SHORT	2
24	M1176A	POTENTIOMETER (STEAM OPTION ONLY)	1	69	S6814A	EYE HOOK, LONG	2
25	M1049A	SWITCH, PUSH BUTTON (2 EA - STEAM OPTION ONLY)	1	70	S0410A	TURNBUCKLE, 1/4-20	2
26	S1311A	KNOB	3	71	Q4033A	ROLL PIN .250 X 1.250	2
27	U8054A	DECAL BASIC BLUE & GOLD	1	72	E8125A	BRACKET WELDMENT	1
28	E6825A	DOOR, 40 W/WINDOW ASSY	1	73	E8159A	PANEL, RIGHT OUTER	1
29	E6827A	DOOR, 60 W/WINDOW ASSY	1	74	S8159A	PANEL, INSERT CONTROL	1
30	U4198A	DECAL, LEG	1	75	U1043A	NAME PLATE	1
31	S8768A	CATCH, ROLLER ADJUSTABLE	1	76	M1326A	SWITCH, 4 POSITION ROTARY	1
32	S8019A	PLATE, STRIKER	1	77	P1900A	CONNECTOR, 1/2" FLEX STRAIGHT	4
33	T3044A	SUPPORT, WIRE RACK	2	78	U3149A	LABEL, WARNING HOT SURFACE (FRENCH)	1
34	T3043A	RACK, FULL SIZE	5	79	U3103A	LABEL, WARNING, HOT SURFACE	1
35	E6865A	SUPPORT, SIDE RACK	8	80	U4197A	DECAL, CAUTION DISCONNECT	1
36	L5091A	BURNER w/IGNITOR BRACKET	1	81	E8790A	WELDMENT, WALL TUBE MOUNT	1
37	M2140A	IGNITER 24 V	1	82	E8064K	ADAPTER, VENT (DIRECT VENTING ONLY)	1
38	R3180A	ORIFICE #48 NAT ONLY	4	83	S0430A	FLANGE BEARING	1
	R6756A	ORIFICE 1.25MM LP ONLY	4	84	L5090A	BURNER	3
39	R8118A	MANIFOLD	1	85	N5007A	NIPPLE, 1/2" X 2-1/2" STEEL PIPE, BLACK	1
40	R3161A	CARRY OVER, PILOT ORIFICE #71 (NAT)	1	86	M1360A	TRANSFORMER, CLASS 2, 120/240V-24V, 40VA	1
41	E8187A	BRACKET MANIFOLD	1	87	E8779A	BRACKET, MOUNTING (POTENTIOMETER)	1
42	E8143A	PANEL, FRONT FIREBOX	1	88	S6804A	CHAIN, ROLLER #35	2
43	M1323X	FLAME SENSOR	1	89	Q2039A	NUT, HEX, LEFT HAND 1/4-20 SS	2
44	N3010A	ELBOW, 1/2" X 90°	3	90	Q2016A	NUT, HEX, 1/4-20 SS	2
45	N5024A	NIPPLE, 1/2" X 8"	1	91	M0120A	PROBE, RTD	1
46	N3009A	UNION, 1/2"	2	92	R3002Y	DIRECT VENT	1



## BAKERS PRIDE LIMITED WARRANTY

30 Pine Street New Rochelle, New York 10801  
914 / 576 - 0200 • US & Canada: 1 - 800 - 431 - 2745 • fax 914 / 576 - 0605

- WHAT IS COVERED** This warranty covers defects in material and workmanship under normal use, and applies only to the original purchaser providing that:
- ◆ The equipment has not been accidentally or intentionally damaged, altered or misused;
  - ◆ The equipment is properly installed, adjusted, operated and maintained in accordance with National and local codes, and in accordance with the installation instruction provided with the product;
  - ◆ The serial number rating plate affixed to the equipment has not been defaced or removed.
- WHO IS COVERED** This warranty is extended to the original purchaser and applies only to equipment purchased for use in the U.S.A.
- COVERAGE PERIOD** Cyclone Convection Ovens: BCO Models: One (1) Year limited parts and labor; (1) Year limited door warranty.  
GDCO Models: Two (2) Year limited parts and labor; (2) Year limited door warranty.  
CO11 Models: Two (2) Year limited parts and labor; (5) Year limited door warranty.  
All Other Products: One (1) Year limited parts and labor. Warranty period begins the date of dealer invoice to customer or ninety (90) days after shipment date from BAKERS PRIDE - whichever comes first.
- WARRANTY COVERAGE** This warranty covers on-site labor, parts and reasonable travel time and travel expenses of the authorized service representative up to (100) miles, round trip, and (2) hours travel time. The purchaser, however, shall be responsible for all expenses related to travel, including time, mileage and shipping expenses on smaller counter models that may be carried into a Factory Authorized Service Center, including the following models: PX-14, PX-16, P18, P22S, P24S, PD-4, PDC, WS Series and BK-18.
- EXCEPTIONS** All removable parts in BAKERS PRIDE Char-broilers, including but not limited to: Burners, Grates, Radiants, Stones and Valves, are covered for a period of SIX MONTHS.  
All Ceramic Baking Decks are covered for a period of THREE MONTHS. The installation of these replacement decks is the responsibility of the purchaser.  
The extended Cyclone door warranty years 3 through 5 is a parts only warranty and does not include labor, travel, mileage or any other charges.
- EXCLUSIONS**
- ◆ Negligence or acts of God,
  - ◆ Thermostat calibrations after (30) days from equipment installation date,
  - ◆ Air and Gas adjustments,
  - ◆ Light bulbs,
  - ◆ Glass doors and door adjustments,
  - ◆ Fuses,
  - ◆ Char-broiler work decks and cutting boards,
  - ◆ Tightening of conveyor chains,
  - ◆ Adjustments to burner flames and cleaning of pilot burners,
  - ◆ Tightening of screws or fasteners,
  - ◆ Failures caused by erratic voltages or gas supplies,
  - ◆ Unauthorized repair by anyone other than a BAKERS PRIDE Factory Authorized Service Center,
  - ◆ Damage in shipment,
  - ◆ Alteration, misuse or improper installation,
  - ◆ Thermostats and safety valves with broken capillary tubes,
  - ◆ Accessories — spatulas, forks, steak turners, grate lifters, oven brushes, scrapers, peels, etc.,
  - ◆ Freight — other than normal UPS charges,
  - ◆ Ordinary wear and tear.
- INSTALLATION** Leveling and installation of decks, as well as proper installation and check out of all new equipment — per appropriate installation and use materials — is the responsibility of the dealer or installer, not the manufacturer.
- REPLACEMENT PARTS** BAKERS PRIDE genuine Factory OEM parts receive a (90) day materials warranty effective from the date of installation by a BAKERS PRIDE Factory Authorized Service Center.

This Warranty is in lieu of all other warranties, expressed or implied, and all other obligations or liabilities on the manufacturer's part. BAKERS PRIDE shall in no event be liable for any special, indirect or consequential damages, or in any event for damages in excess of the purchase price of the unit. The repair or replacement of proven defective parts shall constitute a fulfillment of all obligations under the terms of this warranty.

Form #U4177A 3/04