



30 Pine Street • New Rochelle • New York • 10801  
 914 / 576 - 0200  
 914 / 576 - 0605 fax  
 1 - 800 - 431 - 2745 US & Canada  
 www.bakerspride.com web address



**PX-14/16**  
*Electric Countertop Oven*

**PARTS LIST**

**PX-14 Beginning:**  
 Serial #4633, 12/09/99 (120V)  
 Serial #6547, 11/22/99 (208/240V)

**PX-16 Beginning:**  
 Serial #959, 11/11/99 (120V)  
 Serial #1783, 12/01/99 (208/240V)



**PX-14**



**PX-16**

Model Number: \_\_\_\_\_

Serial Number: \_\_\_\_\_

**Voltage (Single Phase Only)**

115V

200V

208-240V

# PX-14 / PX-16

Electric Countertop Oven

30 Pine Street • New Rochelle • New York • 10801

914 / 576 - 0200

914 / 576 - 0605 fax

1 - 800 - 431 - 2745 US & Canada

www.bakerspride.com web address

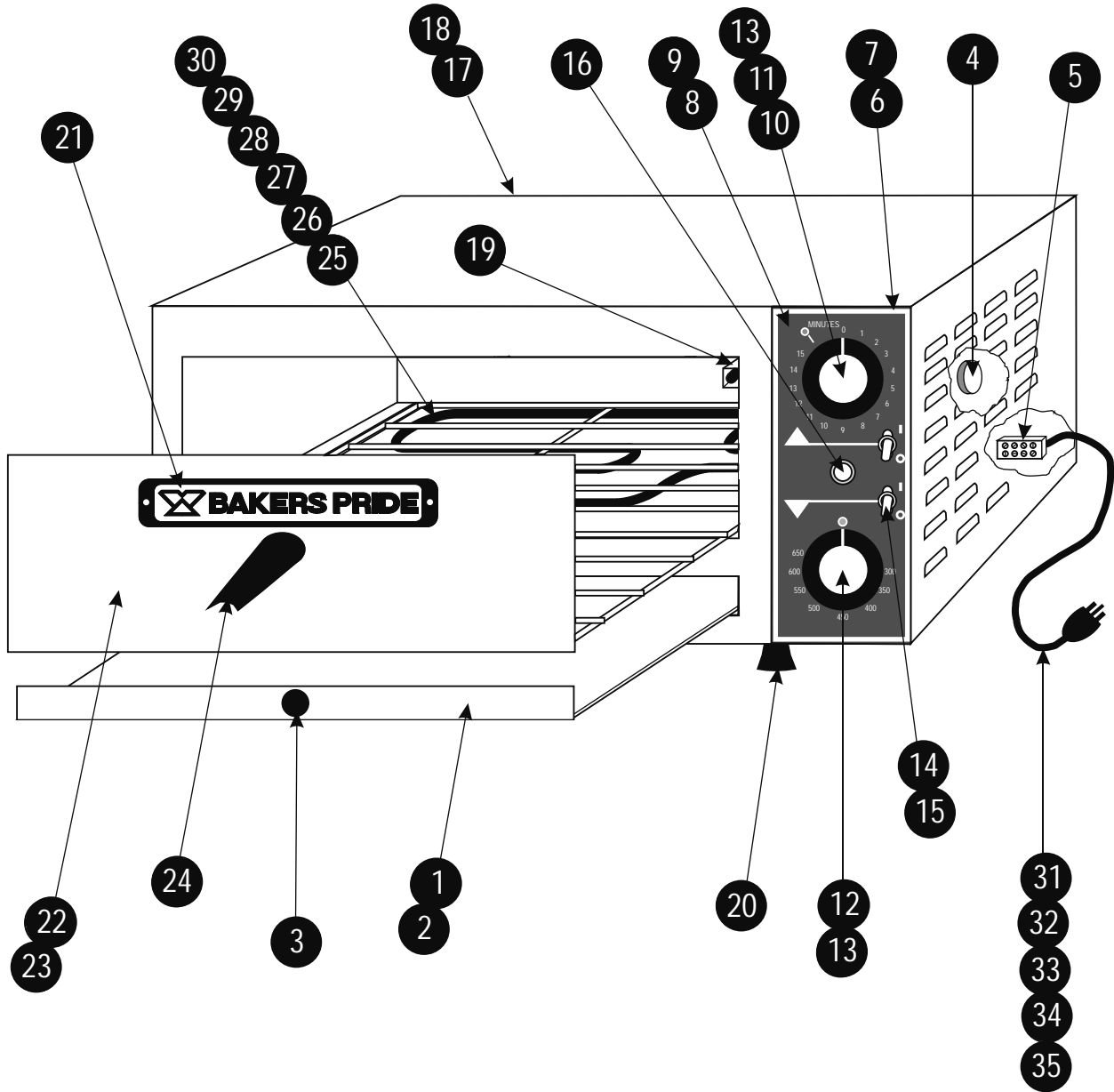

Figure A

PX-14 / 16 (New Style)

**PX-14 Beginning:**  
 Serial #4633, 12/09/99 (120V)  
 Serial #6547, 11/22/99 (208/240V)

**PX-16 Beginning:**  
 Serial #959, 11/11/99 (120V)  
 Serial #1783, 12/01/99 (208/240V)





30 Pine Street • New Rochelle • New York • 10801  
 914 / 576 - 0200  
 914 / 576 - 0605 fax  
 1 - 800 - 431 - 2745 US & Canada  
 www.bakerspride.com web address

# PX-14 / PX-16

*Electric Countertop Oven*

Item	Part #	Description	Item	Part #	Description
<b>PX-14 / 16 (New Style)</b>					
1	D5023X	Crumb Pan Assy w/Knob (PX-14)	19	D5043U	Capillary Retainer Assy
2	D5123X	Crumb Pan Assy w/Knob (PX-16)	20	S1151X	Leg, each
3	S1153X	Knob (Crumb Pan)	21	U1044X	Bakers Pride Nameplate, 8"
4	M1335X	Audio Alarm	22	D5037U	Peel Tray Assy w/Wire Rack & Hdl (PX-14)
5	P1003X	Terminal Block, 3 Pole	23	D5141U	Peel Tray Assy w/Wire Rack & Hdl (PX-16)
6	D5027U	Control Panel Assy, Front (PX-14)	24	S1031X	Handle, w/Nut & Bolt
7	D5127X	Control Panel Assy, Front (PX-16)	25	L1065X	Element, PX-14, 120V/750W (2)
8	U1308A	Control Panel Overlay, 60hz	26	L1148X	Element, PX-16, 120V/900W (2)
9	U1309A	Control Panel Overlay, 50hz	27	L1066X	Element, PX-14, 220V/750W (2)
10	M1331X	Timer, Rotary-Elec, 15 Minutes, 120V	28	L1149X	Element, PX-16, 220V/900W (2)
11	M1345X	Timer, Rotary-Elec, 15 Minutes, 220V	29	L1067X	Element, PX-14, 100V/750W (2) Japan
12	M1119X	Thermostat, EGO, 300-650 deg (No Knob)	30	L1156X	Element, PX-16, 200V/900W (2) Japan
13	S1311X	Knob (Thermostat & Timer)	31	P6004X	Line Cord, 125V/15A
14	M1037X	Switch, Toggle, On/Off	32	P6383A	Line Cord, 125V/20A (Canada)
15	S1038X	Rubber Boot, On/Off Switch (Export)	33	P6005X	Line Cord, 250V/15A
16	P1127X	Pilot Light, Amber	34	P6006X	Line Cord, CEE7-VII (Europe)
17	D5038U	Rear Panel Assy, (PX-14)	35	P6343X	Line Cord w/Fuse, 13A/240V (U.K.)
18	D5138U	Rear Panel Assy, (PX-16)			

# PX-14 / PX-16

Electric Countertop Oven

30 Pine Street • New Rochelle • New York • 10801  
 914 / 576 - 0200  
 914 / 576 - 0605 fax  
 1 - 800 - 431 - 2745 US & Canada  
 www.bakerspride.com web address



**Figure B**

**PX-14 / 16 (Old Style)**

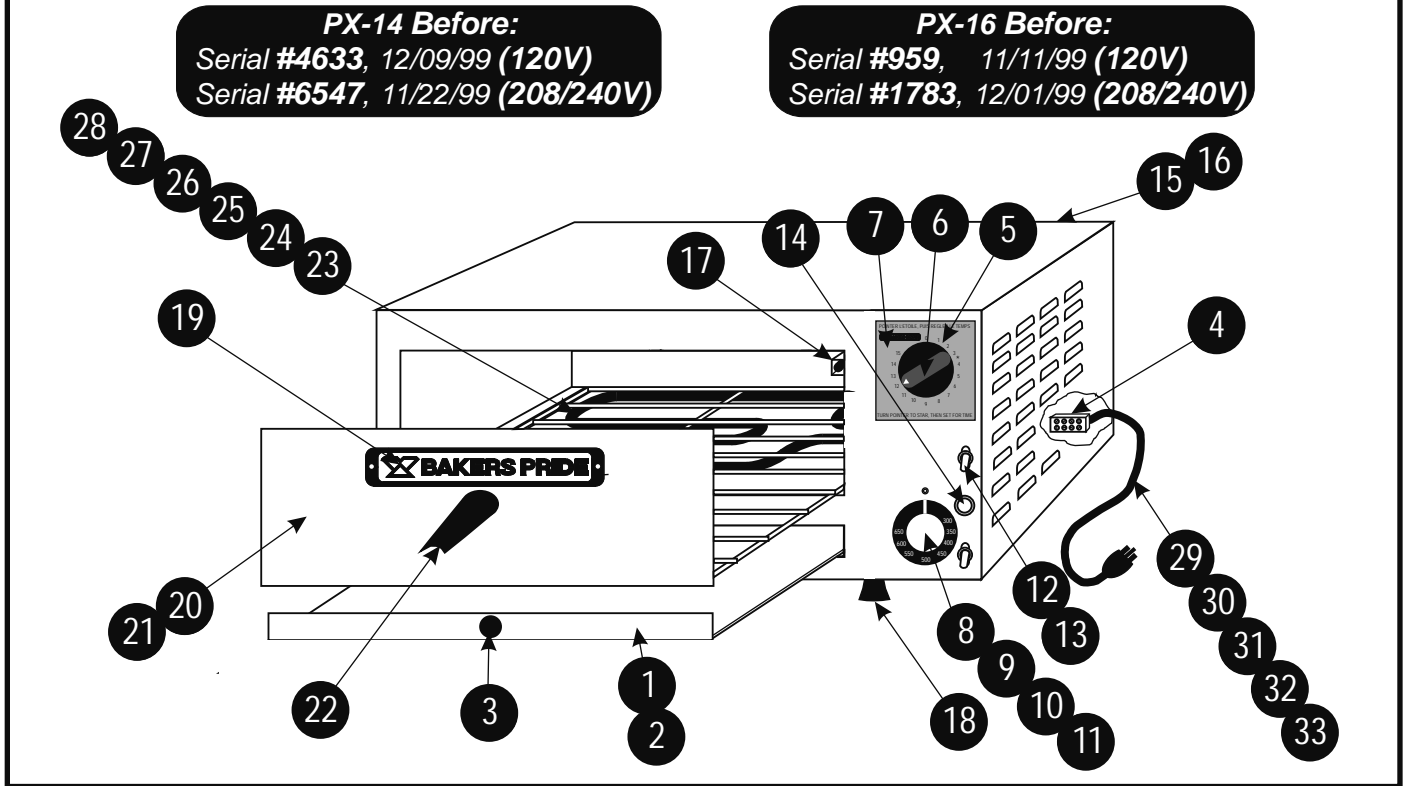

Item	Part #	Description	Item	Part #	Description
1	D5023X	Crumb Pan Assy w/Knob (PX-14)	18	S1151X	Leg, each
2	D5123X	Crumb Pan Assy w/Knob (PX-16)	19	U1044X	Bakers Pride Nameplate, 8"
3	S1153X	Knob (Crumb Pan)	20	D5037U	Peel Tray Assy w/Wire Rack (PX-14)
4	P1003X	Terminal Block, 3 Pole	21	D5141U	Peel Tray Assy w/Wire Rack (PX-16)
5	M1017X	Timer, Mech, 15 Minutes (w/Knob/Plate)	22	S1031X	Handle, w/Nut & Bolt
6	S1052X	Knob, Timer	23	L1065X	Element, PX-14, 120V/750W (2)
7	S1025X	Plate, Timer	24	L1148X	Element, PX-16, 120V/900W (2)
8	M1120X	Thermostat, EGO, 650F deg (w/Knob)	25	L1066X	Element, PX-14, 220V/750W (2)
9	M1119X	Thermostat, EGO, 370C deg (w/Knob)	26	L1149X	Element, PX-16, 220V/900W (2)
10	S1155X	Knob, Thermostat (650F)	27	L1067X	Element, PX-14, 100V/750W (2) Japan
11	S1154X	Knob, Thermostat (370C)	28	L1156X	Element, PX-16, 200V/900W (2) Japan
12	M1037X	Switch, Toggle, On/Off	29	P6004X	Line Cord, 125V/15A
13	S1038X	Rubber Boot, On/Off Switch (Export)	30	P6383A	Line Cord, 125V/20A (Canada)
14	P1127X	Pilot Light, Amber	31	P6005X	Line Cord, 250V/15A
15	D5038U	Rear Panel Assy, (PX-14)	32	P6006X	Line Cord, CEE7-VII (Europe)
16	D5138U	Rear Panel Assy, (PX-16)	33	P6343X	Line Cord w/Fuse, 13A/240V (U.K.)
17	D5043U	Capillary Retainer Assy			