



30 Pine Street • New Rochelle • New York • 10801

1 - 914 / 576 - 0200

1 - 914 / 576 - 0605 fax

1 - 800 - 431 - 2745 US & Canada

www.bakerspride.com web address

Y-600-DSP

Gas Display Oven

PARTS LIST

SuperDeck 6

GAS DISPLAY SERIES



(Shown with custom brass trim)

Model Number: **Y-600-DSP**

Serial Number _____

Type of Gas

Natural

L.P.

Other

Exterior / Decks / Doors

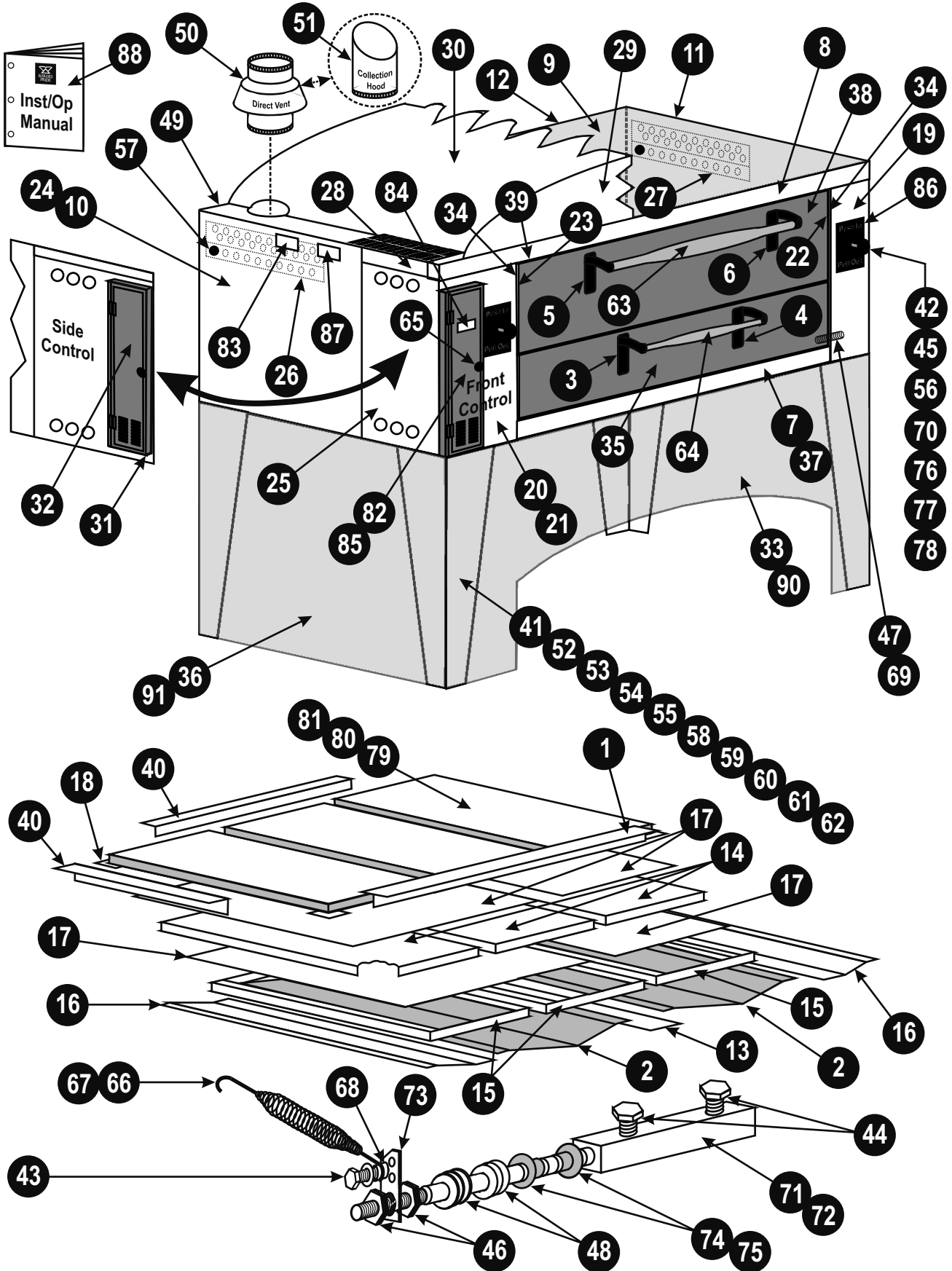

Item	Part #	Description	Item	Part #	Description
1	A1153X	Hearth Trim Assy, S/S	47	Q3023X	Spacer Kit, Door Pin
2	A3079X	Flame Diverter, Slide Out 35" (2)	48	Q3024X	Spacer Kit, Door Rod
3	A3278U	Door Handle Bracket Assy, Bottom Left	49	R1061P	Gas Inlet Assy
4	A3279U	Door Handle Bracket Assy, Bottom Right	50	R3002Y	Flue Diverter, Direct Vent
5	A3280U	Door Handle Bracket Assy, Top Left Black	51	R3115Y	Flue Diverter, Collection Hood
6	A3281U	Door Handle Bracket Assy, Top Right Black	52	S1003X	Leg, 16" (ea)
7	A4001X	Bottom Apron, S/S	53	S1003Y	Legs, 16" (Set/4, w/Bolts)
8	A4002X	Top Trim, S/S	54	S1004X	Leg, 30" (ea)
9	A4007X	Outer Top, S/S	55	S1004Y	Legs, 30" (Set/4, w/Bolts)
10	A4011X	Outer Side, Left, S/S	56	S1005X	Knob, Push-Pull, 3/8"-16
11	A4015X	Outer Side, Right S/S	57	S1010X	Knob, Flue Slide
12	A4027U	Outer Back Assy, SS	58	S1018T	Leg, 12" (ea)
13	A4063X	Flame Diverter, Center (1)	59	S1018Y	Legs, 12" (Set/4, w/Bolts)
14	A4092X	Air (Insulation) Pan Assy, 20" x 36" (Set/3)	60	S1076X	S/S Leg Wrap, 12" (Set/2)
15	A4103T	Hearth Frame Assy, 20" (3)	61	S1077X	S/S Leg Wrap, 16" (Set/2)
16	A4107K	Flame Diverter, Side (2)	62	S1078X	S/S Leg Wrap, 30" (Set/2)
17	A4082X	Hearth Liner Sheet, Set (1 Lg, 1 Sm)	63	S1325A	Door Handle, Long (Top Door)
18	A4140Z	Shim, Hearth 2" x 2"(each)	64	S1330A	Door Handle, Short (Bottom Door)
19	A4181U	Front Panel Assy, Right	65	S1346A	Latch, Mini Quarter Turn
20	A4182U	Front Panel Assy, Left SS (Front Mt)	66	S3003X	Spring, Top Door, 1 1/8" x 9 3/4"
21	A4186U	Front Panel Assy, Left SS (Side Mt)	67	S3004X	Spring, Bottom Door, 13/16" x 6 3/4"
22	A4286K	Door Seal, R.H.	68	S3007X	Teflon Bushing Assy
23	A4287K	Door Seal, L.H.	69	S3009X	Pin, Door, Right Side (9/16"-18 x 3")
24	A4541K	Outer Side, Left SS,RR-Half (Side Mt)	70	S3036X	Push-Pull Rod, 3/8"x 10-1/2" (Off-Set) [Y
25	A4545K	Outer Side, Left SS,FR-Half (Side Mt)	71	S3040W	Door Rod Assy, Left Side (3/4" x 14 1/2")
26	A4584T	Flue Slide Assy, Lower, Left	72	S3040X	Door Rod, Left Side (3/4" x 14 1/2")
27	A4585T	Flue Slide Assy, Lower, Right	73	S3056X	Lever, Door Spring (3 1/2")
28	A4844K	Top Trim, Left-Side SS (Side Mt)	74	S3133X	Insert Only (Duralon) .75 ID x .88 OD
29	A4861U	Upper Arch Assy S/S, Top Oven	75	S3135X	Bushing w/Insert, Door Rod (3/4")
30	A4862K	Dome, S/S Top Oven	76	S3137A	Bushing, Door Pin 0.69/0.75 ID x 0.88 OD X 2"
31	A4943T	Cont.Pnl Sleeve Assy, (PC-Blk)	77	S3138X	Sleeve Assy, Door Pin
32	A4944C	Access Door Assy, (PC-Blk)	78	S3236A	Push-Pull Rod, 12 3/4" (Tile)
33	A4951K	Skirt, 16"H Front (Double Stack, Bottom Oven)	79	T1005X	Steel Baking Deck (Option)
34	A4964K	Tile Flange, Vertical (Tile)	80	T1118X	Hearth Baking Deck, 20x36x1 1/2 (Set/3)
35	A4981T	Door Assy, Bottom PC-Blk	81	T1118Y	Hearth Baking Deck, 20x36x1 1/2 (ea)
36	A4984K	Skirt, 16"H-Side (Double Stack Tile, Bottom Oven)	82	U1240A	Label, Unit For Use Only With.....
37	A4988K	Bottom Apron, A/S (Bottom Oven, Tile)	83	U1243A	Label, Ventilation Hood, Bi-Ling
38	A4989T	Door Assy, Top PC-Blk 4 hole	84	U1245A	Label, Gas Shut-Off Valve (Bi-Ling)
39	A4997K	Tile Flange, Horizontal (Tile)	85	U1333A	Label, Warning (Pizza Oven/Cordierie)
40	K1099K	Wedge, Hearth, 30" (2)	86	U1356A	Push-Pull Plate
41	Q2102A	Bolt, Leg, 1/2-13 x 1 (ea) - Not Shown	87	U1364A	Label, Warning
42	Q2217A	Bolt, Push-Pull Rod (1)	88	U4007A	Installation/Operating Manual (Large Gas)
43	Q2301X	Shoulder Bolt, 3/8-16 x 1"	89	A4799C	Center Apron, Blk (Bet. Upper & Lower Oven - N/S)
44	Q2303X	Bolt, Door Rod, 3/8-16 (2)	90	A4221K	Skirt, 30"H Front (Single Stack)
45	Q2306A	Nut, Push-Pull Rod (2)	91	A4222K	Skirt, 30"H-Side (Single Stack)
46	Q2401X	Nut, Door Rod (9/16-18)			

Controls / Interior Components

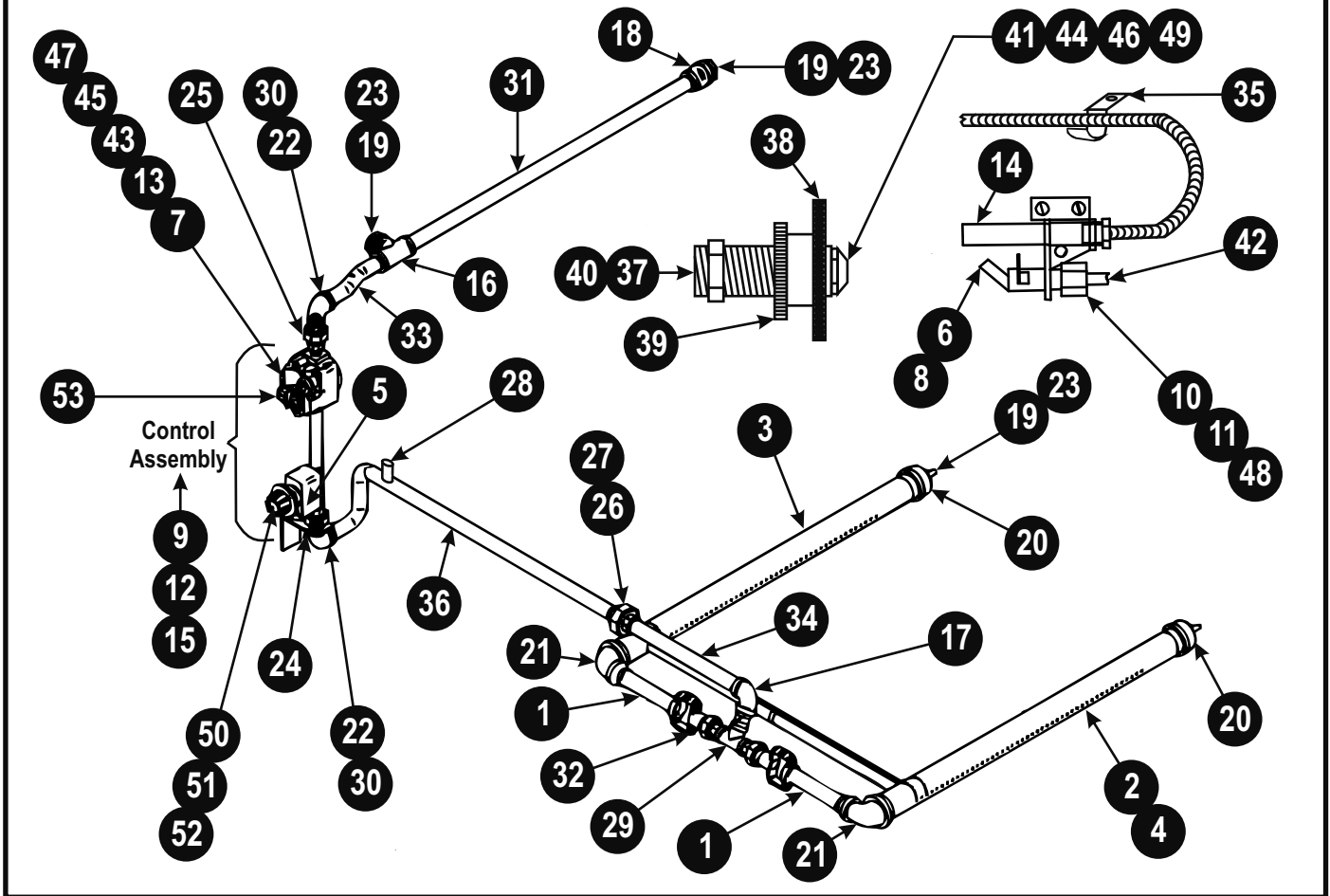

Item	Part #	Description	Item	Part #	Description
1	L5001X	Inspirator #3	29	N3077P	Manifold Tee Assy
2	L5075X	Burner w/Cap & Elbow, Right (13 1/2" C-Ovr)	30	N5009A	Nipple
3	L5076X	Burner w/Cap & Elbow, Left (13 1/2" C-Ovr)	31	N5203P	Nipple
4	L5085P	Burner, Complete (13 1/2" C-Ovr)	32	N5212A	Nipple
5	M1005X	Thermostat, Gas, FDTH (650F, 340°C) 1/2"	33	N5232A	Nipple
6	M1220X	Pilot Burner, Natural, w/Ftgs, 2 CHA-1	34	N5233P	Nipple
7	M1221X	BMVR Valve Kit, LP - Not Shown	35	Q4021X	Capillary Clip, 3/16"
8	M1222X	Pilot Burner, LP, w/Fittings, 2 CHA-1	36	R1130P	Manifold Assy
9	M1242X	Control Assy, Nat BMVR 650°F (Frnt Mt, Top Ovn)	37	R3004A	Spud Holder #3
10	M1244X	Orifice, Pilot, Nat, 2 CHA-1 (.018")	38	R3005A	Adjusting Disc, #3
11	M1245X	Orifice, Pilot, LP, 2 CHA-1 (.010")	39	R3006A	Locking Disc, #3
12	M1248X	Control Assy, LP BMVR (650°F) Side Mt	40	R3007X	Spud Assy #3
13	M1260X	BMVR Valve Kit, Nat - Not Shown	41	R3008X	Orifice, Blank - Not drilled
14	M1265X	Thermopile, Q313 (w/Armoured Cable)	42	R3035X	Pilot Tubing, S/S, 3/16" x 60"
15	M1371P	Control Assy, Nat Gas, CE (U7mvr) 650°F	43	R3104X	Valve Assy, 7000Bmvr Cmbi, Nat Gas
16	N3002A	Tee	44	R3117X	Orifice, Nat, #25 Drill (2)
17	N3004A	Elbow	45	R3124X	Valve Assy, 7000Bmvr Cmbi, LP Gas
18	N3007A	Coupling	46	R3129X	Orifice, LP #43 Drill (10" WC)
19	N3008A	Bushing, Reducing	47	R3137E	Valve Assy, U7000mvr CE Combi, Nat Gas
20	N3013A	Pipe Cap	48	R3182A	Ball Sleeve, Annealed (Ferrule)
21	N3016A	Elbow	49	R3189P	Orifice #1, Town Gas, Spud #3
22	N3021A	Elbow	50	S1056X	Knob, Thermostat, 650°F (Side Mount)
23	N3022A	Plug	51	S1163X	Knob, Thermostat, FDTH, CE, 340°C
24	N3026M	Union, Male	52	S1385A	Knob, Thermostat, 650°F, 3" Dia. (Front Mount)
25	N3027F	Union, Female	53	S1453A	Knob, Combination Valve
26	N3028P	Union, Female	54	M1002X	Automatic Oven Starter (7 Day Timer) - Not Shown
27	N3029P	Union, Male	55	X1113Q	Crate, Shipping (Top Oven w/Dome) - Not Shown
28	N3068P	Pressure Tap Nozzle Assy	56	Y6KIT#21	Packaging Kit, (Y-600) - Not Shown