

# **BEVERAGE-AIR**

## **PARTS MANUAL**

FOR

**SM/ST/SMF-34/49/58**



**ALL PURPOSE COLD** ®

**MILK COOLERS**  
**COLD WALL & FORCED AIR**

**115V60HZ**

| PART                                | PAGE |
|-------------------------------------|------|
| ACCUMULATORS                        | 7    |
| CAPILLARY TUBES                     | 6    |
| CASTERS                             | 4    |
| COMPRESSOR CAP./RELAY ASSY.         | 6    |
| COMPRESSOR START CAP.               | 6    |
| COMPRESSORS                         | 6    |
| CONDENSER COILS                     | 7    |
| CONDENSER FAN BLADES                | 7    |
| CONDENSER FAN MOTORS                | 7    |
| CONDENSING UNITS                    | 6    |
| DOOR BUMPER-RECESS 1" BLACK         | 3    |
| DOOR GASKET ASSEMBLIES              | 4    |
| DOOR HINGE BUSHING                  | 4    |
| DOOR HINGE PIN                      | 4    |
| DOOR HINGE PLATE                    | 4    |
| DOOR HINGE RETAINER                 | 4    |
| DOOR LATCH KEEPER                   | 4    |
| DOOR LATCH PIN ASSEMBLY             | 4    |
| DOOR LATCH SPACER                   | 4    |
| DOOR LOCK SCREWS                    | 3    |
| DOOR LOCK SPACERS                   | 3    |
| DOOR LOCK STRIKE                    | 3    |
| DOOR LOCK WASHERS                   | 3    |
| DOOR LOCKS W / KEYS                 | 3    |
| DOOR STRIKE                         | 3    |
| DRAIN "O" RING                      | 4    |
| DRAIN CAP AND WASHER(EXTERIOR)      | 4    |
| DRAIN FLANGE                        | 4    |
| DRAIN HOSE ADAPTER (NYLON)          | 4    |
| DRAIN LINE HOOK                     | 4    |
| DRAIN PAN (EVAPORATOR)              | 4    |
| DRAIN PAN HOOK SPRING               | 4    |
| DRAIN PAN SPRING HOOK               | 4    |
| DRAIN PLUG (EXTERIOR)               | 4    |
| DRAIN PLUG (INTERIOR)               | 3    |
| DRYERS                              | 7    |
| EVAPORATOR FAN BLADES               | 4    |
| EVAPORATOR FAN MOTORS               | 4    |
| EVAPORATOR COIL ASSEMBLIES          | 6    |
| EVAPORATOR COILS                    | 6    |
| LID ASSEMBLIES                      | 3    |
| LID BUMPER ASSEMBLY                 | 4    |
| LID CHAIN RETAINER SCREW            | 4    |
| LID CHAIN                           | 4    |
| LID GASKET KITS                     | 3    |
| LID GASKETS-SEALS                   | 3    |
| LID HOLDING CLAMP                   | 4    |
| REFRIGERATION ASSEMBLIES            | 6    |
| SHELVING                            | 4    |
| SUCTION LINE & CAPILLARY ASSEMBLIES | 6    |
| TEMPERATURE CONTROLS                | 4    |
| THERMOMETERS (SOLAR & DIGITAL)      | 4    |

# SMF34/49/58 ILLUSTRATION

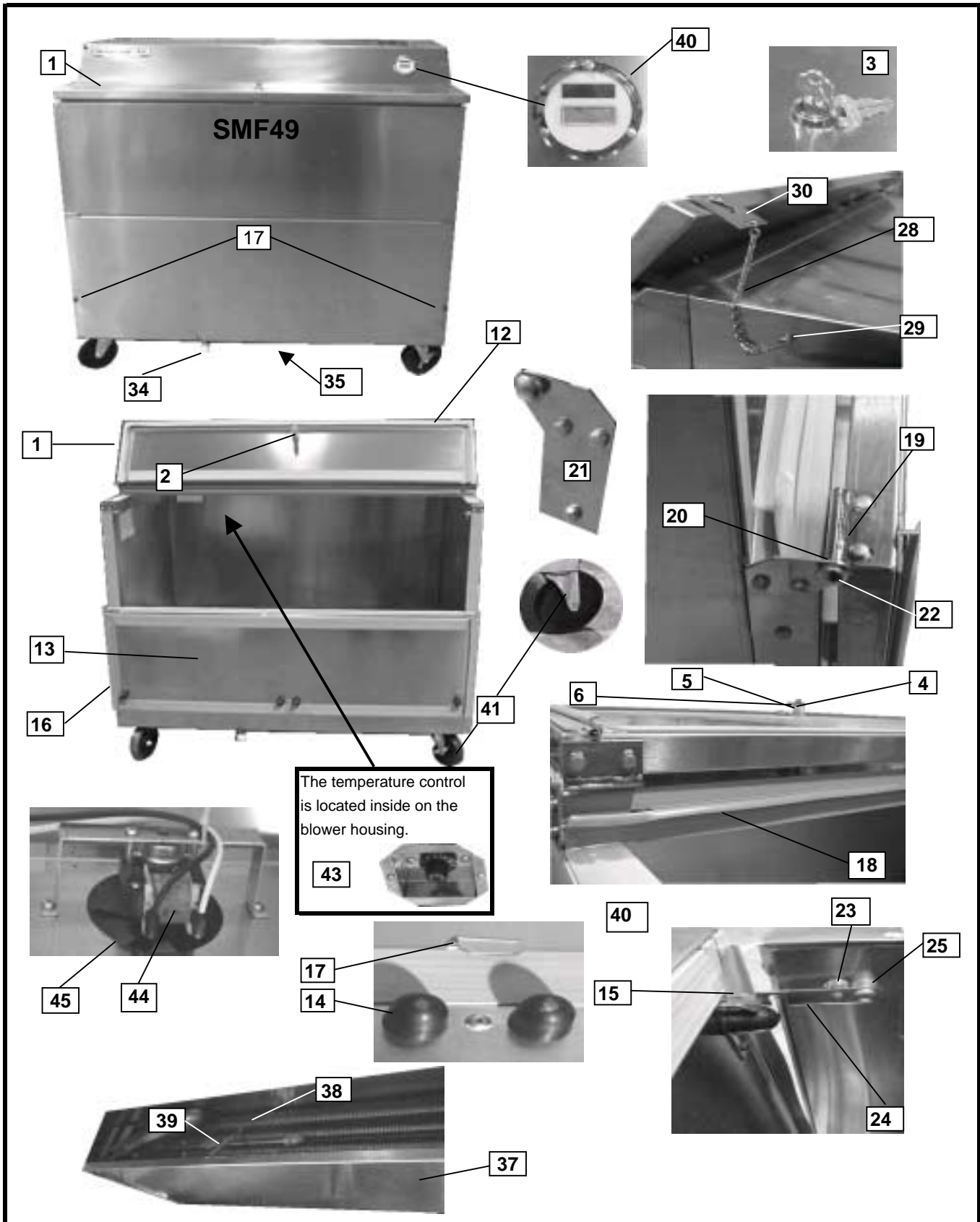

# SM-ST34/49/58 ILLUSTRATION

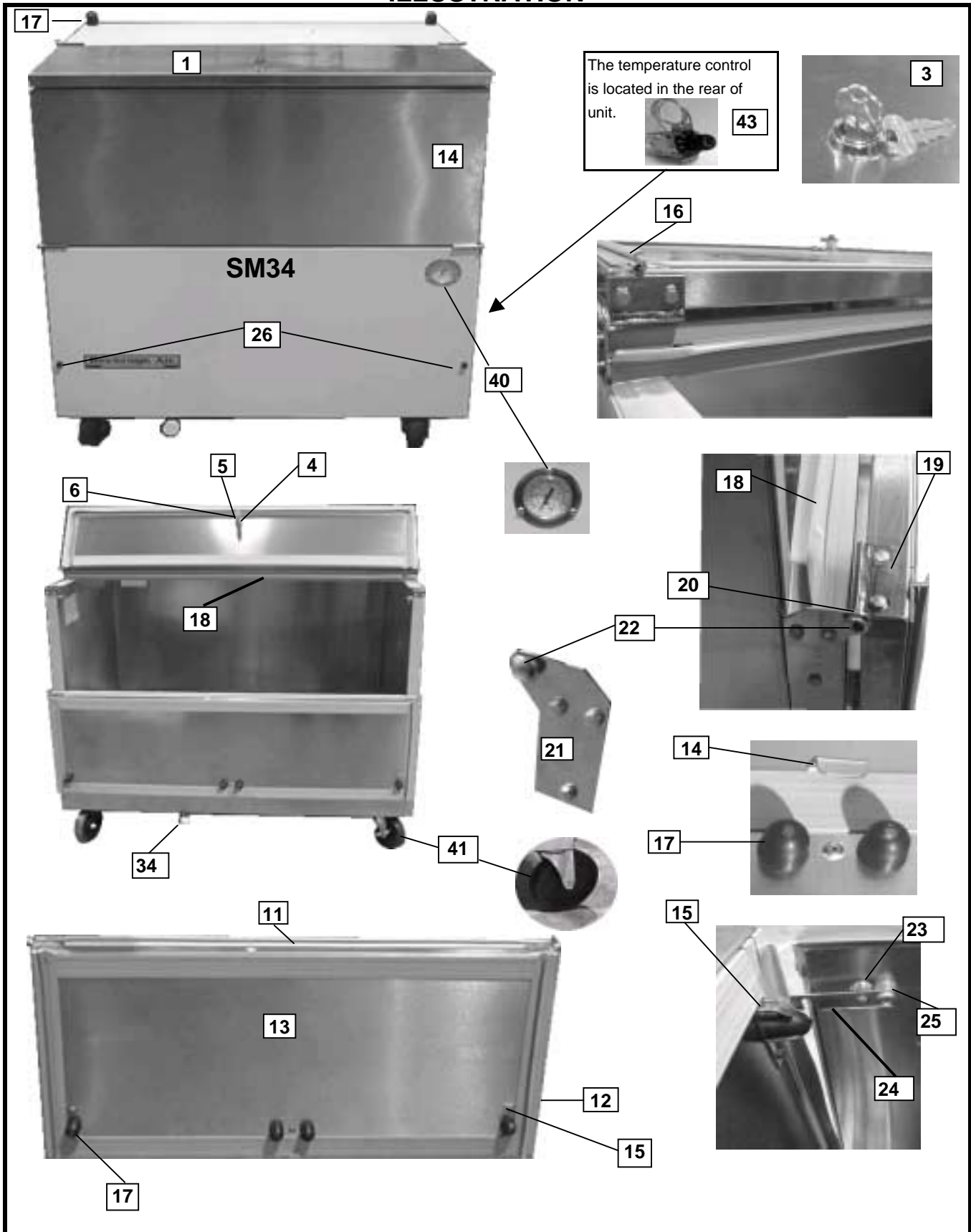

## SCHOOL MILK UNITS

### DOORS & LIDS

| ITEM | MODEL #     | DESCRIPTION                       | PART NUMBER   |
|------|-------------|-----------------------------------|---------------|
| 1    | SM34        | LID ASSEMBLY                      | 02B33-045C    |
|      | SM49        | LID ASSEMBLY                      | 02B33-044C    |
|      | SM58        | LID ASSEMBLY                      | 02B33-043C    |
|      | ST/SMF34    | LID ASSEMBLY                      | 02B33-050D    |
|      | ST/SMF49    | LID ASSEMBLY                      | 02B33-048D    |
|      | ST/SMF58    | LID ASSEMBLY                      | 02B33-047D    |
| 2    | ALL         | LOCK ACCY KIT                     | 00C30-103A    |
| 3    | ALL         | LOCK WITH KEYS(2)-#2298           | 401-049AAA    |
| 4    | ALL         | LOCK EXTENSION NYLON              | 401-126A      |
| 5    | ALL         | LOCK CAM                          | 401-567A      |
| 6    | ALL         | LOCK SCREW HHMS 5/16-18 X 1 SM/ST | 603-402A      |
| 7    | ALL         | CAMLOCK NUT SPACER SM/ST/SMF      | 401-480A      |
| 8    | ALL         | WASHER - NYLON LOCK SPACER        | 703-371A--    |
| 9    | ALL         | SPACER - LOCK SUPPORT             | 703-638A      |
| 10   | ALL         | HOLE PLUG 1/2 DIA GRAY            | 703-645A      |
| 11   | SM34        | LID GASKET - SEAL                 | 02A40-017C    |
|      | SM49/58     | LID GASKET - SEAL                 | 02A40-018C    |
|      | ST/SMF34    | LID GASKET - SEAL                 | 02A40-020C    |
|      | SM/ST/SMF58 | LID GASKET- SEAL                  | 02A40-021C    |
| 12   | SM34/49     | GASKET KIT                        | 32C01-002A    |
|      | SM58        | GASKET KIT                        | 32C01-003A    |
|      | SMF34       | GASKET KIT                        | 32C01-004A    |
|      | SMF49       | GASKET KIT                        | 32C01-005A    |
|      | SMF58       | GASKET KIT                        | 32C01-006A    |
| 13   | SM/ST/SMF34 | DOOR ASSEMBLY                     | 02B33-063D-03 |
|      | SM/ST/SMF49 | DOOR ASSEMBLY                     | 02B33-063D-02 |
|      | SM/ST/SMF58 | DOOR ASSEMBLY                     | 02B33-063D-01 |
| 14   | ALL DOORS   | DOOR LOCK STRIKE                  | 02A42-009A    |
| 15   | ALL DOORS   | DOOR STRIKE                       | 28D04-028A    |
| 16   | ALL DOORS   | DOOR GASKET SEAL-DOOR END-L/R     | 28D12-009C    |
| 17   | ALL DOORS   | DOOR BUMPER - RECESS 1"D BLACK    | 703-161A--    |

## SCHOOL MILK UNITS CABINET COPONENTS

| ITEM | MODEL #       | DESCRIPTION                          | PART NUMBER   |
|------|---------------|--------------------------------------|---------------|
| 18   | SM/ST34       | CABINET GASKET ASSY.                 | 28B36-002ABB  |
|      | SM/ST49       | CABINET GASKET ASSY.                 | 28B36-001AAB  |
|      | SM/ST58       | CABINET GASKET ASSY.                 | 28B03-002BAA  |
| 19   | ALL SM/SMF/ST | HINGE PIN ASSY                       | 13B01-006A    |
| 20   | ALL SM/SMF/ST | HINGE BUSHING                        | 703-178A--    |
| 21   | ALL SM/SMF/ST | HINGE PLATE (FOR DOOR AND LID)       | 28A77-016B    |
| 22   | ALL SM/SMF/ST | PUSH ON HINGE RETAINER               | 604-167A      |
| 23   | ALL SM/SMF/ST | LATCH PIN ASSY.                      | 603-388A      |
| 24   | ALL SM/SMF/ST | DOOR KEEPER LT/RT SS SM/SMF          | 28D04-029A    |
| 25   | ALL SM/SMF/ST | LATCH SPACER                         | 401-446A      |
| 26   | ALL SM/SMF/ST | BUMPER - RECESS BLACK RUBBER         | 703-003A--    |
| 27   | ALL SM        | BUMPER ASS'Y                         | 02B30-007B    |
| 28   | SMF34/49/58   | LID CHAIN                            | 606-001A--    |
| 29   | SMF34/49/58   | LID CHAIN RETAINER SCREW             | 603-275A      |
| 30   | SMF34/49/58   | LID HOLDING CLAMP                    | 28D01-013B-05 |
| 31   | ALL SM/SMF    | DRAIN PLUG                           | 703-605A      |
| 32   | ALL SM/SMF    | DRAIN FLANGE                         | 205-151A      |
| 33   | ALL SM/SMF    | "O" RING                             | 703-379A--    |
| 34   | ALL SM/SMF    | DRAIN CAP W/WASHER                   | 205-144A      |
| 35   | ALL SM/SMF    | NYLON HOSE ADAPT                     | 205-143A      |
| 36   | SMF 34/49/58  | DRAIN LINE HOOKS                     | 401-084A--    |
| 37   | SMF34         | EVAP.DRAIN PAN ASSY.                 | 04B02-106C    |
|      | SMF49         | EVAP.DRAIN PAN ASSY.                 | 04B02-107C    |
|      | SMF58         | EVAP.DRAIN PAN ASSY.                 | 04B02-094C    |
| 38   | SMF34/49/58   | PAN SPRING HOOK                      | 401-409A      |
| 39   | SMF34/49/58   | EVAP. PAN SPRING                     | 404-414A      |
| 40   | SM34/49/58    | DIAL THERMOMETER 2IN DIA.            | 402-232B      |
|      | ALL SMF       | THERM. DIGITAL SOLAR                 | 402-249A      |
| 41   | ALL SM        | CASTER 4"                            | 401-094A--    |
|      | ALL SM        | CASTER 4" W/BRAKE                    | 401-099A--    |
|      | ALL SMF       | CASTER 7"                            | 401-519A      |
|      | ALL SMF       | CASTER 7" W/BRAKE                    | 401-520A      |
| 42   | SM34N         | SHELF 30.75X26.63                    | 403-221D      |
|      | SM34L         | SHELF 29.75X25.63                    | 403-219D      |
|      | SMF34         | SHELF 27.25X27.63                    | 403-400C      |
|      | SM49N         | SHELF 22.75X26.63                    | 403-222D      |
|      | SM49L         | SHELF 22.25X25.63                    | 403-220D      |
|      | SMF49         | SHELF 22.25X27.63                    | 403-401C      |
|      | SM58N         | SHELF 27.25X26.63                    | 403-223D      |
| 43   | SM34/49N      | TEMPERATURE CONTROL                  | 502-294B      |
|      | SM34/49L      | TEMPERATURE CONTROL                  | 502-067ABB    |
|      | SM58N         | TEMPERATURE CONTROL                  | 502-294B      |
| 44   | SMF34/49/58   | EVAPERATOR FAN MOTOR .65 AMPS 120-60 | 501-076B      |
| 45   | SMF34/49/58   | EVAPERATOR FAN BLADE 4"(5 PET PLAS)  | 405-054A      |

REFRIGERATION ASSEMBLY COMPONENTS

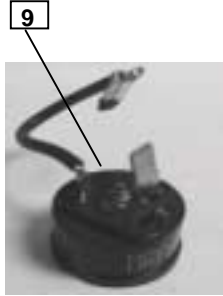
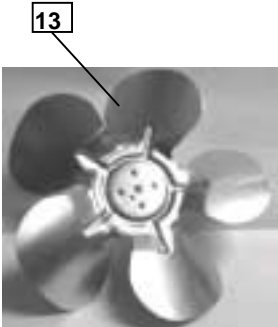
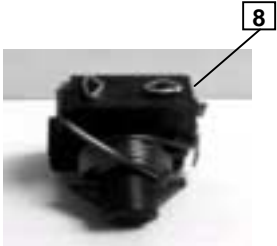
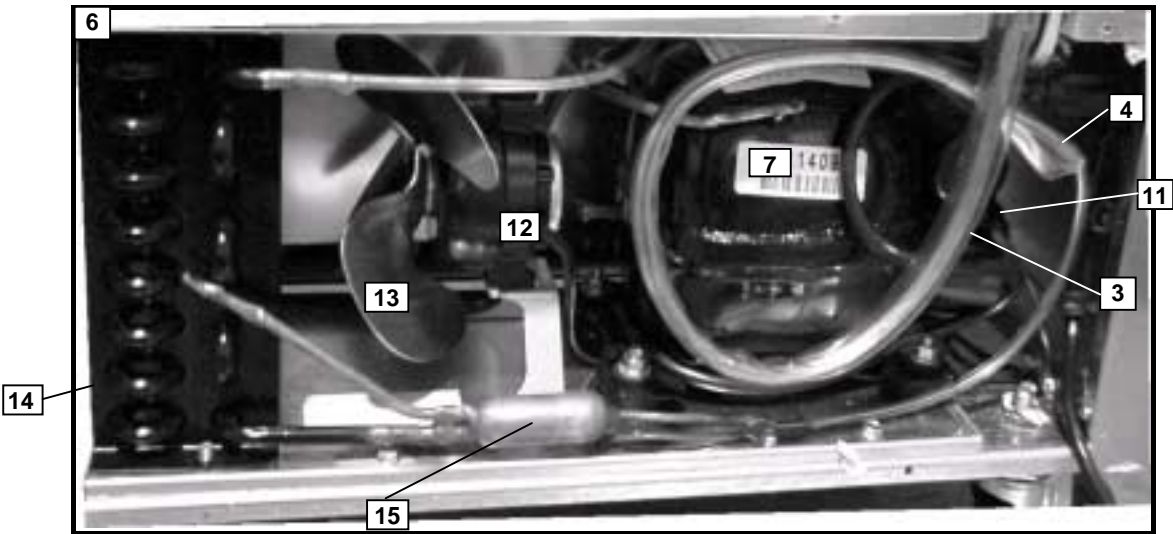

**SCHOOL MILK UNITS  
REFRIGERATION ASSEMBLIES**

| ITEM | MODEL #     | DESCRIPTION                               | PART NUMBER   |
|------|-------------|-------------------------------------------|---------------|
| 1    | SMF34       | REFRIGERATION ASSEMBLY                    | 19B36-075D-01 |
|      | SMF49       | REFRIGERATION ASSEMBLY                    | 19B36-076D-01 |
|      | SMF58       | REFRIGERATION ASSEMBLY                    | 19B36-077D-01 |
| 2    | SMF34       | EVAPORATOR COIL ASSEMBLY                  | 20B30-084D    |
|      | SMF49       | EVAPORATOR COIL ASSEMBLY                  | 20B30-085D    |
|      | SMF58       | EVAPORATOR COIL ASSEMBLY                  | 20B30-086D    |
| 3    | SMF34/49/58 | SUCTION LINE AND CAPILLARY ASSY.          | 20B33-024C    |
|      | SM34N       | SUCTION LINE AND CAPILLARY ASSY.          | 19B30-028D    |
|      | SM49N       | SUCTION LINE AND CAPILLARY ASSY.          | 19B30-029D    |
|      | SM58N       | SUCTION LINE AND CAPILLARY ASSY.          | 19B30-030D    |
|      | SM34L       | SUCTION LINE AND CAPILLARY ASSY.          | 19B30-022D    |
|      | SM49L       | SUCTION LINE AND CAPILLARY ASSY.          | 19B30-022D    |
|      | ST34        | SUCTION LINE AND CAPILLARY ASSY.          | 19B30-028D    |
|      | ST49        | SUCTION LINE AND CAPILLARY ASSY.          | 19B30-029D    |
|      | ST58        | SUCTION LINE AND CAPILLARY ASSY.          | 19B30-030D    |
| 4    | SMF34/49/58 | CAPILLARY TUBE<br>(.059ID X .109OD X 96)  | 203-128A      |
|      | SM34N       | CAPILLARY TUBE<br>(.049ID X .099OD X 116) | 203-041A--    |
|      | SM49N       | CAPILLARY TUBE<br>(.049ID X .099OD X 80)  | 203-117A      |
|      | SM58N       | CAPILLARY TUBE<br>(.054ID X .106OD X 96)  | 203-045A--    |
|      | SM34L/SM49L | CAPILLARY TUBE<br>(.042ID X .092OD X 108) | 203-138A      |
|      | ST34        | CAPILLARY TUBE<br>(.049ID X .099OD X 116) | 203-041A--    |
|      | ST49        | CAPILLARY TUBE<br>(.049ID X .099OD X 80)  | 203-117A      |
|      | ST58        | CAPILLARY TUBE<br>(.054ID X .106OD X 96)  | 203-045A--    |
| 5    | SMF34       | EVAPORATOR COIL<br>(26"X4"X5")            | 305-191C      |
|      | SMF49       | EVAPORATOR COIL<br>(41"X4"X5")            | 305-192C      |
|      | SMF58       | EVAPORATOR COIL<br>(50"X4"X5")            | 305-193C      |
| 6    | SMF34       | CONDENSING UNIT                           | 15C32-049D    |
|      | SMF49/58    | CONDENSING UNIT                           | 15C32-047D    |
|      | SM34N       | CONDENSING UNIT                           | 19B34-031D-01 |
|      | SM49N       | CONDENSING UNIT                           | 19B34-031D-03 |
|      | SM58N       | CONDENSING UNIT                           | 19B34-031D-02 |
|      | SM34L       | CONDENSING UNIT                           | 19B34-025D-01 |
|      | SM49L       | CONDENSING UNIT                           | 19B34-025D-01 |
|      | SM58L       | CONDENSING UNIT                           | 19B34-031D-02 |
|      | ST34        | CONDENSING UNIT                           | 19B34-031D-01 |
|      | ST49        | CONDENSING UNIT                           | 19B34-031D-03 |
|      | ST58        | CONDENSING UNIT                           | 19B34-031D-02 |



**SCHOOL MILK UNITS**  
**REFRIGERATION ASSEMBLIES (Continued)**

| ITEM | MODEL #                              | DESCRIPTION                                  | PART NUMBER |
|------|--------------------------------------|----------------------------------------------|-------------|
| 7    | SMF49/58                             | COMPRESSOR<br>1/2HP 115-60 TEC. (AKA4476YXA) | 302-626B    |
|      | SM34/49N                             | COMPRESSOR<br>1/4HP 115-60 TEC. (AE9415ZXA)  | 312-001B    |
|      | SM58N                                | COMPRESSOR<br>1/3HP 115-60 TEC. (AE9422ZXA)  | 312-002B    |
|      | SM34/49L                             | COMPRESSOR<br>1/3HP 115-60 TEC (AEA2411ZXA)  | 302-943B    |
|      | SM58L                                | COMPRESSOR<br>1/3HP 115-60 TEC. (AE9422ZXA)  | 312-002B    |
|      | ST34/49                              | COMPRESSOR<br>1/4HP 115-60 TEC. (AE9415ZXA)  | 312-001B    |
|      | ST58                                 | COMPRESSOR<br>1/3HP 115-60 TEC. (AE9422ZXA)  | 312-002B    |
| 8    | SMF34                                | COMPRESSOR RELAY<br>(TI) 9660 042 182        | 302-350A    |
|      | SMF49/58                             | COMPRESSOR RELAY<br>(GE) 3ARR2-KCR181S       | 302-290A    |
|      | SM34/49N                             | COMPRESSOR RELAY<br>(GE) 3ARR12-PL22         | 302-909A    |
|      | SM58N                                | COMPRESSOR RELAY<br>(GE) 3ARR12KPL71         | 302-963A    |
|      | SM34/49L                             | COMPRESSOR RELAY<br>(GE) 3ARR12KPL71         | 302-963A    |
|      | SM58L                                | COMPRESSOR RELAY<br>(GE) 3ARR12KPL71         | 302-963A    |
|      | ST34/49                              | COMPRESSOR RELAY<br>(GE) 3ARR12-PL22         | 302-909A    |
| ST58 | COMPRESSOR RELAY<br>(GE) 3ARR12KPL71 | 302-963A                                     |             |
| 9    | SMF34                                | COMPRESSOR OVERLOAD                          | 302-350A    |
|      | SMF49/58                             | COMPRESSOR OVERLOAD                          | 302-439A    |
|      | SM34/49N                             | COMPRESSOR OVERLOAD                          | 302-908A    |
|      | SM58N                                | COMPRESSOR OVERLOAD                          | 313-009A    |
|      | SM34/49L                             | COMPRESSOR OVERLOAD                          | 313-004A    |
|      | SM58L                                | COMPRESSOR OVERLOAD                          | 313-009A    |
|      | ST34/49                              | COMPRESSOR OVERLOAD                          | 302-908A    |
| ST58 | COMPRESSOR OVERLOAD                  | 313-009A                                     |             |
| 10   | SMF49/58                             | START CAP.                                   | 302-628A    |
|      | SM34/49N                             | START CAP.                                   | 302-357A    |
|      | SM58N                                | START CAP.                                   | 315-003A    |
|      | SM34/49L                             | START CAP.                                   | 315-003A    |
|      | SM58L                                | START CAP.                                   | 315-003A    |
|      | ST34/49                              | START CAP.                                   | 302-357A    |
|      | ST58                                 | START CAP.                                   | 315-003A    |
| 11   | SMF49/58                             | CAP/RELAY ASSY.                              | 302-718A    |
|      | SM58N                                | CAP/RELAY ASSY.                              | 317-009A    |
|      | SM34/49L                             | CAP/RELAY ASSY.                              | 317-004A    |
|      | SM58L                                | CAP/RELAY ASSY.                              | 317-009A    |

**SCHOOL MILK UNITS**  
**REFRIGERATION ASSEMBLIES (Continued)**

| ITEM | MODEL #     | DESCRIPTION                               | PART NUMBER |
|------|-------------|-------------------------------------------|-------------|
| 12   | SMF34/49/58 | CONDENSER FAN MOTOR<br>(9 WATTS 115-60)   | 501-148B    |
|      | SM34N       | CONDENSER FAN MOTOR<br>(5 WATTS 115-60)   | 501-019B    |
|      | SM49/58N    | CONDENSER FAN MOTOR<br>(9 WATTS 115-60)   | 501-148B    |
|      | SM34/49/58L | CONDENSER FAN MOTOR<br>(9 WATTS 115-60)   | 501-148B    |
|      | ST34        | CONDENSER FAN MOTOR<br>(5 WATTS 115-60)   | 501-019B    |
|      | ST49        | CONDENSER FAN MOTOR<br>(9 WATTS 115-60)   | 501-148B    |
|      | ST58        | CONDENSER FAN MOTOR<br>(9 WATTS 115-60)   | 501-148B    |
| 13   | SMF34       | CONDENSER FAN BLADE<br>(8.75")            | 405-034A    |
|      | SMF49/58    | CONDENSER FAN BLADE<br>9.5" (3 PET ALUM)  | 405-053B    |
|      | SM34/49N    | CONDENSER FAN BLADE<br>6.75" (3 PET ALUM) | 405-015A--  |
|      | SM58N       | CONDENSER FAN BLADE<br>7.75" (3 PET ALUM) | 405-012A--  |
|      | SM34/48/58L | CONDENSER FAN BLADE<br>7.75" (3 PET ALUM) | 405-012A--  |
|      | ST34        | CONDENSER FAN BLADE<br>6.75" (3 PET ALUM) | 405-015A--  |
|      | ST49/58     | CONDENSER FAN BLADE<br>7.75" (3 PET ALUM) | 405-012A--  |
| 14   | SMF34       | CONDENSER COIL<br>(11"X10"X3")            | 305-186C    |
|      | SMF49/58    | CONDENSER COIL<br>(11"X10-1/64"X4")       | 305-194C    |
|      | SM34N       | CONDENSER COIL<br>(11"X10-1/64"X4")       | 305-054C    |
|      | SM49/58N    | CONDENSER COIL<br>(11-5/16"X7-7/8"X3")    | 305-049C    |
|      | SM34/49L    | CONDENSER COIL<br>(11-5/16X7-7/8X4)       | 305-048C    |
|      | SM58L       | CONDENSER COIL<br>(11-5/16X7-7/8X3)       | 305-049C    |
|      | ST34        | CONDENSER COIL<br>(11"X10-1/64"X4")       | 305-054C    |
|      | ST49/58     | CONDENSER COIL<br>(11-5/16X7-7/8X3)       | 305-049C    |
| 15   | SMF34       | DRYER                                     | 303-143A    |
|      | SMF49/58    | DRYER                                     | 303-127A    |
|      | SM34/49/58N | DRYER                                     | 303-143A    |
|      | SM34/49/58L | DRYER                                     | 303-143A    |
|      | ST34/49/58  | DRYER                                     | 303-143A    |
| 16   | SMF34/49/58 | ACCUMULATOR                               | 303-071A    |