

# **BEVERAGE-AIR**

**PARTS  
MANUAL  
FOR  
SM/ST/SMF-34/49/58**



**ALL PURPOSE COLD ®**

**MILK COOLERS  
COLD WALL & FORCED AIR**

**115V60HZ**

PART	PAGE
ACCUMULATORS	7
CAPILLARY TUBES	6
CASTERS	4
COMPRESSOR CAP./ RELAY ASSY.	6
COMPRESSOR START CAP.	6
COMPRESSORS	6
CONDENSER COILS	7
CONDENSER FAN BLADES	7
CONDENSER FAN MOTORS	7
CONDENSING UNITS	6
DOOR BUMPER-RECESS 1" BLACK	3
DOOR GASKET ASSEMBLIES	4
DOOR HINGE BUSHING	4
DOOR HINGE PIN	4
DOOR HINGE PLATE	4
DOOR HINGE RETAINER	4
DOOR LATCH KEEPER	4
DOOR LATCH PIN ASSEMBLY	4
DOOR LATCH SPACER	4
DOOR LOCK SCREWS	3
DOOR LOCK SPACERS	3
DOOR LOCK STRIKE	3
DOOR LOCK WASHERS	3
DOOR LOCKS W / KEYS	3
DOOR STRIKE	3
DRAIN "O" RING	4
DRAIN CAP AND WASHER(EXTERIOR)	4
DRAIN FLANGE	4
DRAIN HOSE ADAPTER (NYLON)	4
DRAIN LINE HOOK	4
DRAIN PAN (EVAPORATOR)	4
DRAIN PAN HOOK SPRING	4
DRAIN PAN SPRING HOOK	4
DRAIN PLUG (EXTERIOR)	4
DRAIN PLUG (INTERIOR)	3
DRYERS	7
EVAPORATOR FAN BLADES	4
EVAPORATOR FAN MOTORS	4
EVAPORATOR COIL ASSEMBLIES	6
EVAPORATOR COILS	6
LID ASSEMBLIES	3
LID BUMPER ASSEMBLY	4
LID CHAIN RETAINER SCREW	4
LID CHAIN	4
LID GASKET KITS	3
LID GASKETS-SEALS	3
LID HOLDING CLAMP	4
REFRIGERATION ASSEMBLIES	6
SHELVING	4
SUCTION LINE & CAPILLARY ASSEMBLIES	6
TEMPERATURE CONTROLS	4
THERMOMETERS (SOLAR & DIGITAL)	4

# SMF34/49/58 ILLUSTRATION

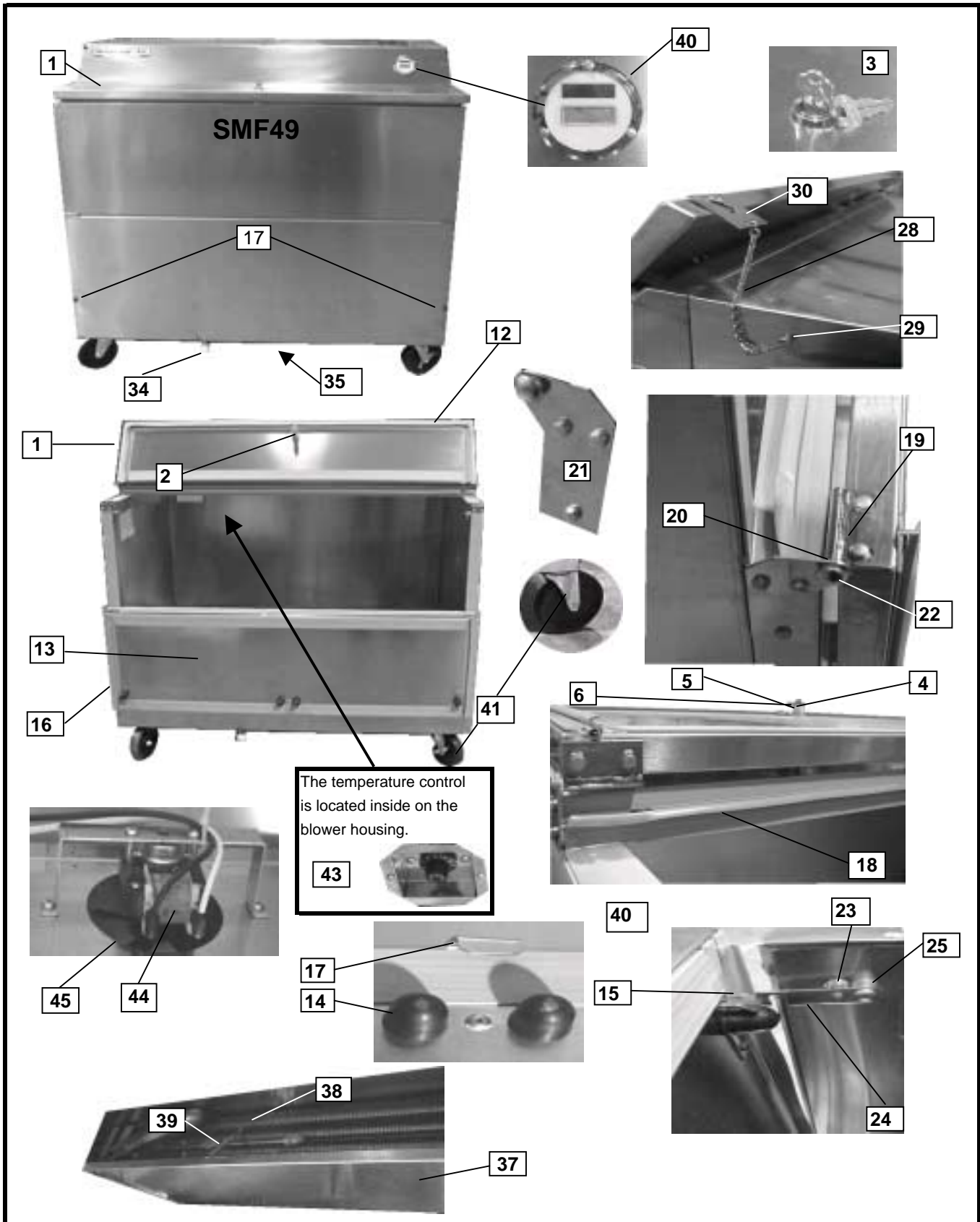

# SM-ST34/49/58 ILLUSTRATION

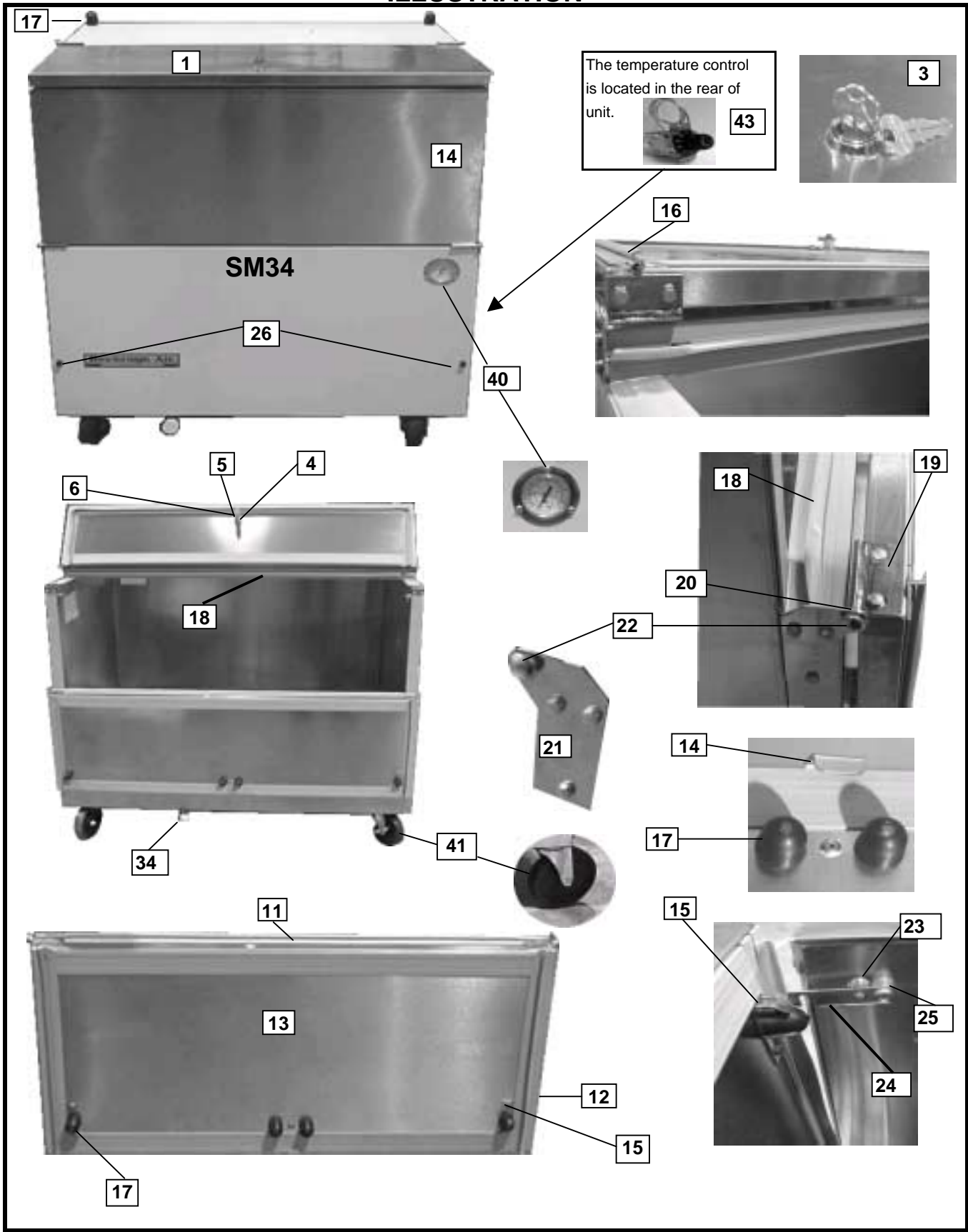

## SCHOOL MILK UNITS

### DOORS & LIDS

ITEM	MODEL #	DESCRIPTION	PART NUMBER
1	SM34	LID ASSEMBLY	02B33-045C
	SM49	LID ASSEMBLY	02B33-044C
	SM58	LID ASSEMBLY	02B33-043C
	ST/SMF34	LID ASSEMBLY	02B33-050D
	ST/SMF49	LID ASSEMBLY	02B33-048D
	ST/SMF58	LID ASSEMBLY	02B33-047D
2	ALL	LOCK ACCY KIT	00C30-103A
3	ALL	LOCK WITH KEYS(2)-#2298	401-049AAA
4	ALL	LOCK EXTENSION NYLON	401-126A
5	ALL	LOCK CAM	401-567A
6	ALL	LOCK SCREW HHMS 5/16-18 X 1 SM/ST	603-402A
7	ALL	CAMLOCK NUT SPACER SM/ST/SMF	401-480A
8	ALL	WASHER - NYLON LOCK SPACER	703-371A--
9	ALL	SPACER - LOCK SUPPORT	703-638A
10	ALL	HOLE PLUG 1/2 DIA GRAY	703-645A
11	SM34	LID GASKET - SEAL	02A40-017C
	SM49/58	LID GASKET - SEAL	02A40-018C
	ST/SMF34	LID GASKET - SEAL	02A40-020C
	SM/ST/SMF58	LID GASKET- SEAL	02A40-021C
12	SM34/49	GASKET KIT	32C01-002A
	SM58	GASKET KIT	32C01-003A
	SMF34	GASKET KIT	32C01-004A
	SMF49	GASKET KIT	32C01-005A
	SMF58	GASKET KIT	32C01-006A
13	SM/ST/SMF34	DOOR ASSEMBLY	02B33-063D-03
	SM/ST/SMF49	DOOR ASSEMBLY	02B33-063D-02
	SM/ST/SMF58	DOOR ASSEMBLY	02B33-063D-01
14	ALL DOORS	DOOR LOCK STRIKE	02A42-009A
15	ALL DOORS	DOOR STRIKE	28D04-028A
16	ALL DOORS	DOOR GASKET SEAL-DOOR END-L/R	28D12-009C
17	ALL DOORS	DOOR BUMPER - RECESS 1"D BLACK	703-161A--

**SCHOOL MILK UNITS  
CABINET COPONENTS**

ITEM	MODEL #	DESCRIPTION	PART NUMBER
18	SM/ST34	CABINET GASKET ASSY.	28B36-002ABB
	SM/ST49	CABINET GASKET ASSY.	28B36-001AAB
	SM/ST58	CABINET GASKET ASSY.	28B03-002BAA
19	ALL SM/SMF/ST	HINGE PIN ASSY	13B01-006A
20	ALL SM/SMF/ST	HINGE BUSHING	703-178A--
21	ALL SM/SMF/ST	HINGE PLATE (FOR DOOR AND LID)	28A77-016B
22	ALL SM/SMF/ST	PUSH ON HINGE RETAINER	604-167A
23	ALL SM/SMF/ST	LATCH PIN ASSY.	603-388A
24	ALL SM/SMF/ST	DOOR KEEPER LT/RT SS SM/SMF	28D04-029A
25	ALL SM/SMF/ST	LATCH SPACER	401-446A
26	ALL SM/SMF/ST	BUMPER - RECESS BLACK RUBBER	703-003A--
27	ALL SM	BUMPER ASS'Y	02B30-007B
28	SMF34/49/58	LID CHAIN	606-001A--
29	SMF34/49/58	LID CHAIN RETAINER SCREW	603-275A
30	SMF34/49/58	LID HOLDING CLAMP	28D01-013B-05
31	ALL SM/SMF	DRAIN PLUG	703-605A
32	ALL SM/SMF	DRAIN FLANGE	205-151A
33	ALL SM/SMF	"O" RING	703-379A--
34	ALL SM/SMF	DRAIN CAP W/WASHER	205-144A
35	ALL SM/SMF	NYLON HOSE ADAPT	205-143A
36	SMF 34/49/58	DRAIN LINE HOOKS	401-084A--
37	SMF34	EVAP.DRAIN PAN ASSY.	04B02-106C
	SMF49	EVAP.DRAIN PAN ASSY.	04B02-107C
	SMF58	EVAP.DRAIN PAN ASSY.	04B02-094C
38	SMF34/49/58	PAN SPRING HOOK	401-409A
39	SMF34/49/58	EVAP. PAN SPRING	404-414A
40	SM34/49/58	DIAL THERMOMETER 2IN DIA.	402-232B
	ALL SMF	THERM. DIGITAL SOLAR	402-249A
41	ALL SM	CASTER 4"	401-094A--
	ALL SM	CASTER 4" W/BRAKE	401-099A--
	ALL SMF	CASTER 7"	401-519A
	ALL SMF	CASTER 7" W/BRAKE	401-520A
42	SM34N	SHELF 30.75X26.63	403-221D
	SM34L	SHELF 29.75X25.63	403-219D
	SMF34	SHELF 27.25X27.63	403-400C
	SM49N	SHELF 22.75X26.63	403-222D
	SM49L	SHELF 22.25X25.63	403-220D
	SMF49	SHELF 22.25X27.63	403-401C
	SM58N	SHELF 27.25X26.63	403-223D
43	SM34/49N	TEMPERATURE CONTROL	502-294B
	SM34/49L	TEMPERATURE CONTROL	502-067ABB
	SM58N	TEMPERATURE CONTROL	502-294B
44	SMF34/49/58	EVAPERATOR FAN MOTOR .65 AMPS 120-60	501-076B
45	SMF34/49/58	EVAPERATOR FAN BLADE 4"(5 PET PLAS)	405-054A

REFRIGERATION ASSEMBLY COMPONENTS

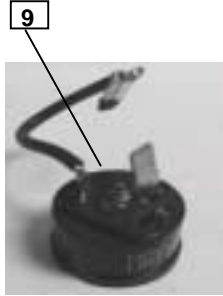
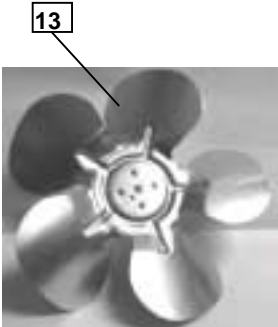
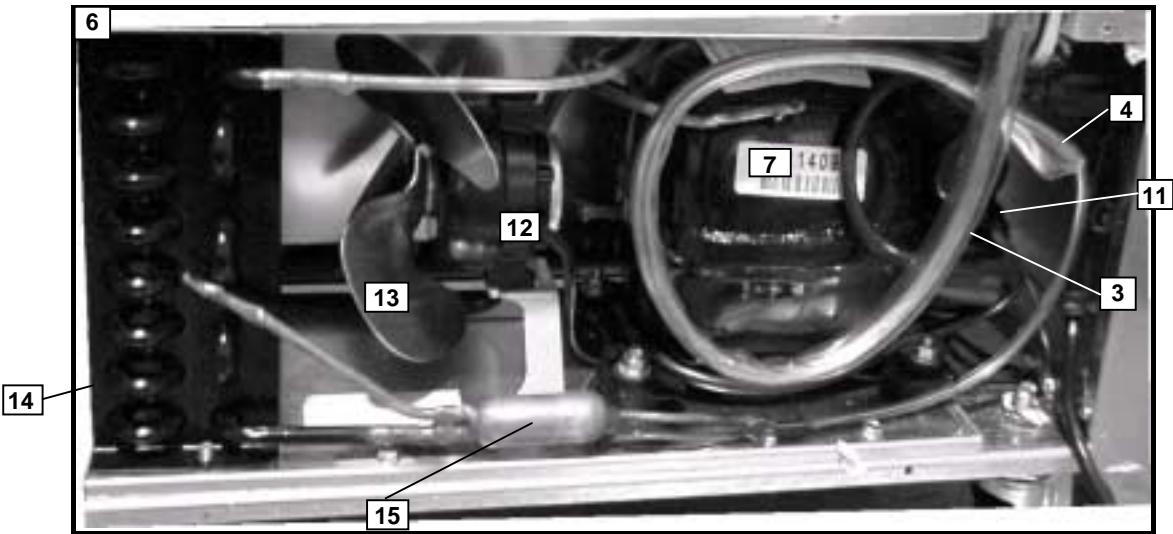

**SCHOOL MILK UNITS  
REFRIGERATION ASSEMBLIES**

ITEM	MODEL #	DESCRIPTION	PART NUMBER
1	SMF34	REFRIGERATION ASSEMBLY	19B36-075D-01
	SMF49	REFRIGERATION ASSEMBLY	19B36-076D-01
	SMF58	REFRIGERATION ASSEMBLY	19B36-077D-01
2	SMF34	EVAPORATOR COIL ASSEMBLY	20B30-084D
	SMF49	EVAPORATOR COIL ASSEMBLY	20B30-085D
	SMF58	EVAPORATOR COIL ASSEMBLY	20B30-086D
3	SMF34/49/58	SUCTION LINE AND CAPILLARY ASSY.	20B33-024C
	SM34N	SUCTION LINE AND CAPILLARY ASSY.	19B30-028D
	SM49N	SUCTION LINE AND CAPILLARY ASSY.	19B30-029D
	SM58N	SUCTION LINE AND CAPILLARY ASSY.	19B30-030D
	SM34L	SUCTION LINE AND CAPILLARY ASSY.	19B30-022D
	SM49L	SUCTION LINE AND CAPILLARY ASSY.	19B30-022D
	ST34	SUCTION LINE AND CAPILLARY ASSY.	19B30-028D
	ST49	SUCTION LINE AND CAPILLARY ASSY.	19B30-029D
	ST58	SUCTION LINE AND CAPILLARY ASSY.	19B30-030D
4	SMF34/49/58	CAPILLARY TUBE (.059ID X .109OD X 96)	203-128A
	SM34N	CAPILLARY TUBE (.049ID X .099OD X 116)	203-041A--
	SM49N	CAPILLARY TUBE (.049ID X .099OD X 80)	203-117A
	SM58N	CAPILLARY TUBE (.054ID X .106OD X 96)	203-045A--
	SM34L/SM49L	CAPILLARY TUBE (.042ID X .092OD X 108)	203-138A
	ST34	CAPILLARY TUBE (.049ID X .099OD X 116)	203-041A--
	ST49	CAPILLARY TUBE (.049ID X .099OD X 80)	203-117A
	ST58	CAPILLARY TUBE (.054ID X .106OD X 96)	203-045A--
5	SMF34	EVAPORATOR COIL (26"X4"X5")	305-191C
	SMF49	EVAPORATOR COIL (41"X4"X5")	305-192C
	SMF58	EVAPORATOR COIL (50"X4"X5")	305-193C
6	SMF34	CONDENSING UNIT	15C32-049D
	SMF49/58	CONDENSING UNIT	15C32-047D
	SM34N	CONDENSING UNIT	19B34-031D-01
	SM49N	CONDENSING UNIT	19B34-031D-03
	SM58N	CONDENSING UNIT	19B34-031D-02
	SM34L	CONDENSING UNIT	19B34-025D-01
	SM49L	CONDENSING UNIT	19B34-025D-01
	SM58L	CONDENSING UNIT	19B34-031D-02
	ST34	CONDENSING UNIT	19B34-031D-01
	ST49	CONDENSING UNIT	19B34-031D-03
	ST58	CONDENSING UNIT	19B34-031D-02



**SCHOOL MILK UNITS**  
**REFRIGERATION ASSEMBLIES (Continued)**

ITEM	MODEL #	DESCRIPTION	PART NUMBER
7	SMF49/58	COMPRESSOR 1/2HP 115-60 TEC. (AKA4476YXA)	302-626B
	SM34/49N	COMPRESSOR 1/4HP 115-60 TEC. (AE9415ZXA)	312-001B
	SM58N	COMPRESSOR 1/3HP 115-60 TEC. (AE9422ZXA)	312-002B
	SM34/49L	COMPRESSOR 1/3HP 115-60 TEC (AEA2411ZXA)	302-943B
	SM58L	COMPRESSOR 1/3HP 115-60 TEC. (AE9422ZXA)	312-002B
	ST34/49	COMPRESSOR 1/4HP 115-60 TEC. (AE9415ZXA)	312-001B
	ST58	COMPRESSOR 1/3HP 115-60 TEC. (AE9422ZXA)	312-002B
8	SMF34	COMPRESSOR RELAY (TI) 9660 042 182	302-350A
	SMF49/58	COMPRESSOR RELAY (GE) 3ARR2-KCR181S	302-290A
	SM34/49N	COMPRESSOR RELAY (GE) 3ARR12-PL22	302-909A
	SM58N	COMPRESSOR RELAY (GE) 3ARR12KPL71	302-963A
	SM34/49L	COMPRESSOR RELAY (GE) 3ARR12KPL71	302-963A
	SM58L	COMPRESSOR RELAY (GE) 3ARR12KPL71	302-963A
	ST34/49	COMPRESSOR RELAY (GE) 3ARR12-PL22	302-909A
ST58	COMPRESSOR RELAY (GE) 3ARR12KPL71	302-963A	
9	SMF34	COMPRESSOR OVERLOAD	302-350A
	SMF49/58	COMPRESSOR OVERLOAD	302-439A
	SM34/49N	COMPRESSOR OVERLOAD	302-908A
	SM58N	COMPRESSOR OVERLOAD	313-009A
	SM34/49L	COMPRESSOR OVERLOAD	313-004A
	SM58L	COMPRESSOR OVERLOAD	313-009A
	ST34/49	COMPRESSOR OVERLOAD	302-908A
ST58	COMPRESSOR OVERLOAD	313-009A	
10	SMF49/58	START CAP.	302-628A
	SM34/49N	START CAP.	302-357A
	SM58N	START CAP.	315-003A
	SM34/49L	START CAP.	315-003A
	SM58L	START CAP.	315-003A
	ST34/49	START CAP.	302-357A
	ST58	START CAP.	315-003A
11	SMF49/58	CAP/RELAY ASSY.	302-718A
	SM58N	CAP/RELAY ASSY.	317-009A
	SM34/49L	CAP/RELAY ASSY.	317-004A
	SM58L	CAP/RELAY ASSY.	317-009A

**SCHOOL MILK UNITS**  
**REFRIGERATION ASSEMBLIES (Continued)**

ITEM	MODEL #	DESCRIPTION	PART NUMBER
12	SMF34/49/58	CONDENSER FAN MOTOR (9 WATTS 115-60)	501-148B
	SM34N	CONDENSER FAN MOTOR (5 WATTS 115-60)	501-019B
	SM49/58N	CONDENSER FAN MOTOR (9 WATTS 115-60)	501-148B
	SM34/49/58L	CONDENSER FAN MOTOR (9 WATTS 115-60)	501-148B
	ST34	CONDENSER FAN MOTOR (5 WATTS 115-60)	501-019B
	ST49	CONDENSER FAN MOTOR (9 WATTS 115-60)	501-148B
	ST58	CONDENSER FAN MOTOR (9 WATTS 115-60)	501-148B
13	SMF34	CONDENSER FAN BLADE (8.75")	405-034A
	SMF49/58	CONDENSER FAN BLADE 9.5" (3 PET ALUM)	405-053B
	SM34/49N	CONDENSER FAN BLADE 6.75" (3 PET ALUM)	405-015A--
	SM58N	CONDENSER FAN BLADE 7.75" (3 PET ALUM)	405-012A--
	SM34/48/58L	CONDENSER FAN BLADE 7.75" (3 PET ALUM)	405-012A--
	ST34	CONDENSER FAN BLADE 6.75" (3 PET ALUM)	405-015A--
	ST49/58	CONDENSER FAN BLADE 7.75" (3 PET ALUM)	405-012A--
14	SMF34	CONDENSER COIL (11"X10"X3")	305-186C
	SMF49/58	CONDENSER COIL (11"X10-1/64"X4")	305-194C
	SM34N	CONDENSER COIL (11"X10-1/64"X4")	305-054C
	SM49/58N	CONDENSER COIL (11-5/16"X7-7/8"X3")	305-049C
	SM34/49L	CONDENSER COIL (11-5/16X7-7/8X4)	305-048C
	SM58L	CONDENSER COIL (11-5/16X7-7/8X3)	305-049C
	ST34	CONDENSER COIL (11"X10-1/64"X4")	305-054C
	ST49/58	CONDENSER COIL (11-5/16X7-7/8X3)	305-049C
15	SMF34	DRYER	303-143A
	SMF49/58	DRYER	303-127A
	SM34/49/58N	DRYER	303-143A
	SM34/49/58L	DRYER	303-143A
	ST34/49/58	DRYER	303-143A
16	SMF34/49/58	ACCUMULATOR	303-071A