



**MT1820E
CONVEYOR OVEN
REPLACEMENT PARTS LIST**



EFFECTIVE MARCH 12, 2001

BLODGETT OVEN COMPANY, 50 Lakeside Avenue, Burlington, Vermont 05401 USA
Telephone: (802) 860-3700 (800) 331-5842 Fax: (802) 860-3732
www.blodgett.com

Superseding All Previous Parts Lists.
The Company reserves the right to make substitution in the event that items specified are not available.
ERRORS: Descriptive and/or typographic errors are subject to correction.

www.blodgett.com

IMPORTANT: When ordering parts, please provide the model, gas type and serial number of the oven. The identification plate is located on the left side of the combustion compartment and, also, above the control panel under the ledge.

MT1820E

March 12, 2001

- ASAP Distributor Required Stocking Parts
- Doors Are Not Returnable

2

ELECTRICAL COMPONENTS

Ref. No.	Part No.	Description
1	<input checked="" type="checkbox"/> M7389	Timer, Solid State (Qty 1)
2	<input checked="" type="checkbox"/> M5442	Control, Temperature (Qty 1)
3	<input checked="" type="checkbox"/> M6811	Control, Minarik Closed Loop (Qty 1) (for Gearmotor)
4	<input checked="" type="checkbox"/> 30857	Probe, Temperature RTD 500 Ohms (Qty 1)
	M7252	Bracket, EGO Probe (Qty 1)
5	<input checked="" type="checkbox"/> M5446	Potentiometer, Control (Qty 1)
6	<input checked="" type="checkbox"/> M6087	Knob, Low Profile (Qty 1)
7	M5447	Indicator Lamp, 250V (Qty 1)
8	<input checked="" type="checkbox"/> 30465	Switch, Rocker DPDT Black (Qty 1)
9	<input checked="" type="checkbox"/> M3295	Thermostat, High Limit (Qty 1)
	<input checked="" type="checkbox"/> M4988	Fuse, 5 AMP, 300V, SC-5 (Qty 2)
10	<input checked="" type="checkbox"/> M0158	Fuse Holder (Qty 2)
11	<input checked="" type="checkbox"/> M9559	Element Assy, 208V, 1 PH (Qty 1)
11	<input checked="" type="checkbox"/> M9560	Element Assy, 240V, 1 PH (Qty 1)
11	M9561	Element Assy, 230V, 1 PH (Qty 1)
	M8576	Voltage Conversion Kit (208 to 240V)
	M8577	Voltage Conversion Kit (240 to 208V)
12	<input checked="" type="checkbox"/> M5765	Relay, Heat Sink Assy. (Qty 1)
13	<input checked="" type="checkbox"/> M6899	Transformer, 208/240V to 24V (Qty 1)
	M3299	Bracket, Thermal Switch (Qty 1)
14	<input checked="" type="checkbox"/> M2453	Snap Disc, L140-20F, 3 Pole (Qty 1) (Blower Compartment)
15	<input checked="" type="checkbox"/> M6044	Snap Disc, L110-20F, 3 Pole (Qty 1) (Control Compartment)
16	M0593	Terminal Block, 2 Pole (Qty 3)
17	M10336	Terminal Block to Din Rail Conv Kit Replaces 11204 this oven only
18	<input checked="" type="checkbox"/> 23034	Axial Fan, 106 CFM, 230V 4" (Qty 5)
19	22718	Guard, Axial Fan (Qty 3)
	M10434	Cord Set Assy., 40 AMP, 250V (Qty 1)
	4888	Lug, Grounding (Qty 1)
20	M7265	Connector, Liquid Tight (Qty 1)
	19634	Contact, Mercury, 3Pole, 30AMP
	M9478	Conversion Kit, SS Relay to Merc. Contactor
	18651	Contact, Mercury, 2 Pole, 60AMP
	M3831	Harness, Elements to Contactor

CONVECTION COMPONENTS

Ref. No.	Part No.	Description
28	<input checked="" type="checkbox"/> M7233	Motor, Blower Assy., CW, 50/60 HZ (Qty 2)
	M7577	Insulation Kit, Blower (Qty 1)
29	M7961	Air Plate, Upper (Qty 1)
30	M7960	Air Plate, Lower (Qty 1)

CONVEYOR COMPONENTS

Ref. No.	Part No.	Description
21	M6337	Belt, Wire S/S 18" (Per Foot) (Total Length 9 FT)
22	<input checked="" type="checkbox"/> M7994	Motor, Gear w/ Encoder (Qty 1) Motor Only
	M7995	Cable, Encoder (for Motor M7994) (with molex connector at each end)
23	M7043	Conveyor Assy. (Qty 1)
	M4815	Shaft, Drive (Qty 1)
	M4816	Shaft, Idle (Qty 1)
24	M4817	Bearing, Rulon (Qty 4)
	M4818	Sprocket, Wire Belt (Qty 10)
25	M7495	Pulley, Timing 1/5 P 3/8 Wide Motor (Sprocket) (Qty 1) (15 Tooth)
26	<input checked="" type="checkbox"/> M5425	Pulley, Timing 1/5 P 3/8 Wide Conveyor (Sprocket) (Qty 1) (30 Tooth)
27	<input checked="" type="checkbox"/> M5423	Belt, Timing (Qty 1) (Marked "200XL")

FOR OVENS MANUFACTURED BEFORE 04/01/96 & UP TO SERIAL NUMBER 040196GC038S

Ref. No.	Part No.	Description
	M0200	Knob, Lock Phenolic, Black (Qty 2)
<input checked="" type="checkbox"/>	M6087	Knob, Low Profile (Qty 1)
	M8209	Motor, Gear w/ Encoder Replacement Kit **See Note
<input checked="" type="checkbox"/>	M7994	Motor, Gear w/Encoder (Qty 1) Motor only **See note

NOTE: Part number M8209 is needed only to convert from old style (M7126-no longer available). After you've converted this motor, you will only need to order part number M7994.

M7995	Cable, Encoder (for Motor M7994) (with molex connector at each end)
M4954	Control Cover Assy. w/ Access Door (Qty 1)
M6035	Latch, Access Door (Qty 1)
M5424	Pulley, Timing 1/5 P 3/8 Wide (Sprocket) (Qty 1) (12 Tooth)

MT1820E STANDARD & CE CONTROLS (Detail "A")

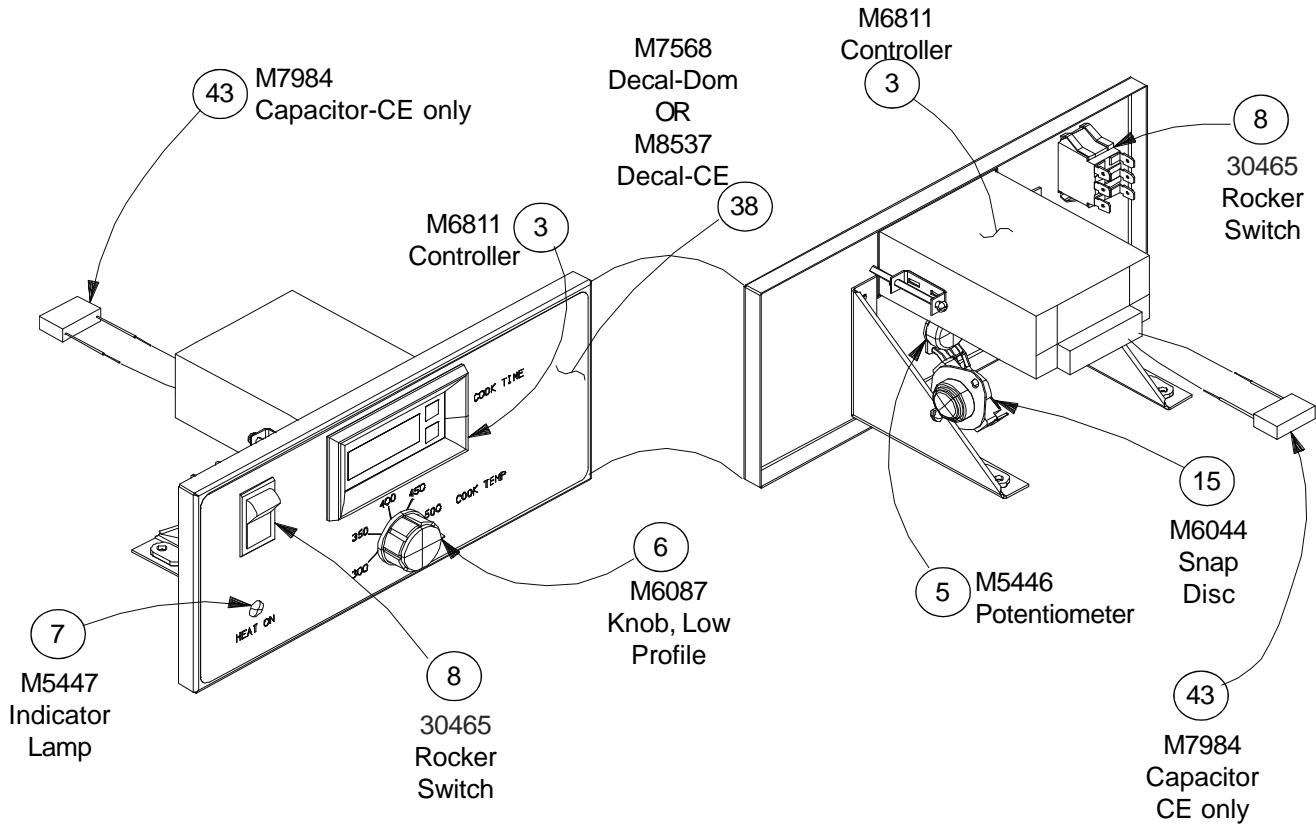

STANDARD & CE CONTROLS

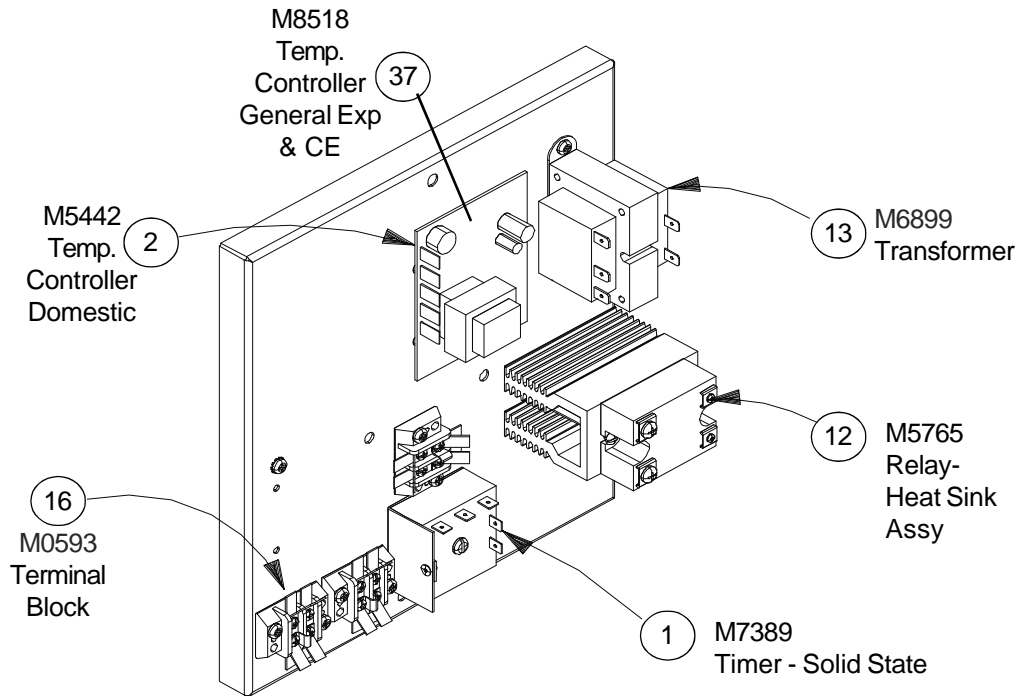

MT1820 EXTERIOR VIEW

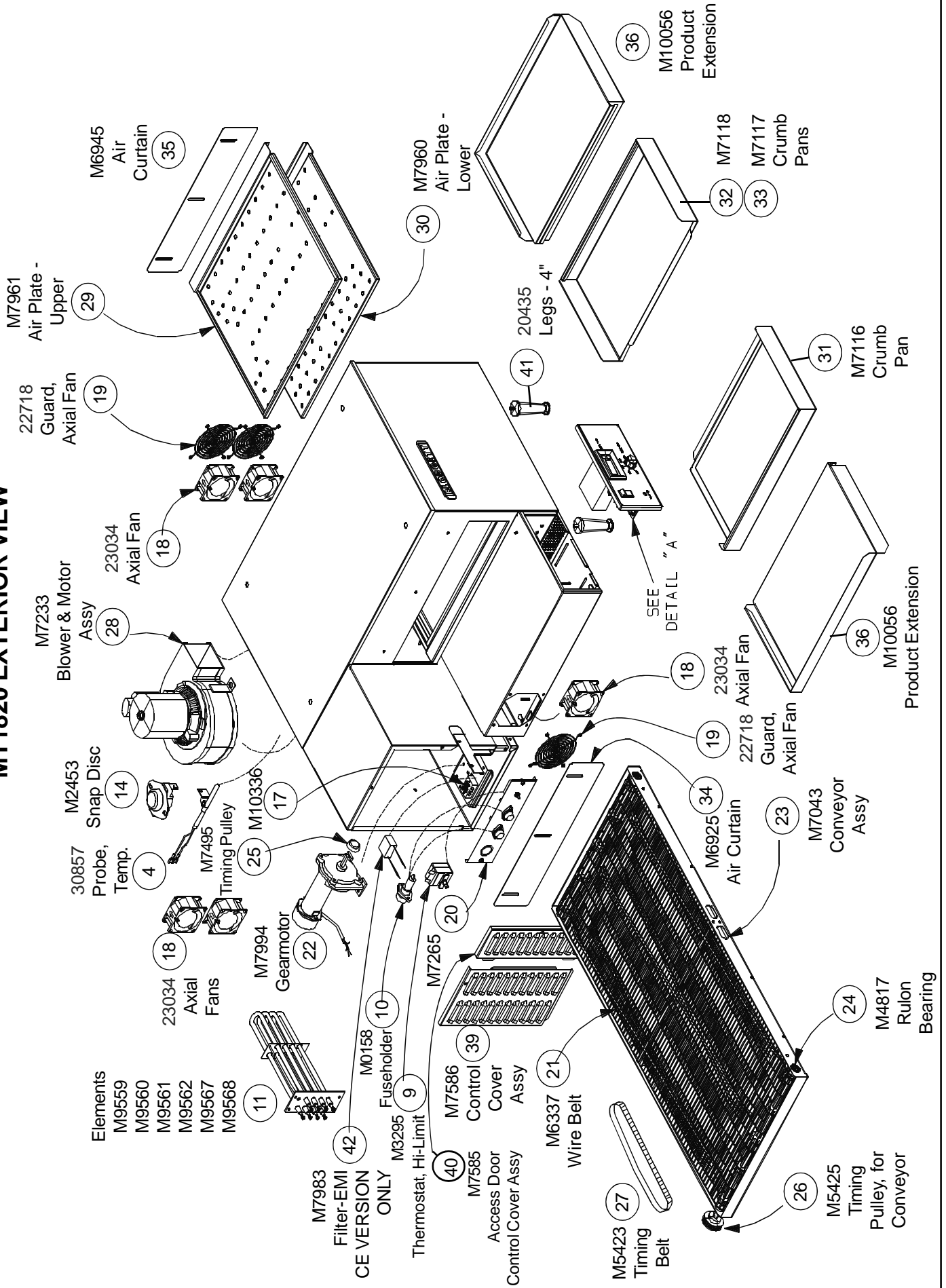

- Elements
- M9559
 - M9560
 - M9561
 - M9562
 - M9567
 - M9568

EXTERIOR COMPONENTS

<u>Ref. No.</u>	<u>Part No.</u>	<u>Description</u>
31	M7116	Crumb Pan, Drive (Qty 1)
32	M7118	Crumb Pan, Idle, Sgl Section (Qty 1)
33	M7117	Crumb Pan, Idle, Top Section (Vented) (Qty 1)
34	M6925	Air Curtain, Drive Side (Qty 1)
35	M6945	Air Curtain, Idle Side (Qty 1)
	M6792	Product Stop (Qty 1)
36	M10056	Product Extension, Drive & Idle Side (Qty 2 per oven)
38	M7568	Decal, Control Panel (w/o Fan Controls) (Qty 1)
39	M7586	Control Cover Assy. (Stationary) (Qty 1)
40	M7585	Access Door, Control Cover Assy. (Qty 1)
	M7651	Latch, Access Door (Qty 1)
	90086	Nameplate, Blodgett 7-3/4" (Qty 1)
	M7887	Pin, Stacking (Qty 4)
	M9084	Heat Shield Kit (Qty 1)
	M10119	Stacking Kit
	M7195	Chimney Kit, Sgl (Qty 1)
	M7196	Chimney Kit, Dbl (Qty 1)
	M4852	Body Back (Qty 1)
41	20435	Legs, 4" w/ Bolts, S/S (Set of 4)
	M5953	Stand, 24" S/S w/ Casters

EXCLUSIVE TO EXPORT

<u>Ref. No.</u>	<u>Part No.</u>	<u>Description</u>
37	M8518	Controller, Temperature Gen Exp & CE
3	M6811	Control, Minarik Closed Loop (Qty 1) Gen Exp & CE
5	M5446	Potentiometer, Control (Qty 1) Gen Exp & CE
38	M8537	Control Decal Gen Exp & CE
	M7862	Harness, Control Box CE
11	M9562	Element Assy., 230/400V, 3PH
11	M9567	Element Assy., 208V, 3PH (Qty 1)
11	M9568	Element Assy., 240V, 3PH (Qty 1)
7	M5447	Indicator Lamp, 250V (Qty 1) Gen Exp & CE
15	M6044	Snap Disc, L110-20F, 3 Pole (Qty 1) (Control Compartment) Gen Exp & CE
6	M6087	Knob, Low Profile (Qty 1) Gen Exp & CE
8	30465	Switch, Rocker DPDT Black (Qty 1) Gen Exp & CE
13	M6899	Transformer 208/240V
1	M7389	Timer, Solid State Off Delay, 5 AMP, 230V
	19634	Contact, Mercury 3 Pole, 30AMP
	M4542	Block, Power Terminal
	R0166	Block, Terminal Ground
42	M7983	Filter, EMI 20A, 250V, 50/60hz, 2 leads (Qty 1 in all CE ovens) CE
	M8521	Filter, EMI 2A, 50V, DC, 4 leads (Qty 1 in all CE ovens) CE
43	M7984	Capacitor, 250V (Qty 1) CE
	M7888	Relay, 1 Sec Delay CE
	M8592	Fuse, Gen Exp 5 AMP
	M3167	Fuseholder, Type HTB-36M
	M8660	Fuse, Gen Exp 2 AMP
	M8670	Fuse, Gen Exp 1.6 AMP
	M8559	Phase Conv. Kit 230V 1PH to 230/240V 3PH CE
	M8573	Phase Conv. Kit 1PH to 3PH NON CE

NOTE: Cord set is not available on CE ovens.