



**CO151F1818B
CO151FPUA12B
CO151FUA12B
RO151F1332B
RO151FUA18B**



**CO151H189B
CO151XUA5B
CO151X185B
CO151HUA6B**

SUBJECT	PAGE
INSTALLATI3, 4
OPERATING4, 5, 6
Illustra4
MAINTENANCE INSTRUCTIONS	
How to Clean the Unit	5
Trouble Shooting Guide	6
Replacement Parts	7, 8
Illustrations; Hot Unit.....	9, 10
Wiring Diagram	11, 12
STACKING INSTRUCTIONS.....	FL-2211
TIMER PROGRAMMING.....	FL-2222
SERVICE POLICY and AGENCY LIST	FL-1400

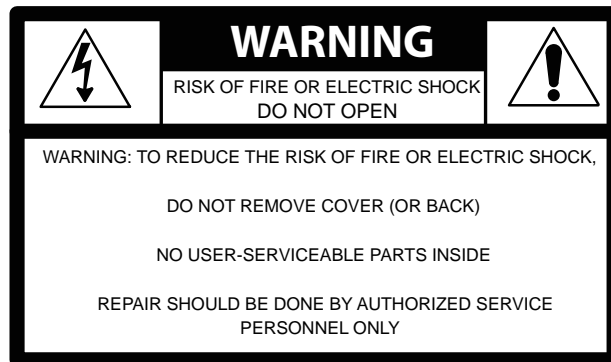

VENTING YOU

1. The purpose of capture smoke fumes.
2. Low temperature (250°F/121°C); grease-laden vented.

temperature ovens
C) as low-heat

odes. The
ement of
for making

UNIT SPECIFI

MODEL NOS.	ELECTRICAL SPECS (AC SERVICE)			ELEC. LOAD		POWER SUPPLY REQUIREMENT ALL 3 PHASE IS 3 WIRE + GROUND			
	Volts	Ph	Hz.	Amps	Volts	Amps	Ph	Volts	NEMA
CONVECTION OVENS									
CO151FUA12B2081	208	1	60	39	208	50	1	208	6-50P
CO151FUA12B2401	240	1	60	34	240	50	1	240	6-50P
CO151FUA12B2083	208	3	60	23	208	30	3	208	L15-30P
CO151FUA12B2403	240	3	60	20	240	30	3	240	L15-30P
CO151F1818B2081	208	1	60	39	208	50	1	208	6-50P
CO151F1818B2401	240	1	60	34	240	50	1	240	6-50P
CO151F1818B2083	208	3	60	23	208	30	3	208	L15-30P
CO151F1818B2403	240	3	60	20	240	30	3	240	L15-30P
RETHERM OVENS									
RO151FUA18B2081	208	1	60	39	208	50	1	208	6-50P
RO151FUA18B2401	240	1	60	34	240	50	1	240	6-50P
RO151FUA18B2083	208	3	60	23	208	30	3	208	L15-30P
RO151FUA18B2403	240	3	60	20	240	30	3	240	L15-30P
RO151F1332B2081	208	1	60	39	208	50	1	208	6-50P
RO151F1332B2401	240	1	60	34	240	50	1	240	6-50P
RO151F1332B2083	208	3	60	23	208	30	3	208	L15-30P
RO151F1332B2403	240	3	60	20	240	30	3	240	L15-30P
HALF-SIZE OVENS Are rated at 4700 watts (Three [3] heaters at 1470 watts each)									
CO151HUA6B2081	208	1	60	23	208	30	1	208	6-30P
CO151HUA6B2401	240	1	60	20	240	30	1	240	6-30P
CO151HUA6B2083	208	3	60	13	208	20	3	208	L15-20P
CO151HUA6B2403	240	3	60	12	240	20	3	240	L15-20P
CO151H189B2081	208	1	60	23	208	30	1	208	6-30P
CO151H189B2401	240	1	60	20	240	30	1	240	6-30P
CO151H189B2083	208	3	60	13	208	20	3	208	L15-20P
CO151H189B2403	240	3	60	12	240	20	3	240	L15-20P
CO151XUA5B2081	208	1	60	23	208	30	1	208	6-30P
CO151XUA5B2401	240	1	60	20	240	30	1	240	6-30P
CO151XUA5B2083	208	3	60	13	208	20	3	208	L15-20P
CO151XUA5B2403	240	3	60	12	240	20	3	240	L15-20P
CO151X185B2081	208	1	60	23	208	30	1	208	6-30P
CO151X185B2401	240	1	60	20	240	30	1	240	6-30P
CO151X185B2083	208	3	60	13	208	20	3	208	L15-20P
CO151X185B2403	240	3	60	12	240	20	3	240	L15-20P

All models are designed for AC Service. Model numbers may have the letters: P, L, M, Z, T or S.

HOW TO INST

1. Remove all p
cabinet.
2. Position cabir
interior (pan s
3. Plug power c

hen unit is

180°F/82°C for



Stacking Installation.

OPERATING INSTRUCTIONS

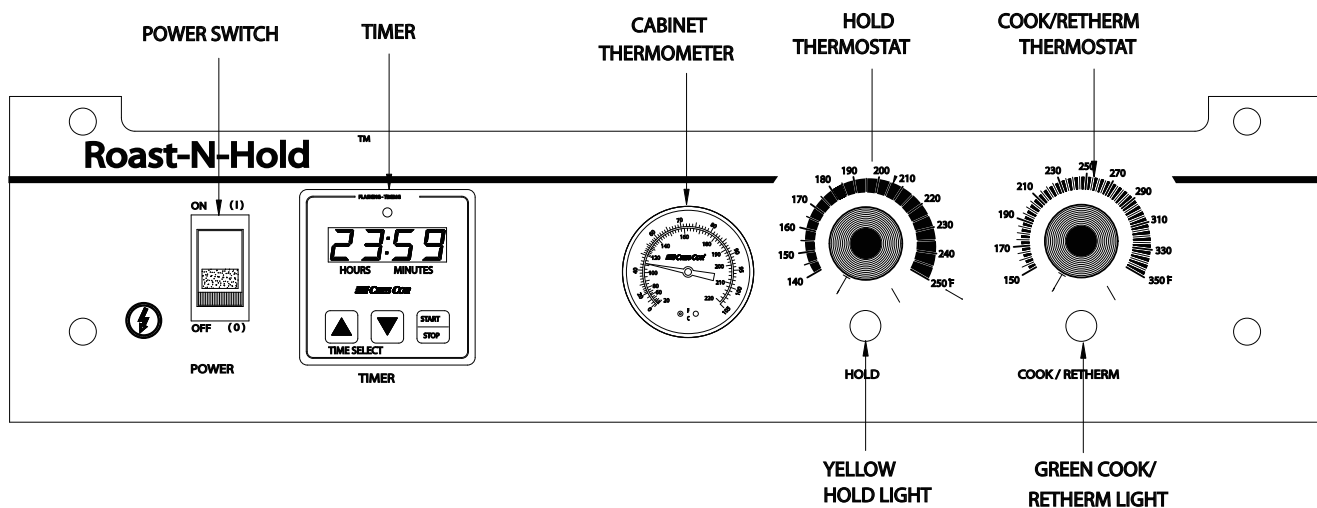

HOW TO SET TIMER:

- Press the **UP** arrow-button (on the TIMER) to increase the time. The longer the button is held down, the faster the time will increase. Pressing the **DOWN** arrow-button (using the same method) will cause the time to decrease.
- Press **START/STOP** button on Timer to begin cooking cycle. GREEN roast light will light up. Timer will count down to 0.00. The timing light on the timer will flash.
- Cooking time can be changed while oven is in any mode.
 - Press **START/STOP** button.
 - Adjust time by using **UP** and **DOWN** arrow-buttons.
 - Press **START/STOP** button to restart oven.

HOW TO START UNIT

(for first-time operation only)

A new oven needs to “burn off” factory oils and glue before it’s first use. **Do NOT load food into oven until this has been done!**

1. Push switch to “ON”.
2. Set the **Cook/Retherm** thermostats to 350°F/177°C.
3. Set the **Hold** thermostat to 150°F/66°C.
4. Set the timer to one (1) hour.
5. Allow oven to run automatically for one (1) hour of **Cook/Retherm** cycle and 30 minutes of **Hold** cycle.



HOW TO STAIN

(After first-time

Push **POWER** sw

For Automatic O

1. Set *Cook/Retl* temperature y
2. Set *Hold* ther need. Proper 1 or higher.
3. Set *Timer* for the roasting time. The unit will automatically switch to the pre-set “hold” temperature after roasting time has expired.

to 180°F/82°C for

When unit is operat-

are you need.

NOTE: Ventilating fans will continue to run until cabinet is cool. Do **NOT** disconnect the power supply to the cabinet while the ventilating fan is still operating.

HOW TO CLEAN THE UNIT:



BEFORE cleaning the cabinet:

1. **Unplug cord from wall. Allow cabinet to cool.**
2. **Do NOT hose cabinet with water.**
3. **Do NOT get water on controls.**
4. **Do NOT use abrasives or harsh chemicals.**
 - Wipe up spills as soon as possible.
 - Clean regularly to avoid heavy dirt build-up.

Cleaning Hints:

1. Use the mildest cleaning procedure that will do the job.
2. Always rub in the direction of polish lines to avoid scratching the surface.
3. Use only a soft cloth, sponge, fibrous brushes, plastic or stainless steel pads for cleaning and scouring.
4. Rinse thoroughly with fresh water after every cleaning operation.
5. Always wipe dry to avoid water marks.

	SOIL	CLEANER	METHOD
CABINET Inside and Outside (Stainless Steel)	Routine Cleaning	Soap, ammonia or mild detergent* and water.	1. Sponge on with cloth 2. Rinse
	Stubborn Spots, Stains	Mild abrasive made for Stainless Steel.	1. Apply with damp sponge or cloth. 2. Rub lightly.
	Burnt on Foods or Grease	Chemical oven cleaner made for Stainless Steel.	Follow oven cleaner manufacturer’s directions.
	Hard Water Spots & Scale	Vinegar	1. Swab or wipe with cloth. 2. Rinse and dry.
*MILD DETERGENTS INCLUDE SOAPS AND NON-ABRASIVE CLEANERS.			



IF _____ ;T

If hot unit is *NOT* working, first check the following causes:

- | | |
|--|---|
| 1. Cord is unplugged from wall outlet. | 3. Switch is turned off. |
| 2. Circuit breaker/fuse to wall outlet is blown. | 4. Thermostat is turned off, or is set too low. |

PROBLEM	POSSIBLE CAUSE	SOLUTION
Cabinet does not heat, or doesn't heat properly	1. Fuse 2. Control 3. Sensor 4. Heater contactor 5. Loose wiring at heater contactor 6. On/Off Switch	1. Replace 2. Replace 3. Replace 4. Replace 5. Replace 6. Replace
Blowers do not operate	1. On/Off Switch 2. Fuse 3. Blower	1. Replace 2. Replace 3. Replace
Heaters will not shut off	1. Thermostat defective 2. Contactor defective	1. Replace 2. Replace
Vent fans do not shut off	1. Vent fan switch defective 2. Control compartment is still hot.	1. Replace 2. Wait until it cools Check "Heaters will not shut off"
Vent fans do not operate (See Note)	1. Fuse 2. Vent fan switch defective 3. Vent fan defective	1. Replace 2. Replace 3. Replace

NOTE: Vent fans will not operate until the control compartment requires ventilation to limit temperatures. Replacement of electrical components must be done by a qualified electrician. Refer to our *Service Agency list, FL-1400* (found in the back of this manual), of authorized service centers. Instructions for replacing parts are included in replacement parts list.



Hot Unit Replacement Parts

ITEM DESCRIPTION	Part No.	ITEM DESCRIPTION	Part No.
1. Switch (On/Off)	0808-113-01-K	PARTS for 8200W, 1-PH UNITS	
2. Timer, Digital	0849-088-K	19. Power Cord	0810-124
Timer, Digital with Transformer	0849-088-K2	Power Cord (Pass-thru)	0810-161
3. Knob, Thermostat	0595-061	20. Heater Kit, 208V	0811-261
3. Control Board Kit	0848-057-K3	Heater Kit, 240V	0811-262
Potentiometer Only	0848-057-04	21. Strain Relief	0818-061
4. Pilot Light, Yellow	0766-095	PARTS for 8200W, 3-PH UNITS	
5. Pilot Light, Green	0766-097	19. Power Cord	0810-132
6. Thermometer	5238-031	Power Cord (Pass-thru)	0810-162
7. Vent Fan	0769-174	20. Heater Kit, 208V	0811-261
8. Fan Guard	0769-167	Heater Kit, 240V	0811-262
9. Fuse (Before 7/08)	0807-058	21. Strain Relief	0818-050
Fuse Holder (Before 7/08)	0807-048	PARTS for 4700W, 1-PH UNITS	
Fuse	0807-151	19. Power Cord	0810-163
Fuse Holder	0807-150	20. Heater Kit, 240V	0811-020-K
10. Blower Kit	0769-182-K	Heater Kit, 208V	0811-020-01-K
11. Contactor	0857-026	21. Strain Relief	0818-050
12. Terminal Block, Front	0852-096	PARTS for 4700W, 3-PH UNITS	
13. Terminal Block	0852-093	19. Power Cord	0810-164
14. Switch, Fan	0848-034	20. Heater Kit, 240V	0811-020-K
15. Relay, Timer	0857-102	Heater Kit, 208V	0811-020-01-K
16. Hi-Limit (Switch)	0848-079	21. Strain Relief	0818-050
17. Sensor Only	0848-058-K1		
Sensor Bushing	0818-014		
18. Transformer	0769-159		

DESCRIPTION					-F1332
	Hot Unit, 208V, 1				
Hot Unit, 240V, 1 Ph	HU675018	HU675063	HU675022		HU675059
Hot Unit, 208V, 3 Ph	HU675019	HU675064	HU675023		HU675060
Hot Unit, 240V, 3 Ph	HU675020	HU675065	HU675024		HU675061
Door Latch Kit	1006-120-01-K	1006-120-01-K	1006-120-01-K		1006-120-01-K
Latch Strike	1006-120-02-K	1006-120-02-K	1006-120-02-K		1006-120-02-K
Door Hinge	0519-074-K	0519-074-K	0519-074-K		0519-074-K
Door Assembly	1221-525-K	1221-525-K	1221-541-K		1221-543-K
Door Gasket	0861-185-K	0861-185-K	0861-197-K		0861-184
Interior	0621-281-K	0621-281-K	1104-106		1104-108
Side Handles (2), Black Recessed	0911-102	0911-102	0911-102		0911-102

HALF-SIZE CABINET REPLACEMENT PARTS

DESCRIPTION	MODEL PREFIX CO-151 or RO-151			
	-HUA, (6B)	-H18 (9B)	-X185B	-XUA5B
Hot Unit, 208V, 1 Ph	HU675033	HU675041	HU675041	HU675033
Hot Unit, 240V, 1 Ph	HU675034	HU675042	HU675042	HU675034
Hot Unit, 208V, 3 Ph	HU675035	HU675043	HU675043	HU675035
Hot Unit, 240V, 3 Ph	HU675036	HU675044	HU675044	HU675036
Door Latch Kit	1006-120-01-K	1006-120-01-K	1006-120-01-K	1006-120-01-K
Latch Strike	1006-120-02-K	1006-120-02-K	1006-120-02-K	1006-120-02-K
Door Hinge	0519-074-K	0519-074-K	0519-074-K	0519-074-K
Door Assembly	1221-525-K	1221-541-K	1221-546-K	1221-545-K
Door Gasket	0861-185-K	0861-197-K	0861-251	0861-250-K
Interior	0621-281-K	1104-106	1104-107	0621-281-K

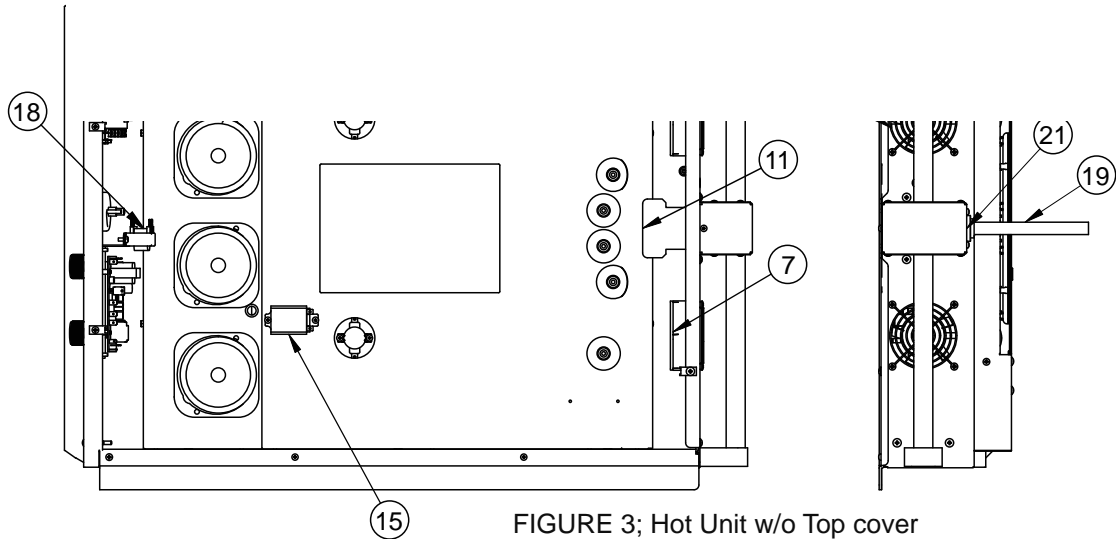

FIGURE 3; Hot Unit w/o Top cover
(For parts description, refer to page 7.)

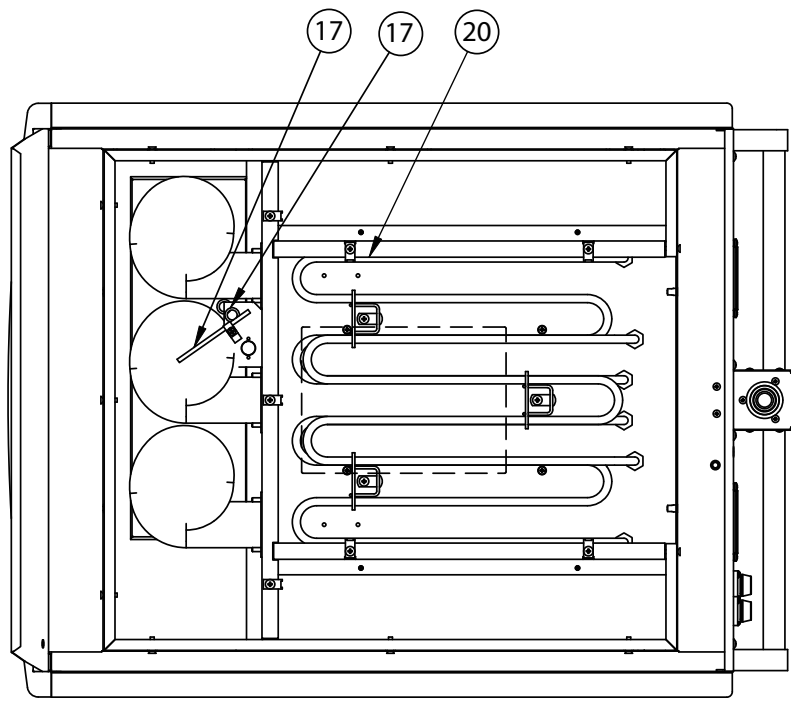

FIGURE 4; Bottom of Hot Unit, Cover Removed
(For parts description, refer to page 7.)

ft

S

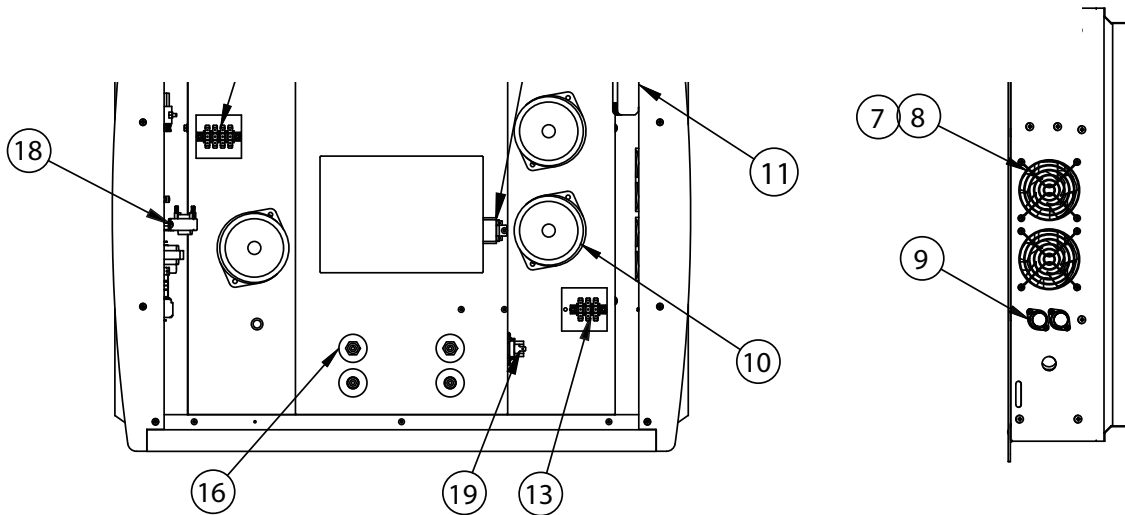

FIGURE 3; Hot Unit w/o Top cover
(For parts description, refer to page 7.)

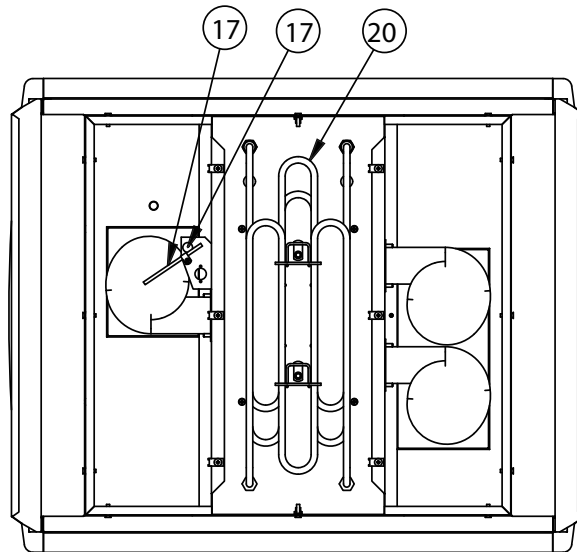
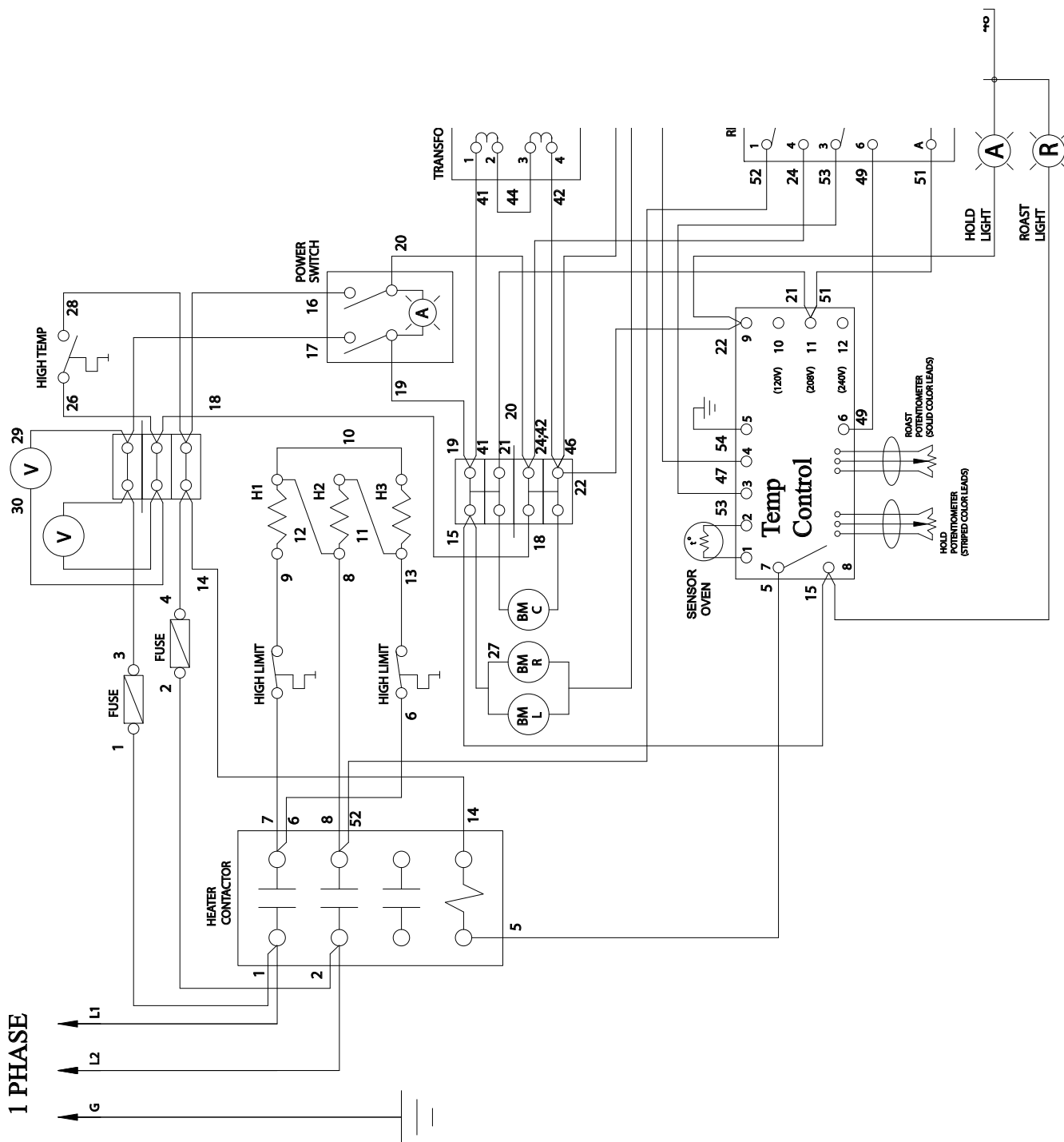

FIGURE 4; Bottom of Hot Unit, Cover Removed
(For parts description, refer to page 7.)



SINGLE PHASE

