

Replacement Parts for Single Deck Dual Control Valve

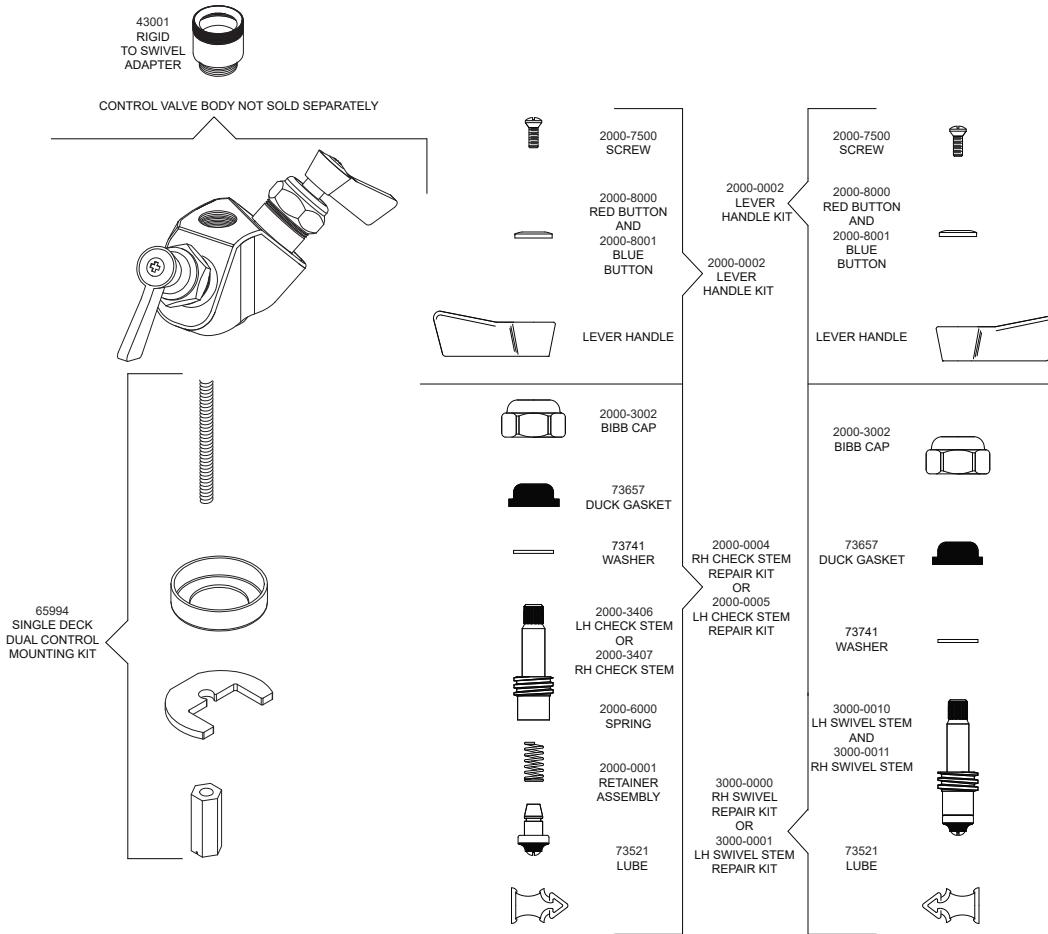

CVHB-RO-SDDL Product Installation Guide



73557 SINGLE DECK DUAL CONTROL HOSE 1/2" F INLET



Since 1936, Fisher Manufacturing Company has manufactured heavy-duty, high quality plumbing products and hardware specialties for the food service industry. For three generations, the Fisher family has adhered to a strict dedication of and overall value. When you install Fisher products... you install the best. Our hardware is manufactured with the standardization of internal mechanisms. All chrome plating is triple plated copper, nickel and chrome for durability. Every piece of equipment we make is rigorously tested in both our modern in-house testing center and in actual field situations under extreme conditions. Every detail is thoroughly checked. Before we make our products available to you, they pass each and every test. You get proven performance. Guaranteed.

Limited One Year Warranty

Fisher Manufacturing Company warrants its products and parts thereof (except as noted below) against defects in materials or workmanship for a period of one year after the date of original purchase. During this period Fisher Manufacturing Company will replace a defective product or part without charge to you, provided that the entire product is delivered to Fisher Manufacturing Company. All transportation and insurance charges for shipping the product to and from Fisher Manufacturing Company must be borne by you. Charges for transportation and insurance may, at the option of Fisher Manufacturing Company, be refunded depending upon our investigation of the warranty claim. This warranty does not cover external finish (except at date of original purchase) or labor costs not specifically authorized by Fisher Manufacturing Company.

A full and complete copy of our One Year limited warranty is available upon request.

Warning: This product can expose you to chemicals including Lead, Nickel (Metallic), Di(2-ethylhexyl) phthalate (DEHP) which are known to the State of California to cause cancer, and Lead, Di(2-ethylhexyl) phthalate (DEHP) which are known to the State of California to cause birth defects or reproductive harm.

For more information go to:

www.P65Warnings.ca.gov.



#13064 - Single Deck Dual Control Valve with Swivel Outlet

#13072 - Single Deck Dual Control Valve with Swivel Outlet and Check Valves

#10529 - Single Deck Dual Control Valve with 3/8" Female Outlet

#13080 - Single Deck Dual Control Valve with 3/8" Female Outlet and Check Valves

KEEP THIS MANUAL FOR FUTURE REFERENCE



ANSI/A112.18.1M, ANSI/NSF 61.9

FISHER MANUFACTURING COMPANY - TOLL FREE: 800-421-6162 FAX: 800-832-8238

Installation Instructions for Single Deck Dual Control Valves

BE SURE TO CHECK WITH YOUR LOCAL DEPARTMENT HAVING JURISDICTION REGARDING BACKFLOW PREVENTION

Installation Notes:

- Be sure to shut off water supply before beginning.
- Use pipe thread sealant such as PST on all threaded joints.
- Check the packaging for missing items BEFORE beginning installation. If items are missing, contact your supplier.

Tools Required for Installation

- Medium Sized Crescent Wrenches
- Pipe Thread Sealant
- 1-1/4" Drill Bit
- Plumbers Tape or Pipe Thread Sealant



Installation of Single Deck Dual Control

1. Drill 1-1/4" rough in hole through the deck where the control valve is to be mounted.
2. Screw the thread shank into the body. Hold the body over the deck hole.
3. Insert the HOT and COLD hoses through the cup washer.
4. Insert both hoses through the deck hole (as shown). Using thread sealant, screw the "COLD" hose into the body.
5. Using thread sealant, screw the HOT hose into the body.
6. (Shown from rear) Push the body down into the deck hole and lift the cup washer up against the deck.
7. (Shown from rear) Lift up the horseshoe washer over the threaded shank, then screw the nut onto the threadshank and up to support the horseshoe washer and the cup washer. Tighten nut until the body is secure in place on the deck.
8. Using washers and thread sealant, connect HOT and COLD supply lines to source. Check for leaks.

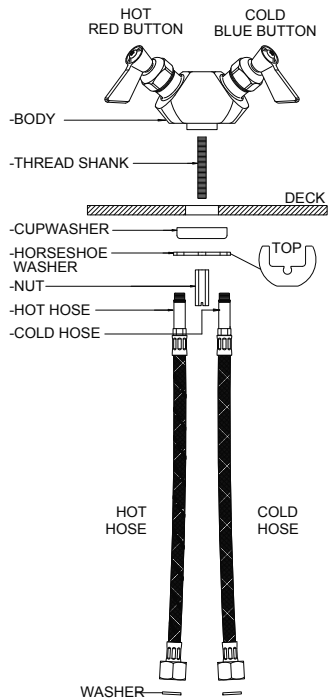

Step 1

(Rough-In)

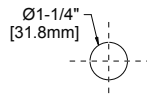

Installation Instructions Continued

Step 2

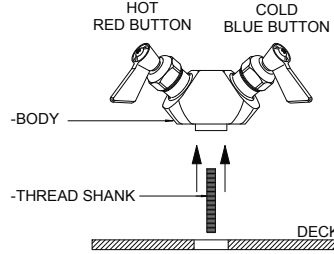

Step 3

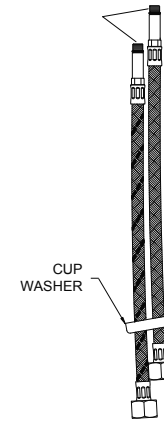

Step 4

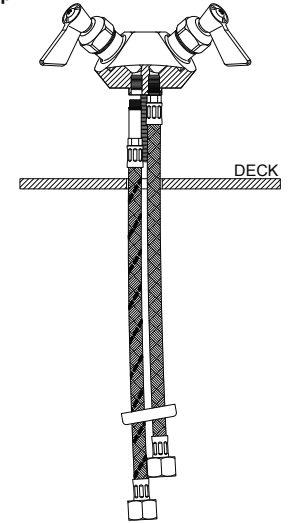

Step 6

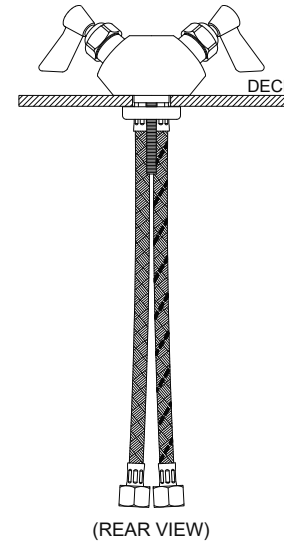

Step 5

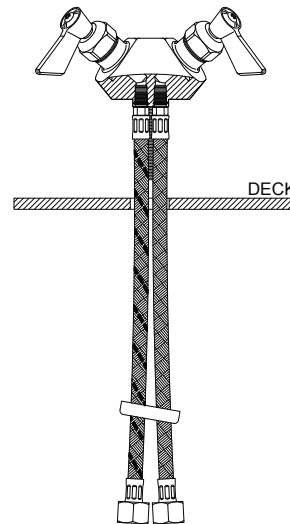

Step 7 & 8

