

FISHER

FISHER MANUFACTURING COMPANY

VOICE: 800-421-6162 • FAX: 800-832-8238

Glass Filler - Components and Options

[Return to Glass Filler - Components and Options](#)

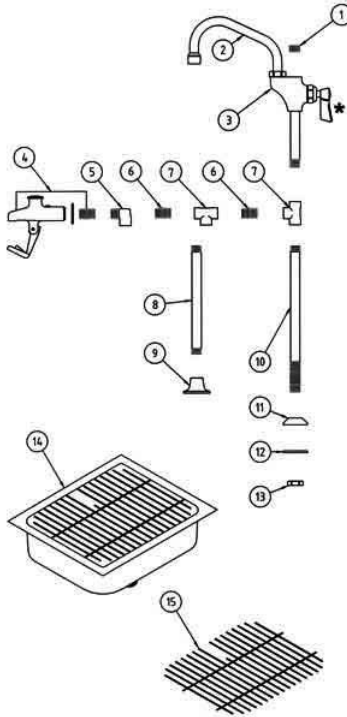

1	1000-3309	3/8" PLUG
2	3960	6" SWING SPOUT
	3961	8" SWING SPOUT
	3962	10" SWING SPOUT
	3963	12" SWING SPOUT
	3964	14" SWING SPOUT
	3967	16" SWING SPOUT
3	2901-0001	ADD-ON CONTROL VALVE WITH 2" RISER
	3000-0000	STEM RH 1/2" SWIVEL REPAIR KIT
4	10200	3/8" FEMALE GLASS FILLER HEAD WITH 3/8" CLOSE NIPPLE AND FLANGE
	11347	REPAIR KIT FOR GLASS FILLER
5	2400-3300	3/8" MALE X 3/8" FEMALE STREET ELBOW - POLISHED CHROME
6	1000-3418	3/8" CLOSE NIPPLE - ROUGH CHROME
7	1000-3303	3/8" FEMALE X 3/8" FEMALE X 3/8" FEMALE TEE - POLISHED CHROME
8	2901-8300	RISER, 2", 3/8" NPT ON BOTH ENDS
	2901-8301	RISER, 4-1/2", 3/8" NPT ON BOTH ENDS
	1001-4307	RISER, 8", 3/8" NPT ON BOTH ENDS
	3336	RISER, 10", 3/8" NPT ON BOTH ENDS
	2927-4302	RISER, 12", 3/8" NPT ON BOTH ENDS
	2927-4303	RISER, 16", 3/8" NPT ON BOTH ENDS
	2927-4300	RISER, 21", 3/8" NPT ON BOTH ENDS
	2113-4301	RISER, 25", 3/8" NPT ON BOTH ENDS
	2927-4301	RISER, 31", 3/8" NPT ON BOTH ENDS
9	1000-2304	SINGLE DECK BASE WITH 3/8" FEMALE OUTLET AND 3/8" FEMALE INLET
	1000-2305	SINGLE DECK BASE WITH 3/8" FEMALE OUTLET AND 1/2" FEMALE INLET
10	1000-4305	8" GLASS FILLER RISER
	1116-4300	10" GLASS FILLER RISER
	1116-4301	12" GLASS FILLER RISER
	9106-4300	14" GLASS FILLER RISER
11	1000-3321	BASE FOR GLASS FILLER
12	1000-5012	WASHER 0.702" X 1-3/4"
13	3042-3004	3/8" LOCKNUT
14	1403	SINK ASSEMBLY WITH DRAIN HOLE - STAINLESS

STEEL
1400-0000 SINK ASSEMBLY WITH
DRAIN AND PEDESTAL
GLASS FILLER SHANK
HOLE - STAINLESS STEEL

15 1400-8503 GRILL

* Optional handles available
Vandal Resistant Kit available