

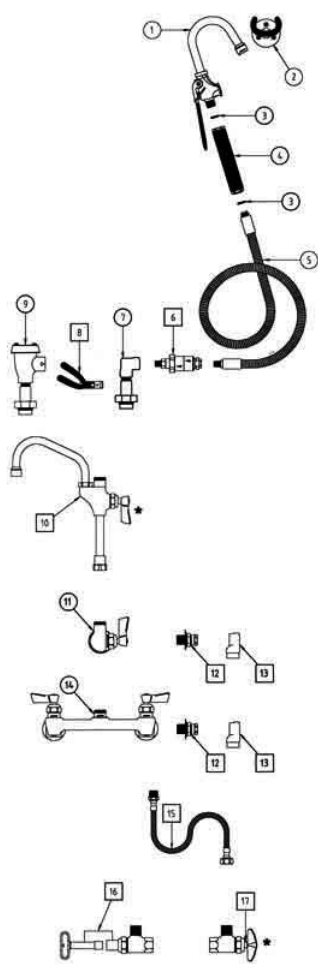

FISHER MANUFACTURING COMPANY  
 VOICE: 800-421-6162 • FAX: 800-832-8238

## Pot Filler - Wall Mount - Components and Options

[Return to Pot Filler - Wall Mount - Components and Options](#)



- |           |           |  |
|-----------|-----------|--|
| <b>1</b>  | 11061     | POT FILLER VALVE   |
|           | 11355     | REPAIR KIT FOR SPRAY VALVE                                     |
| <b>2</b>  | 2907      | WALL HOOK  |
| <b>3</b>  | 2922-5000 | HANDLE GASKET  |
| <b>4</b>  | 2913      | INSULATED HANDLE   |
| <b>5</b>  | 2915-FG   | FOOD GRADE HOSE 60" LONG                                       |
|           | 12289     | FOOD GRADE HOSE 12" LONG                                       |
|           | 12297     | FOOD GRADE HOSE 15" LONG                                       |
|           | 12300     | FOOD GRADE HOSE 18" LONG                                       |
|           | 12319     | FOOD GRADE HOSE 21" LONG                                       |
|           | 12327     | FOOD GRADE HOSE 24" LONG                                       |
|           | 12335     | FOOD GRADE HOSE 27" LONG                                       |
|           | 12343     | FOOD GRADE HOSE 30" LONG                                       |
|           | 2914-FG   | FOOD GRADE HOSE 36" LONG                                       |
|           | 12351     | FOOD GRADE HOSE 42" LONG                                       |
|           | 12378     | FOOD GRADE HOSE 48" LONG                                       |
|           | 12386     | FOOD GRADE HOSE 54" LONG                                       |
|           | 12394     | FOOD GRADE HOSE 72" LONG                                       |
|           | 12408     | FOOD GRADE HOSE 84" LONG                                       |
|           | 12416     | FOOD GRADE HOSE 96" LONG                                       |
|           | 12424     | FOOD GRADE HOSE 108" LONG                                      |
|           | 12432     | FOOD GRADE HOSE 120" LONG                                      |
|           | 12440     | FOOD GRADE HOSE 132" LONG                                      |
|           | 12459     | FOOD GRADE HOSE 144" LONG                                      |
| <b>6</b>  | 2542      | BACKFLOW PREVENTER   |
| <b>7</b>  | 2931      | SWIVEL HOSE ADAPTER WITH 1/4" FEMALE OUTLET                    |
| <b>8</b>  | 2943      | PIPE HOOK  |
| <b>9</b>  | 2932      | SWIVEL HOSE ADAPTER WITH 1/4" FEMALE OUTLET AND VACUUM BREAKER |
| <b>10</b> | 2771      | ADD-ON FAUCET WITH 6" SWING SPOUT AND SWIVEL OUTLET            |
|           | 2798      | ADD-ON FAUCET WITH 8" SWING SPOUT AND SWIVEL OUTLET            |
|           | 2801      | ADD-ON FAUCET WITH 10"   |

		SWING SPOUT AND SWIVEL OUTLET
2828		ADD-ON FAUCET WITH 12" SWING SPOUT AND SWIVEL OUTLET
2836		ADD-ON FAUCET WITH 14" SWING SPOUT AND SWIVEL OUTLET
2844		ADD-ON FAUCET WITH 16" SWING SPOUT AND SWIVEL OUTLET
3000-0000		STEM RH 1/2" SWIVEL REPAIR KIT
<b>11</b>	3700	SINGLE WALL CONTROL VALVE WITH SWIVEL OUTLET
	3000-0000	STEM RH 1/2" SWIVEL REPAIR KIT
<b>12</b>	2200-0000	1/2" X 1-1/4" NIPPLE WITH LOCKNUT, WASHER AND SLIP JOINT KIT
<b>13</b>	2400-2103	1/2" ELBOW
<b>14</b>	3200-CV	8" ADJ WALL CONTROL VALVE WITH SWIVEL OUTLET AND CHECK STEMS
	2000-0004	HOT STEM RH 1/2" CHECK REPAIR KIT
	2000-0005	COLD STEM LH 1/2" CHECK REPAIR KIT
<b>15</b>	10049	SS SUPPLY LINE 1/2" MALE X 1/2" FEMALE X 24" LONG
	10006	SS SUPPLY LINE 1/2" FEMALE X 1/2" MALE X 36" LONG
<b>16</b>	1792	ANGLE STOP WITH KEY STOP, POLISHED CHROME 1/2"M x 1/2"F
<b>17</b>	1790-1	ANGLE STOP WITH CROSS HANDLE, POLISHED CHROME 1/2"M X 1/2"F
		* Optional handles available
		Vandal Resistant Kit available