

# FISHER

FISHER MANUFACTURING COMPANY

VOICE: 800-421-6162 • FAX: 800-832-8238

## Pot & Kettle Filler Faucets - 1/2" - Components and Options

Return to Pot & Kettle Filler Faucets - 1/2" - Components and Options

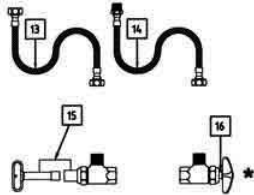
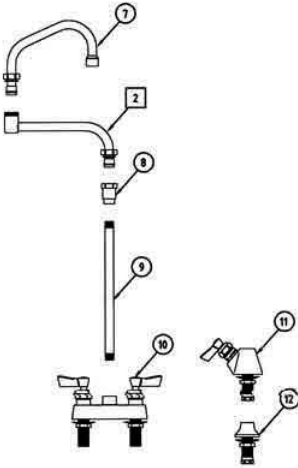
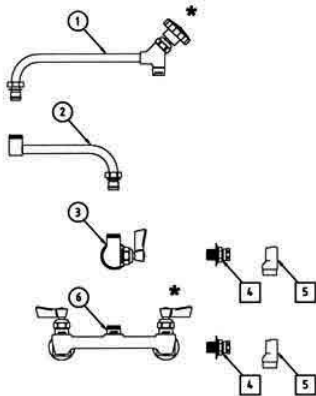

- |          |           |  |
|----------|-----------|--|
| <b>1</b> | 4000-0001 | 11" CONTROL SWING SPOUT                                      |
|          | 11010     | 8" CONTROL SWING SPOUT                                       |
|          | 3000-0000 | STEM RH 1/2" SWIVEL REPAIR KIT                               |
| <b>2</b> | 3000-0003 | 7-1/4" DJ MACHINED SUB ASSY.                                 |
| <b>2</b> | 3000-0003 | 7-1/4" DJ MACHINED SUB ASSY.                                 |
| <b>2</b> | 4000-0002 | 13" DJ MACHINED SUB ASSY.                                    |
| <b>2</b> | 4000-0002 | 13" DJ MACHINED SUB ASSY.                                    |
| <b>3</b> | 3700      | SINGLE WALL CONTROL VALVE WITH SWIVEL OUTLET                 |
|          | 3000-0000 | STEM RH 1/2" SWIVEL REPAIR KIT                               |
| <b>4</b> | 2200-0000 | 1/2" X 1-1/4" NIPPLE WITH LOCKNUT, WASHER AND SLIP JOINT KIT |
| <b>5</b> | 2400-2103 | 1/2" ELBOW   |
| <b>6</b> | 3200-CV   | 8" ADJ WALL CONTROL VALVE WITH SWIVEL OUTLET AND CHECK STEMS |
|          | 2000-0004 | HOT STEM RH 1/2" CHECK REPAIR KIT                            |
|          | 2000-0005 | COLD STEM LH 1/2" CHECK REPAIR KIT                           |
| <b>7</b> | 3960      | 6" SWING SPOUT   |
|          | 3961      | 8" SWING SPOUT   |
|          | 3962      | 10" SWING SPOUT  |
|          | 3963      | 12" SWING SPOUT  |
|          | 3964      | 14" SWING SPOUT  |
|          | 3967      | 16" SWING SPOUT  |
|          | 2002      | SNAP RING FOR SPOUTS   |
|          | 1600-5000 | O-RING FOR SPOUTS  |
| <b>8</b> | 4000-3300 | 3/8" FEMALE X FISHER SWIVEL MALE X POLISHED CHROME           |
| <b>9</b> | 2927-4300 | RISER, 21", 3/8" NPT ON BOTH ENDS                            |
|          | 2901-8300 | RISER, 2", 3/8" NPT ON BOTH ENDS                             |
|          | 2901-8301 | RISER, 4-1/2", 3/8" NPT ON BOTH ENDS                         |
|          | 1001-4307 | RISER, 8", 3/8" NPT ON BOTH ENDS                             |
|          | 3336      | RISER, 10", 3/8" NPT ON BOTH ENDS                            |
|          | 2927-4302 | RISER, 12", 3/8" NPT ON BOTH ENDS                            |
|          | 2927-4303 | RISER, 16", 3/8" NPT ON BOTH ENDS                            |
|          | 2113-4301 | RISER, 25", 3/8" NPT ON BOTH ENDS                            |
|          | 2927-4301 | RISER, 31", 3/8" NPT ON BOTH ENDS                            |

<b>10</b>	2500	4" CC DECK CONTROL VALVE WITH 3/8" FEMALE OUTLET
	3000-0000	HOT STEM RH 1/2" SWIVEL REPAIR KIT
	3000-0001	COLD STEM LH 1/2" SWIVEL REPAIR KIT
<hr/>		
<b>11</b>	12890	SINGLE DECK CONTROL VALVE RIGID, INLET 1/2"M X 2" LONG
	3000-0001	STEM LH 1/2" SWIVEL REPAIR KIT
<hr/>		
<b>12</b>	2903	SINGLE DECK BASE WITH 3/8" FEMALE OUTLET
<hr/>		
<b>13</b>	10014	SS SUPPLY LINE 1/2" FEMALE X 1/2" FEMALE X 24" LONG
	10022	SS SUPPLY LINE 1/2" FEMALE X 1/2" FEMALE X 36" LONG
<hr/>		
<b>14</b>	10049	SS SUPPLY LINE 1/2" MALE X 1/2" FEMALE X 24" LONG
	10006	SS SUPPLY LINE 1/2" FEMALE X 1/2" MALE X 36" LONG
<hr/>		
<b>15</b>	1792	ANGLE STOP WITH KEY STOP, POLISHED CHROME 1/2"M x 1/2"F
<hr/>		
<b>16</b>	1790-1	ANGLE STOP WITH CROSS HANDLE, POLISHED CHROME 1/2"M X 1/2"F
		* Optional handles available
		Vandal Resistant Kit available