

Heated Landing Zone Models HLZ 18, HLZ 22

Electrical Components

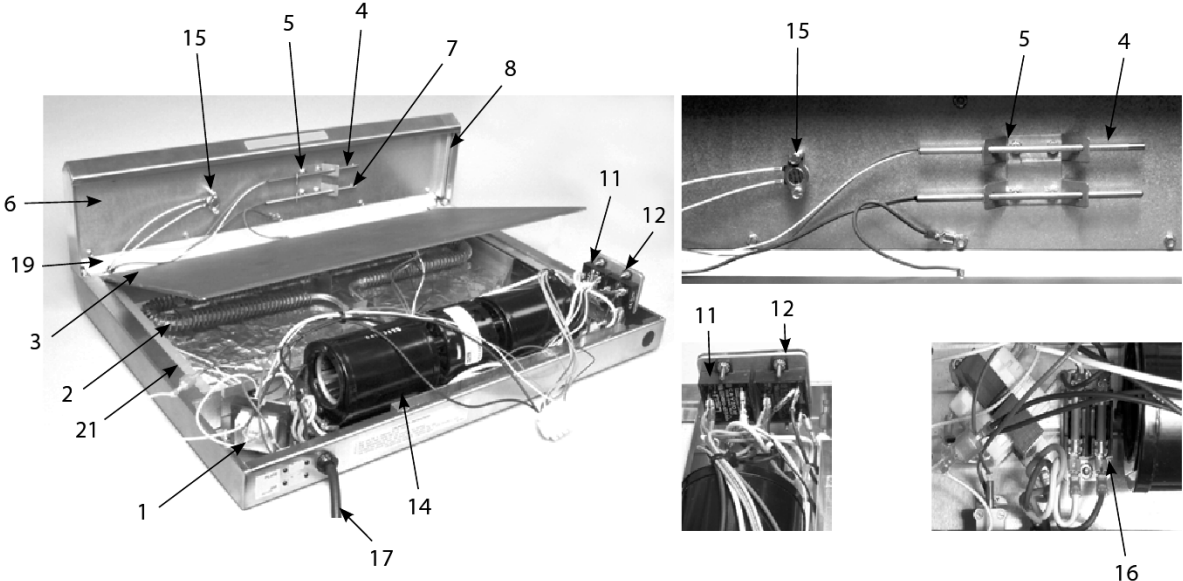

Heated Landing Zone Models HLZ 18, HLZ 22

Electrical Components

#	PART #	DESCRIPTION	QTY	Note
1	8070979	Transformer, 208V/240V/12V	1	
1a	8073185	Transformer 230V (CE)	1	
2	8261549	Air Heater, 208V	1	
2a	8073630	Air Heater 230V (CE)	1	
2b	8073011	Air Heater, 240V	1	
3	9008486	Shield, HLZ Heater	1	
4	8073036	Air RTD Probe	1	
5	9008366SP	Bracket, RTD/Thermocouple	1	
6	8232741	Delivery Air Back W/A	1	
7	8073043	Air Thermocouple	1	
8	8069238SP	HLZ 22 Plate, Heater with RTD and Thermocouple, 208V/240V (22"x15.5")	1	
8a	8069239SP	HLZ 18 Plate, Heater with RTD and Thermocouple, 208- 240V (22"x12")	1	
9	8072818	Line Filter (CE)	1	
10	8069636	Plug Assembly, Computer	1	
11	8262038	Air Relay, SS Service	1	
12	8261958	Plate Relay, SS Service	1	
13	8073021	Relay, Latching	1	
14	8073691	Blower, 230V (CE)	1	
14a	8261551	Blower, 208-240V	1	
15	8073631	Hi-Limit	1	
16	8072820	Fuse Block	1	
16a	8072819	Fuse, 20A	1	
17	8073020	Cordset, Twist Lock, HLZ	1	
17a	8071696	3-Wire with 3-Pin Sleeved Plug, 230V	1	
17b	8073419	Cordset, Japanese	1	
17c	8074409	Cordset, China	1	
18	8110511	RTV#108 Silicone Rubber	1	
19	8160418	Gasket, HLZ Plate/Cowl	1	
20	8101724	Filter Screen	1	
21	8111042	Acrylic Tape	1	
22	8262535	Controller Assembly, HLZ McD	1	
22a	8122277	Controller Assembly, SHS Generic	1	
23	8232745	Cowl Assembly	1	
23a	8090448	Clip, Tinnerman	1	
24	8232742	Front Delivery Air W/A	1	
25	8072972	Lug, Grounding 14 GA	1	
26	8261561	Pad, HLZ Leg	1	