



Decal Installation

Decal Installation Instructions

Follow the instructions below to install decals packed separately for a Nacho Cheese Dispenser (if applicable). Unit must be off, unplugged, and allowed to cool before attempting installation. General images are shown for reference purposes only (decals may vary by unit).

Items Needed for Installation:

- Set of Decals - for door, right and left panels, rear panel, and bottom panel (if applicable).
- Gold Medal Watchdog Glass Cleaner (Item No. 2588) or a **non-ammonia** type glass cleaner.
- Plastic squeegee, medium size applicator (type used for Bondo® filler).

Decal Location

Door Decal (PN 36054)
(precut for button)

Bottom Panel Decal (PN 36053 - if supplied)

Right Housing Decal (PN 36052)

Left Housing Decal (PN 36051)
(precut for thermometer)

Rear Panel Decal (PN 36055)

Thermometer

Decal Installation

For best results, **check decal alignment often** during installation.

Step 1: Hold decal up to mounting surface to determine decal placement.

Step 2: Apply glass cleaner to “wet” the surface where decal is to be placed (Figure A). **Do not wipe the glass cleaner off.**

Apply Glass Cleaner
(DO NOT wipe off)

Figure A



Decal Installation

Decal Installation Instructions

Follow the instructions below to install decals packed separately for a Nacho Cheese Dispenser (if applicable). Unit must be off, unplugged, and allowed to cool before attempting installation. General images are shown for reference purposes only (decals may vary by unit).

Items Needed for Installation:

- Set of Decals - for door, right and left panels, rear panel, and bottom panel (if applicable).
- Gold Medal Watchdog Glass Cleaner (Item No. 2588) or a **non-ammonia** type glass cleaner.
- Plastic squeegee, medium size applicator (type used for Bondo® filler).

Decal Location

Door Decal (PN 36054)
(precut for button)

Bottom Panel Decal (PN 36053 - if supplied)

Right Housing Decal (PN 36052)

Left Housing Decal (PN 36051)
(precut for thermometer)

Rear Panel Decal (PN 36055)

Thermometer

Decal Installation

For best results, **check decal alignment often** during installation.

Step 1: Hold decal up to mounting surface to determine decal placement.

Step 2: Apply glass cleaner to “wet” the surface where decal is to be placed (Figure A). **Do not wipe the glass cleaner off.**

Apply Glass Cleaner
(DO NOT wipe off)

Figure A



Decal Installation

Decal Installation Instructions

Follow the instructions below to install decals packed separately for a Nacho Cheese Dispenser (if applicable). Unit must be off, unplugged, and allowed to cool before attempting installation. General images are shown for reference purposes only (decals may vary by unit).

Items Needed for Installation:

- Set of Decals - for door, right and left panels, rear panel, and bottom panel (if applicable).
- Gold Medal Watchdog Glass Cleaner (Item No. 2588) or a **non-ammonia** type glass cleaner.
- Plastic squeegee, medium size applicator (type used for Bondo® filler).

Decal Location

Door Decal (PN 36054)
(precut for button)

Bottom Panel Decal (PN 36053 - if supplied)

Right Housing Decal (PN 36052)

Left Housing Decal (PN 36051)
(precut for thermometer)

Rear Panel Decal (PN 36055)

Thermometer

Decal Installation

For best results, **check decal alignment often** during installation.

Step 1: Hold decal up to mounting surface to determine decal placement.

Step 2: Apply glass cleaner to “wet” the surface where decal is to be placed (Figure A). **Do not wipe the glass cleaner off.**

Apply Glass Cleaner
(DO NOT wipe off)

Figure A



Decal Installation

Decal Installation Instructions

Follow the instructions below to install decals packed separately for a Nacho Cheese Dispenser (if applicable). Unit must be off, unplugged, and allowed to cool before attempting installation. General images are shown for reference purposes only (decals may vary by unit).

Items Needed for Installation:

- Set of Decals - for door, right and left panels, rear panel, and bottom panel (if applicable).
- Gold Medal Watchdog Glass Cleaner (Item No. 2588) or a **non-ammonia** type glass cleaner.
- Plastic squeegee, medium size applicator (type used for Bondo® filler).

Decal Location

Door Decal (PN 36054)
(precut for button)

Bottom Panel Decal (PN 36053 - if supplied)

Right Housing Decal (PN 36052)

Left Housing Decal (PN 36051)
(precut for thermometer)

Rear Panel Decal (PN 36055)

Thermometer

Decal Installation

For best results, **check decal alignment often** during installation.

Step 1: Hold decal up to mounting surface to determine decal placement.

Step 2: Apply glass cleaner to “wet” the surface where decal is to be placed (Figure A). **Do not wipe the glass cleaner off.**

Apply Glass Cleaner
(DO NOT wipe off)

Figure A



Decal Installation

Decal Installation Instructions

Follow the instructions below to install decals packed separately for a Nacho Cheese Dispenser (if applicable). Unit must be off, unplugged, and allowed to cool before attempting installation. General images are shown for reference purposes only (decals may vary by unit).

Items Needed for Installation:

- Set of Decals - for door, right and left panels, rear panel, and bottom panel (if applicable).
- Gold Medal Watchdog Glass Cleaner (Item No. 2588) or a **non-ammonia** type glass cleaner.
- Plastic squeegee, medium size applicator (type used for Bondo® filler).

Decal Location

Door Decal (PN 36054)
(precut for button)

Bottom Panel Decal (PN 36053 - if supplied)

Right Housing Decal (PN 36052)

Left Housing Decal (PN 36051)
(precut for thermometer)

Rear Panel Decal (PN 36055)

Thermometer

Decal Installation

For best results, **check decal alignment often** during installation.

Step 1: Hold decal up to mounting surface to determine decal placement.

Step 2: Apply glass cleaner to “wet” the surface where decal is to be placed (Figure A). **Do not wipe the glass cleaner off.**

Apply Glass Cleaner
(DO NOT wipe off)

Figure A



Product Installation and Removal

The dispenser is equipped with a Bag Support Tray to hold the bag of cheese in use, and an upper Cheese Bag Tray to hold a bag of cheese for pre-warming.

Add a Basket Liner (PN 100557) to each Bag Support Tray opening to provide cushion/support for a product bag with the small cap. Follow instructions below to install the liner and insert product.

Basket Liner Installation

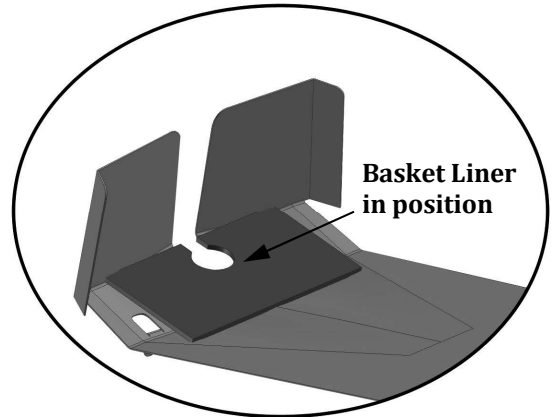

Inside view of Bag Support Tray

Step 1. Open the cabinet door and locate the Bag Support Tray. **Caution:** Tray may be hot when adding or changing the product.

Step 2. Position the Basket Liner in bag support opening as shown.

Product Installation

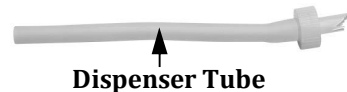

Step 1: Pull ring to remove fitting cover from a preheated product bag. Use a new dispenser tube (PN 5285) for each bag.

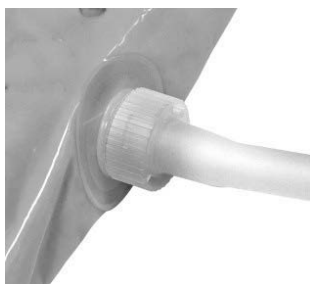

Step 2: The dispenser tube will pierce the inner seal of the bag when installed. Make sure the cap is securely threaded onto the bag fitting. **Caution:** Product may be hot.

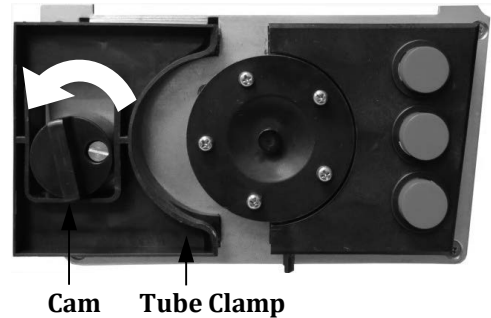

Step 3: Open the front door of the dispenser. Open the tube clamp by turning the cam counterclockwise.



Cabinet Front and Interior View

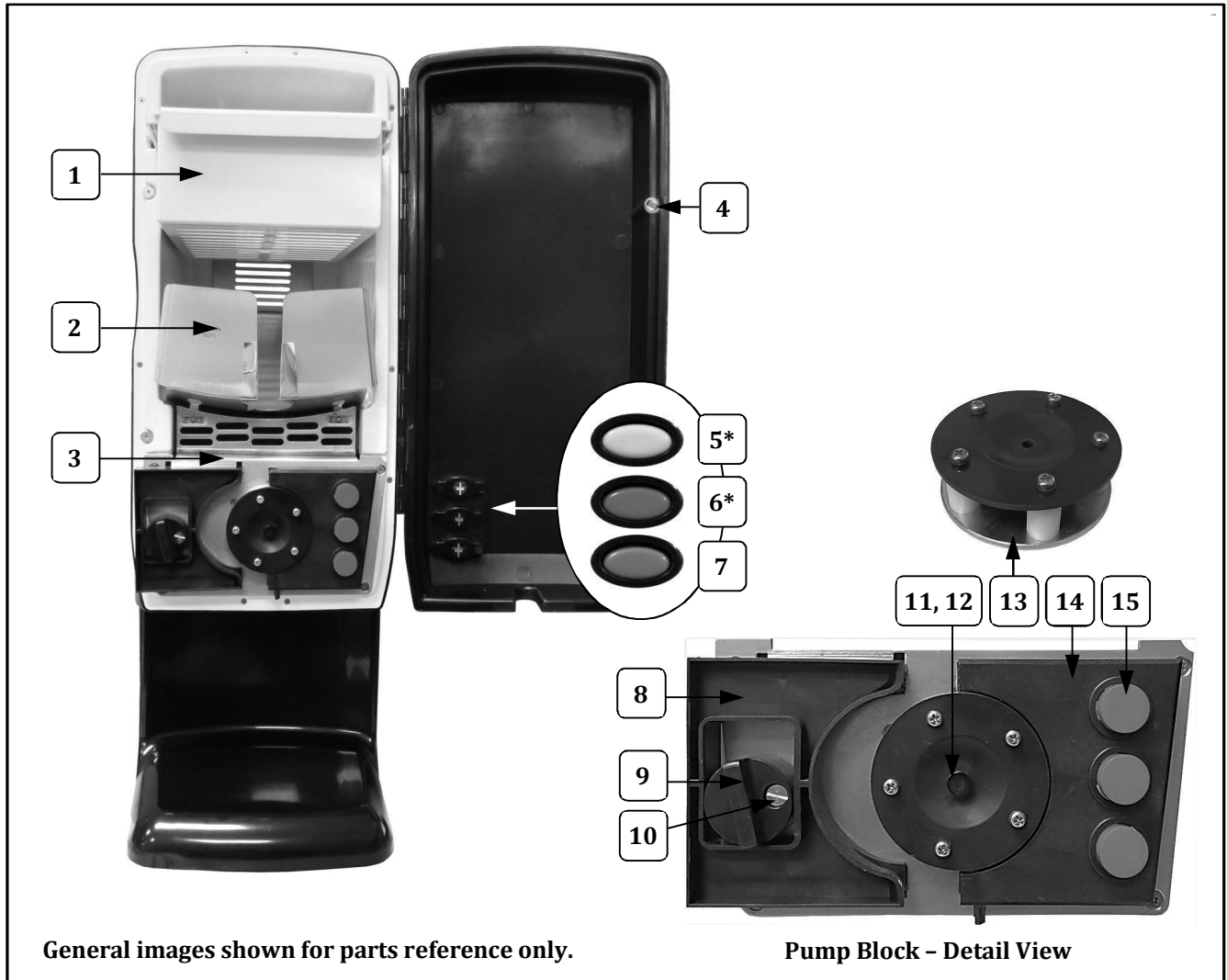

Item	Part Description	Part Number
		5300
1	CHEESE BAG TRAY	EN0008
2	CHEESE BAG SUPPORT	36027
3	SWITCH MOUNT PANEL	36029
4	DOOR MAGNET	36042
5	YELLOW BUTTON	36033YL
6	RED BUTTON	36033RD
7	ORANGE BUTTON	36033OR
8	SLIDING PUMP BLOCK	36031
9	PUMP CAM LOCK	36032
10	CAM M5 SLOTTED SCREW	77125
11	PUMP MOUNT THUMB SCREW	77122
12	M3-WASHER-SPRING	77130
13	PUMP HEAD ASSY 5 ROLLER	36105
14	PUMP BLOCK RIGHT-SWITCH	36030
15	SWITCH	36038



Cabinet Front and Interior View

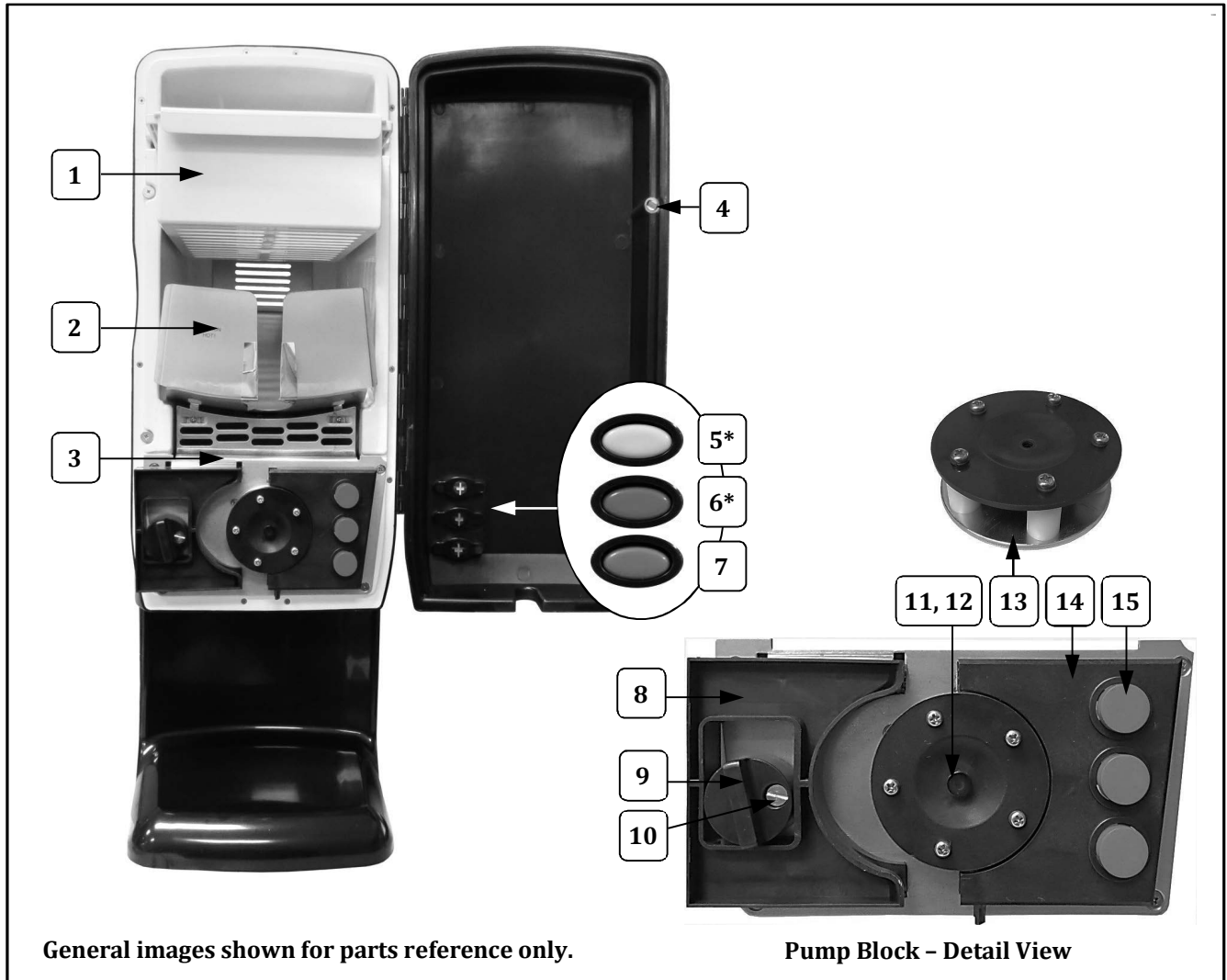

General images shown for parts reference only.

Pump Block - Detail View

Item	Part Description	Part Number
		5300
1	CHEESE BAG TRAY	EN0008
2	CHEESE BAG SUPPORT	36027
3	SWITCH MOUNT PANEL	36029
4	DOOR MAGNET	36042
5	YELLOW BUTTON	36033YL
6	RED BUTTON	36033RD
7	ORANGE BUTTON	36033OR
8	SLIDING PUMP BLOCK	36031
9	PUMP CAM LOCK	36032
10	CAM M5 SLOTTED SCREW	77125
11	PUMP MOUNT THUMB SCREW	77122
12	M3-WASHER-SPRING	77130
13	PUMP HEAD ASSY 5 ROLLER	36105
14	PUMP BLOCK RIGHT-SWITCH	36030
15	SWITCH	36038



Cabinet Front and Interior View

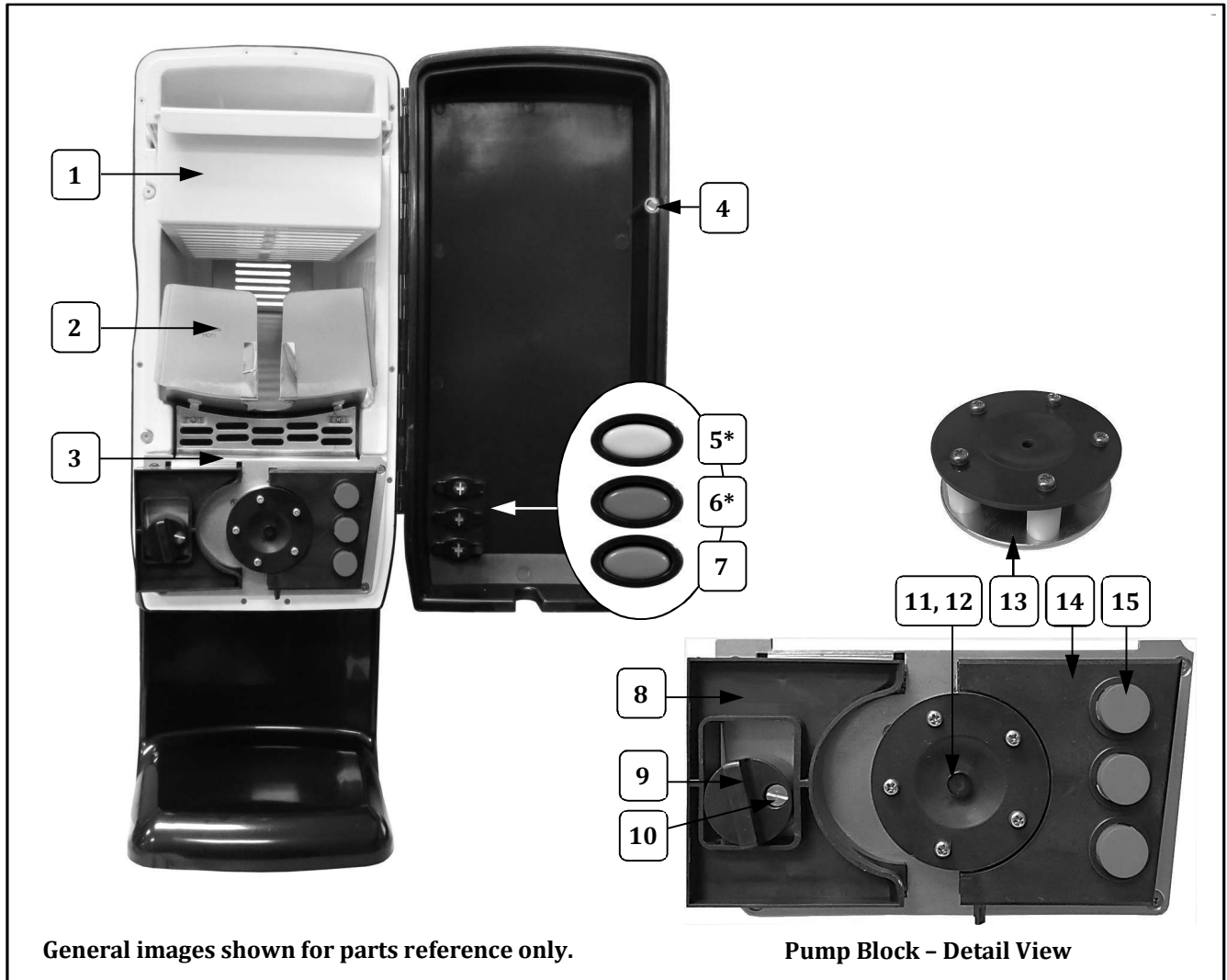

Item	Part Description	Part Number
		5300
1	CHEESE BAG TRAY	EN0008
2	CHEESE BAG SUPPORT	36027
3	SWITCH MOUNT PANEL	36029
4	DOOR MAGNET	36042
5	YELLOW BUTTON	36033YL
6	RED BUTTON	36033RD
7	ORANGE BUTTON	36033OR
8	SLIDING PUMP BLOCK	36031
9	PUMP CAM LOCK	36032
10	CAM M5 SLOTTED SCREW	77125
11	PUMP MOUNT THUMB SCREW	77122
12	M3-WASHER-SPRING	77130
13	PUMP HEAD ASSY 5 ROLLER	36105
14	PUMP BLOCK RIGHT-SWITCH	36030
15	SWITCH	36038



Cabinet Front and Interior View

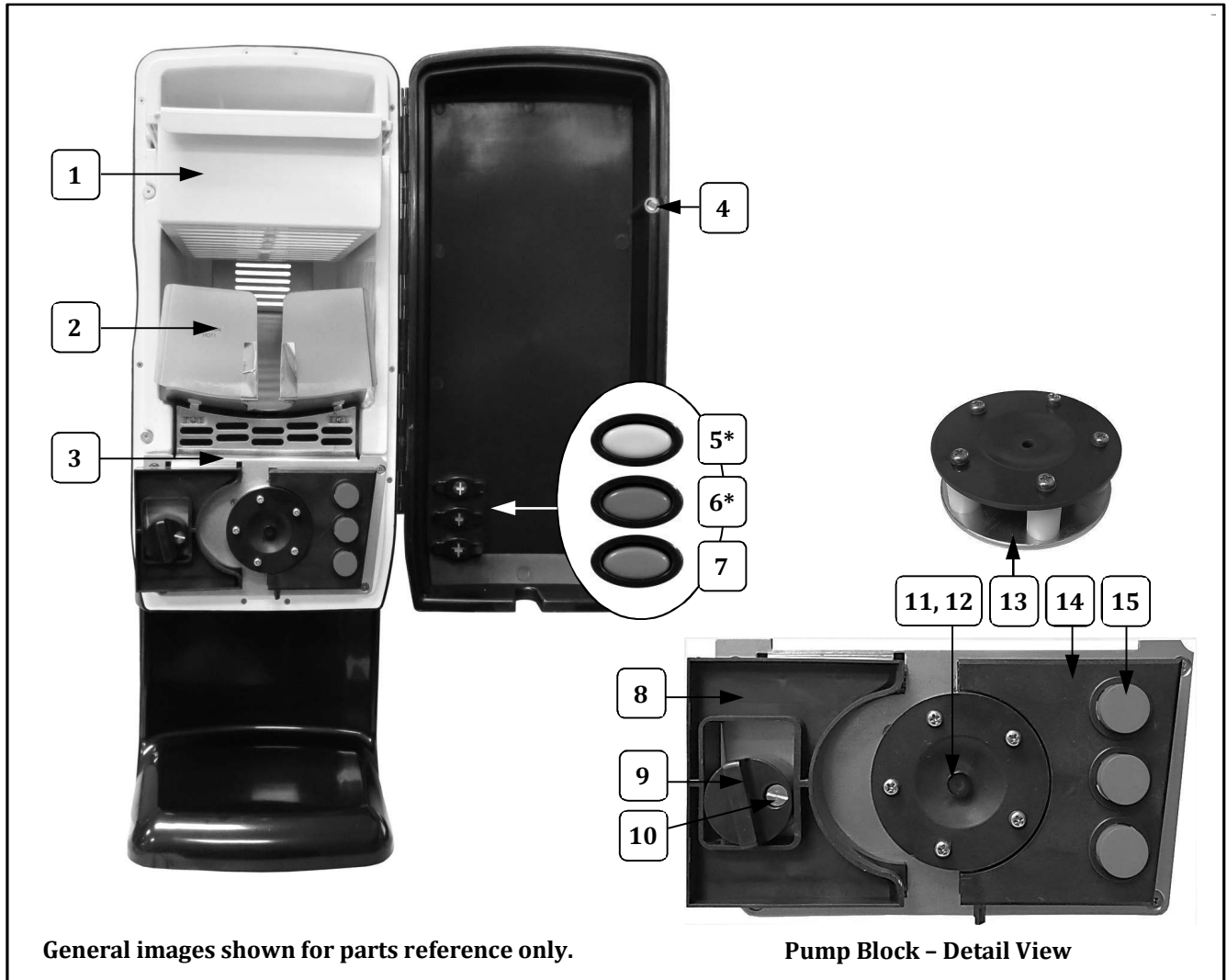

Item	Part Description	Part Number
		5300
1	CHEESE BAG TRAY	EN0008
2	CHEESE BAG SUPPORT	36027
3	SWITCH MOUNT PANEL	36029
4	DOOR MAGNET	36042
5	YELLOW BUTTON	36033YL
6	RED BUTTON	36033RD
7	ORANGE BUTTON	36033OR
8	SLIDING PUMP BLOCK	36031
9	PUMP CAM LOCK	36032
10	CAM M5 SLOTTED SCREW	77125
11	PUMP MOUNT THUMB SCREW	77122
12	M3-WASHER-SPRING	77130
13	PUMP HEAD ASSY 5 ROLLER	36105
14	PUMP BLOCK RIGHT-SWITCH	36030
15	SWITCH	36038



Cabinet Front and Interior View

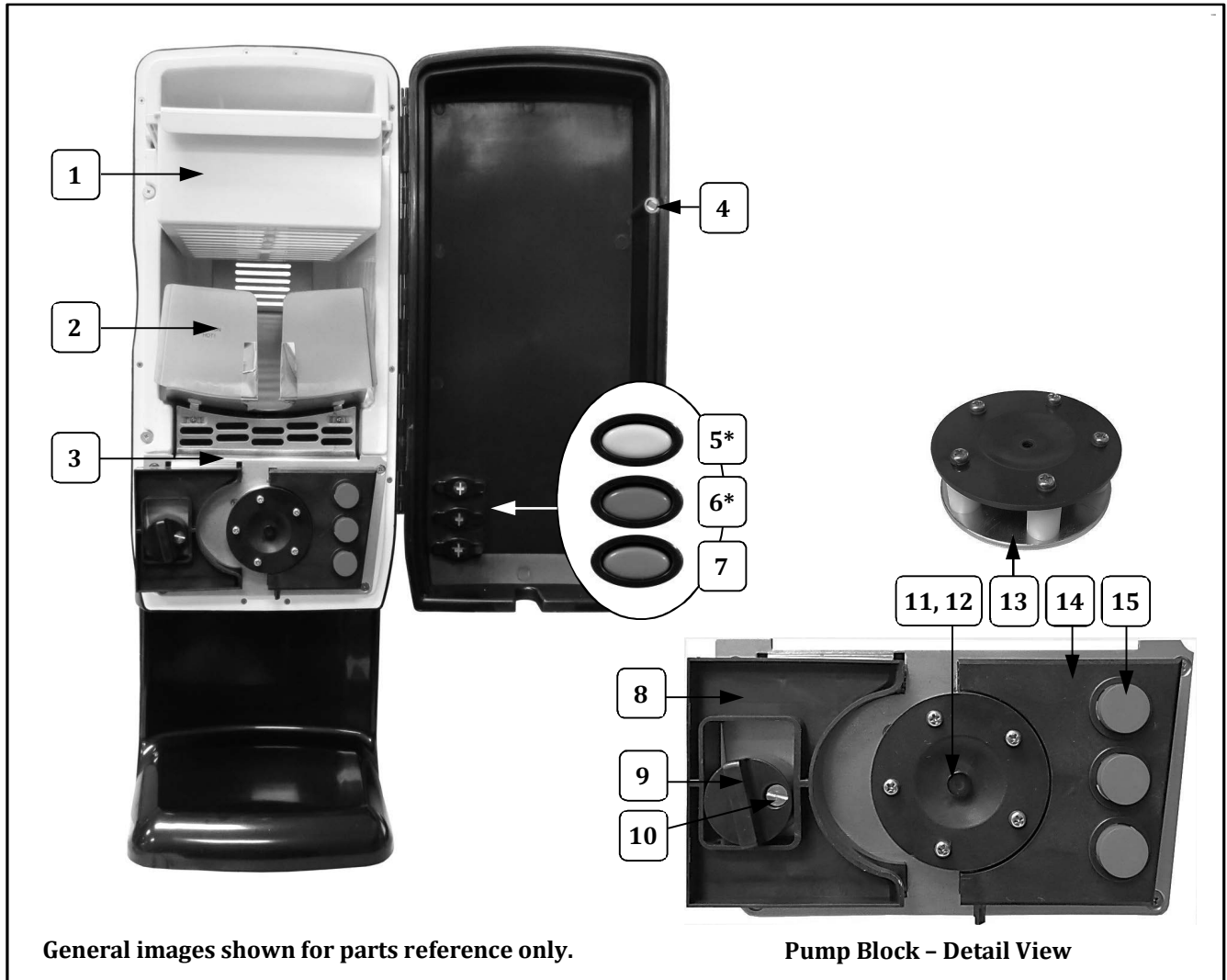

Item	Part Description	Part Number
		5300
1	CHEESE BAG TRAY	EN0008
2	CHEESE BAG SUPPORT	36027
3	SWITCH MOUNT PANEL	36029
4	DOOR MAGNET	36042
5	YELLOW BUTTON	36033YL
6	RED BUTTON	36033RD
7	ORANGE BUTTON	36033OR
8	SLIDING PUMP BLOCK	36031
9	PUMP CAM LOCK	36032
10	CAM M5 SLOTTED SCREW	77125
11	PUMP MOUNT THUMB SCREW	77122
12	M3-WASHER-SPRING	77130
13	PUMP HEAD ASSY 5 ROLLER	36105
14	PUMP BLOCK RIGHT-SWITCH	36030
15	SWITCH	36038



Cabinet Front and Interior View

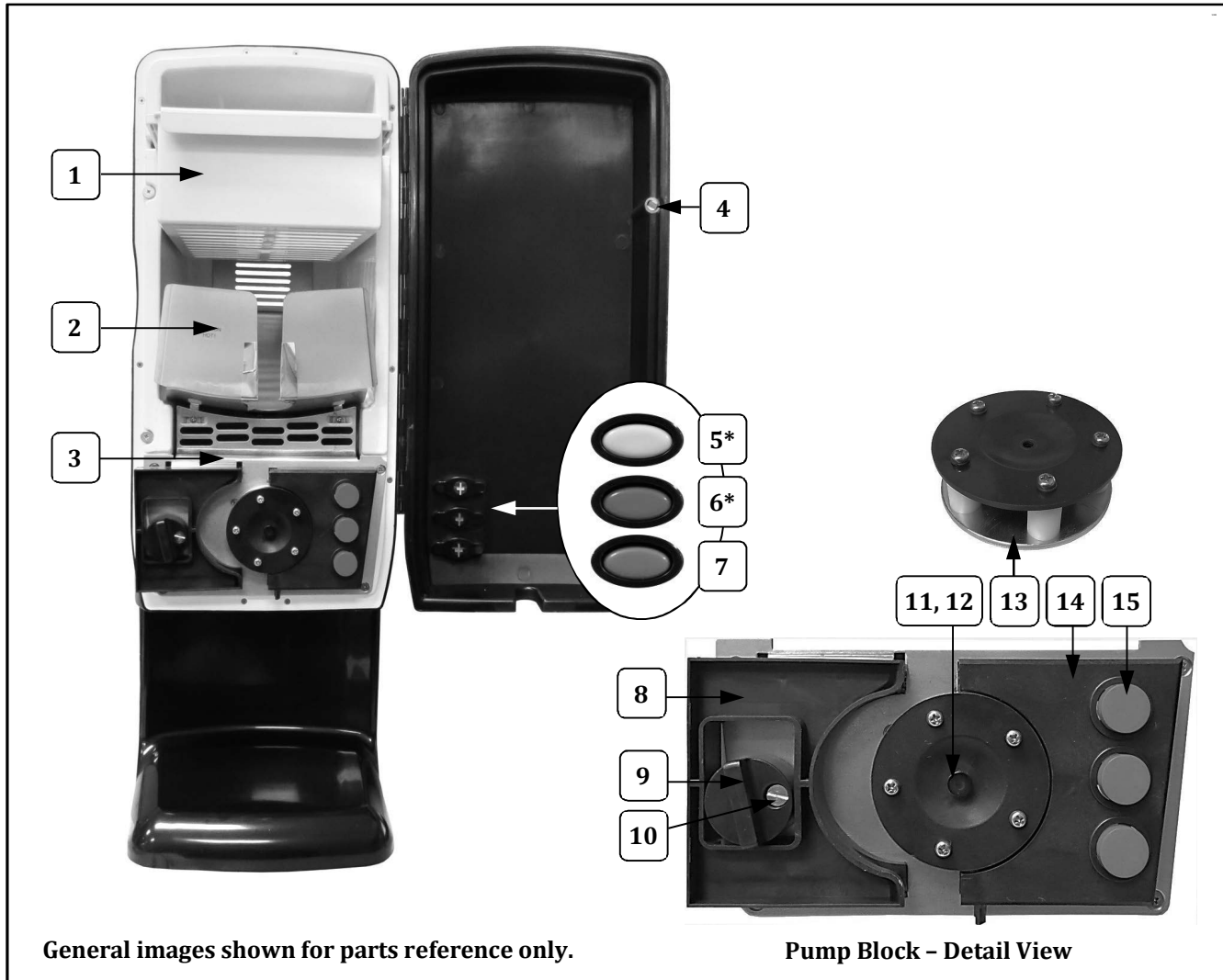

General images shown for parts reference only.

Pump Block - Detail View

Item	Part Description	Part Number
		5300
1	CHEESE BAG TRAY	EN0008
2	CHEESE BAG SUPPORT	36027
3	SWITCH MOUNT PANEL	36029
4	DOOR MAGNET	36042
5	YELLOW BUTTON	36033YL
6	RED BUTTON	36033RD
7	ORANGE BUTTON	36033OR
8	SLIDING PUMP BLOCK	36031
9	PUMP CAM LOCK	36032
10	CAM M5 SLOTTED SCREW	77125
11	PUMP MOUNT THUMB SCREW	77122
12	M3-WASHER-SPRING	77130
13	PUMP HEAD ASSY 5 ROLLER	36105
14	PUMP BLOCK RIGHT-SWITCH	36030
15	SWITCH	36038



Cabinet Front and Interior View

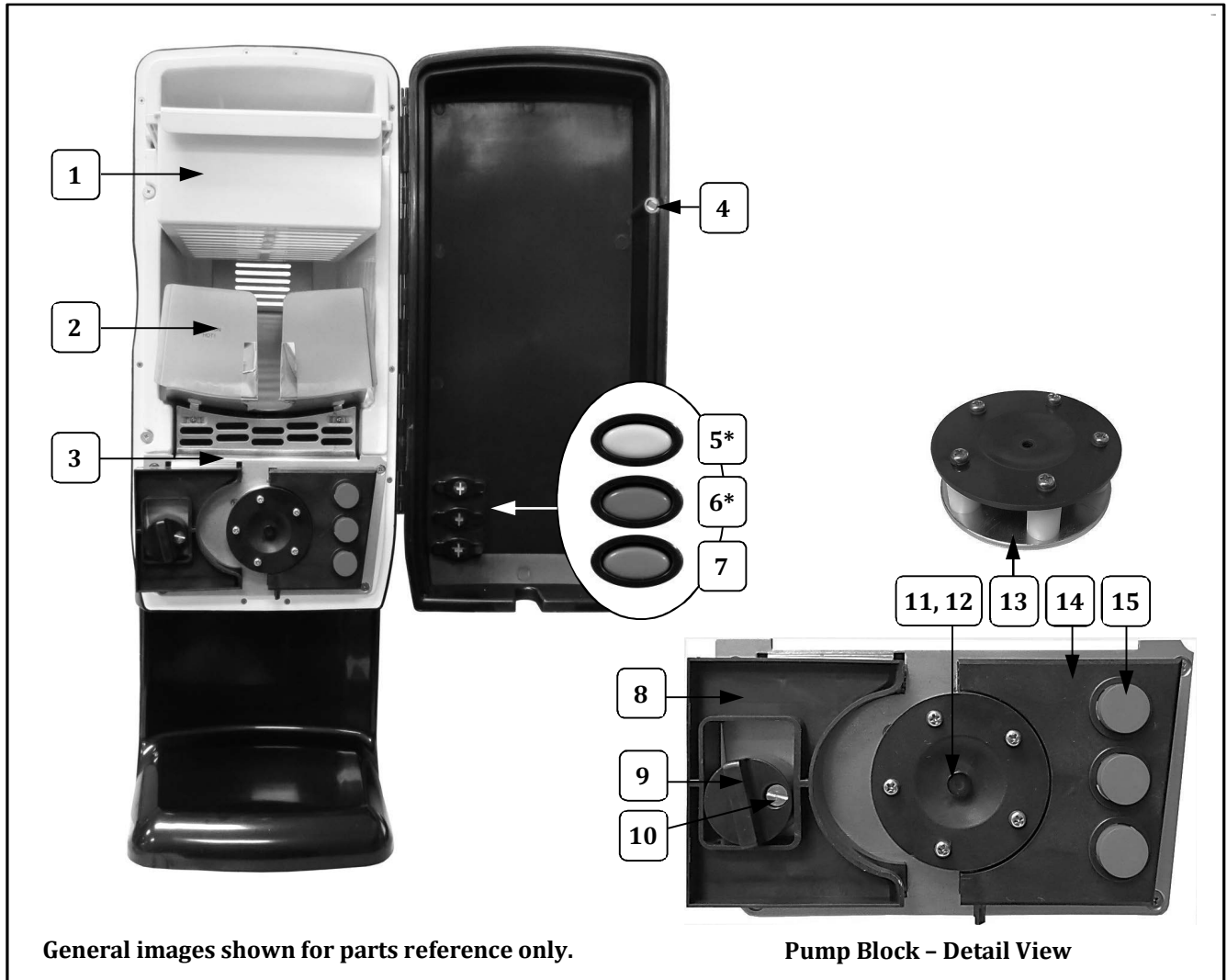

Item	Part Description	Part Number
		5300
1	CHEESE BAG TRAY	EN0008
2	CHEESE BAG SUPPORT	36027
3	SWITCH MOUNT PANEL	36029
4	DOOR MAGNET	36042
5	YELLOW BUTTON	36033YL
6	RED BUTTON	36033RD
7	ORANGE BUTTON	36033OR
8	SLIDING PUMP BLOCK	36031
9	PUMP CAM LOCK	36032
10	CAM M5 SLOTTED SCREW	77125
11	PUMP MOUNT THUMB SCREW	77122
12	M3-WASHER-SPRING	77130
13	PUMP HEAD ASSY 5 ROLLER	36105
14	PUMP BLOCK RIGHT-SWITCH	36030
15	SWITCH	36038



Cabinet Front and Interior View

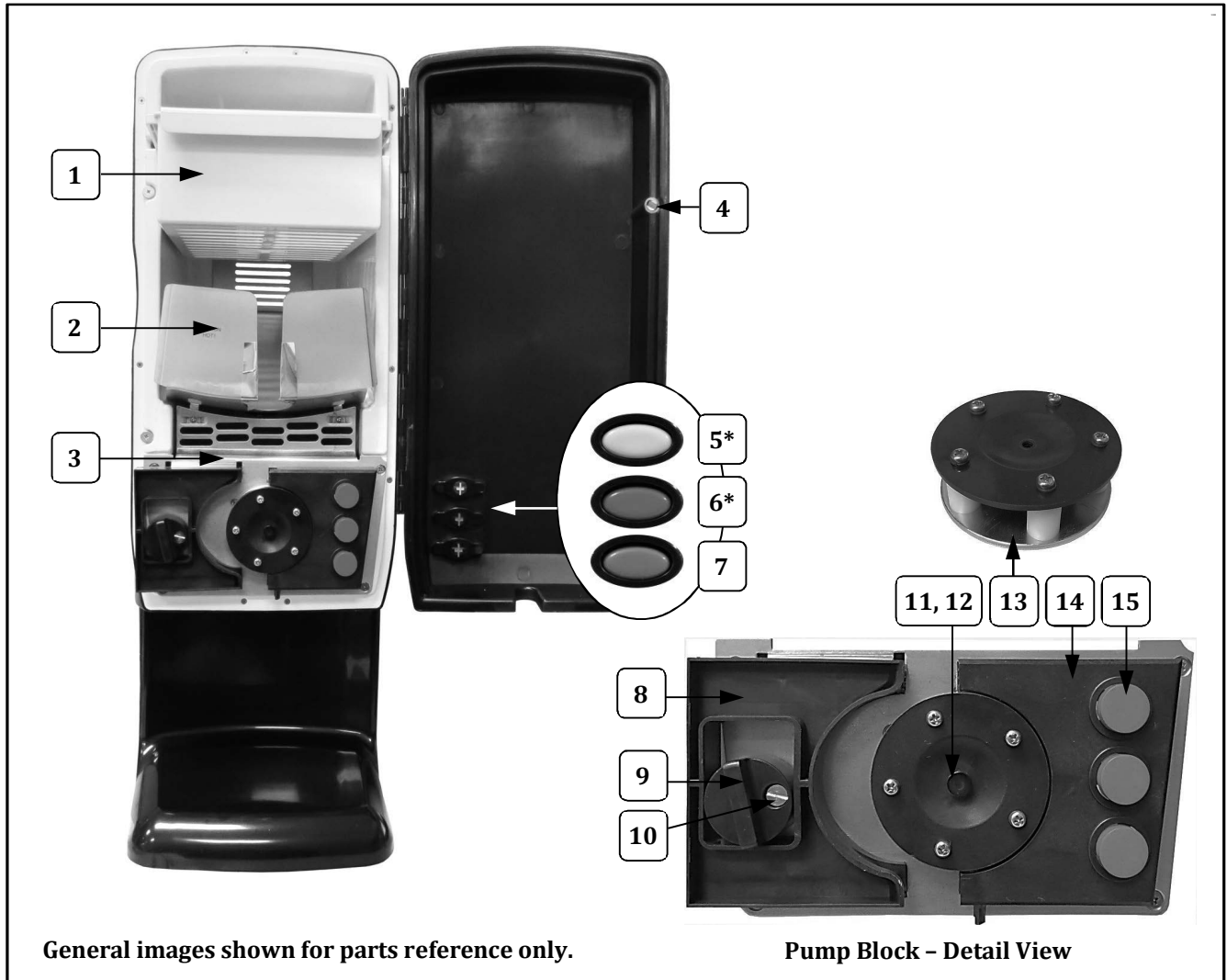

Item	Part Description	Part Number
		5300
1	CHEESE BAG TRAY	EN0008
2	CHEESE BAG SUPPORT	36027
3	SWITCH MOUNT PANEL	36029
4	DOOR MAGNET	36042
5	YELLOW BUTTON	36033YL
6	RED BUTTON	36033RD
7	ORANGE BUTTON	36033OR
8	SLIDING PUMP BLOCK	36031
9	PUMP CAM LOCK	36032
10	CAM M5 SLOTTED SCREW	77125
11	PUMP MOUNT THUMB SCREW	77122
12	M3-WASHER-SPRING	77130
13	PUMP HEAD ASSY 5 ROLLER	36105
14	PUMP BLOCK RIGHT-SWITCH	36030
15	SWITCH	36038



Cabinet Front and Interior View

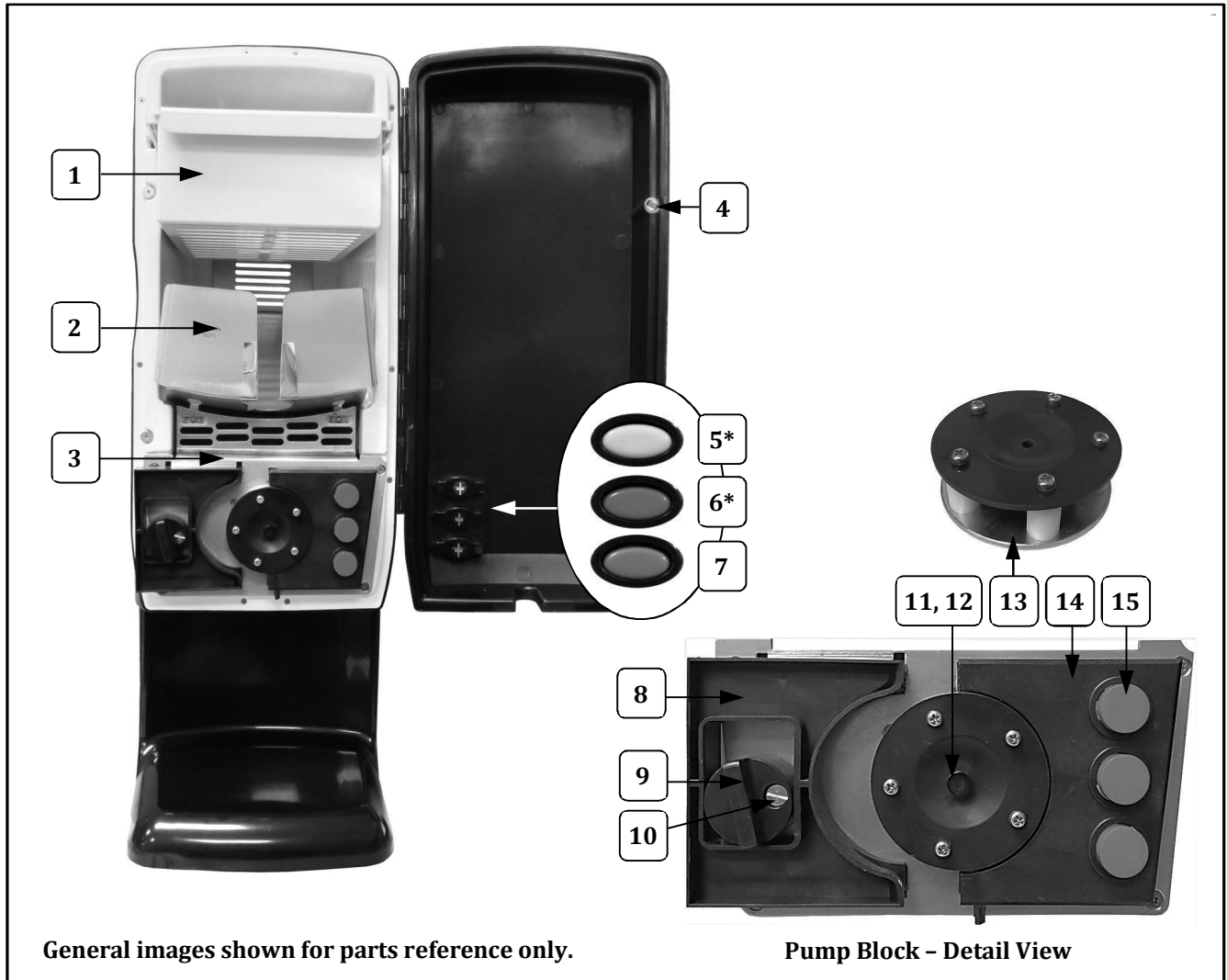

Item	Part Description	Part Number
		5300
1	CHEESE BAG TRAY	EN0008
2	CHEESE BAG SUPPORT	36027
3	SWITCH MOUNT PANEL	36029
4	DOOR MAGNET	36042
5	YELLOW BUTTON	36033YL
6	RED BUTTON	36033RD
7	ORANGE BUTTON	36033OR
8	SLIDING PUMP BLOCK	36031
9	PUMP CAM LOCK	36032
10	CAM M5 SLOTTED SCREW	77125
11	PUMP MOUNT THUMB SCREW	77122
12	M3-WASHER-SPRING	77130
13	PUMP HEAD ASSY 5 ROLLER	36105
14	PUMP BLOCK RIGHT-SWITCH	36030
15	SWITCH	36038



Cabinet Front and Interior View

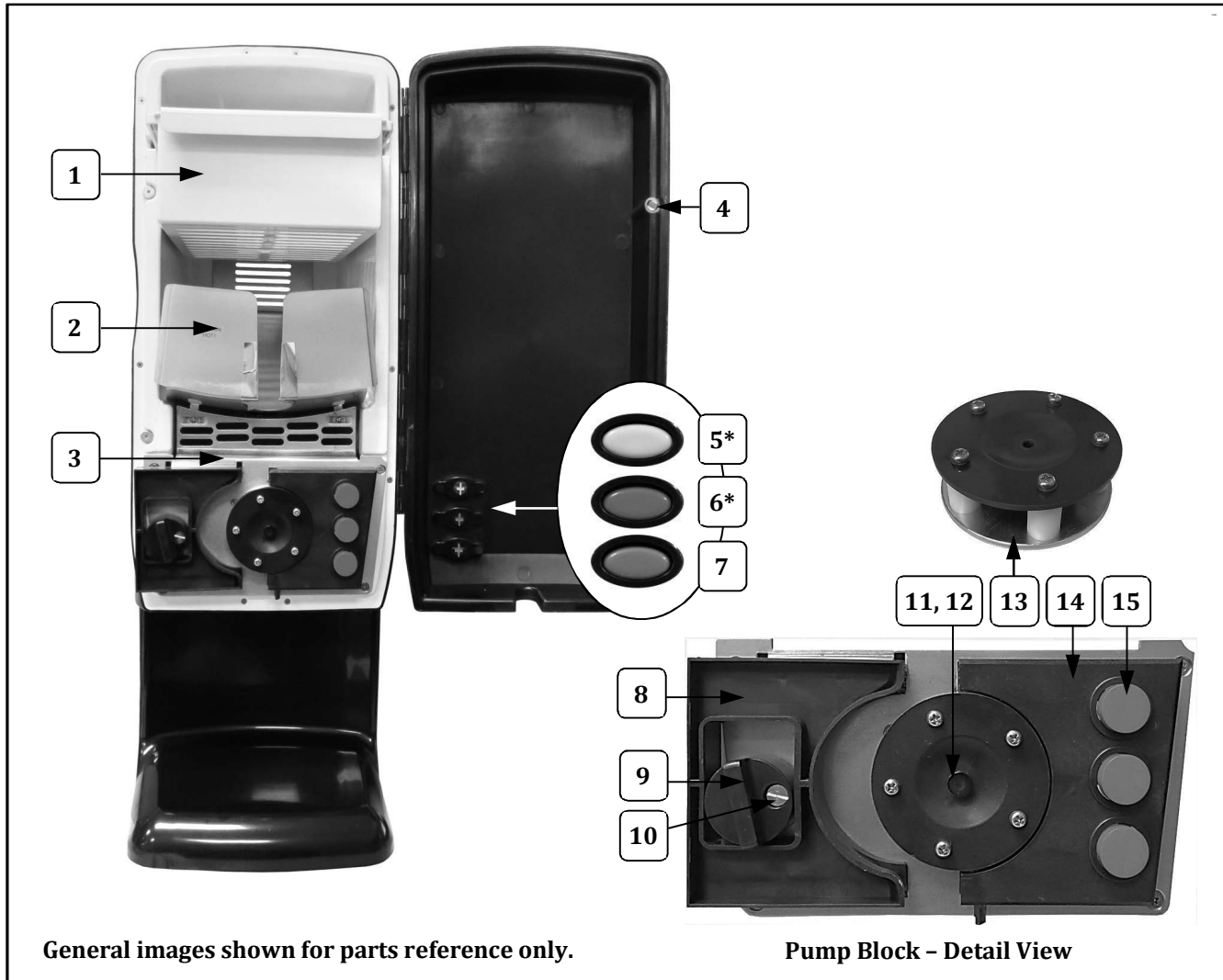

General images shown for parts reference only.

Pump Block - Detail View

Item	Part Description	Part Number
		5300
1	CHEESE BAG TRAY	EN0008
2	CHEESE BAG SUPPORT	36027
3	SWITCH MOUNT PANEL	36029
4	DOOR MAGNET	36042
5	YELLOW BUTTON	36033YL
6	RED BUTTON	36033RD
7	ORANGE BUTTON	36033OR
8	SLIDING PUMP BLOCK	36031
9	PUMP CAM LOCK	36032
10	CAM M5 SLOTTED SCREW	77125
11	PUMP MOUNT THUMB SCREW	77122
12	M3-WASHER-SPRING	77130
13	PUMP HEAD ASSY 5 ROLLER	36105
14	PUMP BLOCK RIGHT-SWITCH	36030
15	SWITCH	36038



Cabinet Front and Interior View

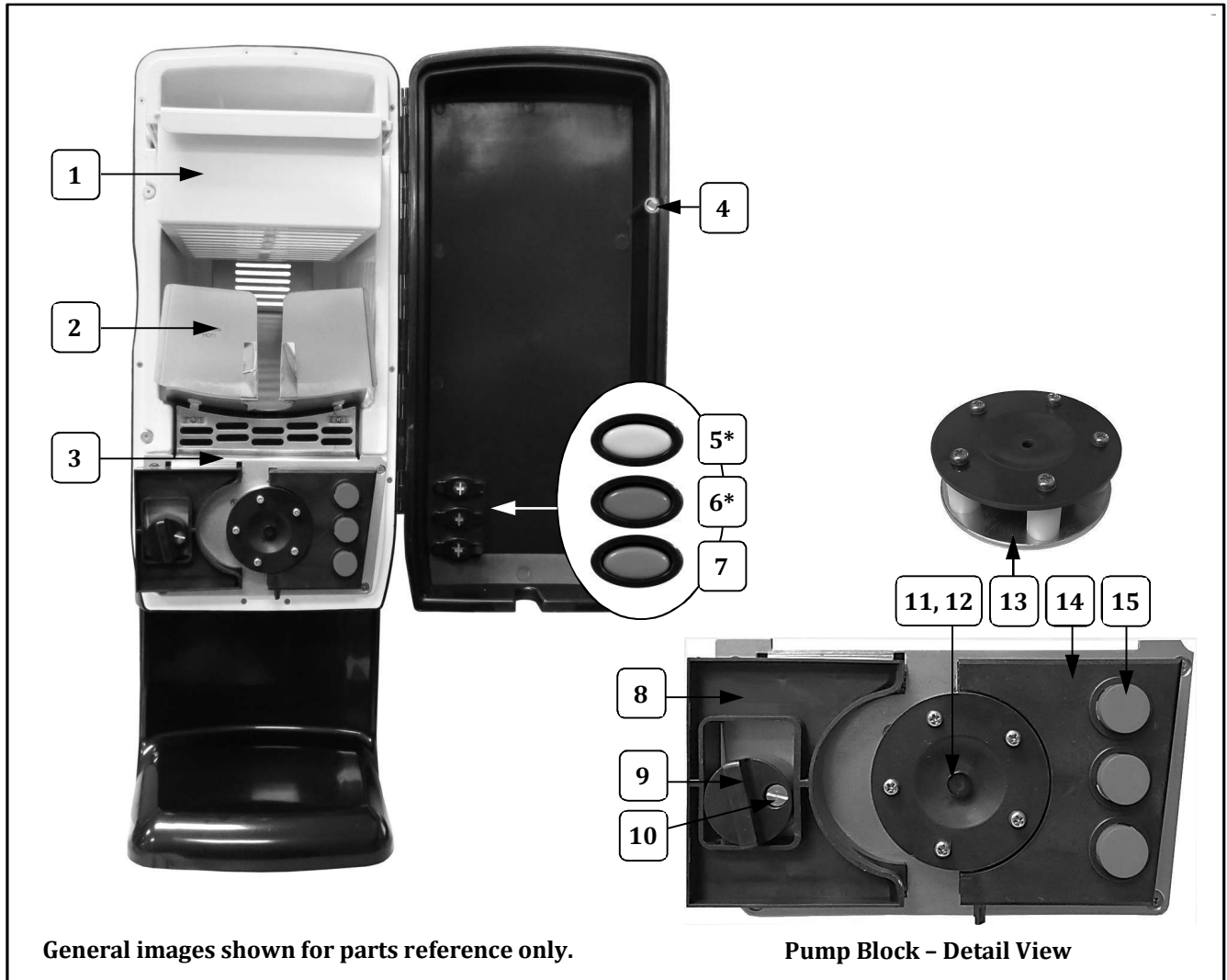

General images shown for parts reference only.

Pump Block - Detail View

Item	Part Description	Part Number
		5300
1	CHEESE BAG TRAY	EN0008
2	CHEESE BAG SUPPORT	36027
3	SWITCH MOUNT PANEL	36029
4	DOOR MAGNET	36042
5	YELLOW BUTTON	36033YL
6	RED BUTTON	36033RD
7	ORANGE BUTTON	36033OR
8	SLIDING PUMP BLOCK	36031
9	PUMP CAM LOCK	36032
10	CAM M5 SLOTTED SCREW	77125
11	PUMP MOUNT THUMB SCREW	77122
12	M3-WASHER-SPRING	77130
13	PUMP HEAD ASSY 5 ROLLER	36105
14	PUMP BLOCK RIGHT-SWITCH	36030
15	SWITCH	36038



Cabinet Front and Interior View

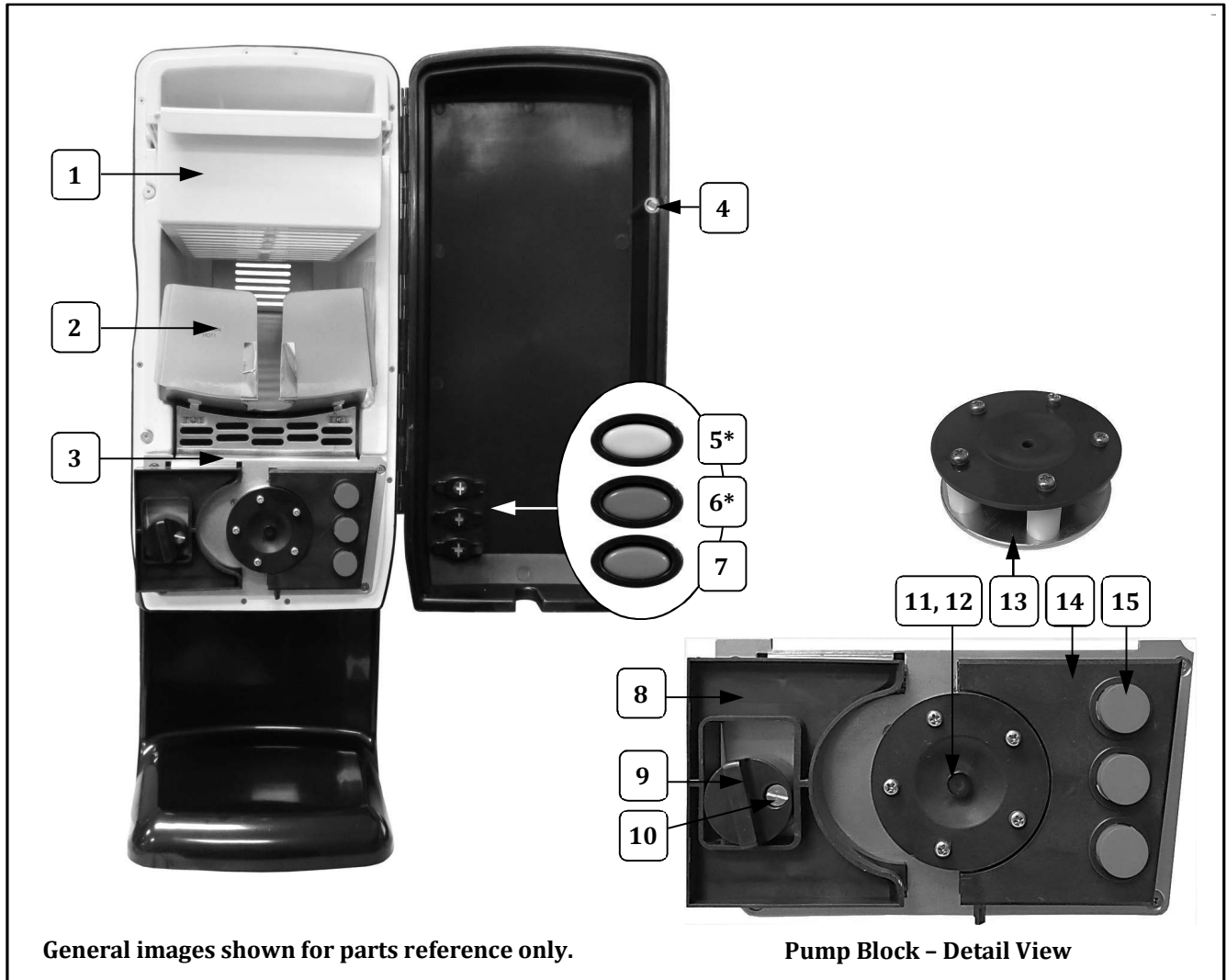

Item	Part Description	Part Number
		5300
1	CHEESE BAG TRAY	EN0008
2	CHEESE BAG SUPPORT	36027
3	SWITCH MOUNT PANEL	36029
4	DOOR MAGNET	36042
5	YELLOW BUTTON	36033YL
6	RED BUTTON	36033RD
7	ORANGE BUTTON	36033OR
8	SLIDING PUMP BLOCK	36031
9	PUMP CAM LOCK	36032
10	CAM M5 SLOTTED SCREW	77125
11	PUMP MOUNT THUMB SCREW	77122
12	M3-WASHER-SPRING	77130
13	PUMP HEAD ASSY 5 ROLLER	36105
14	PUMP BLOCK RIGHT-SWITCH	36030
15	SWITCH	36038



Cabinet Back and Interior View

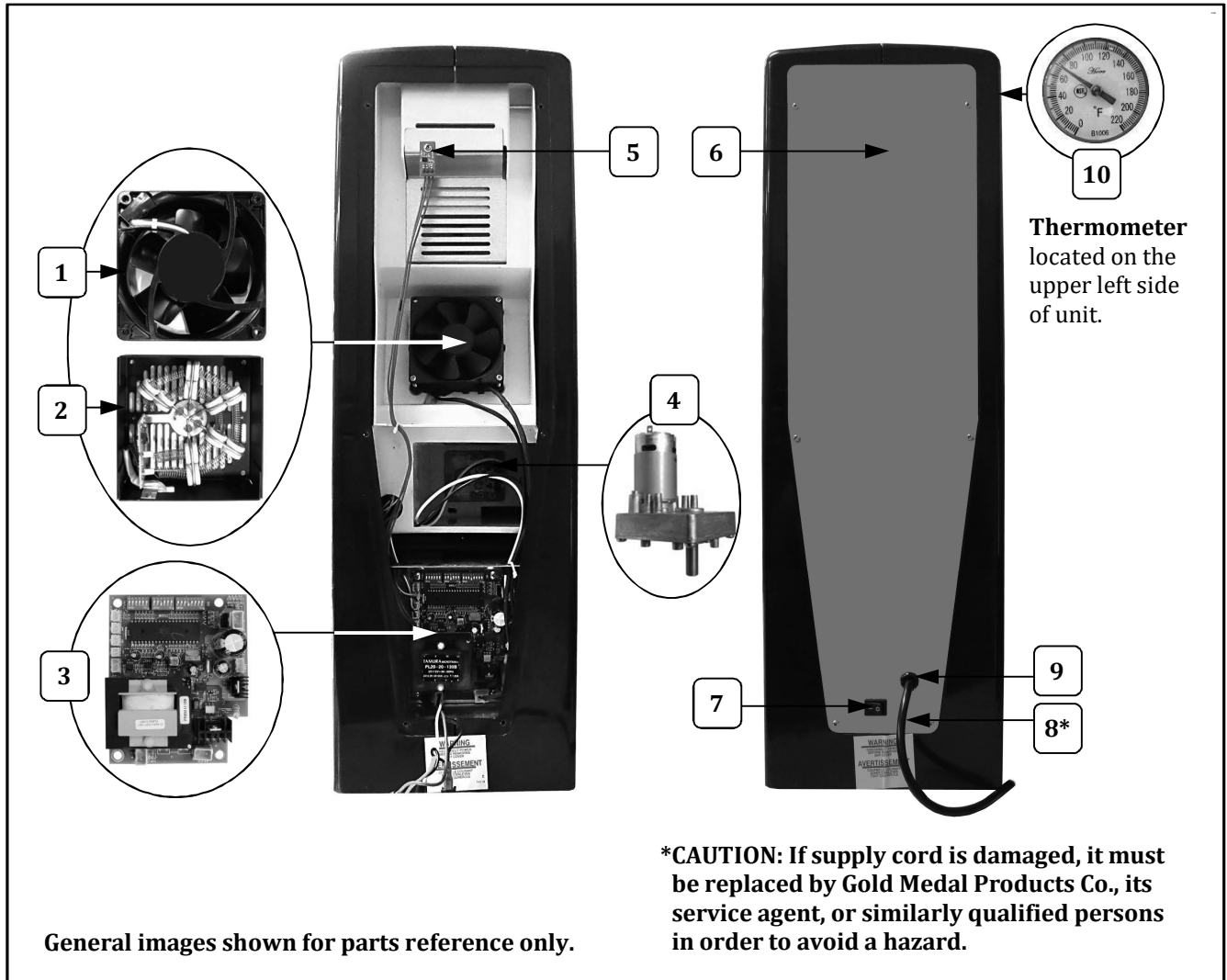

Item	Part Description	Part Number
		5300
1	24 V FAN BLOWER	36046
2	HEATER ASSEMBLY	36047
3	PCBA MASTER BOARD	36048
4	24 V DC MOTOR	36043
5	PCBA TEMPERATURE SENSOR	36049
6	REAR ACCESS PANEL	36026
7	SPST SWITCH	36119
8	POWER CORD W/PCBA CONNECT	23038
9	STRAIN RELIEF	87810
10	THERMOMETER	EN0001



Cabinet Back and Interior View

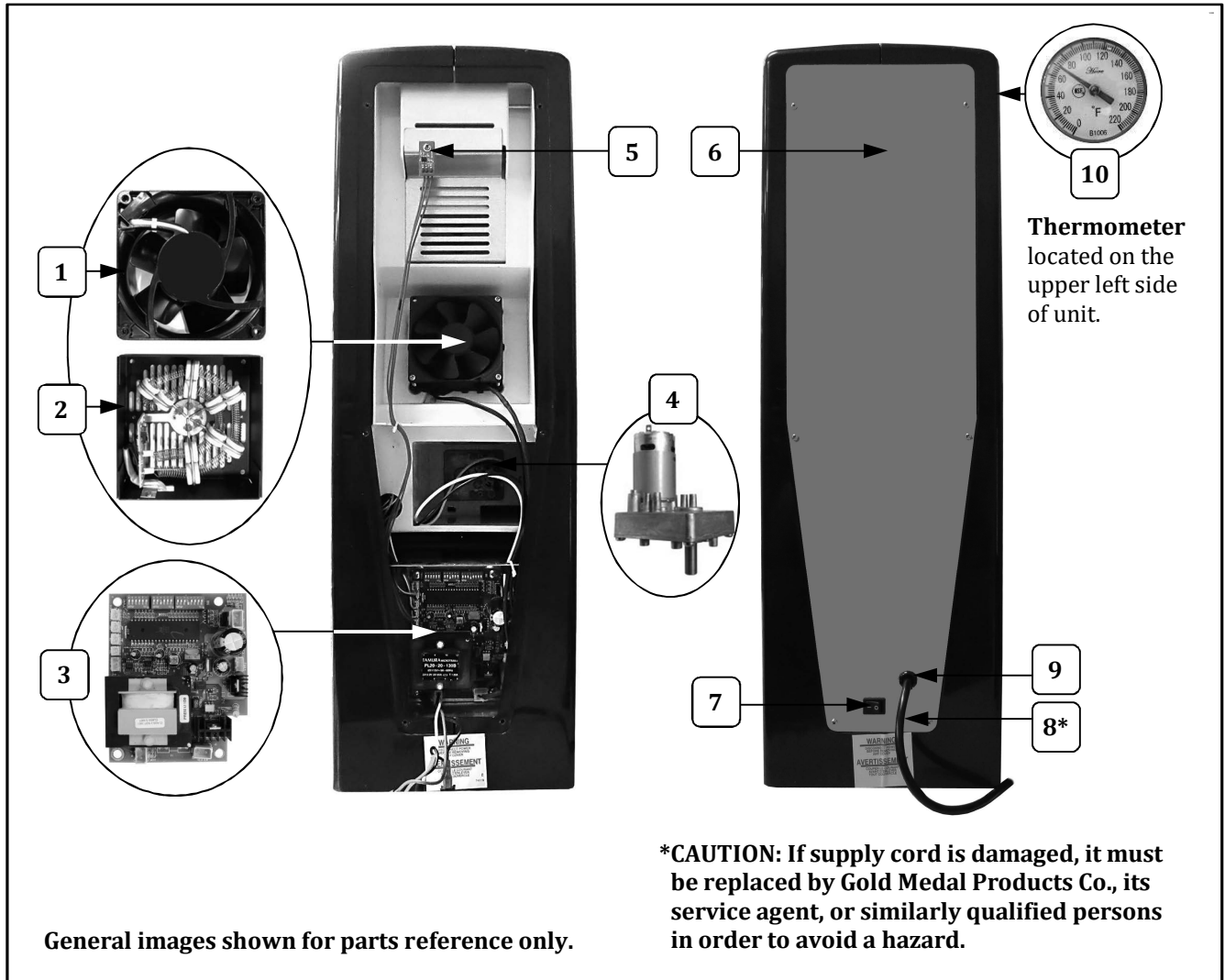

Item	Part Description	Part Number
		5300
1	24 V FAN BLOWER	36046
2	HEATER ASSEMBLY	36047
3	PCBA MASTER BOARD	36048
4	24 V DC MOTOR	36043
5	PCBA TEMPERATURE SENSOR	36049
6	REAR ACCESS PANEL	36026
7	SPST SWITCH	36119
8	POWER CORD W/PCBA CONNECT	23038
9	STRAIN RELIEF	87810
10	THERMOMETER	EN0001



Cabinet Back and Interior View

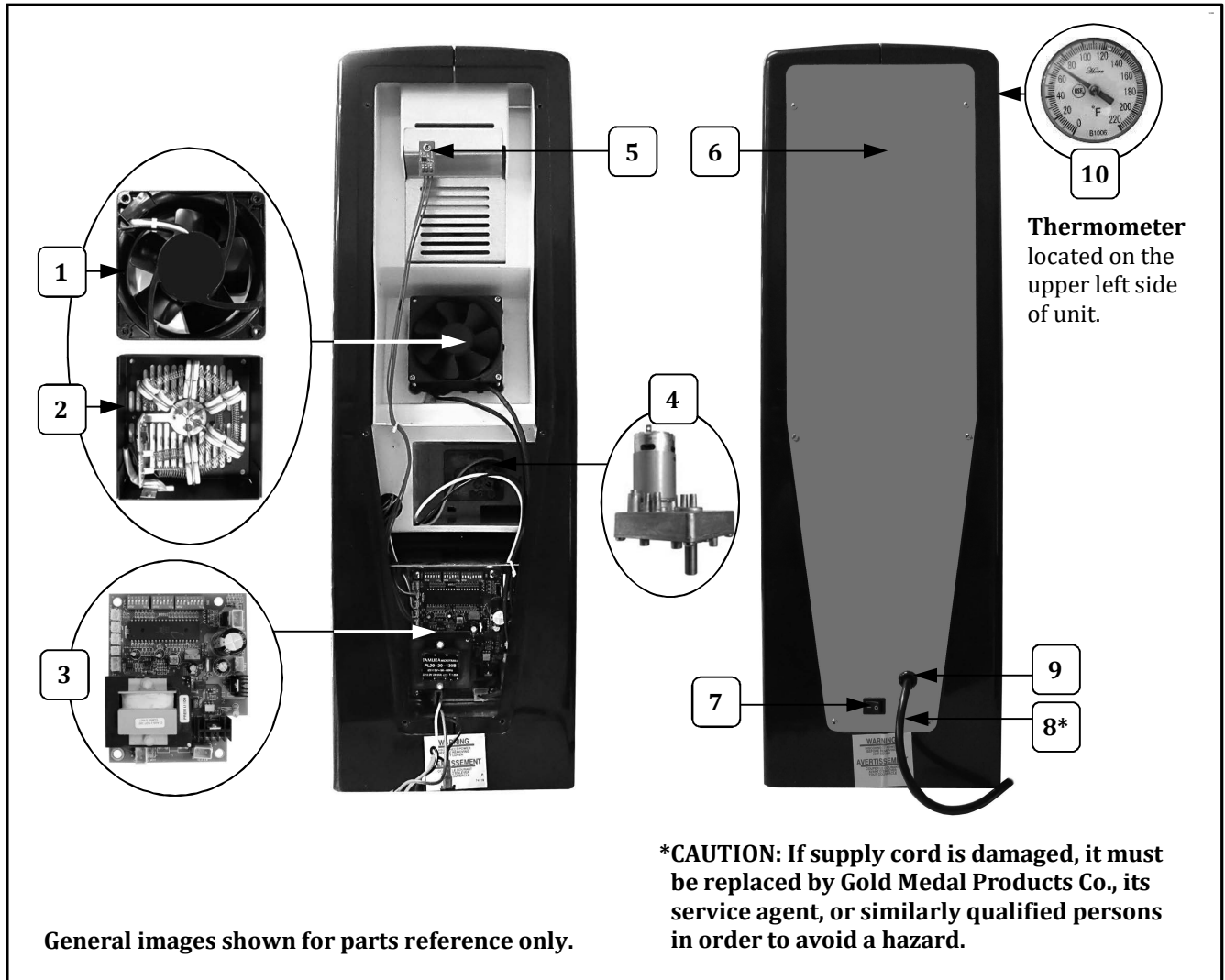

Item	Part Description	Part Number
		5300
1	24 V FAN BLOWER	36046
2	HEATER ASSEMBLY	36047
3	PCBA MASTER BOARD	36048
4	24 V DC MOTOR	36043
5	PCBA TEMPERATURE SENSOR	36049
6	REAR ACCESS PANEL	36026
7	SPST SWITCH	36119
8	POWER CORD W/PCBA CONNECT	23038
9	STRAIN RELIEF	87810
10	THERMOMETER	EN0001



Cabinet Back and Interior View

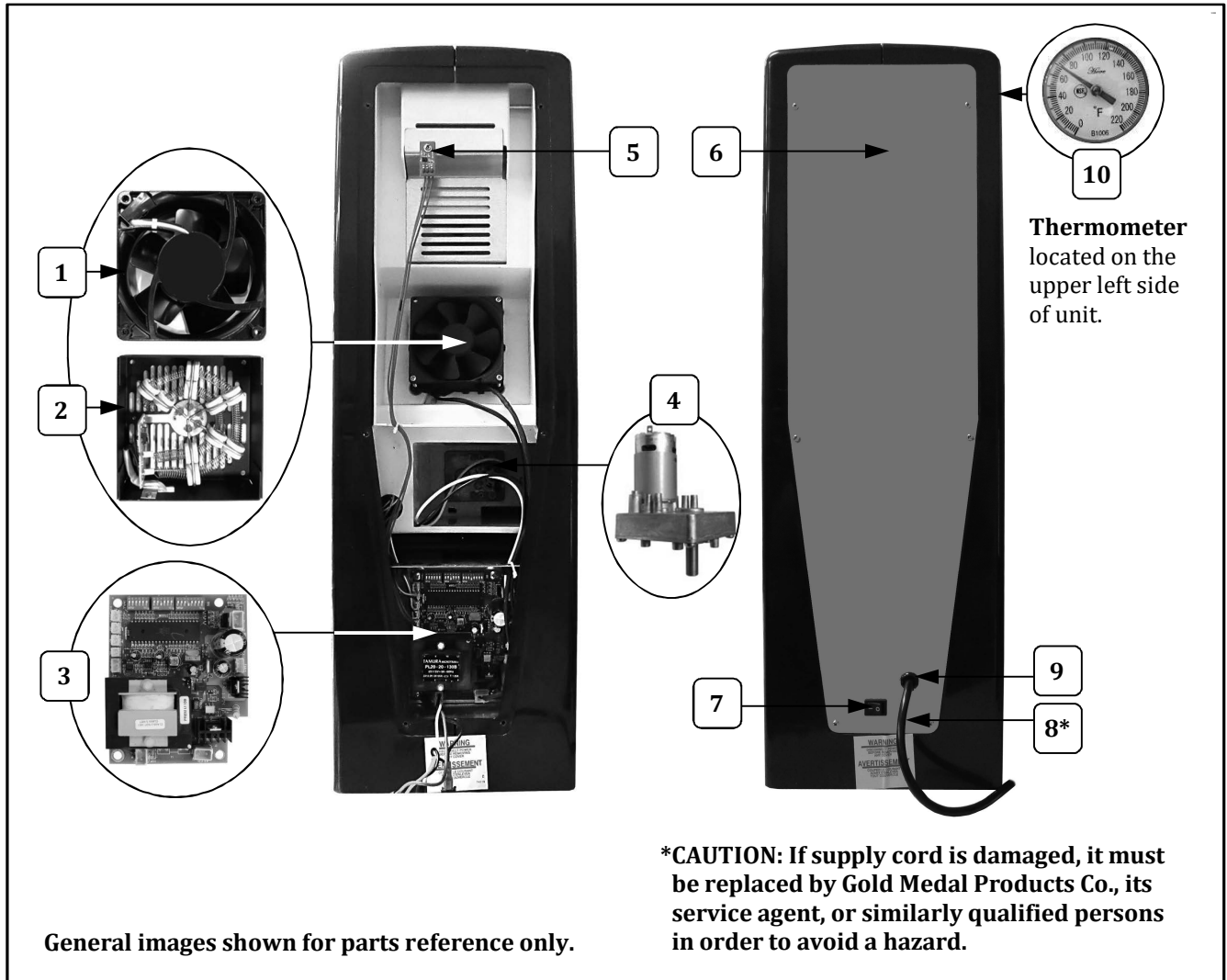

Item	Part Description	Part Number
		5300
1	24 V FAN BLOWER	36046
2	HEATER ASSEMBLY	36047
3	PCBA MASTER BOARD	36048
4	24 V DC MOTOR	36043
5	PCBA TEMPERATURE SENSOR	36049
6	REAR ACCESS PANEL	36026
7	SPST SWITCH	36119
8	POWER CORD W/PCBA CONNECT	23038
9	STRAIN RELIEF	87810
10	THERMOMETER	EN0001



Cabinet Back and Interior View

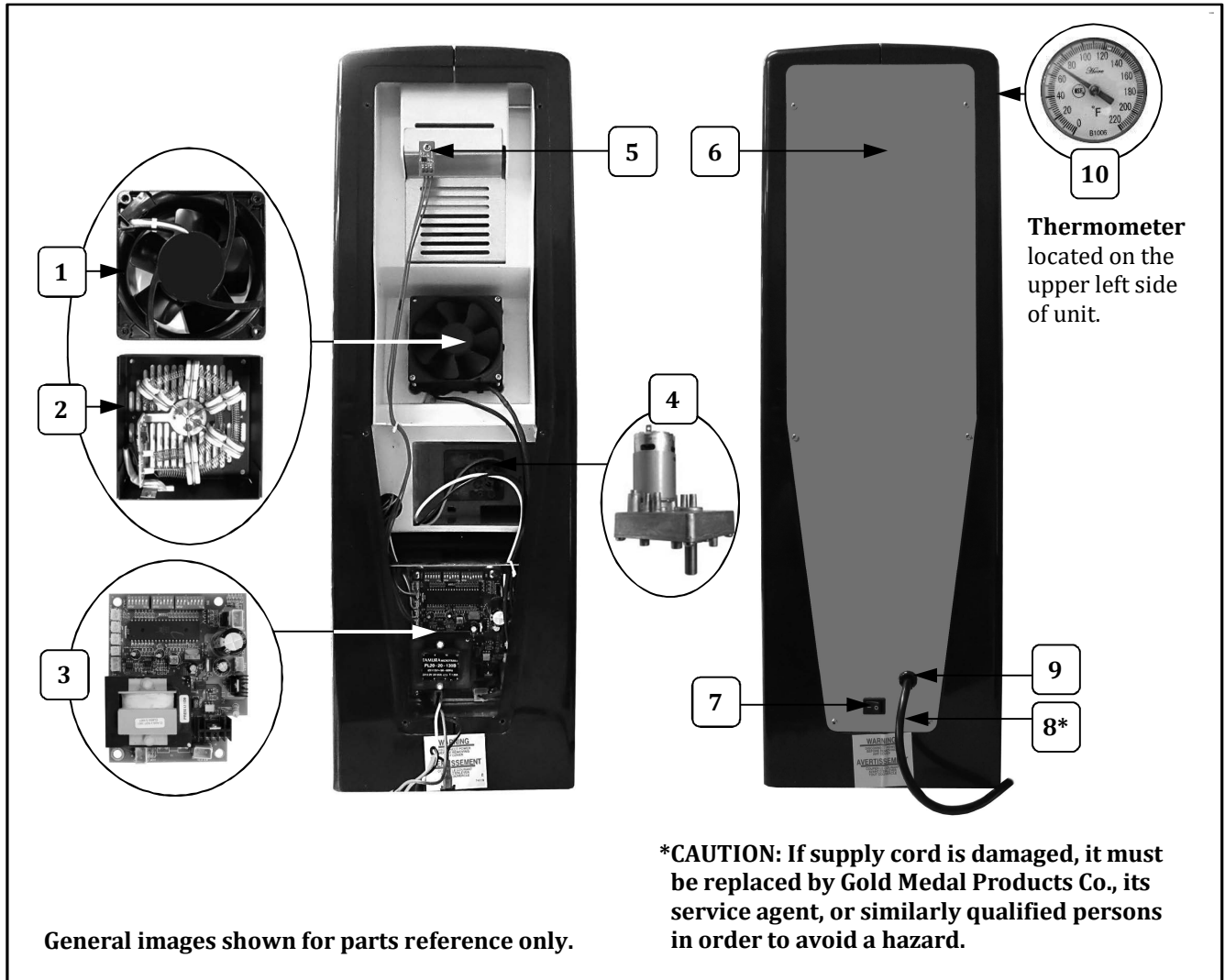

Item	Part Description	Part Number
		5300
1	24 V FAN BLOWER	36046
2	HEATER ASSEMBLY	36047
3	PCBA MASTER BOARD	36048
4	24 V DC MOTOR	36043
5	PCBA TEMPERATURE SENSOR	36049
6	REAR ACCESS PANEL	36026
7	SPST SWITCH	36119
8	POWER CORD W/PCBA CONNECT	23038
9	STRAIN RELIEF	87810
10	THERMOMETER	EN0001



Cabinet Back and Interior View

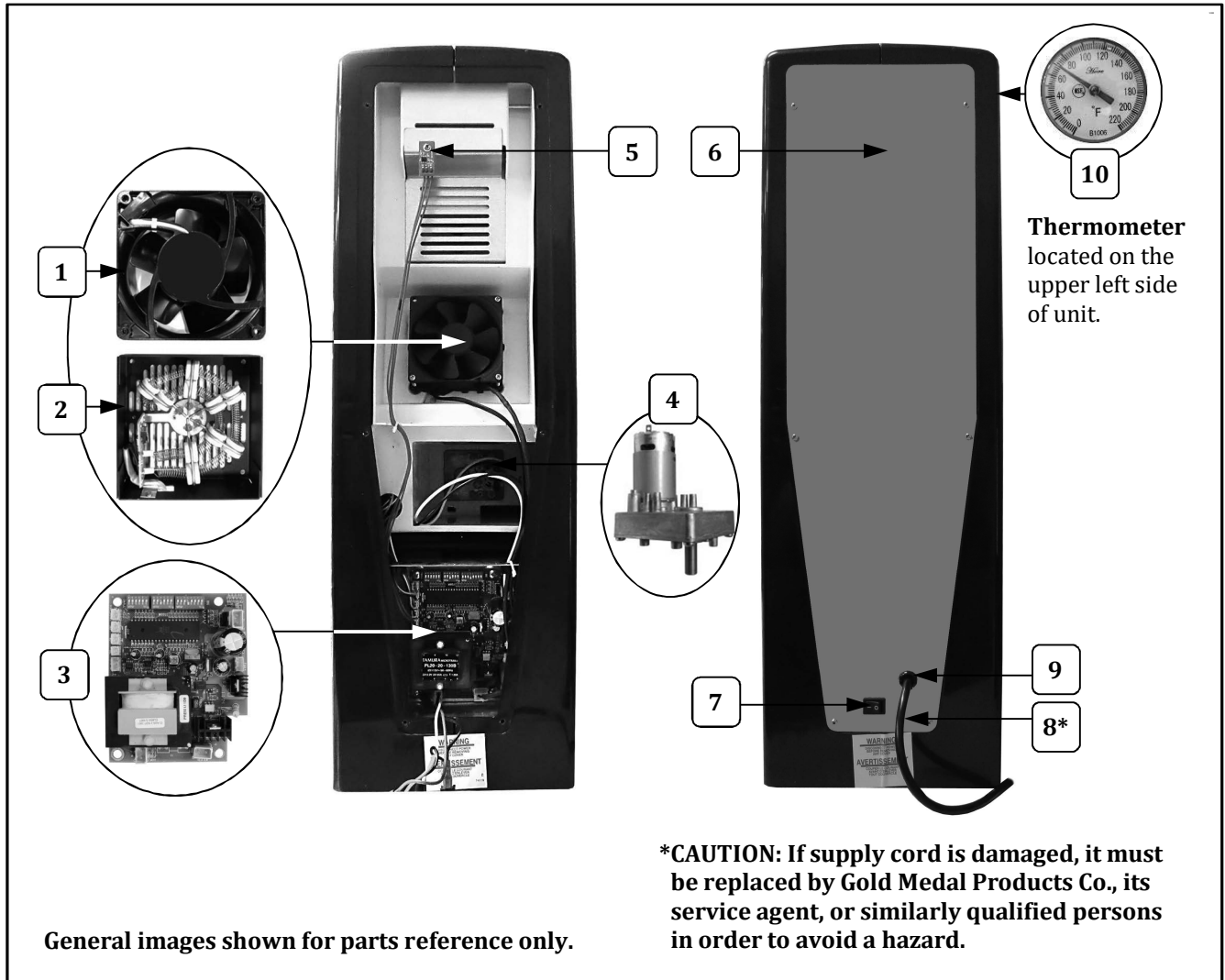

Item	Part Description	Part Number
		5300
1	24 V FAN BLOWER	36046
2	HEATER ASSEMBLY	36047
3	PCBA MASTER BOARD	36048
4	24 V DC MOTOR	36043
5	PCBA TEMPERATURE SENSOR	36049
6	REAR ACCESS PANEL	36026
7	SPST SWITCH	36119
8	POWER CORD W/PCBA CONNECT	23038
9	STRAIN RELIEF	87810
10	THERMOMETER	EN0001



Cabinet Back and Interior View

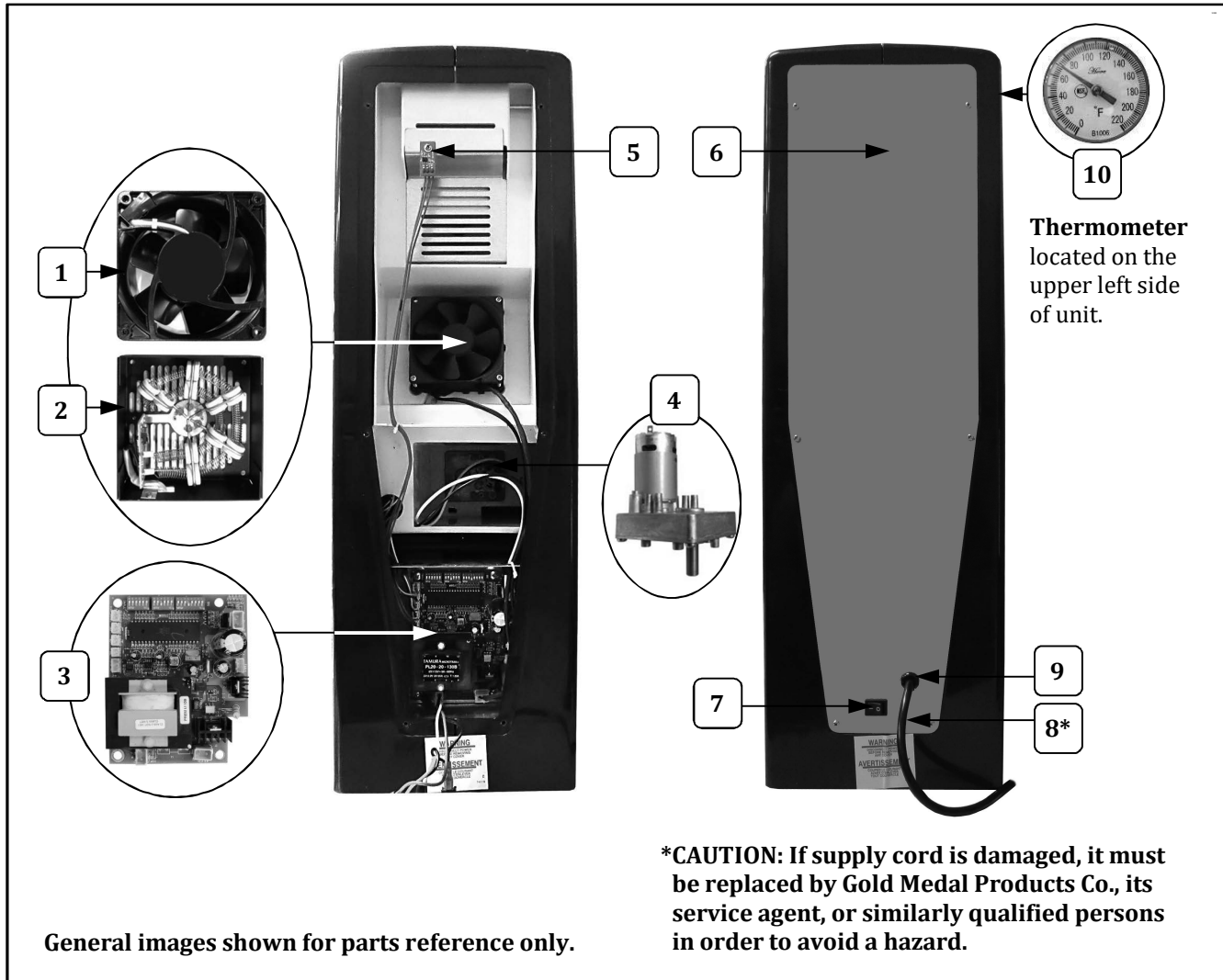

Item	Part Description	Part Number
		5300
1	24 V FAN BLOWER	36046
2	HEATER ASSEMBLY	36047
3	PCBA MASTER BOARD	36048
4	24 V DC MOTOR	36043
5	PCBA TEMPERATURE SENSOR	36049
6	REAR ACCESS PANEL	36026
7	SPST SWITCH	36119
8	POWER CORD W/PCBA CONNECT	23038
9	STRAIN RELIEF	87810
10	THERMOMETER	EN0001



Cabinet Back and Interior View

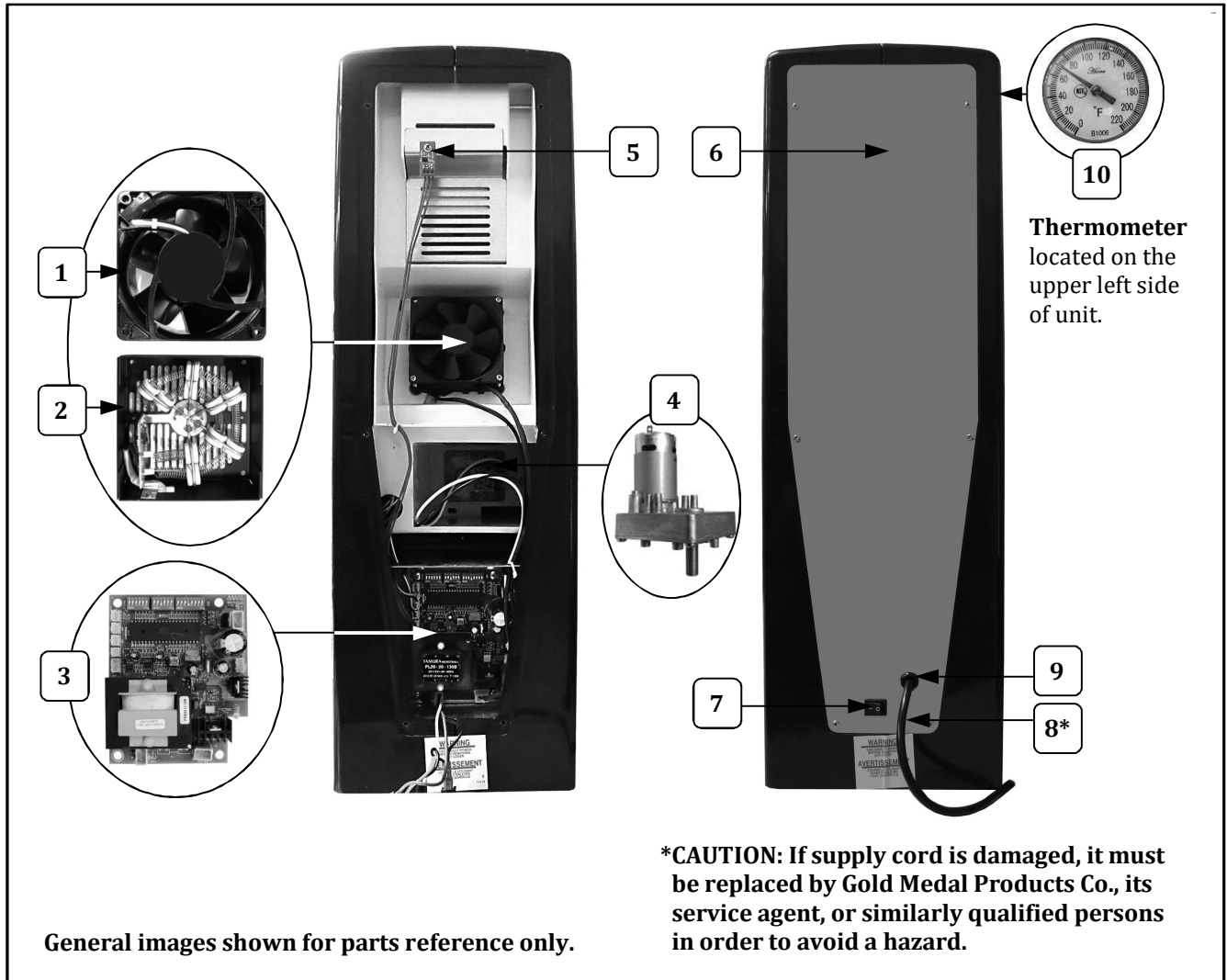

Item	Part Description	Part Number
		5300
1	24 V FAN BLOWER	36046
2	HEATER ASSEMBLY	36047
3	PCBA MASTER BOARD	36048
4	24 V DC MOTOR	36043
5	PCBA TEMPERATURE SENSOR	36049
6	REAR ACCESS PANEL	36026
7	SPST SWITCH	36119
8	POWER CORD W/PCBA CONNECT	23038
9	STRAIN RELIEF	87810
10	THERMOMETER	EN0001



Cabinet Back and Interior View

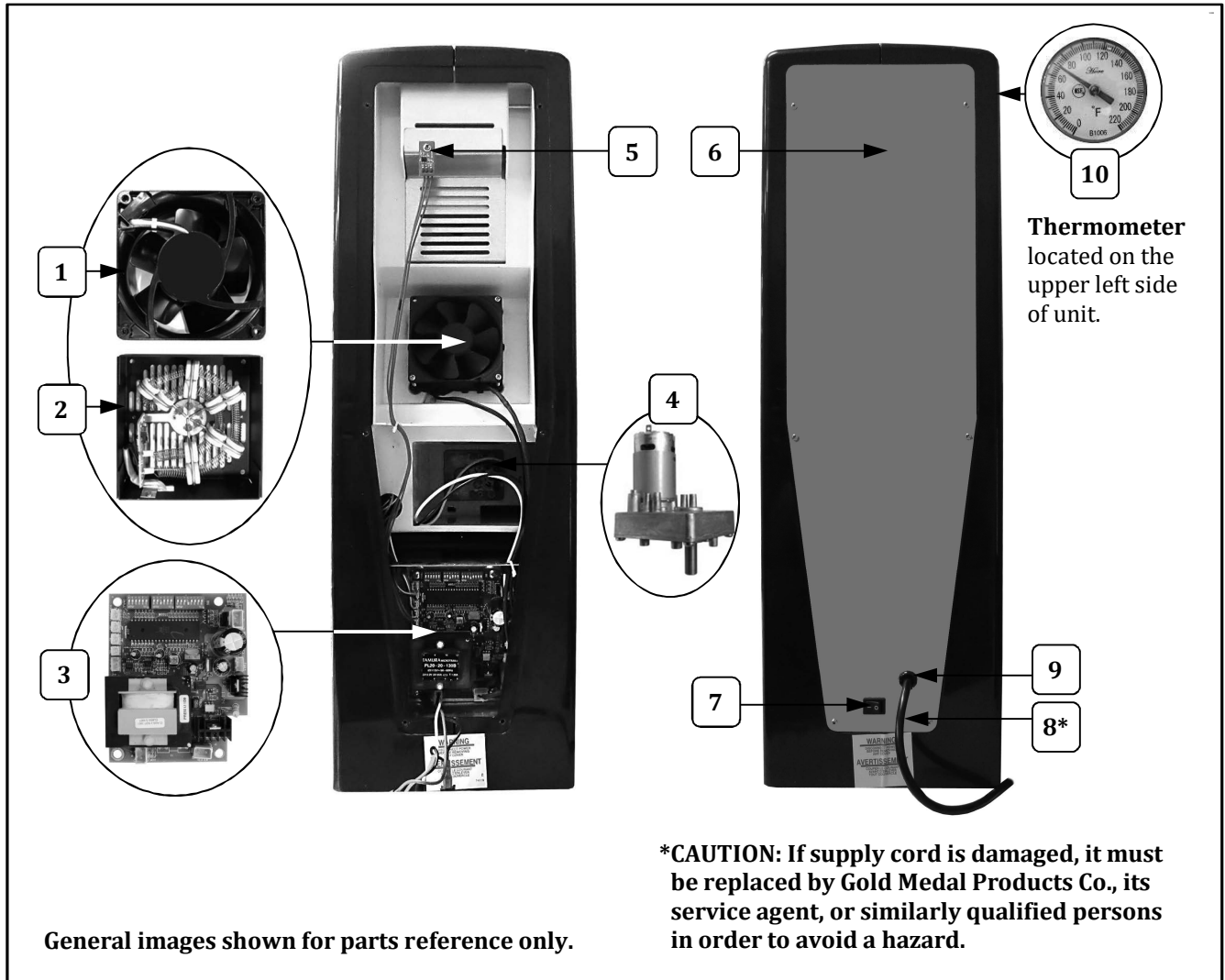

Item	Part Description	Part Number
		5300
1	24 V FAN BLOWER	36046
2	HEATER ASSEMBLY	36047
3	PCBA MASTER BOARD	36048
4	24 V DC MOTOR	36043
5	PCBA TEMPERATURE SENSOR	36049
6	REAR ACCESS PANEL	36026
7	SPST SWITCH	36119
8	POWER CORD W/PCBA CONNECT	23038
9	STRAIN RELIEF	87810
10	THERMOMETER	EN0001



Cabinet Back and Interior View

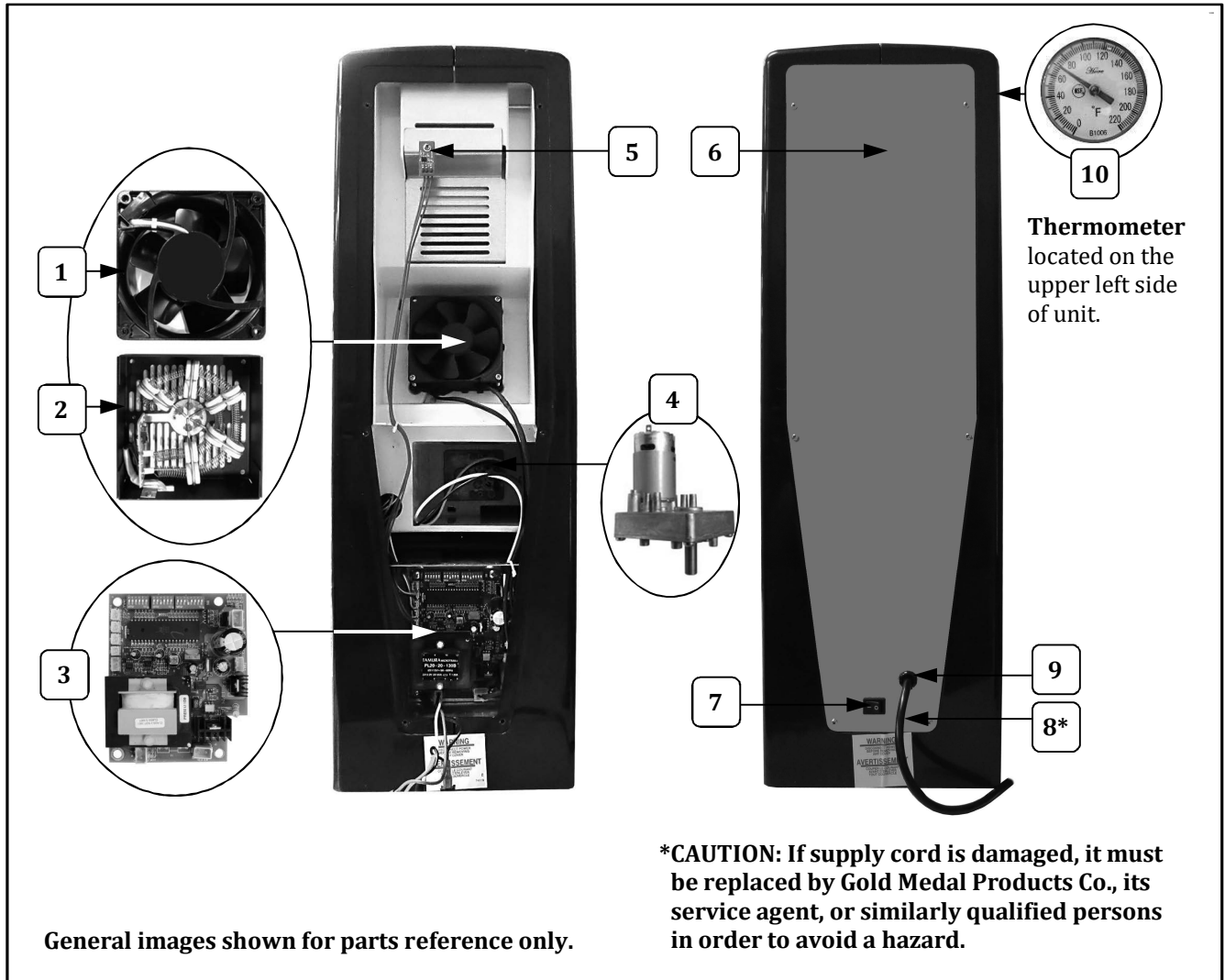

Item	Part Description	Part Number
		5300
1	24 V FAN BLOWER	36046
2	HEATER ASSEMBLY	36047
3	PCBA MASTER BOARD	36048
4	24 V DC MOTOR	36043
5	PCBA TEMPERATURE SENSOR	36049
6	REAR ACCESS PANEL	36026
7	SPST SWITCH	36119
8	POWER CORD W/PCBA CONNECT	23038
9	STRAIN RELIEF	87810
10	THERMOMETER	EN0001