

## Replacement Parts and Accessories Diagram

**PROPRIETARY RIGHTS NOTICE** This document and all information contained within it is the property of Hamilton Beach Brands, Inc. (HBB). It is confidential and proprietary and has been provided to you for a limited purpose. It must be returned or destroyed upon request. Disclosure, reproduction or use of this document and any information contained within it, in full or in part, for any purpose is forbidden without the prior written consent of HBB. No photographs may be taken of any article fabricated or assembled from this document without the prior written consent of HBB.

### Replacement Parts

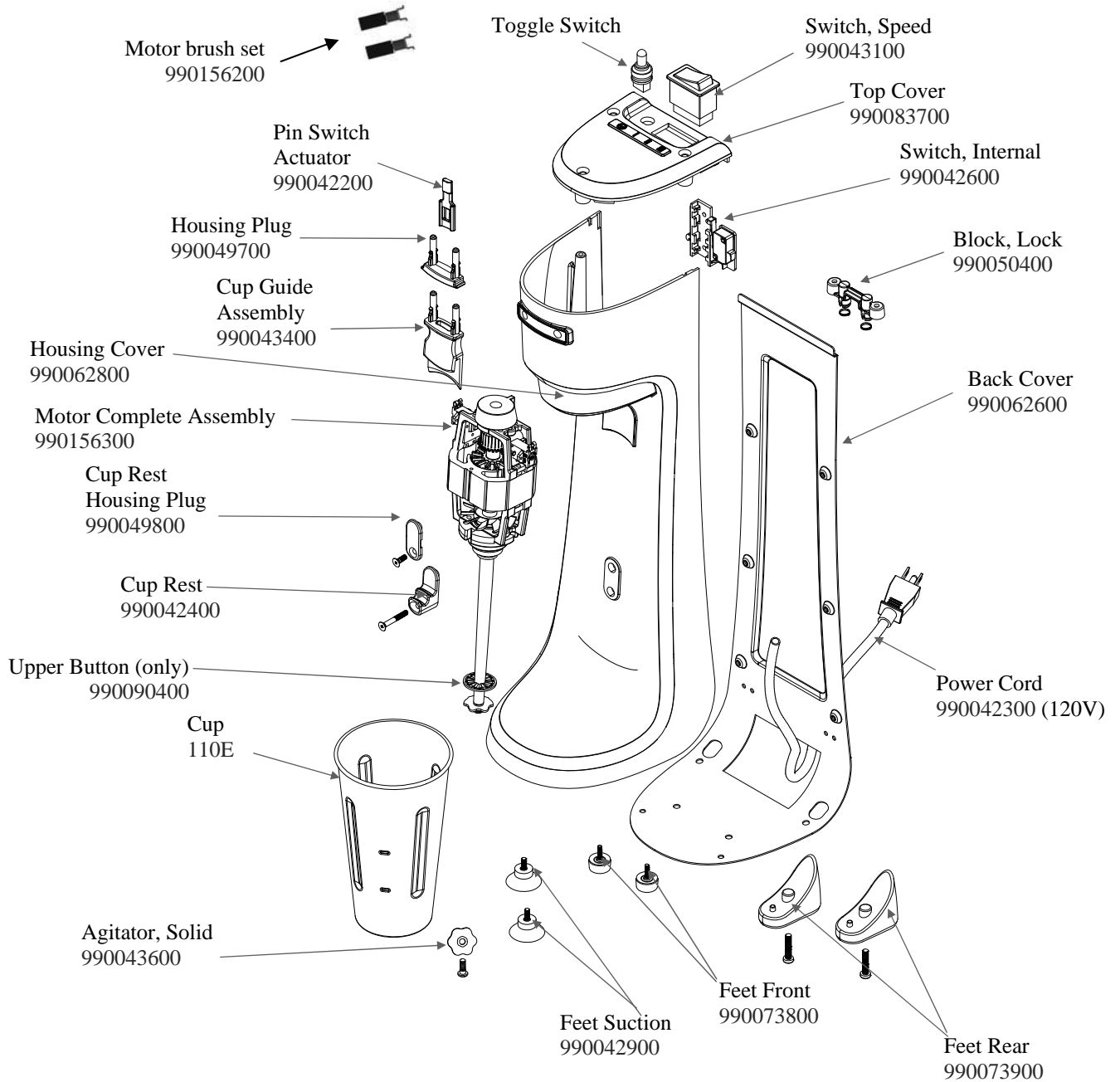

**Note:** Use toggle switch 990043000 on Series A-D machines and the top cover must be changed also to 990062200.

\*Switch Upgrade Kit for series A-D – 990092800  
 Includes: Upper Lid, Toggle Switch, Boot, Grounding Wire,  
 and Switch Adaptor

 4421 Waterfront Drive Glen Allen, VA 23060	Revision Description:	Added Motor Brush Set					
	Request Number:	DOC4027	Revision Date:	9/04/13	Approved by:	DOC4027	
	Issue Code(s):	CS, SP	Page:	1 of 3	Document #:	510021100	Rev:

## Replacement Parts and Accessories Diagram

**PROPRIETARY RIGHTS NOTICE** This document and all information contained within it is the property of Hamilton Beach Brands, Inc. (HBB). It is confidential and proprietary and has been provided to you for a limited purpose. It must be returned or destroyed upon request. Disclosure, reproduction or use of this document and any information contained within it, in full or in part, for any purpose is forbidden without the prior written consent of HBB. No photographs may be taken of any article fabricated or assembled from this document without the prior written consent of HBB.

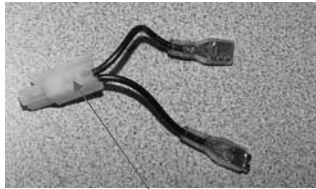

Switch Adaptor  
990088900

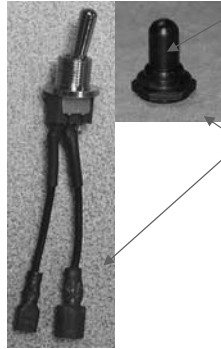

Boot  
990084200

Toggle Switch, Boot and Lead Wires  
– Sub-Assembly  
990083600

Ground Wire, Gasket  
and Ground Wire  
990088800

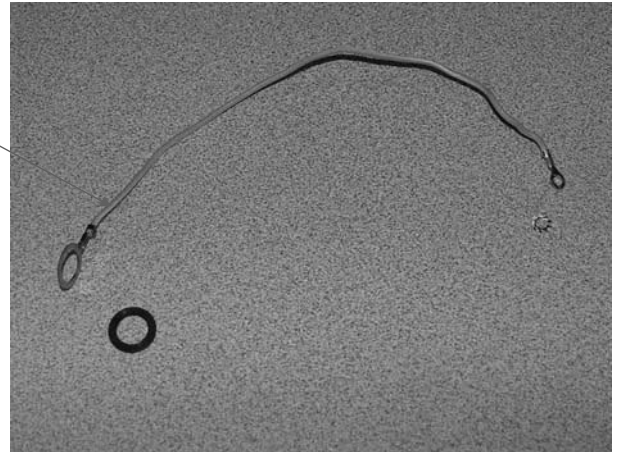

 4421 Waterfront Drive Glen Allen, VA 23060	Revision Description:		Added Motor Brush Set					
	Request Number:	DOC4027	Revision Date:	9/04/13	Approved by:	DOC4027		
	Issue Code(s):	CS, SP	Page:	2 of 3	Document #:	510021100	Rev:	E

## Replacement Parts and Accessories Diagram

**PROPRIETARY RIGHTS NOTICE** This document and all information contained within it is the property of Hamilton Beach Brands, Inc. (HBB). It is confidential and proprietary and has been provided to you for a limited purpose. It must be returned or destroyed upon request. Disclosure, reproduction or use of this document and any information contained within it, in full or in part, for any purpose is forbidden without the prior written consent of HBB. No photographs may be taken of any article fabricated or assembled from this document without the prior written consent of HBB.

### Accessories

Agitator,  
Alternative  
929

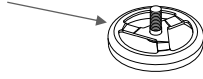

 4421 Waterfront Drive Glen Allen, VA 23060	Revision Description:		Added Motor Brush Set					
	Request Number:	<b>DOC4027</b>	Revision Date:	9/04/13	Approved by:	DOC4027		
	Issue Code(s):	CS, SP	Page:	3 of 3	Document #:	<b>510021100</b>	Rev:	<b>E</b>