

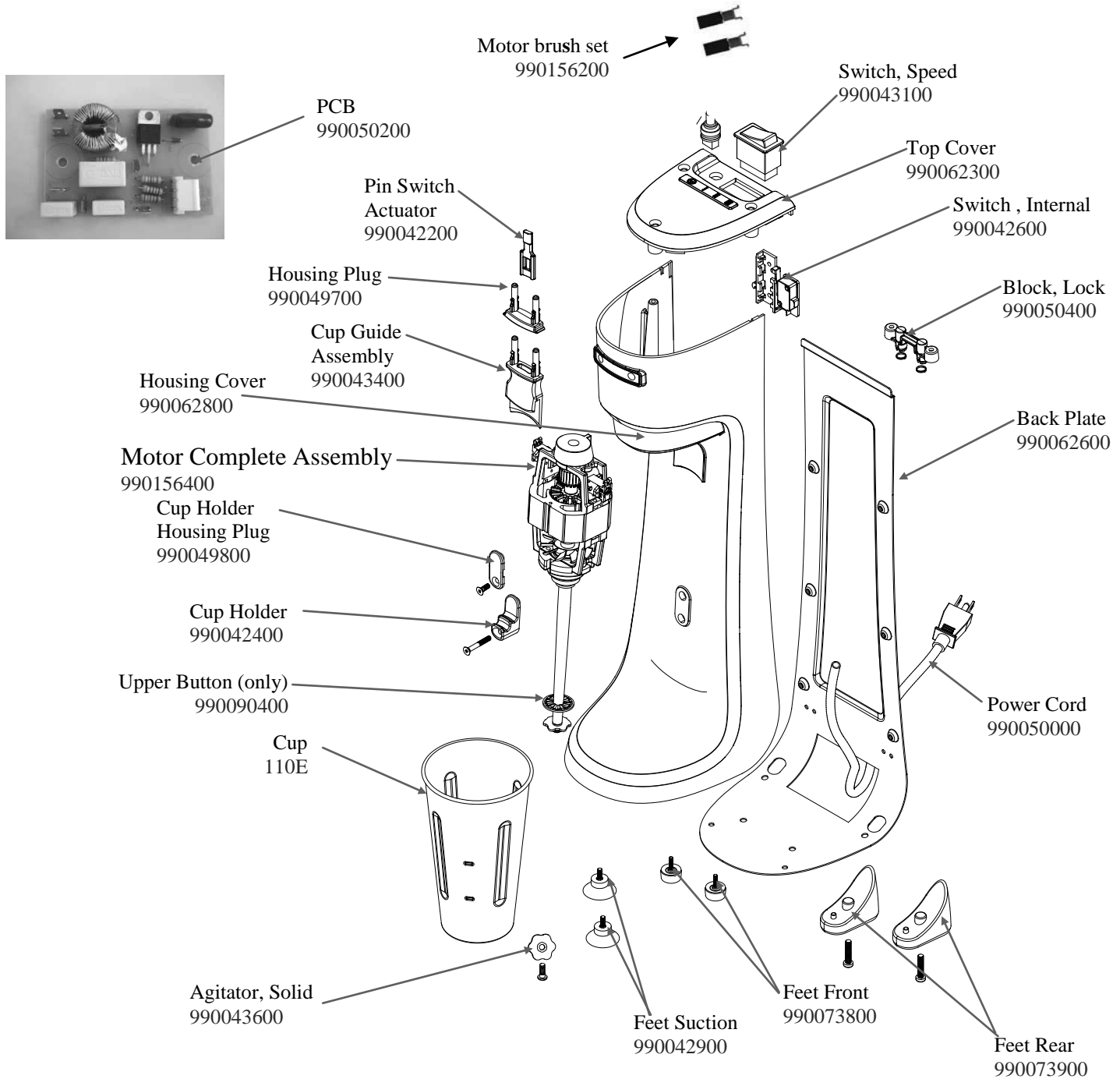

Parts and Accessories Diagram

HMD200-UK

PROPRIETARY RIGHTS NOTICE This document and all information contained within it is the property of Hamilton Beach Brands, Inc. (HBB). It is confidential and proprietary and has been provided to you for a limited purpose. It must be returned or destroyed upon request. Disclosure, reproduction or use of this document and any information contained within it, in full or in part, for any purpose is forbidden without the prior written consent of HBB. No photographs may be taken of any article fabricated or assembled from this document without the prior written consent of HBB.

Replacement Parts



 <p>Hamilton Beach 4421 Waterfront Drive Glen Allen, VA 23060</p>	Revision Description:	Update CARE Part Cup Part Number to 110E					
	Request Number:	DOC7696	Revision Date:	04/13/2017	Approved by:	DOC7696	
	Issue Code(s):		Page:	1 of 2	Document #:	540006540	Rev:

Accessories

PROPRIETARY RIGHTS NOTICE This document and all information contained within it is the property of Hamilton Beach Brands, Inc. (HBB). It is confidential and proprietary and has been provided to you for a limited purpose. It must be returned or destroyed upon request. Disclosure, reproduction or use of this document and any information contained within it, in full or in part, for any purpose is forbidden without the prior written consent of HBB. No photographs may be taken of any article fabricated or assembled from this document without the prior written consent of HBB.

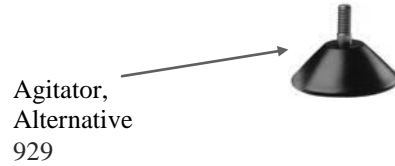
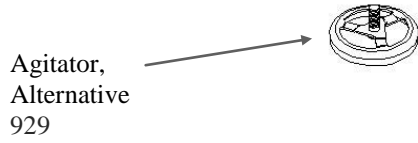

 4421 Waterfront Drive Glen Allen, VA 23060	Revision Description:		Update CARE Part Cup Part Number to 110E												
	Request Number:		DOC7696		Revision Date:		04/13/2017		Approved by:		DOC7696				
	Issue Code(s):				Page:		2 of 2		Document #:		540006540		Rev:		B