

Parts and Accessories Diagram

HMD400-BZ220

PROPRIETARY RIGHTS NOTICE This document and all information contained within it is the property of Hamilton Beach Brands, Inc. (HBB). It is confidential and proprietary and has been provided to you for a limited purpose. It must be returned or destroyed upon request. Disclosure, reproduction or use of this document and any information contained within it, in full or in part, for any purpose is forbidden without the prior written consent of HBB. No photographs may be taken of any article fabricated or assembled from this document without the prior written consent of HBB.

Replacement Parts

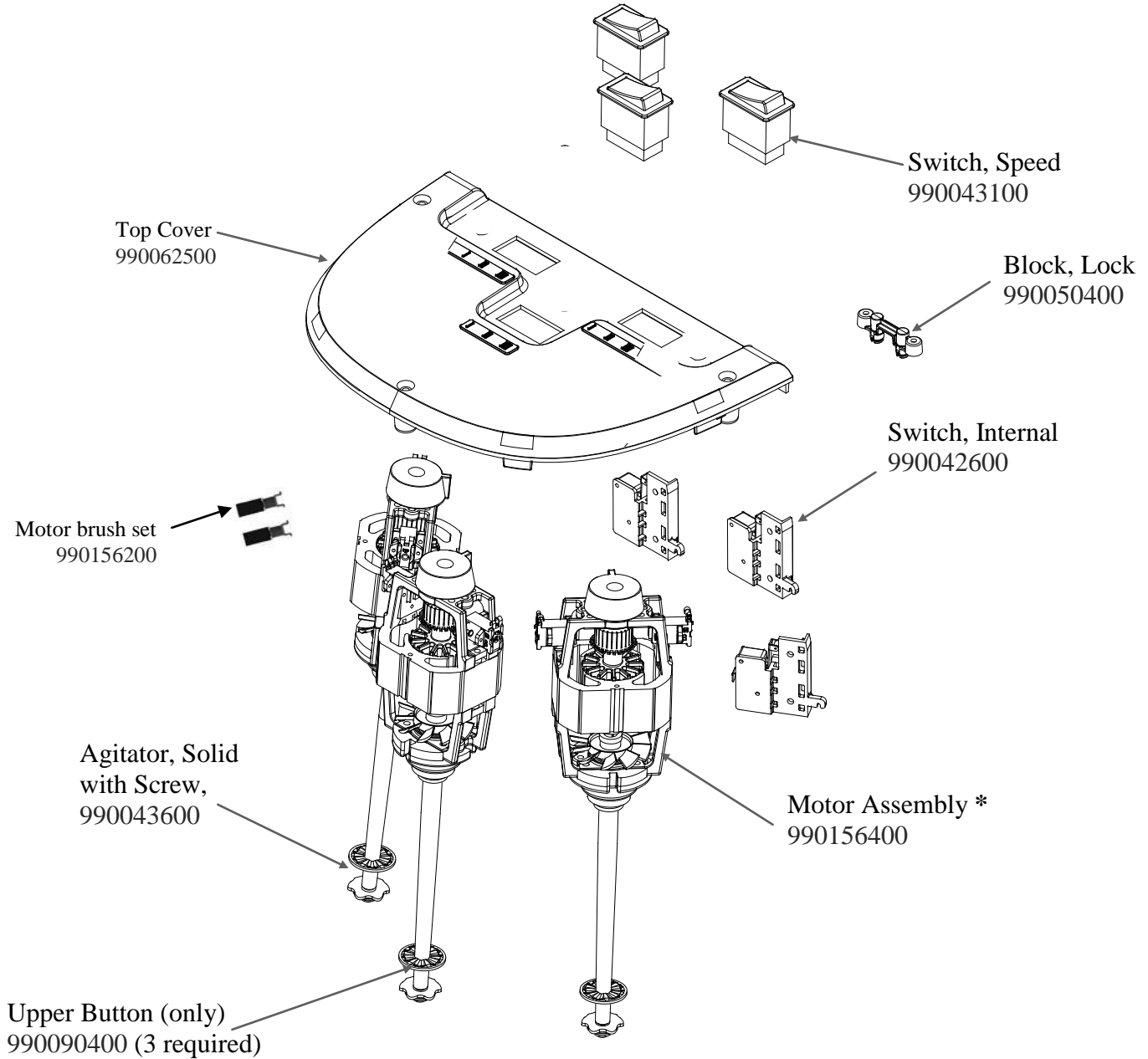

*** Factory Assembled, Not Available As Separate Pieces**

 Hamilton Beach 4421 Waterfront Drive Glen Allen, VA 23060	Revision Description:	Update CARE Part Cup Part Number to 110E					
	Request Number:	DOC7696	Revision Date:	04/13/2017	Approved by:	DOC7696	
	Issue Code(s):		Page:	1 of 4	Document #:	540007700	Rev:

Parts and Accessories Diagram

HMD400-BZ220

PROPRIETARY RIGHTS NOTICE This document and all information contained within it is the property of Hamilton Beach Brands, Inc. (HBB). It is confidential and proprietary and has been provided to you for a limited purpose. It must be returned or destroyed upon request. Disclosure, reproduction or use of this document and any information contained within it, in full or in part, for any purpose is forbidden without the prior written consent of HBB. No photographs may be taken of any article fabricated or assembled from this document without the prior written consent of HBB.

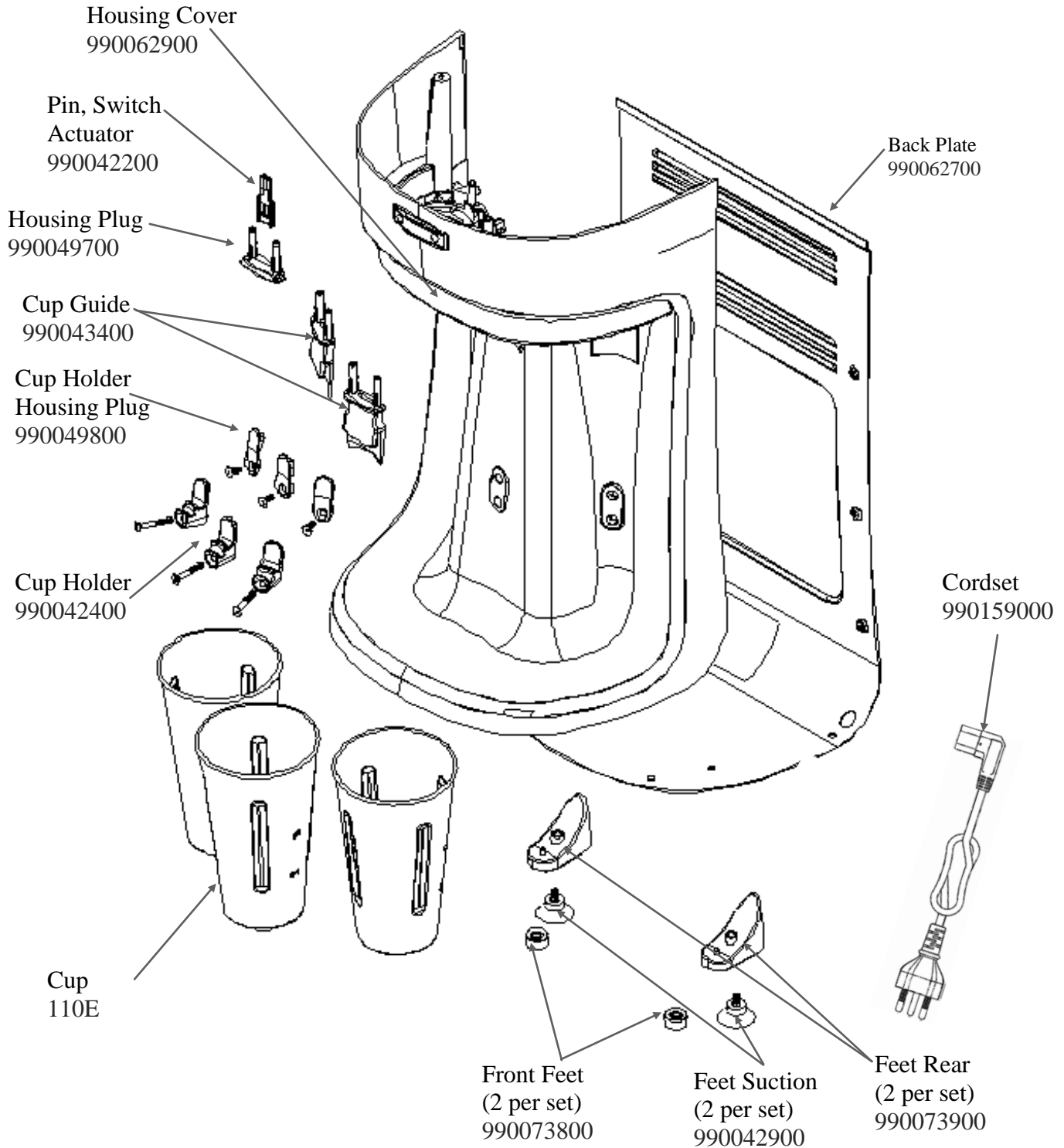

 <p>Hamilton Beach 4421 Waterfront Drive Glen Allen, VA 23060</p>	Revision Description:	Update CARE Part Cup Part Number to 110E					
	Request Number:	DOC7696	Revision Date:	04/13/2017	Approved by:	DOC7696	
	Issue Code(s):		Page:	2 of 4	Document #:	540007700	Rev:

Parts and Accessories Diagram

HMD400-BZ220

PROPRIETARY RIGHTS NOTICE This document and all information contained within it is the property of Hamilton Beach Brands, Inc. (HBB). It is confidential and proprietary and has been provided to you for a limited purpose. It must be returned or destroyed upon request. Disclosure, reproduction or use of this document and any information contained within it, in full or in part, for any purpose is forbidden without the prior written consent of HBB. No photographs may be taken of any article fabricated or assembled from this document without the prior written consent of HBB.

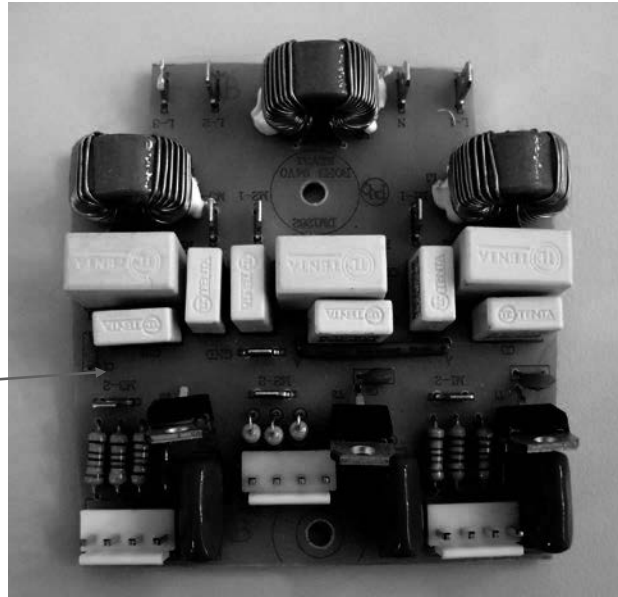

RFI Board
990050500

 Hamilton Beach 4421 Waterfront Drive Glen Allen, VA 23060	Revision Description:		Update CARE Part Cup Part Number to 110E					
	Request Number:	DOC7696	Revision Date:	04/13/2017	Approved by:	DOC7696		
	Issue Code(s):		Page:	3 of 4	Document #:	540007700	Rev:	C

Parts and Accessories Diagram HMD400-BZ220

PROPRIETARY RIGHTS NOTICE This document and all information contained within it is the property of Hamilton Beach Brands, Inc. (HBB). It is confidential and proprietary and has been provided to you for a limited purpose. It must be returned or destroyed upon request. Disclosure, reproduction or use of this document and any information contained within it, in full or in part, for any purpose is forbidden without the prior written consent of HBB. No photographs may be taken of any article fabricated or assembled from this document without the prior written consent of HBB.

Accessories

Agitator
928



Agitator
929

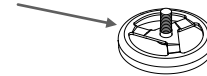

Agitator
930



 Hamilton Beach 4421 Waterfront Drive Glen Allen, VA 23060	Revision Description:	Update CARE Part Cup Part Number to 110E						
	Request Number:	DOC7696	Revision Date:	04/13/2017	Approved by:	DOC7696		
	Issue Code(s):		Page:	4 of 4	Document #:	540007700	Rev:	C