



Flav-R-Savor[®]

Tall Humidified Holding Cabinets

FSHC Series

FSHC-12

FSHC-17

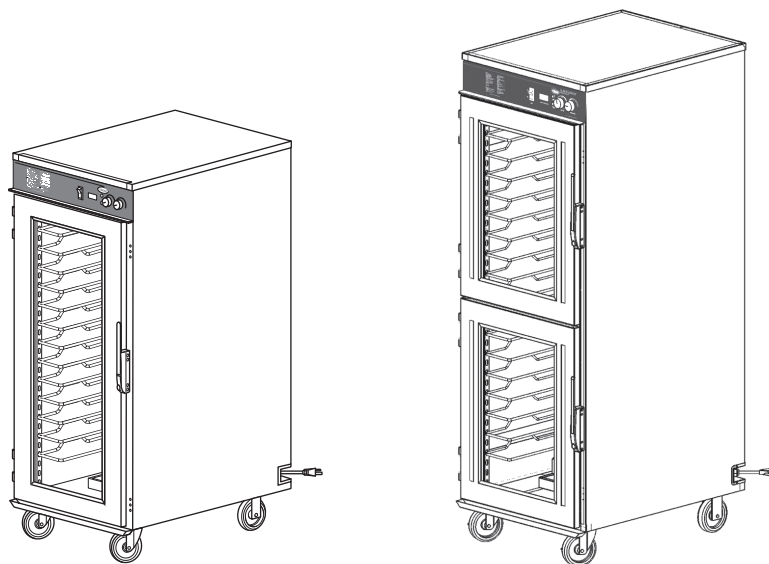

REPLACEMENT PARTS LIST

HATCO FLAV-R-SAVOR® TALL HUMIDIFIED HOLDING CABINET

FSHC-12 and FSHC-17 Series

CAUTION

Use of replacement parts other than those supplied by Hatco Corporation may result in damage to the unit or injury to personnel and will void all warranties.

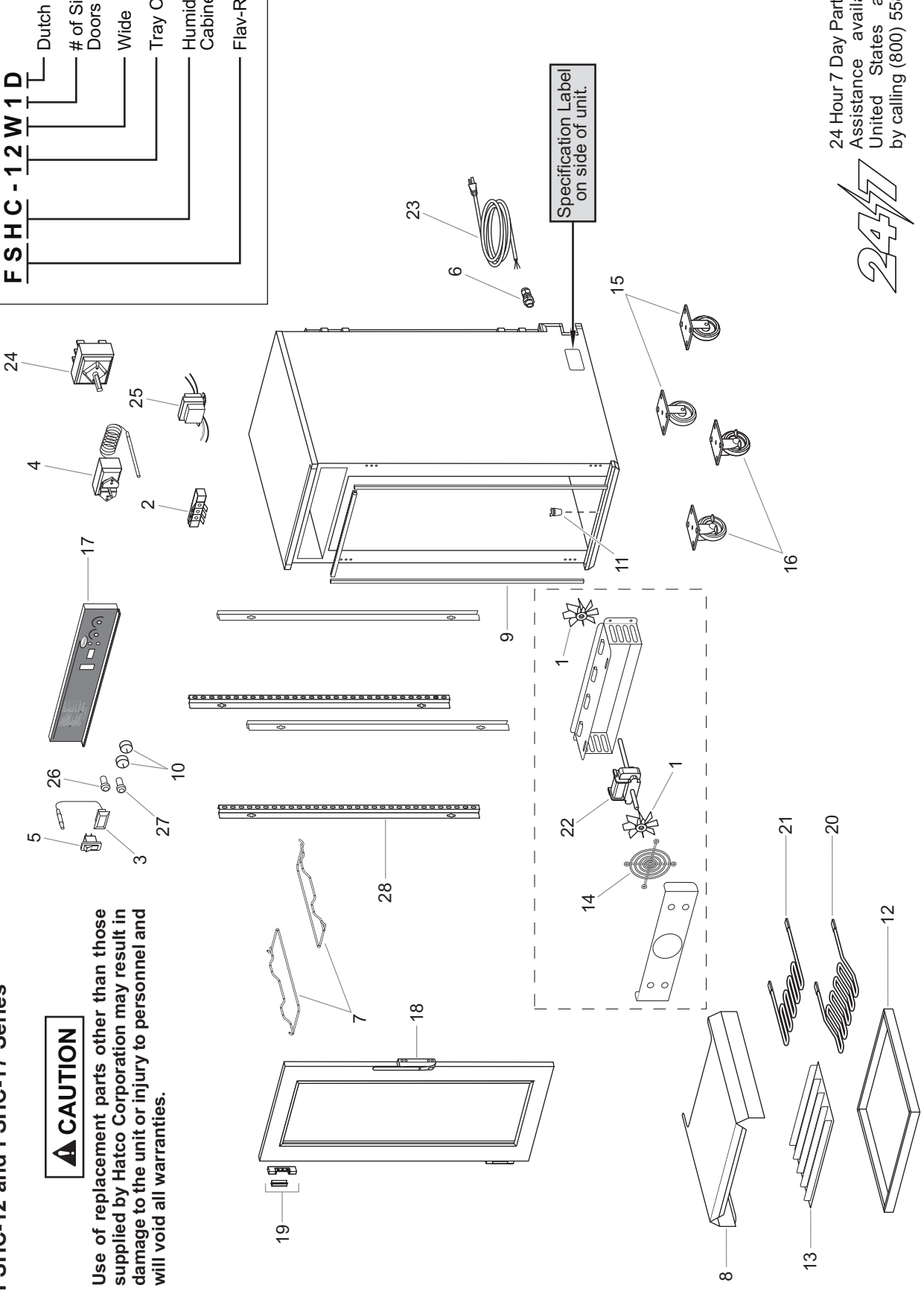
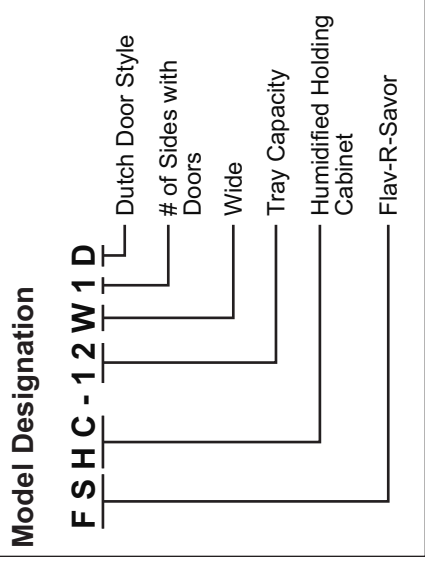

24/7

24 Hour 7 Day Parts and Service Assistance available in the United States and Canada by calling (800) 558-0607.



PARTS COMMON TO ALL FSHC-12 AND FSHC-17 MODELS

Item	Description	Part No.	Qty.	Item	Description	Part No.	Qty.
1	Fan Blade, Blower	X02.12.099.00	2	10	Control Knob	05.30.019.00	2
2	Terminal Block	X02.15.053.00	1	11	Stopper, Drain	X04.48.031.00	1-2
3	Temperature Indicator (F°)	02.16.057.00	1	12	Water Pan*	X04.48.029.00	1
	Temperature Indicator (C°)	02.16.058.00	1	13	Grid Insert, Water Pan♦	X04.40.030.00	1
4	Air Heat Thermostat with Bulb	X02.16.142.00	1	14	Fan Guard	02.12.011.00	1
5	On/Off Switch, Lighted	X02.19.188.00	1	15	Caster 5", Rigid	X04.17.1382.00	2
6	Cord Grip Assembly	02.20.259.00	1	16	Caster 5", Swivel and Brake	X04.17.1383.00	2
7	Pan Slide	X04.17.1186.00	24-34	17	Decal, Control Plate	X07.03.615.00	1
8	Heat Tunnel Cover	X04.17.1277.00	1	18	Door Handle	X04.26.391.00	1-4
9	Door Gasket	X05.06.095.00	Per Foot	19	Door Hinge	X04.26.390.00	2-8

* FSHC-12 and FSHC-17 models manufactured before February 15, 2006 use part number X04.48.053.00.

♦ FSHC-12 and FSHC-17 models manufactured before February 15, 2006 use part number X04.48.052.00.

NOTE: The last four digits in a ten digit numerical serial number are the manufacturing date code.

Example: Serial number 3330840704 has a date code of "0704" which indicates the following: 0704



PARTS SPECIFIC TO MODEL FSHC-12W1

Item	Description	120V	208/240V	220-240V
		60 Hz	60 Hz	50/60 Hz
20	Water Heating Element, 110W	X02.05.629.00	X02.05.671.00	X02.05.671.00
21	Air Heating Element, 1500W	R02.08.623.00	X02.08.622.00	X02.08.622.00
22	Blower Motor and Blades	R02.12.098.00	R02.12.106.00	R02.12.106.00
23	Power Cord and Plug	X02.18.254.00†	X02.18.256.00	X02.18.257.00‡ or X02.18.258.00‡
24	Humidity Control Switch	X02.19.187.00	X02.19.207.00	X.02.19.207.00
25	Transformer, 24V	02.17.022.00	02.17.023.00	02.17.023.00
26	Indicator Light, Red	02.19.070R.00	02.19.071R.00	02.19.071R.00
27	Indicator Light, Green	02.19.070G.00	02.19.071G.00	02.19.071G.00
28	Upright Tray Slide Holder (Qty. 4)	X04.17.1404.00	X04.17.1404.00	X04.17.1404.00
Electrical Drawing		10-01-529	10-01-529	10-01-529

PARTS SPECIFIC TO MODEL FSHC-12W2

Item	Description	120V	208/240V	220-240V
		60 Hz	60 Hz	50/60 Hz
20	Water Heating Element, 110W	X02.05.629.00	X02.05.671.00	X02.05.671.00
21	Air Heating Element, 1500W	R02.08.623.00	X02.08.622.00	X02.08.622.00
22	Blower Motor and Blades	R02.12.098.00	R02.12.106.00	R02.12.106.00
23	Power Cord and Plug	X02.18.254.00†	X02.18.256.00	X02.18.257.00‡ or X02.18.258.00‡
24	Humidity Control Switch	X02.19.187.00	X02.19.207.00	X.02.19.207.00
25	Transformer, 24V	02.17.022.00	02.17.023.00	02.17.023.00
26	Indicator Light, Red	02.19.070R.00	02.19.071R.00	02.19.071R.00
27	Indicator Light, Green	02.19.070G.00	02.19.071G.00	02.19.071G.00
28	Upright Tray Slide Holder (Qty. 4)	X04.17.1404.00	X04.17.1404.00	X04.17.1404.00
Electrical Drawing		10-01-529	10-01-529	10-01-529

The shaded areas contain information for **International models only**.

† 120 Volt units for Canada use a 20 amp power cord and plug, P/N X02.18.222.00.

‡ 220-240 units for export use either X02.18.257.00 (BS 1363 style) or X02.18.258.00 (CEE 717 Schuko style).



PARTS SPECIFIC TO MODEL FSHC-17W1

Item	Description	120V 60 Hz	208/240V 60 Hz	220-240V 50/60 Hz
20	Water Heating Element, 110W	X02.05.629.00	X02.05.671.00	X02.05.671.00
21	Air Heating Element, 1500W	R02.08.623.00	X02.08.622.00	X02.08.622.00
22	Blower Motor and Blades	R02.12.098.00	R02.12.106.00	R02.12.106.00
23	Power Cord and Plug	X02.18.254.00†	X02.18.256.00	X02.18.257.00‡ or X02.18.258.00‡
24	Humidity Control Switch	X02.19.187.00	X02.19.207.00	X.02.19.207.00
25	Transformer, 24V	02.17.022.00	02.17.023.00	02.17.023.00
26	Indicator Light, Red	02.19.070R.00	02.19.071R.00	02.19.071R.00
27	Indicator Light, Green	02.19.070G.00	02.19.071G.00	02.19.071G.00
28	Upright Tray Slide Holder (Qty. 4)	X04.17.1405.00	X04.17.1405.00	X04.17.1405.00
Electrical Drawing		10-01-529	10-01-529	10-01-529

PARTS SPECIFIC TO MODEL FSHC-17W1D

Item	Description	120V 60 Hz	208/240V 60 Hz	220-240V 50/60 Hz
20	Water Heating Element, 110W	X02.05.629.00	X02.05.671.00	X02.05.671.00
21	Air Heating Element, 1500W	R02.08.623.00	X02.08.622.00	X02.08.622.00
22	Blower Motor and Blades	R02.12.098.00	R02.12.106.00	R02.12.106.00
23	Power Cord and Plug	X02.18.254.00†	X02.18.256.00	X02.18.257.00‡ or X02.18.258.00‡
24	Humidity Control Switch	X02.19.187.00	X02.19.207.00	X.02.19.207.00
25	Transformer, 24V	02.17.022.00	02.17.023.00	02.17.023.00
26	Indicator Light, Red	02.19.070R.00	02.19.071R.00	02.19.071R.00
27	Indicator Light, Green	02.19.070G.00	02.19.071G.00	02.19.071G.00
28	Upright Tray Slide Holder (Qty. 4)	X04.17.1405.00	X04.17.1405.00	X04.17.1405.00
Electrical Drawing		10-01-529	10-01-529	10-01-529

The shaded areas contain information for **International models only**.

† 120 Volt units for Canada use a 20 amp power cord and plug, P/N X02.18.222.00.

‡ 220-240 units for export use either X02.18.257.00 (BS 1363 style) or X02.18.258.00 (CEE 7/7 Schuko style).



PARTS SPECIFIC TO MODEL FSHC-17W2

Item	Description	120V 60 Hz	208/240V 60 Hz	220-240V 50/60 Hz
20	Water Heating Element, 110W	X02.05.629.00	X02.05.671.00	X02.05.671.00
21	Air Heating Element, 1500W	R02.08.623.00	X02.08.622.00	X02.08.622.00
22	Blower Motor and Blades	R02.12.098.00	R02.12.106.00	R02.12.106.00
23	Power Cord and Plug	X02.18.254.00†	X02.18.256.00	X02.18.257.00‡ or X02.18.258.00‡
24	Humidity Control Switch	X02.19.187.00	X02.19.207.00	X.02.19.207.00
25	Transformer, 24V	02.17.022.00	02.17.023.00	02.17.023.00
26	Indicator Light, Red	02.19.070R.00	02.19.071R.00	02.19.071R.00
27	Indicator Light, Green	02.19.070G.00	02.19.071G.00	02.19.071G.00
28	Upright Tray Slide Holder (Qty. 4)	X04.17.1405.00	X04.17.1405.00	X04.17.1405.00
	Electrical Drawing	10-01-529	10-01-529	10-01-529

PARTS SPECIFIC TO MODEL FSHC-17W2D

Item	Description	120V 60 Hz	208/240V 60 Hz	220-240V 50/60 Hz
20	Water Heating Element, 110W	X02.05.629.00	X02.05.671.00	X02.05.671.00
21	Air Heating Element, 1500W	R02.08.623.00	X02.08.622.00	X02.08.622.00
22	Blower Motor and Blades	R02.12.098.00	R02.12.106.00	R02.12.106.00
23	Power Cord and Plug	X02.18.254.00†	X02.18.256.00	X02.18.257.00‡ or X02.18.258.00‡
24	Humidity Control Switch	X02.19.187.00	X02.19.207.00	X.02.19.207.00
25	Transformer, 24V	02.17.022.00	02.17.023.00	02.17.023.00
26	Indicator Light, Red	02.19.070R.00	02.19.071R.00	02.19.071R.00
27	Indicator Light, Green	02.19.070G.00	02.19.071G.00	02.19.071G.00
28	Upright Tray Slide Holder (Qty. 4)	X04.17.1405.00	X04.17.1405.00	X04.17.1405.00
	Electrical Drawing	10-01-529	10-01-529	10-01-529

The shaded areas contain information for **International models only**.

† 120 Volt units for Canada use a 20 amp power cord and plug, P/N X02.18.222.00.

‡ 220-240 units for export use either X02.18.257.00 (BS 1363 style) or X02.18.258.00 (CEE 7/7 Schuko style).

NOTES



HATCO AUTHORIZED PARTS DISTRIBUTORS

ALABAMA

Jones McLeod Appl. Svc.
Birmingham 205-251-0159

ARIZONA

Service Solutions Group
Phoenix 602-234-2443

Byassee Equipment Co.
Phoenix 602-252-0402

CALIFORNIA

Industrial Electric
Commercial Parts & Service, Inc.
Huntington Beach 714-379-7100

Chapman Appl. Service
San Diego 619-298-7106

P & D Appliance
Commercial Parts & Service, Inc.
S. San Francisco 650-635-1900

COLORADO

Hawkins Commercial Appliance
Englewood 303-781-5548

FLORIDA

Whaley Foodservice Repair
Jacksonville 904-725-7800

Nass Service Co., Inc.
Orlando 407-425-2681

B.G.S.I.
Pompano Beach 954-971-0456

Comm. Appliance Service
Tampa 813-663-0313

GEORGIA

TWC Services
Smyrna 770-438-9797

Heritage Service Group
Norcross 866-388-9837

Southeastern Rest. Svc.
Norcross 770-446-6177

HAWAII

Burney's Comm. Service, Inc.
Honolulu 808-848-1466

Food Equip Parts & Service
Honolulu 808-847-4871

ILLINOIS

Parts Town
Lombard 708-865-7278

Eichenauer Elec. Service
Decatur 217-429-4229

Midwest Elec. Appl. Service
Elmhurst 630-279-8000

Cone's Repair Service
Moline 309-797-5323

INDIANA

GCS Service
Indianapolis 317-545-9655

IOWA

Electric Motor Service Co.
Davenport 319-323-1823

Goodwin Tucker Group
Des Moines 515-262-9308

KENTUCKY

Service Solutions Group
Lexington 859-254-8854

Service Solutions Group
Louisville 502-451-5411

LOUISIANA

Chandlers Parts & Service
Baton Rouge 225-272-6620

MARYLAND

Electric Motor Service
Baltimore 410-467-8080

GCS Service
Silver Spring 301-585-7550

MASSACHUSETTS

Ace Service Co., Inc.
Needham 781-449-4220

MICHIGAN

Bildons Appliance Service
Detroit 248-478-3320

Commercial Kitchen Service
Bay City 517-893-4561

Midwest Food Equip. Service
Grandville 616-261-2000

MINNESOTA

GCS Service
Plymouth 800-345-4221

MISSOURI

General Parts
Kansas City 816-421-5400

Commercial Kitchen Services
St. Louis 314-890-0700

Kaemmerlen Parts & Service
St. Louis 314-535-2222

NEBRASKA

Anderson Electric
Omaha 402-341-1414

NEVADA

Burney's Commercial
Las Vegas 702-736-0006

Hi. Tech Commercial Service
N. Las Vegas 702-649-4616

NEW JERSEY

Jay Hill Repair
Fairfield 973-575-9145

Service Plus
Flanders 973-691-6300

NEW YORK

Acme American Repairs, Inc.
Brooklyn 718-456-6544

Alpro Service Co.
Brooklyn 718-386-2515

Appliance Installation
Buffalo 716-884-7425

Duffy's Equipment Services, Inc.
Buffalo 800-836-1014

3Wire Northern
Plattsburgh 800-634-5005

Duffy's Equipment Services, Inc.
Sauquoit 800-836-1014

J.B. Brady, Inc.
Syracuse 315-422-9271

NORTH CAROLINA

Authorized Appliance
Charlotte 704-377-4501

OHIO

Akron/Canton Comm. Svc. Inc.
Akron 330-753-6635

Service Solutions Group
Cincinnati 513-772-6600

Commercial Parts and Service
Columbus 614-221-0057

Electrical Appl. Repair Service
Independence 216-459-8700

E. A. Wichman Co.
Toledo 419-385-9121

OKLAHOMA

Hagar Rest. Service, Inc.
Oklahoma City 405-235-2184

Krueger, Inc.
Oklahoma City 405-528-8883

OREGON

Ron's Service, Inc.
Portland 503-624-0890

PENNSYLVANIA

Elmer Schultz Services
Philadelphia 215-627-5401

FAST Comm. Appl. Service
Philadelphia 215-288-4800

Appliance Installation & Service
Pittsburgh 412-809-0244

K & D Service Co.
Harrisburg 717-236-9039

Electric Repair Co.
Reading 610-376-5444

RHODE ISLAND

Marshall Electric Co.
Providence 401-331-1163

SOUTH CAROLINA

Whaley Foodservice Repair
W. Columbia 803-791-4420

TENNESSEE

Camp Electric
Memphis 901-527-7543

TEXAS

GCS Service
Fort Worth 800-433-1804

Armstrong Repair Service
Houston 713-666-7100

Cooking Equipment Specialist
Mesquite 972-686-6666

Commercial Kitchen Repair Co.
San Antonio 210-735-2811

UTAH

La Monica's Rest. Equip. Service
Murray 801-263-3221

VIRGINIA

Daubers
Norfolk 757-855-4097

Daubers
Springfield 703-866-3600

WASHINGTON

3Wire Restaurant Appliance
Seattle 866-770-2022

WISCONSIN

A.S.C., Inc.
Madison 608-246-3160

A.S.C., Inc.
Milwaukee 414-543-6460

CANADA

ALBERTA

Key Food Equipment Service
Edmonton 780-438-1690

BRITISH COLUMBIA

Key Food Equipment Service
Vancouver 604-433-4484

Key Food Equipment Service
Victoria 250-920-4888

MANITOBA

Air Rite, Inc.
Winnipeg 204-895-2300

NEW BRUNSWICK

EMR Services, Ltd.
Moncton 506-855-4228

ONTARIO

R.G. Henderson Ltd.
Toronto 416-422-5580

Choquette - CKS, Inc.
Ottawa 613-739-8458

QUÉBEC

Choquette - CKS, Inc.
Montreal 514-722-2000

Choquette - CKS, Inc.
Québec City 418-681-3944

UNITED KINGDOM

Marren Group
Northants +44(0)1933 666233

