



GLO-RAY[®]

Merchandising Warmer

GRHW-SGD Series

GRHW-1SGD

**REPLACEMENT
PARTS LIST**

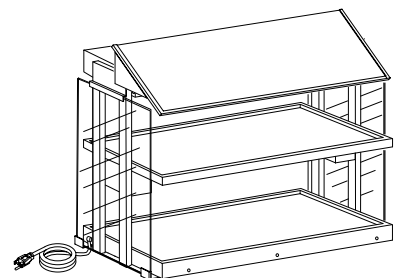

**HATCO GLO-RAY®
MERCHANTISING WARMER
GRHW-SGD SERIES**

Model Designation

| | |
|-----------|----------------|
| GRHW-1SGD | G = Glo |
| | R = Ray |
| | H = Hash Brown |
| | W = Warmer |
| | 1 = One |
| | S = Sign |
| | G = Glass |
| | D = Dual Shelf |

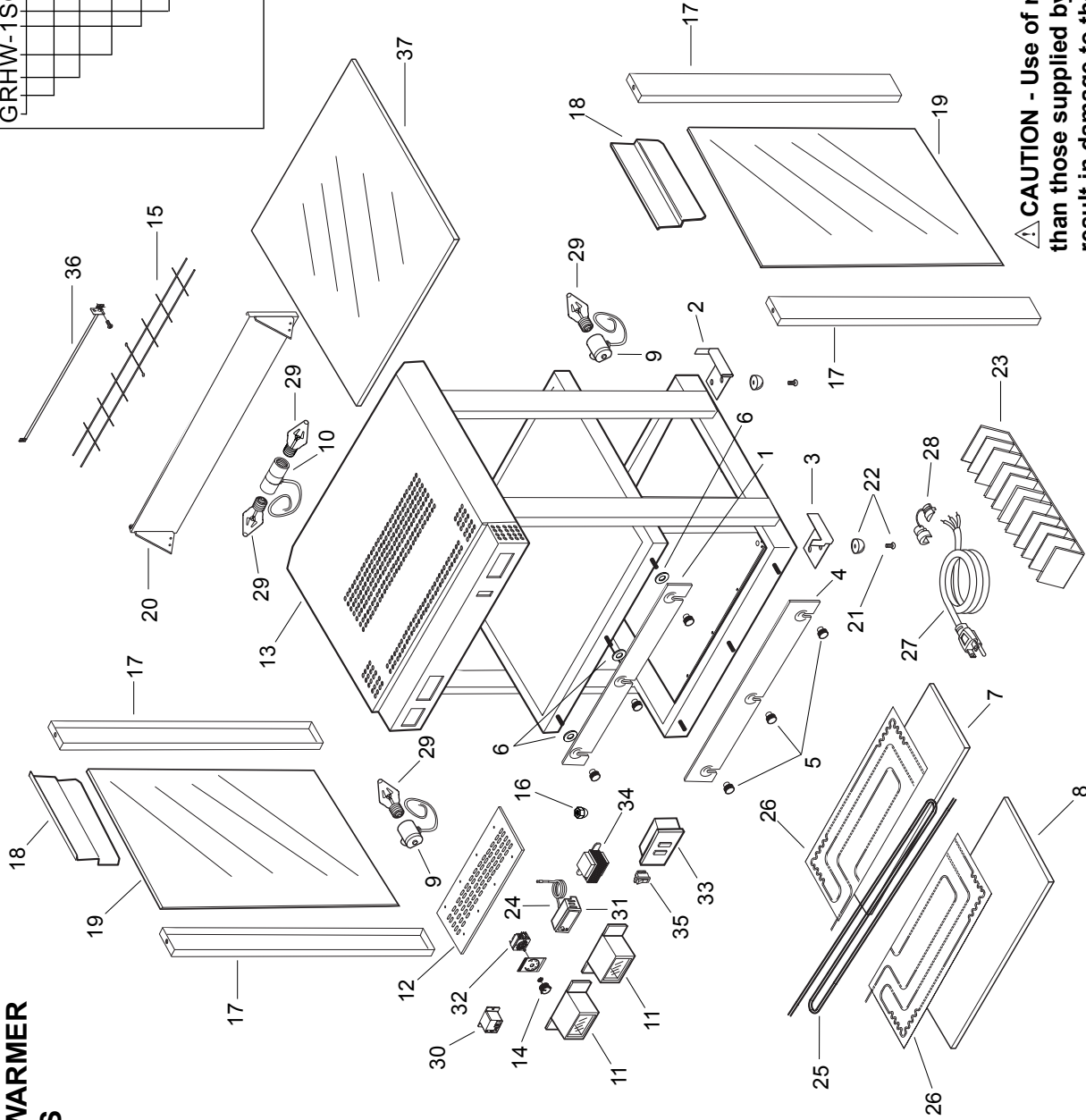

CAUTION - Use of replacement parts other than those supplied by Hatco Corporation may result in damage to the unit or injury to personnel.

PARTS COMMON TO ALL GRHW-SGD MODELS

| ITEM | DESCRIPTION | PART NO. | QTY. | ITEM | DESCRIPTION | PART NO. | QTY. |
|------|--|---------------|------|------|--|---------------|------|
| 1 | Bracket, Personnel | 04.19.804.00 | 2 | 12 | Control Compartment Cover | 04.19.816.00 | 1 |
| 2 | Bracket, Lower Glass, LH | 04.19.810.00 | 2 | 13 | Hood, Exterior | 04.19.820.00 | 1 |
| 3 | Bracket, Lower Glass, RH | 04.19.811.00 | 2 | 14 | Knob, Electronic Thermostat | 05.30.042.00 | 1 |
| 4 | Base Protector | 04.19.821.00 | 2 | 15 | Wire Guard | 04.19.795.00 | 1 |
| 5 | Thumb Nut | 05.04.466.00 | 12 | 16 | Acorn Nut | 05.04.068A.00 | 2 |
| 6 | Spacer | 02.20.101.00 | 6 | 17 | Post Cover | 04.19.801.00 | 4 |
| 7 | Bottom Cover for 6" (15 cm) | | | 18 | Bracket, Upper Glass | 04.19.809.00 | 2 |
| 8 | Extrusion Bottom Cover for 7-3/4" (20 cm) | 04.19.201.00 | 1 | 19 | Side Glass | 04.40.156.00 | 2 |
| 9 | Extrusion Single Light Socket with Leads | 04.19.250.00 | 1 | 20 | Sign Holder | 04.19.796.00 | 1 |
| 10 | Dual Light Socket with Leads | 02.30.044.00 | 2 | 21 | Screw, Rubber Foot | 05.04.190.00 | 4 |
| 11 | Control Cover | 02.30.045.00 | 1 | 22 | Rubber Foot with Screw, 5/8" (4 cm), Gray | R05.30.086.00 | 4 |
| | | R04.19.812.00 | 2 | 23 | Hash Brown Holder (Optional) | 04.19.797.00 | 2 |

PARTS SPECIFIC TO GRHW-1SGD MODELS

| ITEM | DESCRIPTION | 100V | | 120V | | 120/208V | | 120/240V | | 220V | | 240V | | 220-230V CE | | 230-240V CE | |
|------|---|------|--|---------------|--|----------|--|----------|--|------|--|------|--|-------------|--|-------------|--|
| | | | | | | | | | | | | | | | | | |
| 24 | Temperature Probe | --- | | | | | | | | | | | | | | | |
| 25 | Foil Element, Rope, 50 Watt (Qty. 2) | --- | | 02.01.057.00 | | | | | | | | | | | | | |
| 26 | Base Heating Element, Blanket, 100 Watt (Qty. 2) | --- | | 02.05.127.00 | | | | | | | | | | | | | |
| 27 | Cord and Plug Assembly | --- | | 02.05.302.00 | | | | | | | | | | | | | |
| 28 | Cord Grip | --- | | 02.18.154.00 | | | | | | | | | | | | | |
| 29 | Light Bulb, 60 Watt (Qty. 4) | --- | | 02.20.206.00 | | | | | | | | | | | | | |
| 30 | Relay-30 Amp, 24 Volt | --- | | 02.30.043.00 | | | | | | | | | | | | | |
| 31 | Electronic Temperature Controller with Probe, Base | --- | | R02.01.050.00 | | | | | | | | | | | | | |
| 32 | Electronic Controller, Heated Glass | --- | | R02.01.049.00 | | | | | | | | | | | | | |
| 33 | Ground Fault Circuit Interrupt Switch (GFCI) | --- | | 02.01.193.00 | | | | | | | | | | | | | |
| 34 | Transformer - 24 Volt | --- | | 02.01.194.00 | | | | | | | | | | | | | |
| 35 | Switch, On/Off | --- | | 02.17.022.00 | | | | | | | | | | | | | |
| 36 | Heating Element, Upper, 350 Watt | --- | | 02.19.080.00 | | | | | | | | | | | | | |
| 37 | Heated Glass Shelf Assembly Electrical Diagram | --- | | R02.08.306.00 | | | | | | | | | | | | | |
| | | --- | | 04.40.155.00 | | | | | | | | | | | | | |
| | | --- | | 10.01.003.00 | | | | | | | | | | | | | |

Shaded area reflects **export models only**.

HATCO AUTHORIZED PARTS DISTRIBUTORS

ALABAMA

Jones McLeod Appl. Svc.
Birmingham 205-251-0159

ARIZONA

Auth. Comm. Food Equip.
Phoenix 602-234-2443
Byassee Equipment Co.
Phoenix 602-252-0402

CALIFORNIA

Industrial Electric
Huntington Beach 714-379-7100
Chapman Appl. Service
San Diego 619-298-7106
P & D Appliance
S. San Francisco 650-635-1900

COLORADO

Hawkins Commercial Appliance
Englewood 303-781-5548

DELAWARE

Food Equipment Service
Wilmington 302-996-9363

FLORIDA

Whaley Foodservice Repair
Jacksonville 904-725-7800
Nass Service Co., Inc.
Orlando 407-425-2681
B.G.S.I.
Pompano Beach 954-971-0456
Comm. Appliance Service
Tampa 813-663-0313

GEORGIA

Southeastern Rest. Svc.
Norcross 770-446-6177

HAWAII

Burney's Comm. Service, Inc.
Honolulu 808-848-1466
Food Equip Parts & Service
Honolulu 808-847-4871

ILLINOIS

Parts Town
Lombard 708-865-7278
Eichenauer Elec. Service
Decatur 217-429-4229
Midwest Elec. Appl. Service
Elmhurst 630-279-8000
Cone's Repair Service
Moline 309-797-5323

INDIANA

GCS Service
Indianapolis 317-545-9655

IOWA

Electric Motor Service Co.
Davenport 319-323-1823

KENTUCKY

GCS Service
Louisville 502-367-1788

LOUISIANA

Chandlers Parts & Service
Baton Rouge 225-272-6620
Bana Comm. Parts, Inc.
Shreveport 318-631-6550

MARYLAND

Electric Motor Service
Baltimore 410-467-8080
GCS Service
Silver Spring 301-585-7550

MASSACHUSETTS

Ace Service Co., Inc.
Needham 781-449-4220

MICHIGAN

Commercial Kitchen Service
Bay City 517-893-4561
Bildons Appliance Service
Detroit 248-478-3320
Midwest Food Equip. Service
Grandville 616-261-2000

MINNESOTA

GCS Service
Minneapolis 612-546-4221

MISSOURI

GCS Service
Kansas City 816-920-5999
Commercial Kitchen Services
St. Louis 314-890-0700
Kaemmerlen Parts & Service
St. Louis 314-535-2222

NEBRASKA

Anderson Electric
Omaha 402-341-1414

NEVADA

Burney's Commercial
Las Vegas 702-736-0006
Hi. Tech Commercial Service
N. Las Vegas 702-649-4616

NEW JERSEY

Jay Hill Repair
Fairfield 973-575-9145
Service Plus
Flanders 973-691-6300

NEW YORK

Acme American Repairs, Inc.
Brooklyn 718-456-6544
Alpro Service Co.
Brooklyn 718-386-2515

NEW YORK (continued)

Appliance Installation
Buffalo 716-884-7425
Northern Parts Dist.
Plattsburgh 518-563-3200
J. B. Brady, Inc.
Syracuse 315-422-9271

NORTH CAROLINA

Authorized Appliance
Charlotte 704-377-4501

OHIO

Akron/Canton Comm. Svc. Inc.
Akron 330-753-6635
Certified Service Center
Cincinnati 513-772-6600
GCS Service
Columbus 614-476-3225
Electrical Appl. Repair Service
Independence 216-459-8700
E. A. Wichman Co.
Toledo 419-385-9121

OKLAHOMA

Hagar Rest. Service, Inc.
Oklahoma City 405-235-2184
Krueger, Inc.
Oklahoma City 405-528-8883

OREGON

Bressie Electric Co.
Portland 503-231-7171
Ron's Service, Inc.
Portland 503-624-0890

PENNSYLVANIA

Authorized Factory Service
Coraopolis 412-262-2330
FAST Comm. Appl. Service
Philadelphia 215-288-4800
GCS Service
Pittsburgh 412-787-1970
K & D Service Co.
Harrisburg 717-236-9039
Elmer Schultz Services
Philadelphia 215-627-5401
Electric Repair Co.
Reading 610-376-5444

RHODE ISLAND

Marshall Electric Co.
Providence 401-331-1163

SOUTH CAROLINA

Whaley Foodservice Repair
W. Columbia 803-791-4420

TENNESSEE

Camp Electric
Memphis 901-527-7543

TEXAS

Stove Parts Supply
Fort Worth 817-831-0381
Armstrong Repair Service
Houston 713-666-7100
Commercial Kitchen Repair Co.
San Antonio 210-735-2811
San Antonio Rest. Equip.
San Antonio 210-532-1660

UTAH

GCS Service
Salt Lake City 801-487-3653

VIRGINIA

Daubers
Norfolk 757-855-4097
Daubers
Springfield 703-866-3600

WASHINGTON

Restaurant Appl. Service
Seattle 206-524-8200

WISCONSIN

A.S.C., Inc.
Madison 608-246-3160
A.S.C., Inc.
Milwaukee 414-543-6460

CANADA

BRITISH COLUMBIA

Key Food Equipment Service
Vancouver 604-433-4484

ONTARIO

R.G. Henderson Ltd.
Toronto 416-422-5580
Choquette CKS
Ottawa 613-739-8458

QUÉBEC

Choquette CKS
Montreal 514-722-2000
Choquette CKS
Québec City 418-681-3944

HATCO CORPORATION

P.O. Box 340500, Milwaukee, WI 53234-0500 U.S.A.

(800) 558-0607 (414) 671-6350

Parts & Service Fax (800) 690-2966 Int'l. Fax (414) 671-3976

www.hatcocorp.com