

SECTION 3. PARTS INFORMATION

3-1. INTRODUCTION

This section lists the replaceable parts of Henny Penny Model CW-216 and CW-114 Display Counter Warmers.

3-2. GENUINE PARTS

Use only genuine Henny Penny parts in your cabinet. Using a part of lesser quality or substitute design may result in cabinet damage or personal injury.

3-3. HOW TO FIND PARTS

To find items you want to order from the Parts List, proceed as follows:

1. Referring to the illustration in this section, find the part item number of the part needed.
2. Find the item number in the parts list, which shows the Henny Penny part number, a description of the part, any model or usage limitations, and the quantity of parts used.

3-4. HOW TO ORDER

Once the parts you want to order have been found in the Parts List, write down the following information:

Example:

Item number	66
Part number	25183
Description	Thermometer

From the date plate list the following information:

Example:

Product number	CW216.0
Serial number	00155
Phase	3
Voltage	208

3-4. HOW TO ORDER
(Continued)

The following table has been provided as a sample format for you to use in preparing your spare parts orders. By providing all the entries, your distributor will be able to ensure the correct parts will be sent to you. Also, by prepayment your order will be expedited.

FROM PARTS LIST			YOUR ORDER		
Figure Number	Part Number	Description	Quantity Ordered	Price Each	Total
66	25183	Thermometer	1		
Product No. <u>CW216.0</u>		Serial No. <u>00155</u>	Phase <u>3</u>	Voltage <u>208</u>	

3-5. PRICES

Your distributor has a priced parts list and will be glad to inform you of the cost of your parts order.

3-6. DELIVERY

Commonly replaced items are stocked by your distributor and will be sent out when your order is received. Other parts will be ordered by your distributor from Henny Penny Corporation. Normally, these will be sent to your distributor within three working days.

3-7. WARRANTY

All replacement parts (except lamps and fuses) are warranted for 90 days against manufacturing defects and workmanship. If damage occurs during shipping, notify the sender and the carrier at once so that a claim may be properly filed. Refer to warranty in the front of this section for other rights and limitations.

3-8. RECOMMENDED
SPARE PARTS FOR
DISTRIBUTORS

Recommended replacement parts, stocked by your distributor, are indicated with √ in the parts lists. Please use care when ordering recommended parts, because all voltages and variations are marked. Distributors should order parts based upon common voltages and equipment sold in their territory.

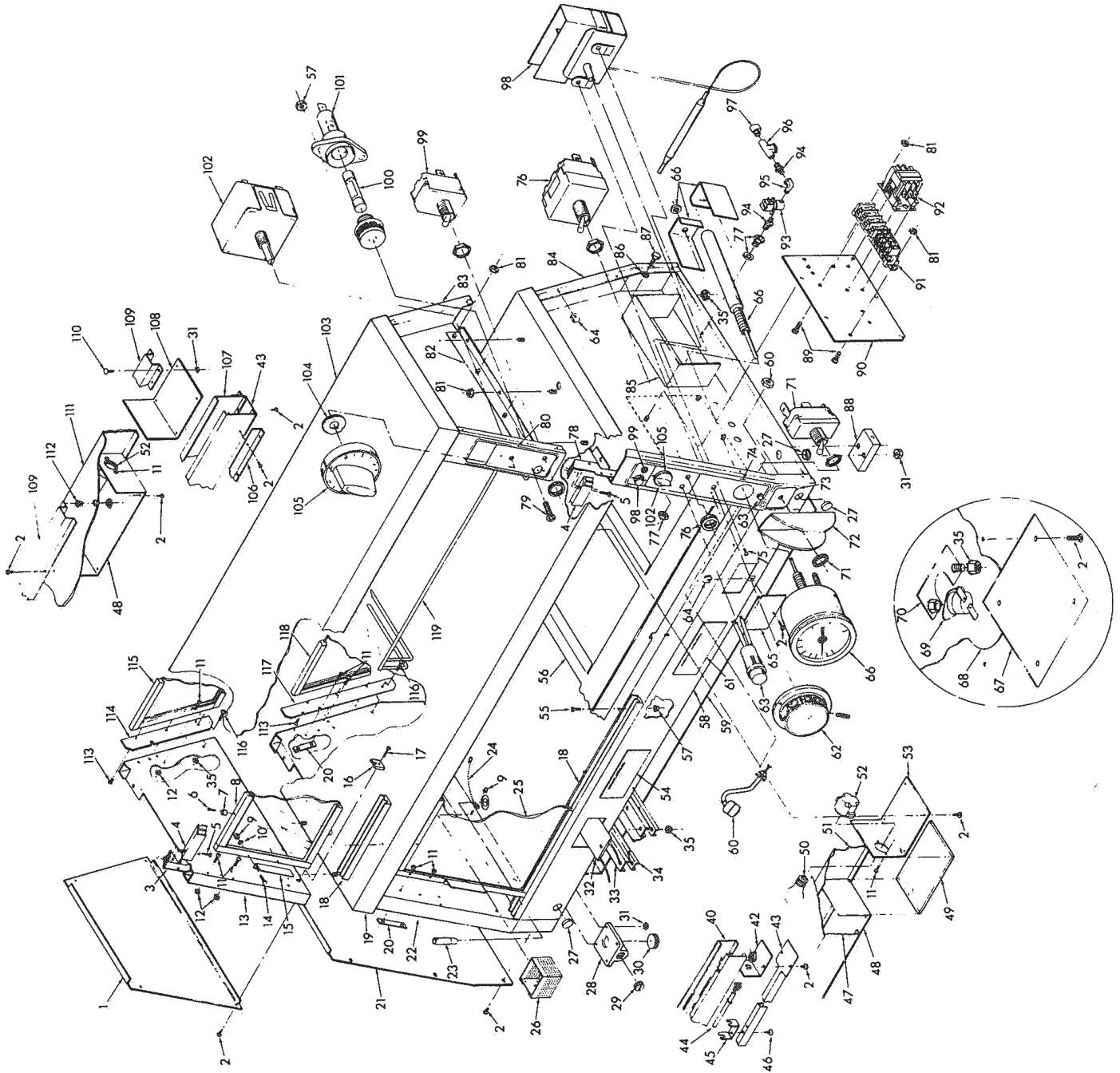

3-9. PARTS LIST

Item No.	Part Number	Description	Qty.
1	22525	Panel - Top End	2
2	SC02-023	Screw #8-B x 3/8" PH Thd.	*
3	23295	Brkt. Weld Assembly - Right	2
4	23555	Track - Door Upper	2
5	SC01-034	Screw - #8-32 x 3/8" PH Thd. S	*
6	SC04-001	Screw - #6-32 x 3/8" PHD Type FC	*
7	22225	Door Glide	*
8	22884	Door Assembly - Top Sliding	2
9	NS03-016	Nut #6-32 B Acorn	*
10	LW01-007	Lockwasher - Split Ring #6 S	*
11	SC01-053	Screw - #8-32 x 1/2" PH Rhd. S	*
12	NS02-007	Nut - #8-32 Hex Keps C	*
13	22889	End Channel - Top (1-1/2) - SN: IY503JB & Above	1
13	14403	Kit - End Channel - Top (1-1/2) - SN: IY502JB & Below	1
14	SC01-082	Screw - #6-32 x 5/8 Ph Thd. S	*
15	23284	Handle - Sliding Door	4
16	22088	Support Rack	2
17	SC01-075	Screw - #10-32 x 3/4 PH Thd.	2
18	23555	Track - Sliding Door	2
19	22599	Middle Shelf Sub-Assembly	1
20	22669	Nutsert Brkt. Assembly	4
21	22519	Panel - End	2
22	22887	End Channel - Bottom (1-1/2)- SN: IY503JB & Above	1
22	14401	Kit - End Channel - Bottom (1-1/2)- SN: IY502JB & Below	1
√ 23	28071	Tube - Overflow	1
24	22802	Retaining Chain Assembly	1
25	22885	Door Assembly - Bottom Sliding	2
26	67852	Screen Assembly	1
27	PL01-006	Plug (1-1/8" dia.)	3
28	22472	Block - Drain	1
29	FP01-009	Plug (3/4" pipe) - Brass	1
30	FP01-021	Plug (1" pipe)	1
31	NS02-006	Nut - #10-24 Hex Keps	*
√ 32	22648	Strip Heater (230 volt, 1020 watt) - Specify	2
√ 32	22649	Strip Heater (208 volt, 1020 watt) - Specify	2
33	22430	Clamp - Heater	4
34	22429	Brace - Heater Clamp	4
35	NS02-002	Nut - 1/4-20 Hex Keps	*
37	SC02-023	Screw #8-B x 3/8" PH Thd.	*
40	22550	Reflector - Heater Housing	1
42	22536	Cover - Terminal	4

√ recommended parts

3-9. PARTS LIST (Continued)

Item No.	Part Number	Description	Qty.
43	22578	Deflector - Heater	2
√ 44	22644	Heater - Radiant - Lower (230 volt, 1000 watt) - <i>Specify</i>	1
√ 44	22645	Heater - Radiant - Lower (208 volt, 1000 watt) - <i>Specify</i>	1
√ 44	22646	Heater - Radiant - Upper (230 volt, 400 watt) - <i>Specify</i>	1
√ 44	22647	Heater - Radiant - Upper (208 volt, 400 watt) - <i>Specify</i>	1
45	22629	Bracket - Heater Support	2
46	SC02-016	Screw #8-AB x 1/2" PH Phd.	*
47	22548	Ceiling Panel - Bottom	1
48	22542	Mounting Plate - Lamp Socket	8
49	22679	Glass	12
√ 50	BL01-004	Light Bulb - 120V-60 Watt	12
√ 50	BL01-005	Light Bulb - 240V-60 Watt - CE	12
51	22546	Side Plate - Light Box	2
√ 52	28294	Socket - Light	12
√ 52	54041	Socket - Light - CE	12
53	22437	Mounting Plate - Lamp Socket	4
54	22617	Plate - Cleaning Instruction	1
55	SC01-062	Screw - #6-32 x 3/8 PH Fhd.	6
56	22879	Pan Support - Formed	*
57	NS02-005	Nut #6-32 Hex Keps	1
58	22551	Stud Assy - Water Pan Base - (before 5/87)	1
58	69699	Assy - Water Pan Base w/o Sld Drs - CE	1
58	70487	Stud Assy - Water Pan w/ Sld Drs - CE	1
58	14382	Kit - Water Pan - (Dom - after 5/87; CE - SN: IR022JB and below)	1
59	22590	Cover - Wire	1
√ 60	14630	Kit - Float Switch - SS	1
61	22618	Plate - Operating Instructions	1
62	16731	Knob - Dual Thermostat	1
√ 63	16624	Light - Indicator - Red	2
√ 63	54085	Light - Indicator - Green - CE	2
64	NS03-017	Nut #8 U-type Chip	*
65	22589	Plate Access (Strip Heater)	2
√ 66	14250	Thermometer	1
67	22509	Plate - Access (High Limit)	1
68	22526	Pan - Bottom	1
√ 69	22601	Switch - High Limit	1
70	22514	Bracket - High Limit Clamp	1
√ 71	22673	Switch - 3 position	1
72	15302	Guard - Switch	1
73	22674	Decal - Water Control Switch	1
74	22602	Decal - Bottom Control Decal	1
75	SC01-023	Screw #6-32 x 1/4 PH Rhd.	2
√ 76	22604	Switch Assembly - Power	1
77	FP01-013	Bulkhead Adapter	1
78	23294	Bracket Weld Assembly Left	2
79	SC01-010	Screw #6-32 x 1/4 PH Rhd.	4
80	22612	Decal - Top Control Panel	1
81	NS02-001	Nut #10-32 Hex Keps	*
82	22508	Angle - Channel Mount (Upper)	2

3-9. PARTS LIST (Continued)

Item No.	Part Number	Description	Qty.
83	22891	End Channel Assembly (3-1/2" top) - SN: IY503JB & Above	1
83	14413	Kit - End Channel Assembly (3-1/2" top) - SN: IY503JB & Below	1
84	22886	End Channel Assembly (3-1/2") - SN: IY503JB & Above	1
84	14402	Kit - End Channel Assembly (3-1/2") - SN: IY503JB & Below	1
85	22667	Guard - Splash	1
86	LW02-004	Lockwasher (1/4" Ext.)	*
87	SC01-022	Screw #1/4-20 x 3/4	8
88	22588	Mounting Block	1
89	SC01-002	Screw #10-32 x 1/2 PH Trn.	2
90	66670	Plate - Electric Component	1
91	22607	Terminal Block Assembly	1
√ 92	19405	Contactor	1
√ 93	25147	Valve - Solenoid (120 volt)	1
√ 93	25409	Valve - Solenoid - 240V-60Hz & 220V-50Hz	1
√ 93	49461	Valve - Solenoid - CE (SN: JA0703045 & BELOW)	1
√ 93	72117	Valve - Solenoid - CE (SN: JA0703046 & ABOVE)	1
94	FP01-012	Nipple - Reducing	2
95	FP01-014	Elbow (1/8 " Brass)	1
√ 96	25208	Strainer - Water	1
97	FP05-005	Elbow (1/4" NPT to 1/4" NPT)	1
√ 98	64103	Thermostat Control	1
√ 99	22198	Switch - Power	1
√ 100	EF02-007	Fuse (15 amp.) (SN: JB0705002 & below)	2
√ 101	EF02-006	Fuse Holder (SN: JB0705002 & below)	2
√ 101	EF02-125	Breaker - Push Button Reset (SN: JB0705003 & above)	2
√ 102	23560	Infinite Regulator (240 volt)	2
103	22615	Top Cap Assembly	1
104	EF02-011	Nut - Infinite Regulator	2
105	22046	Knob - Infinite Switch	2
106	22543	Support Glass	2
107	22549	Heater Housing - Upper	1
108	22539	Plate Cover	4
109	22544	Hat Section	2
110	SC01-015	Screw #10-24 x 1/2 Carriage	*
111	22547	Ceiling Panel - Top	1
112	EF01-011	Nipple - Chase (3/8")	8
113	SC01-003	Screw #6-32 x 3/8 Flat Hd.	12
114	22876	Plate - Top R.H.	1
114	22877	Plate - Top L.H. (not shown)	1
115	22883	Window Assembly - Top	1
116	SC01-059	Screw #1/4-20 x 1/2 PH - Truss Hd.	4
117	22875	Bracket - Mounting Bottom R.H.	1
117	22874	Bracket - Mounting Bottom L.H. (not shown)	1
118	22882	Window Assembly Bottom	1
119	22868	Support - Pan Top	1
√ 120	34528	Relay - Float Switch - 120v (not shown)	1
√ 120	30723	Relay - Float Switch - 240v (not shown)	1
121	14627	Kit - Insul. End Channel - CW (not shown)	1
122	67816	Insul - Side 4.5 x 24 x 1 - CW End (not shown)	1
123	67827	Insul - Side 2.5 x 24 x 1 - CW End (not shown)	1