

**SECTION 3. PARTS INFORMATION**

**3-1. INTRODUCTION**

This section lists the replaceable parts of Henny Penny Model HCW-3, HCW-5, and HCW-8 display cabinets.

**3-2. GENUINE PARTS**

Use only genuine Henny Penny parts in your cabinet. Using a part of lesser quality or substitute design may result in cabinet damage or personal injury.

**3-3. HOW TO FIND PARTS**

To find items you want to order from the Parts List, proceed as follows:

1. Referring to the illustration in this section, find the part item number of the part needed.
2. Find the item number in the parts list, which shows the Henny Penny part number, a description of the part, any model or usage limitations, and the quantity of parts used.

**3-4. HOW TO ORDER**

Once the parts you want to order have been found in the Parts List, write down the following information:

Example:

Item number	75
Part number	25183
Description	Thermometer

From the date plate list the following information:

Example:

Product number	HCW5.0
Serial number	00155
Phase	3
Voltage	208

**3-4. HOW TO ORDER**  
**(Continued)**

The following table has been provided as a sample format for you to use in preparing your spare parts orders. By providing all the entries, your distributor will be able to ensure the correct parts will be sent to you. Also, by prepayment your order will be expedited.

FROM PARTS LIST			YOUR ORDER		
Figure Number	Part Number	Description	Quantity Ordered	Price Each	Total
75	25183	Thermometer	1		
<b>Product No.</b>	<b><u>HCW5.0</u></b>	<b>Serial No.</b>	<b><u>00155</u></b>	<b>Phase</b>	<b><u>3</u></b>
				<b>Voltage</b>	<b><u>208</u></b>

**3-5. PRICES**

Your distributor has a period parts list and will be glad to inform you of the cost of your parts order.

**3-6. DELIVERY**

Commonly replaced items are stocked by your distributor and will be sent out when your order is received. Other parts will be ordered by your distributor from Henny Penny Corporation. Normally, these will be sent to your distributor within three working days.

**3-7. WARRANTY**

All replacement parts (except lamps and fuses) are warranted for 90 days against manufacturing defects and workmanship. If damage occurs during shipping, notify the sender and the carrier at once so that a claim may be properly filled. Refer to warranty in the front of this section for other rights and limitations.

**3-8. RECOMMENDED**  
**SPARE PARTS FOR**  
**DISTRIBUTORS**

Recommended replacement parts, stocked by your distributor, are indicated with √ in the parts lists. Please use care when ordering recommended parts, because all voltages and variations are marked. Distributors should order parts based upon common voltages and equipment sold in their territory.

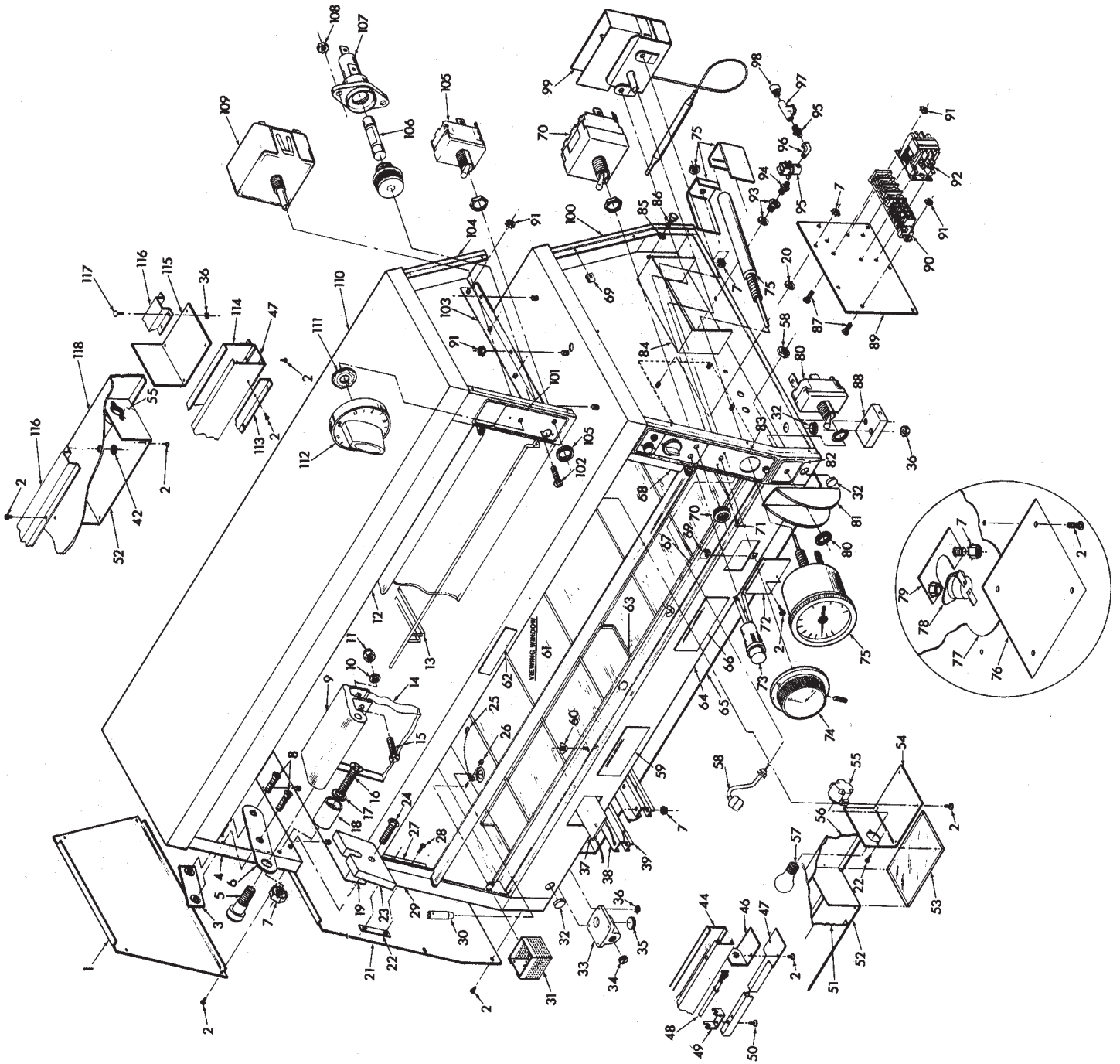

**3-9. PARTS LIST**

Item No.	Part Number	Description	Qty.		
			HCS-2	HCW-5	HCW-8
1	22525	Panel - Top End	-	2	2
2	SC02-023	Screw #8-B x 3/8" PH Thd.	AR	AR	AR
3	22670	Bracket Assembly - Hinge	4	8	8
4	22889	End Channel - Top (1-1/2")-SN: IR022JB & Above	-	1	1
4	14403	Kit-End Channel- Top-SN: IR021JB & Below	-	1	1
5	38172	Bolt - Shoulder	4	8	8
6	22731	Pivot - Side	4	8	8
7	NS02-002	Nut - 1/4-20 Hex Kep	AR	AR	AR
8	SC01-032	Screw #8-32 x 5/8" PH 100 Fhd. S	AR	AR	AR
9	22650	Extrusion - HCW - Door	-	4	-
9	72184	Extrusion - HCS-2 - Door	2	-	-
10	LW02-006	Lockwasher - #8 Internal	8	16	34
11	NS03-024	Nut - (#8-32 Acorn)	8	16	34
12	22579	Top Decorator Panel Assembly	-	2	-
12	38941	Top Decorator Panel Assembly-	-	2	-
13	22558	Pan Support - Top	-	1	-
13	38935	Pan Support - Top - HCW-8	-	-	3
√ 14	22554	Door	-	4	-
√ 14	72183	Door - HCS-2	2	-	-
15	SC01-096	Screw #8-32 x 5/8" PH Phd.	AR	AR	AR
16	SC01-068	Screw #1/4-20 x 1" PH Fhd.	4	8	8
17	WA01-012	Washer	4	8	8
18	22455	Stop - Door	4	8	24
19	22599	Middle Shelf Sub-Assembly	-	1	-
19	69707	Middle Shelf Sub-Assembly - CE - HCW-2	-	-	-
19	38973	Middle Shelf Sub-Assembly - HCW-8	-	-	1
20	WA01-002	Washer - Plate - Electric Component	5	5	5
21	22519	Panel - End	2	2	2
22	NS03-050	Nutsert #8	4	8	8
23	22088	Support - Rack	-	2	2
24	SC01-074	Screw #10-32 x 3/4" PH Thd.	-	2	2
25	79107	Retaining Chain Assembly	1	1	1
26	NS03-016	Nut (#6-32 x 3/4" PH Thd.	1	1	1
27	41557	Viewing Panel Brkt. Assembly - LH	2	4	4
28	SC01-053	Screw #8-32 x 3/4" PH Thd.	AR	AR	AR
29	22887	End Channel-Bottom-1-1/2"-SN: IR022JB & Above	1	1	1
29	14401	Kit-End Channel- Bottom-SN: IR021JB & Below	-	1	1
√ 30	28071	Tube - Overflow	1	1	1
31	67852	Screen Assembly	1	1	1
32	PL01-006	Plug (1-1/8" Dia.)	3	3	3
33	22472	Block - Drain	1	1	1
34	FP01-009	Plug (3/4" Pipe) - Brass	1	1	1
35	FP01-021	Plug (1" Pipe)	1	1	1
36	NS02-006	Nut - #10-24 Hex Keps	AR	AR	AR
√ 37	22648	Strip Heater (230 volt, 1020 watt) - Specify	2	2	4
√ 37	22649	Strip Heater (208 volt, 1020 watt) - Specify	-	2	4
38	22430	Clamp - Heater	4	4	8
39	22429	Brace - Heater	4	4	8

√ recommended parts

**3-9. PARTS LIST (Continued)**

Item No.	Part Number	Description	Qty.		
			HCS-2	HCW-5	HCW-8
44	22549	Reflector - Heater Housing	-	1	-
44	39989	Reflector - Heater Housing - HCW-8	-	-	1
44	72203	Reflector - Heater Housing - HCS-2	1	-	-
46	22536	Cover - Terminal	2	4	4
47	22578	Deflector - Heater	-	1	-
47	39935	Deflector - Heater - HCW-8	-	-	1
47	72204	Deflector - Heater - HCS-2	1	-	-
√ 48	22644	Heater - Radiant - Lower (230 volt, 1000 watt) - Specify	-	1	-
√ 48	22645	Heater - Radiant - Lower (208 volt, 1000 watt) - Specify	-	1	-
√ 48	38955	Heater - Radiant - Lower (230 volt, 2000 watt) - Specify	-	-	1
√ 48	38786	Heater - Radiant - Lower (208 volt, 2000 watt) - Specify	-	-	1
√ 48	22646	Heater - Radiant - Upper (230 volt, 400 watt) - Specify	-	1	-
√ 48	22647	Heater - Radiant - Upper (208 volt, 400 watt) - Specify	-	1	-
√ 48	38954	Heater - Radiant - Upper (230 volt, 800 watt) - Specify	-	-	1
√ 48	38801	Heater - Radiant - Upper (208 volt, 800 watt) - Specify	-	-	1
√ 48	72187	Heater - Radiant - (230 volt, 600 watt)	1	-	-
49	22629	Bracket - Heater Support	1	2	6
50	SC01-023	Screw #8-AB x 1/2" PH Phd.	AR	AR	AR
51	22548	Ceiling Panel - Bottom	-	1	-
51	54273	Ceiling Panel - Bottom	-	-	1
51	72208	Ceiling Panel - Bottom	1	-	-
52	23517	Mounting Plate - Lamp Socket	4	8	16
53	22679	Glass with Silicone	4	12	20
54	23515	Mounting Plate - Lamp Socket	2	4	4
√ 55	28294	Socket - Light	-	12	20
√ 55	54041	Socket - Light - CE	4	12	20
56	22546	Side Plate - Light Box	-	2	-
56	38669	Side Plate - Light Box	-	-	2
56	72207	Side Plate - Light Box	1	-	-
√ 57	BL01-004	Light Bulb - 120 volt, 60 watt	-	12	20
√ 57	BL01-005	Light Bulb - 240 volt, 60 watt - CE	4	12	20
√ 58	14630	Float Switch - S.S.	1	1	1
59	22617	Plate - Cleaning Instructions	1	1	1
60	NS03-033	Nut #10-24 Wing	4	4	5
√ 61	22734	Viewing Panel	-	2	-
√ 61	41558	Viewing Panel - HCW-8	-	-	2
√ 61	41559	Viewing Panel - HCW-8	-	-	4
√ 61	72186	Viewing Panel - HCS-2	2	-	-
62	22795	Label - Use Max. 60 W	1	1	1
63	22678	Water Pan Grid	-	2	3
63	72185	Water Pan Grid	1	-	-
64	22551	Base - HCW-5/3 Water Pan - (before 5/87)	-	1	-
64	69708	Base - HCW-5/3 Water Pan-CE - SN: IR023JB and Above	-	1	-
64	14382	Kit - HCW-5/3 Water Pan - (Dom - after 5/87; CE - SN: IR022JB and below)	-	1	-
64	54267	Base - Water Pan - HCW-8, SN: IR023JB & Above	-	-	1
64	69700	Base - Water Pan - HCW-8-CE, SN: IR023JB & Above	-	-	1
64	14383	Kit - HCW-8 Water Pan - SN: AR009IH to IR022JB	-	1	-
64	71892	Base - Water Pan - HCS-2	1	-	-
65	22590	Cover - Wire	-	1	-
65	38699	Cover - Wire - HCW-8	-	-	1
65	72214	Cover - Wire - HCS-2	1	-	-
66	22618	Plate - Operating Instructions	1	1	1

**3-9. PARTS LIST (Continued)**

Item No.	Part Number	Description	Qty.		
			HCS-2	HCW-5	HCW-8
67	22560	Pan Support - Bottom	-	1	-
67	54263	Pan Support - Bottom - HCW-8	-	-	1
67	72188	Pan Support - Bottom - HCS-2	1	-	-
68	41556	Viewing Panel Bracket Assembly (R.H.)	1	2	2
69	NS03-017	Nut - #8 U-Type Clip - SN: IR022JB and below	-	AR	AR
√ 70	22604	Switch Assembly - Power	1	1	1
71	SC01-023	Screw #6-32 x 1/4" PH Rhd,	2	2	2
72	22589	Plate - Access	2	2	4
√ 73	16624	Light Indicator	-	2	2
√ 73	54085	Light Indicator - CE - Green	2	2	2
74	16731	Knob - Thermostat	1	1	1
√ 75	14250	Thermometer	1	1	1
76	22509	Plate - Access	1	1	1
77	22526	Pan - Bottom	-	1	-
77	38707	Pan - Bottom - HCW-8	-	-	1
77	72191	Pan - Bottom - HCS-2	1	-	-
√ 78	22601	High Limit	1	1	1
79	22514	Bracket - High Limit Clamp	1	1	1
√ 80	22673	Switch - 3 Position	1	1	1
81	15302	Guard - Switch	1	1	1
82	22815	Decal - Water Control Switch	1	1	1
83	22814	Decal - Bottom Control Panel	1	1	1
84	22667	Guard - Splash	1	1	1
85	LW02-004	Lockwasher (1/4" ext.)	AR	AR	AR
86	SC01-068	Screw #1/4-20 x 3/4"	8	8	8
87	SC01-002	Screw #10-32 x 1/2" PH Truss Hd.	2	2	2
88	22588	Mounting Block - Thermometer	1	1	1
89	66670	Plate - Electric Component	1	1	1
90	22607	Terminal Block Assembly	-	1	1
90	80573	Terminal Block Assembly - 220-240/3ph - HCW-5	-	1	-
90	53738	Terminal Block Assembly - Australian HCW-2	-	-	-
90	73525	Terminal Block Assembly - Australian HCS-2	1	-	-
91	NS02-001	Nut #10-32 Hex Keys	AR	AR	AR
√ 92	19405	Contactactor	1	1	1
93	FP01-013	Bulkhead Adaptor	1	1	1
94	FP01-012	Nipple - Reducing	2	2	2
√ 95	14965	Kit - Valve - Solenoid (120 volt)	1	1	1
√ 95	14966	Kit - Valve - Solenoid - 240V-60Hz & 220V-50Hz	1	1	1
√ 95	32646	Valve - Solenoid - WRAS - UK	1	1	1
√					
96	FP01-014	Elbow (1/8" Brass)	1	1	1
√ 97	25208	Strainer - Water	1	1	1
98	FP05-005	Elbow (1/4 NPT to 1/4 NPT)	1	1	1
√ 99	64103	Thermostat Control	1	1	1
100	22886	End Channel (3-1/2" Bottom) - SN: IR023JB and Above	1	1	1
100	14402	Kit - HCW End Channel - SN: IR022JB and below	-	1	1
101	22813	Decal - Top Control Panel	-	1	1
101	61524	Decal - Top Control Panel - Pollo Loco	-	1	1
102	SC01-113	Screw - #6-32 x 1/2" PH Phd.	-	4	4
103	22508	Angle - Channel Mount (Upper)	-	2	2
104	22892	End Channel Assy (3-1/2" Top) SN: IR023JB and Above	-	1	1
104	14413	Kit - HCW End Channel - SN: IR022JB and below	-	1	1

√ recommended parts

**3-9. PARTS LIST (Continued)**

Item No.	Part Number	Description	Qty.		
			HCS-2	HCW-5	HCW-8
√ 105	70046	Switch - Power	1	2	2
√ 106	EF02-007	Fuse (15 amp) (SN: JA0705005 & below)	-	2	2
√ 107	EF02-006	Fuse Holder (SN: JA0705005 & below)	-	2	2
√ 107	EF02-125	Breaker - Push Button Reset (SN: JA0705006 & above)	-	2	2
108	NS02-005	Nut - #6-32 Hex Keys	-	4	4
√ 109	23560	Infinite Regulator	1	2	2
110	22615	Top Cap Assembly	-	1	-
110	38972	Top Cap Assembly - HCW-8	-	-	1
110	72837	Top Cap Assembly - HCS-2	1	-	-
111	EF02-011	Nut - Infinite Regulator	1	2	2
112	22046	Knob - Infinite Switch	1	2	2
113	22543	Support - Glass	-	2	-
113	38721	Support - Glass - HCW-8	-	-	2
114	22549	Heater Housing - Upper	-	1	-
114	38940	Heater Housing - Upper - HCW-8	-	-	1
115	22539	Plate - Cover	4	4	4
116	22544	Hat Section	-	4	-
116	38727	Hat Section - HCW-8	-	-	4
116	72206	Hat Section - HCS-2	1	-	-
117	SC01-015	Screw - #10-24 x 1/2" Carriage	AR	AR	AR
118	22547	Ceiling Panel - Top	-	1	-
118	54275	Ceiling Panel - Top - HCW-8	-	-	1
√ 119*	34528	Relay - 120 Volt	-	1	1
√ 119*	30723	Relay - 240 Volt	1	1	1
√ 119*	14772	Kit - Relay - 12 Volt - Replacement	-	1	1
√ 119*	71933	Relay - 12 Volt	-	1	1
√ 120*	51068	EMC Filter - CE & Australia	1	1	1
121*	48369	Switch Cover - CE	2	4	4
122*	14751	Kit - HCW WRAS Valve Retrofit - UK	1	1	1
122*	65134	Backflow-Prevent Assy - Complete - UK	1	1	1
√ 123*	32645	Switch - Float - WRAS - UK	1	1	1
√ 124*	32646	Solenoid Valve - Water - WRAS - UK	1	1	1
√ 125*	25299	Spacer - Float Switch	2	2	2
126*	65105	Assy. - Reservoir - Weldment	1	1	1
122*	14468	Kit - HCW Water Reservoir Retrofit - CE	-	1	1
122*	65175	Backflow-Prevent Assy - Complete - CE	-	1	-
√ 123*	28856	Switch - Float - CE	-	1	-
√ 124*	72117	Solenoid Valve - Water - CE	-	1	1
15*	25299	Spacer - Float Switch	-	2	-
126*	65105	Assy. - Reservoir - Weldment	-	1	1
127*	14628	Kit - Glass Edge Guard - HCW-3/5	-	1	-
128*	65469	Guard - Glass Edge - HCW-3/5	-	2	-
129*	14629	Kit - Glass Edge Guard - HCW-8/HCS-5	-	1	1
130*	65506	Guard - Glass Edge - HCW-8 - Long	-	-	4
131*	65507	Guard - Glass Edge - HCW-8 - Short	-	-	2
132*	14627	Kit - Insul. End Channel - HCW	-	1	1
133*	67816	Insul - Side 4.5 x 24 x 1 - HCW End	-	1	1
134*	67827	Insul - Side 2.5 x 24 x 1 - HCW End	-	1	1
135*	70410	Conduit - 1/2 x 72 in. Flex. - Power Cord - Canada	-	1	-
136*	14628	Kit-Glass Edge Guard HCW-3/5	-	1	-

√ recommended parts/\* not shown

### HCW-8 Only Parts List

Part Number	Description	Qty.
54193*	Brace Weldment Upper w/Rack Support	2
54197*	Brace Weldment - Upper	2
38774*	Door Assembly - 30" - Middle - Top	2
38742*	Door - 30" - Middle - Top	2
38773*	Extrusion - 30" - Middle - Top	2
38926*	Door Pin	8
38743*	Door Assembly - 30" - End - Top	4
38737*	Door Extrusion - 30" - End - Top	4
38742*	Door - 30" - End - Top	4
38745*	Door Assembly - 36" - End - Bottom	4
38740*	Door - 36" - End - Bottom	4
38739*	Extrusion - 36" - End - Bottom	4
54195*	Brace Weldment - Lower	4
38744*	Door Assembly - 18 3/8" - Middle - Bottom	2
38741*	Door - 18 3/8" - Middle - Bottom	2
38738*	Extrusion - 18 3/8" - Middle - Bottom	2
38705*	Insulation - Top	1
38702*	Insulation - Bottom	1
NS02-006*	Nut #10-24 Keys	AR
NS03-023*	1/4-20 Acorn Nut - Door Stop	16
WA01-013*	Washer - 1/4" - Door Stop	16
14629*	Kit -Glass Edge Guard HCW-8/HCS-5	1