

NO. 71154

ISSUED: JAN. 10, 2000



**HOSHIZAKI  
ICE DISPENSING BIN/  
WATER DISPENSER**

**MODEL**

**DM-90A**

**PARTS LIST**

## MATERIAL ABBREVIATIONS

### ALUMINUM

AL = Aluminum

### COPPER

CU = Copper

### PLASTIC

ABS = Acrylonitrile -butadiene - styrene  
 AC = Polyacetal  
 EVA = Ethylene vinyl acetate  
 PA = Polyamide = Nylon  
 PC = Polycarbonate  
 PE = Polyethylene  
 PES = Polyester  
 PETP = Polyethylene terephthalate = Tetlon  
 PP = Polypropylene  
 PS = Polystyrene  
 PIFE = Polytetrafluoroethylene = Teflon  
 PUR = Polyurethane  
 PVC = Polyvinyl chloride

### RUBBER

VN = Vinyl Nitrile  
 EPDM = EP rubber  
 NBR = Nitrile butadiene rubber  
 NR = Natural rubber  
 NP = Neoprene  
 SIR = Silicone rubber  
 SYR = Synthetic rubber  
 EPH = Epichlorohydrin

### STEEL

GS = Galvanized steel  
 SS = Stainless steel  
 PS = Plated steel  
 PAS = Primed steel

## AUXILIARY CODE

Ex.1

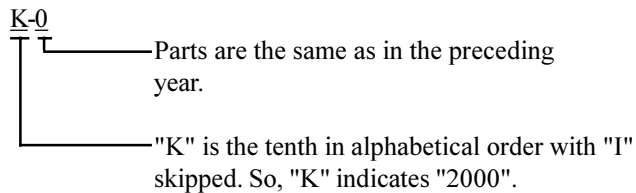

(Note) - = Part deleted.

x = Part deleted and replaced by "o" part.

o = New part for "x" in the same auxiliary code.

Ex.2

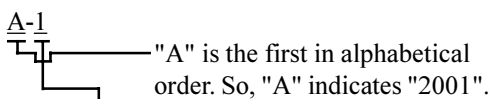

Ex.3

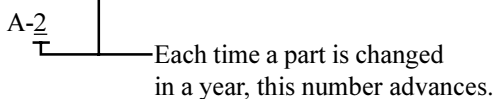

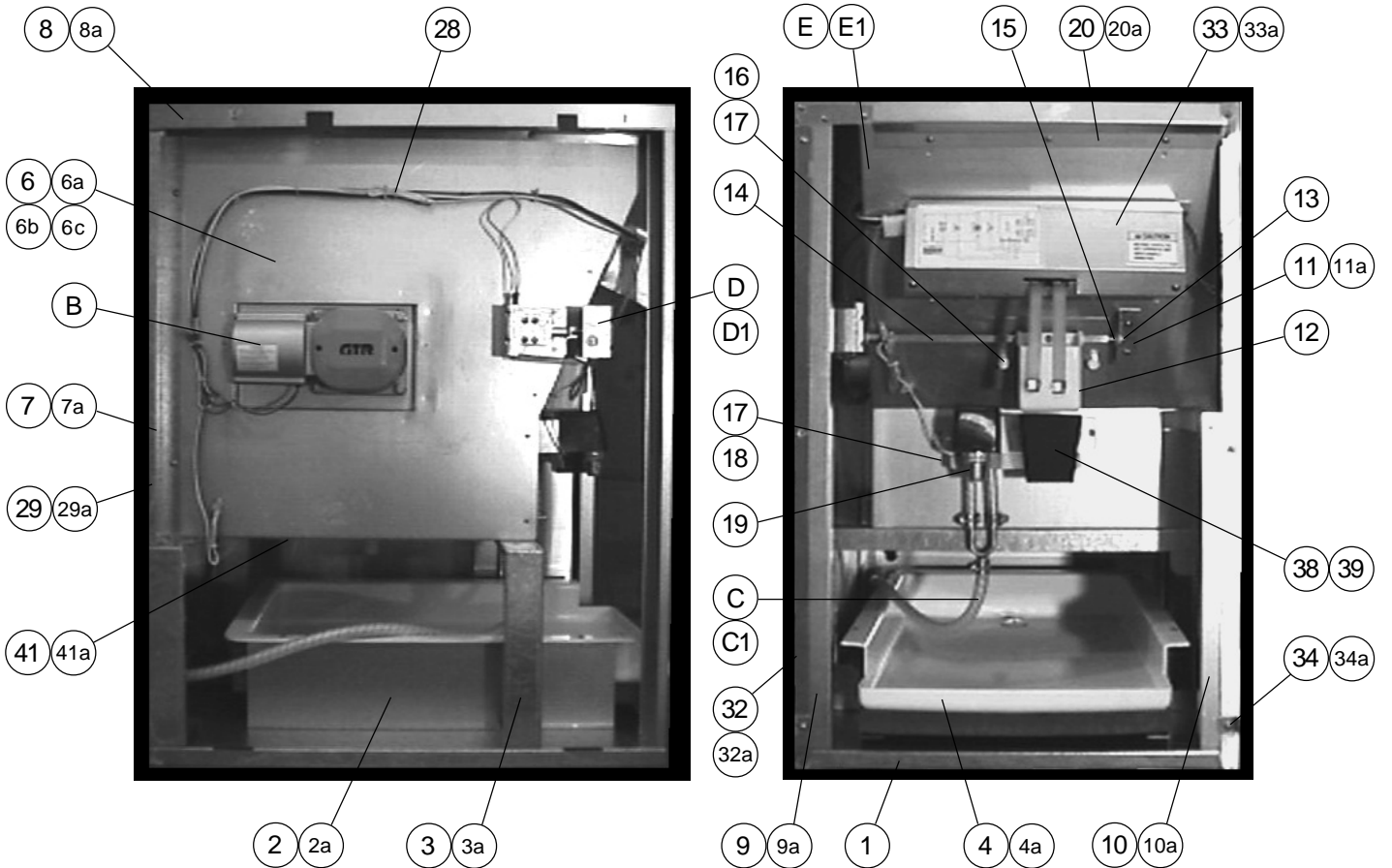
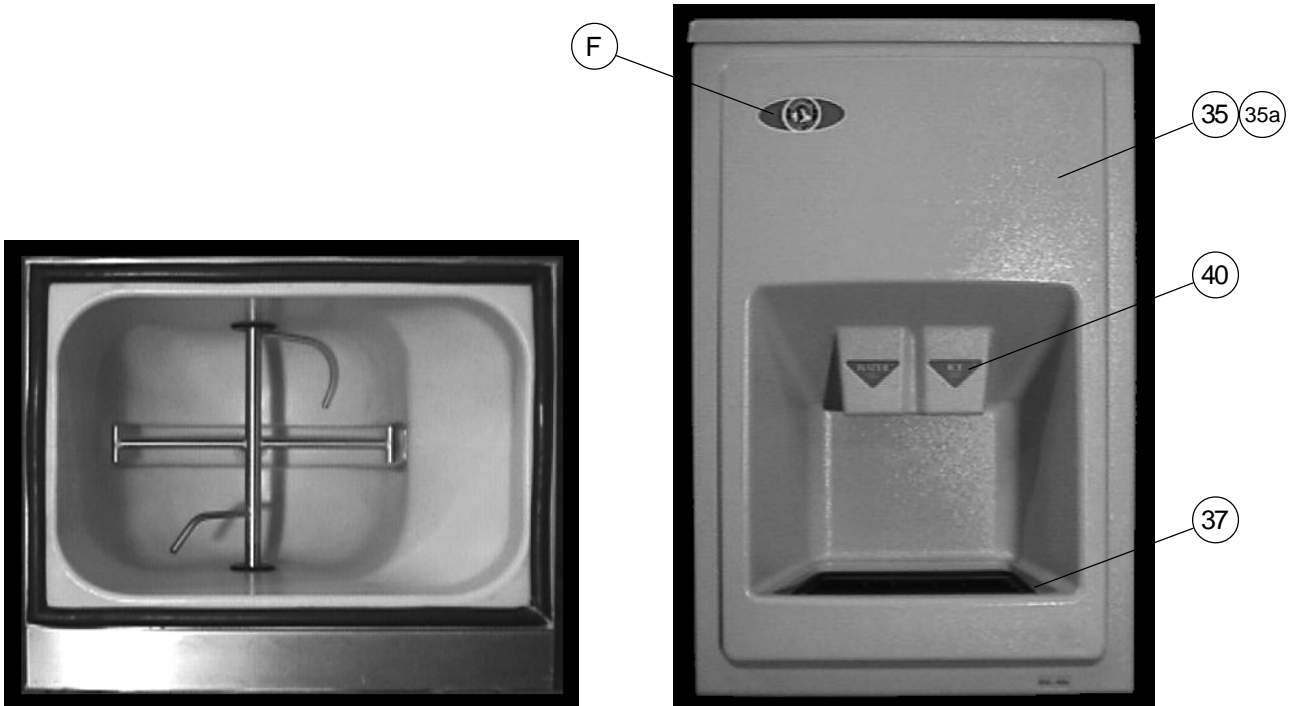

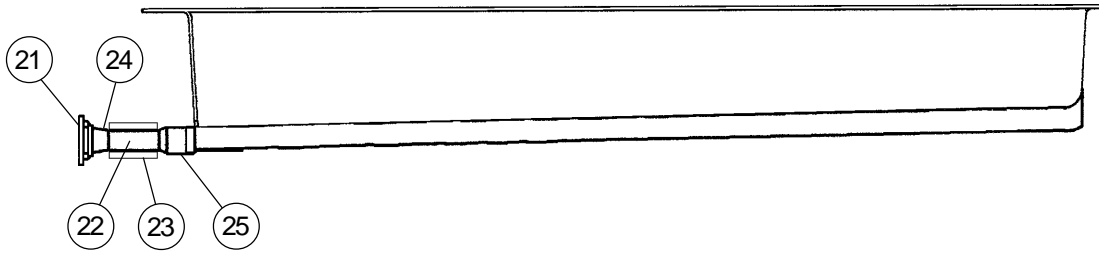

DRAIN PAN SECTION DETAIL

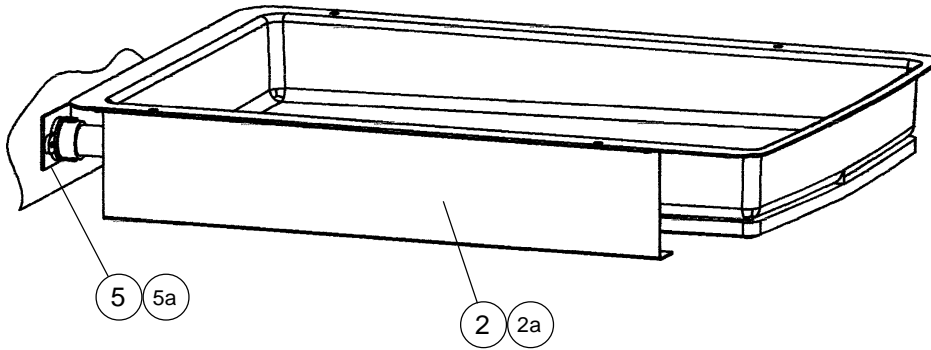

DRAIN PAN ASSEMBLY DETAIL

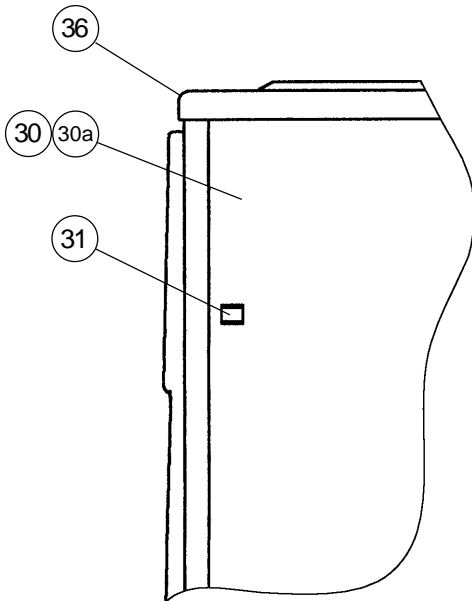

SIDE PANEL DETAIL

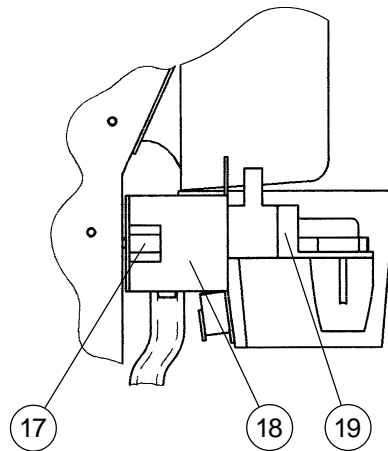

WATER VALVE DETAIL

MODEL: <b>DM-90A</b> TITLE: <b>A. ICE DISPENSER ASSEMBLY</b>										
INDEX NO.	DESCRIPTION	MATERIAL OR MODEL NUMBER	PART NUMBER	REQUIRED NUMBER						
				J-0						
B	DRIVE ASSY	-	1A0181A01	1						
C	WATER CIRCUIT	-	3A0760G01	1						
C1	FT SCREW	4X8	7F31-0408	2						
D	SOLENOID ASSY	-	2A0881A01	1						
D1	HEX HEAD BOLT W/WASHER (LF)	4X10, SS	7B02-0410	4						
E	CONTROL BOX ASSY	-	2A1593A01	1						
E1	T2 SCREW	4X8	7P31-0408	4						
F	LABEL LOCATION	-	3A0814A01	1						
1	BASE	GS	2A0805G01	1						
2	DRAIN PAN BRKT	GS	3A0747G01	2						
2a	FT SCREW	4X8, SS	7F32-0408	4						
3	BASE FRAME	GS	3A0754G01	2						
3a	HEX HEAD BOLT	6X12	7B02-0612	8						
4	DRAIN PAN ASSY	ABS	2A1684G01	1						
4a	TRUSS HEAD SCREW	4X10, SS	7C32-0410	4						
5	PAD	ABS	436580-01	1						
5a	TRUSS HEAD SCREW	5X12, SS	7C32-0512	2						
6	BIN ASSY	-	2A0814G01	1						
6a	HEX HEAD BOLT	8X20	7B01-0820	4						
6b	SPLIT LOCK WASHER	8	7L21-0800	4						
6c	WASHER	8	7W21-800	4						
7	REAR FRAME	GS	3A0753-01	1						
7a	FT SCREW	4X8	7F31-0408	4						
8	TOP FRAME	GS	3A0748-01	1						
8a	FT SCREW	4X8	7F31-0408	4						
9	FRONT FRAME (A)	GS	2A0818-01	1						
9a	FT SCREW	4X8	7F31-0408	4						
10	FRONT FRAME (B)	GS	3A0749-01	1						
10a	FT SCREW	4X8	7F31-0408	4						
11	COLLAR BRACKET	GS	4A1154-01	1						

MODEL: <b>DM-90A</b> TITLE: <b>A. ICE DISPENSER ASSEMBLY</b>										
INDEX NO.	DESCRIPTION	MATERIAL OR MODEL NUMBER	PART NUMBER	REQUIRED NUMBER						
				J-0						
11a	FT SCREW	4X8	7F31-0408	2						
12	SHUTTER (A)	-	3A0756-01	1						
13	COLLAR SHUTTER	-	435533-01	1						
14	SHUTTER SHAFT	SS	4A1156-01	1						
15	SNAP PIN	SSP-6, SS	7155-0006	1						
16	FLOW RATE BRKT	SS	4A1155-01	1						
17	THUMBSCREW	ABS, SS	415949G01	4						
18	DISPENSING BRACKET	SS	3A0943-01	1						
19	WATER VALVE	202-FN-H18-1101	4A1225-01	1						
20	ANGLE (A)	GS	3A0750-01	1						
20a	T2 SCREW	4X8	7P31-0408	3						
21	FITTING DRAIN	-	438729-01	1						
22	DRAIN HOSE	EPDM	436315-03	1						
23	INSULATION TUBE	L=105	7762-2943	1						
24	HOSE CLAMP	HC1031	4A2017-02	1						
25	HOSE CLAMP	HC1250	4A2017-03	1						
26	POWER SUPPLY CORD	-	4A1773-01	1						
27	BUSHING	SR-4K-4	420472-01	1						
28	WIRE SADDLE	VWS4274-C	4A0338-03	6						
29	REAR PANEL	GS	2A0821-01	1						
29a	FT SCREW	4X8, SS	7F32-0408	1						
30	SIDE PANEL (R)	SS	2A0823G01	1						
30a	FT SCREW	4X8, SS	7F32-0408	7						
31	ROCKER SWITCH	1801.1102	4A0418-01	1						
32	SIDE PANEL (L)	SS	2A0822G01	1						
32a	FT SCREW	4X8, SS	7F32-0408	7						
33	CONTROL BOX COVER	GS	3A1258-01	1						
33a	T2 SCREW	4X8	7P31-0408	2						
34	FRONT PANEL BRACKET (C)	GS	4A0334-01	2						
34a	FT SCREW	4X8	7F31-0408	2						



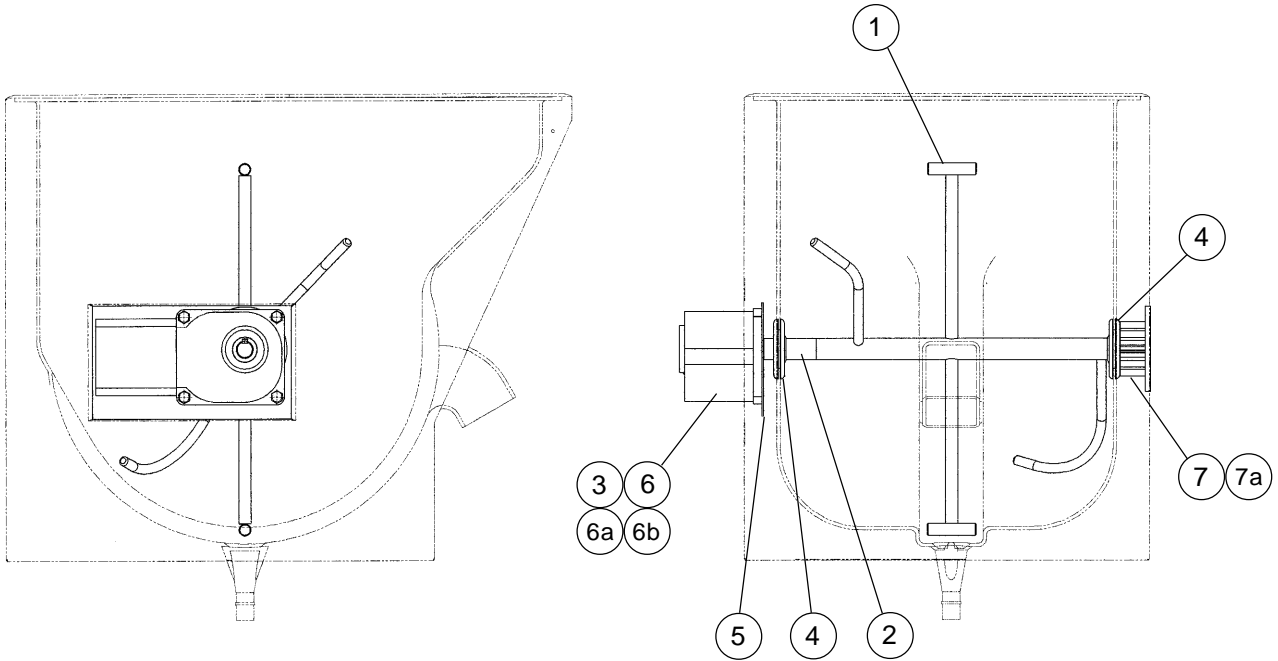



MODEL: <b>DM-90A</b> TITLE: <b>B. DRIVE ASSY</b>										
INDEX NO.	DESCRIPTION	MATERIAL OR MODEL NUMBER	PART NUMBER	REQUIRED NUMBER						
				J-0						
1	AGITATOR	SS	3A0746G01	1						
2	DRIVE SHAFT	SS	4A1157-01	1						
3	KEY	6X6X86	4A1300-01	1						
4	SEAL (B)	-	435558-01	2						
5	RISER	WHITE ABS	4A2160-01	1						
6	GEAR MOTOR	FOB-6139	4A1265-01	1						
6a	HEX HEAD BOLT	8X25, SS	7B02-0825	4						
6b	SPLIT LOCK WASHER	8	7L21-0800	4						
7	HOLDER AGITATOR	-	326441-01	1						
7a	T2 COUNTERSUNK SCREW	4X12, SS	7P42-0412	4						

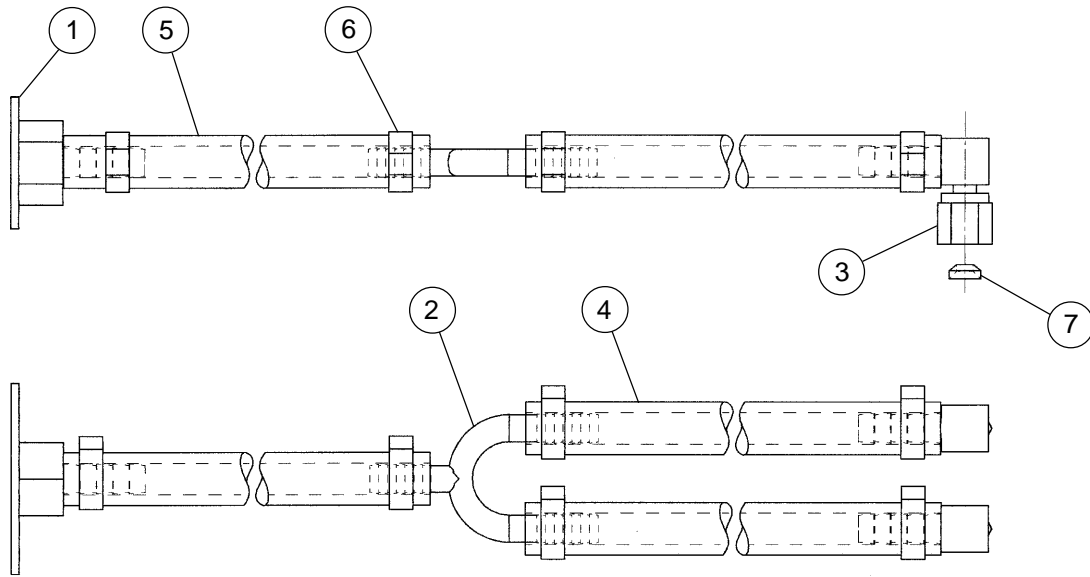

MODEL: DM-90A TITLE: C. WATER CIRCUIT										
INDEX NO.	DESCRIPTION	MATERIAL OR MODEL NUMBER	PART NUMBER	REQUIRED NUMBER						
				J-0						
1	WATER INLET FITTING	COPPER, BRASS	4A1226G01	1						
2	U-BEND MANIFOLD	7095	4A1230-01	1						
3	90 DEG INLET FITTING	7053	4A1229-01	2						
4	BEVERAGE TUBING	L=110	4A0512L04	2						
5	BEVERAGE TUBING	L=650	4A0512L04	1						
6	BEVERAGE TUBING CLAMP	-	4A0533-01	6						
7	NYLON FLARE WASHER	8007	4A1185-01	2						

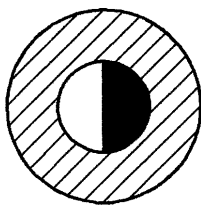
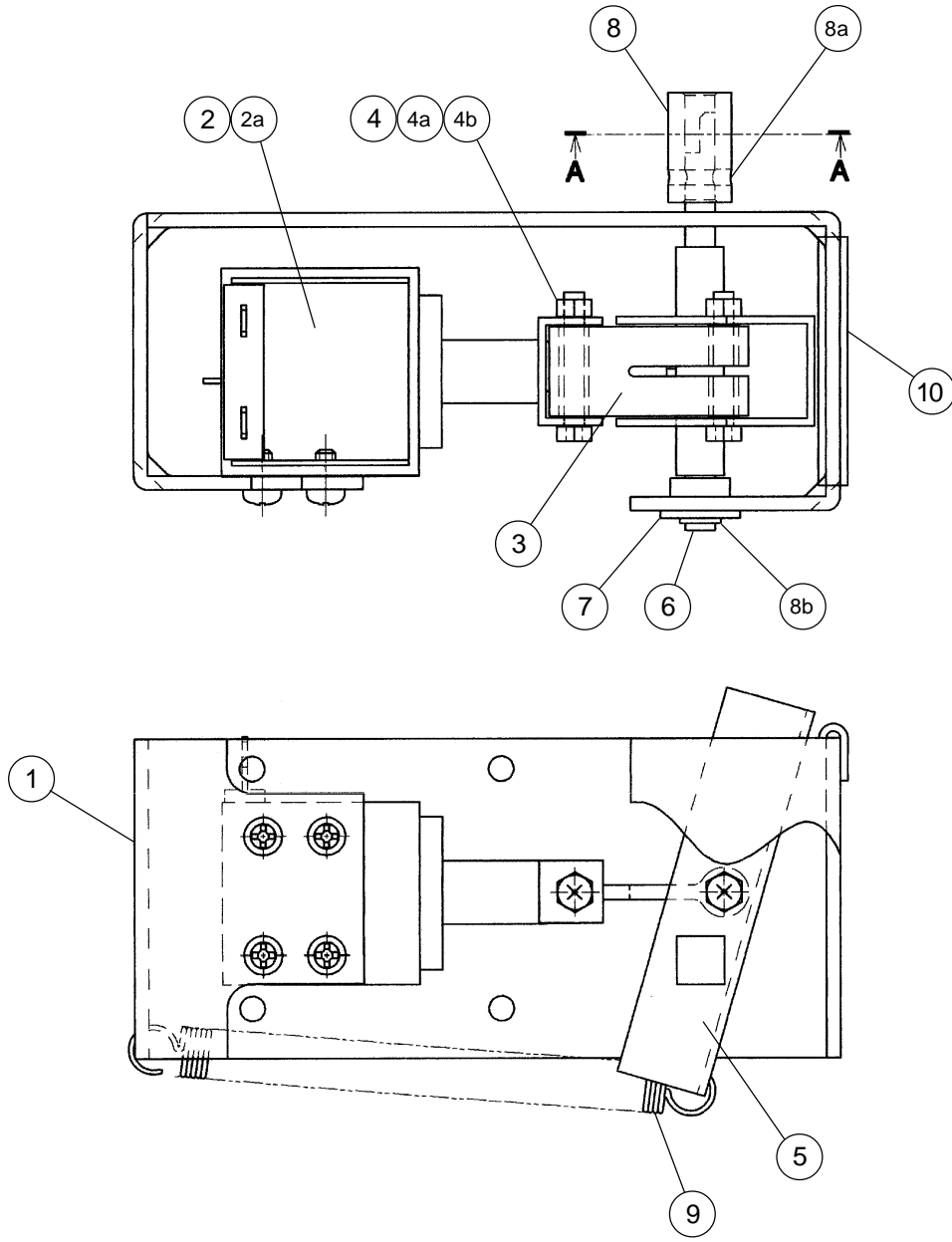

SECTION A-A

MODEL: <b>DM-90A</b> TITLE: <b>D. SOLENOID ASSY</b>										
INDEX NO.	DESCRIPTION	MATERIAL OR MODEL NUMBER	PART NUMBER	REQUIRED NUMBER						
				J-0						
1	SOLENOID BRACKET	GS	3A0795-01	1						
2	SOLENOID	D-4HD	4A1939-01	1						
2a	TRUSS HEAD SCREW	8-32X8	7C31I0831	4						
3	LINK	AC	432232-01	1						
4	COLLAR (D)	SS	432471-01	2						
4a	HEX HEAD BOLT	4X30, SS	7B02-0430	2						
4b	SELF LOCKING NUT	M4, SS	7N22-0400	2						
5	LINK SOLENOID	SS	4A1940-01	1						
6	SHAFT	SS	435532-01	1						
7	COLLAR-SHUTTER		435533-01	2						
8	CONNECTOR	SS	435534-01	1						
8a	SPRING PIN	3X12, SS	712S-0312	1						
8b	"E" RING	M5, SS	7215-0005	1						
9	SPRING	SS	432878-01	1						
10	RUBBER GASKET	CH-35	4A0662L01	1						

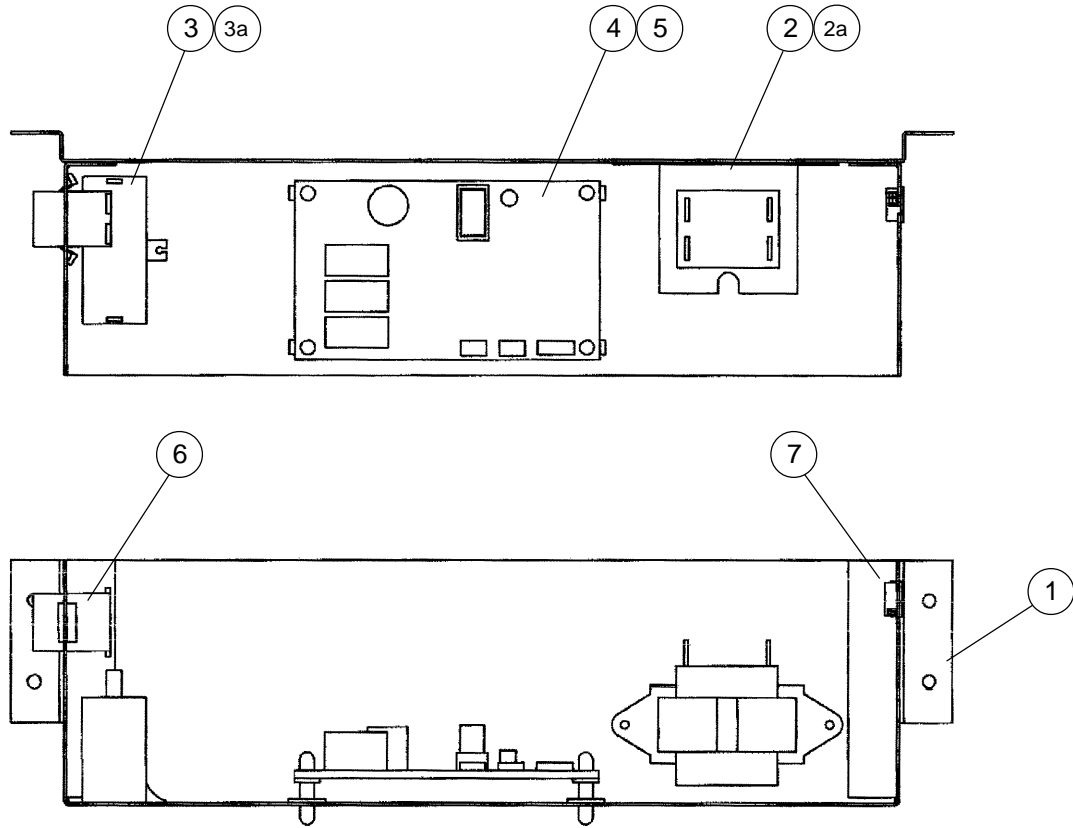

MODEL: DM-90A TITLE: E. CONTROL BOX ASSY										
INDEX NO.	DESCRIPTION	MATERIAL OR MODEL NUMBER	PART NUMBER	REQUIRED NUMBER						
				J-0 K-0						
1	CONTROL BOX (A)	GS	3A1259-01	1						
2	TRANSFORMER	BE141625GEK	4A0557-01	1						
2a	FT SCREW	4X10, SS	7F32-0410	2						
3	CAPACITOR	UP33B126UWF	4A0894-01	1						
3a	FT SCREW	4X10, SS	7F32-0410	1						
4	CONTROL BOARD	3912B000	3A1427-01	1						
5	BOARD SUPPORT	CBLS37-M	4A0336-03	4						
6	9P PLUG HOUSING	3191-09P	412832-02	1						
7	BUSHING	OCB-500	428394-02	1						

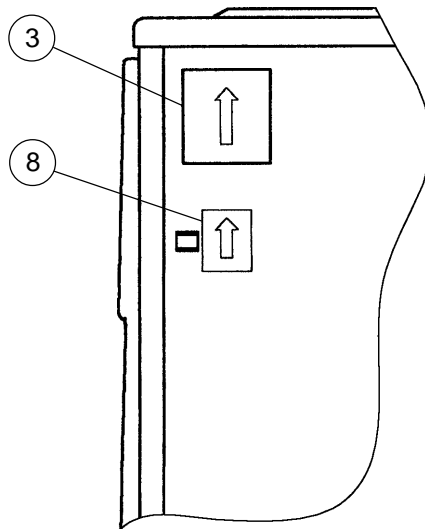
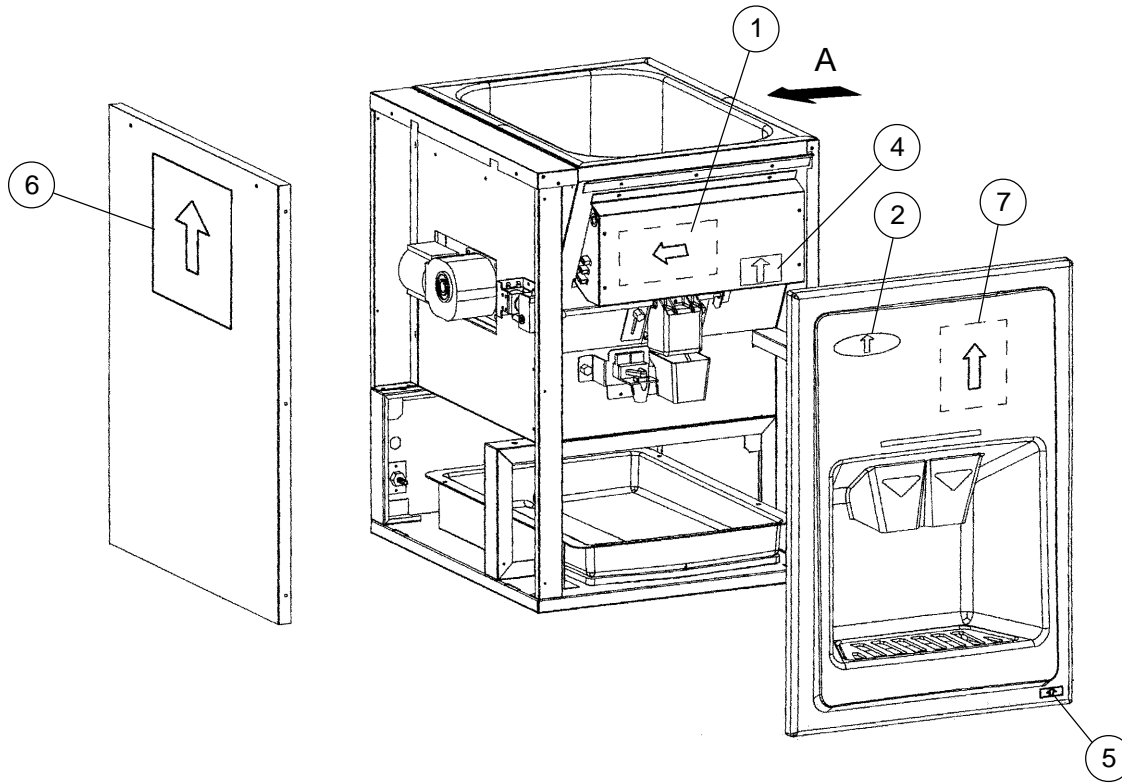

VIEW A



MODEL: DM-90A TITLE: F. LABEL LOCATION												
INDEX NO.	DESCRIPTION	MATERIAL OR MODEL NUMBER	PART NUMBER	REQUIRED NUMBER								
				J-0								
1	WIRING LABEL	PVC FILM	3A1419-01	1								
2	NAMING LABEL	-	4A1954-01	1								
3	NAMEPLATE	PES FILM	4A1240-01	1								
4	CAUTION LABEL	PVC FILM	439144-01	1								
5	MODEL NUMBER LABEL	PVC FILM	4A1244-01	1								
6	INSTRUCTION SHEET	PAPER	2A0888-01	1								
7	MAINTENANCE LABEL	PVC FILM	2A0889-01	1								
8	LABEL-ON/OFF	PVC FILM	4A0522-01	1								

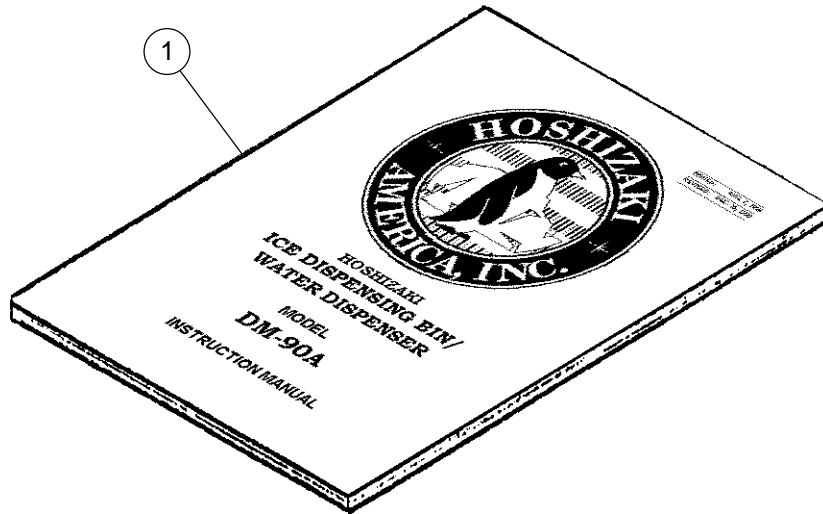

MODEL: DM-90A TITLE: G. ACCESSORIES										
INDEX NO.	DESCRIPTION	MATERIAL OR MODEL NUMBER	PART NUMBER	REQUIRED NUMBER						
				J-0						
				K-0						
1	INSTRUCTION MANUAL	PAPER	91A5CA10A	1						