

RAISED GRIDDLE

IMPERIAL 2000

BROILER

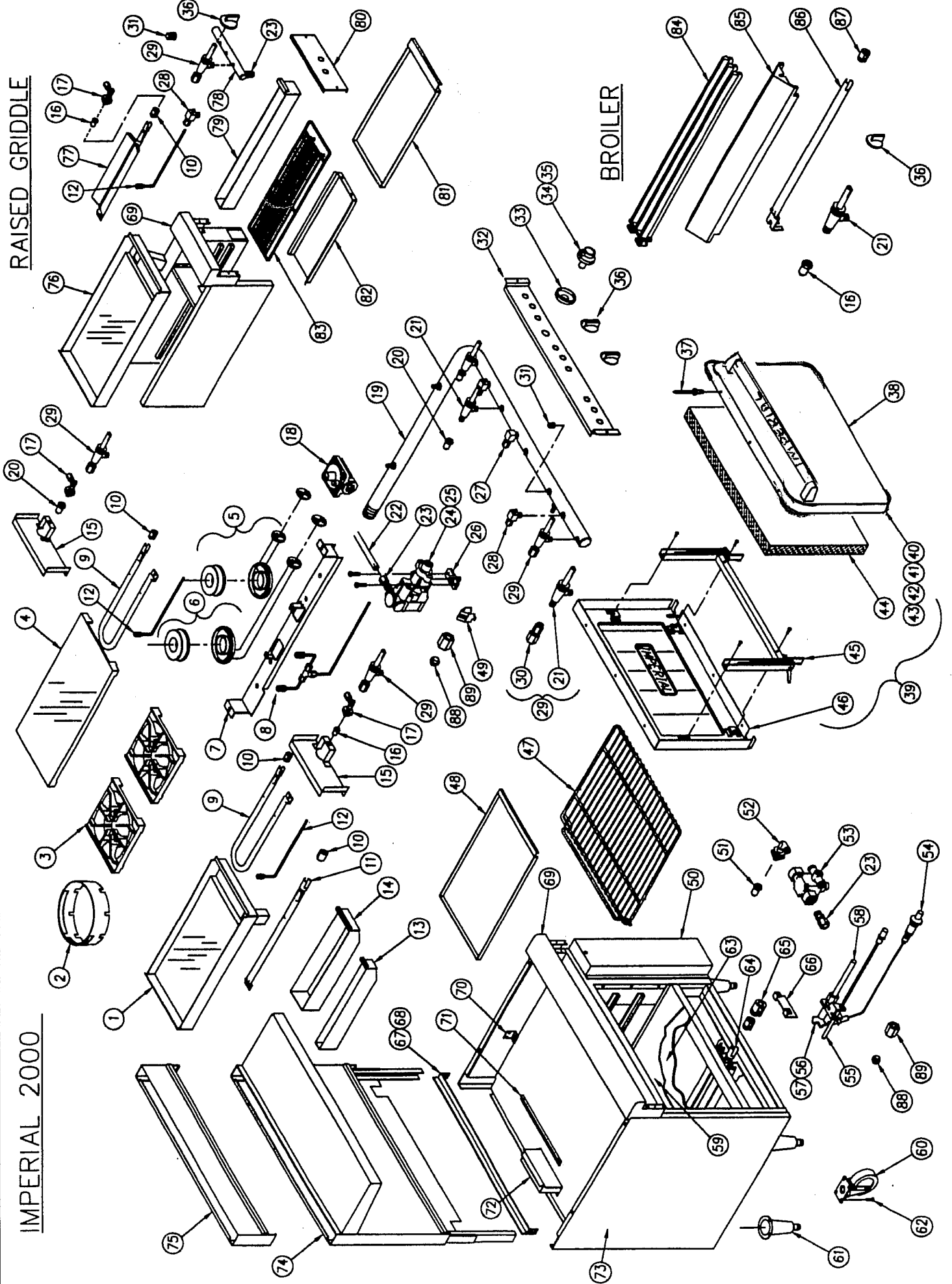

## IR 2000 Series Medium Duty Range w/Standard Oven

| ITEM NO | DESCRIPTION                                       | PART #   | 24"      | 36"      | 48"      | 60"      | 72"      |
|---------|---|----------|----------|----------|----------|----------|----------|
| 1       | Griddle Plate Assembly 12"                        | 20006    | 1        | 1        | 1        | 1        | 1        |
|         | Griddle Plate Assembly 24"                        | 20007    | 1        | 1        | 1        | 1        | 1        |
|         | Griddle Plate Assembly 36"                        | 20008    |          | 1        | 1        | 1        | 1        |
|         | Griddle Plate Assembly 48"                        | 20009    |          |          | 1        | 1        | 1        |
|         | Griddle Plate Assembly 60"                        | 20010    |          |          |          | 1        | 1        |
|         | Griddle Plate Assembly 72"                        | 20011    |          |          |          |          | 1        |
| 2       | Wok Ring  | 21065    | Optional | Optional | Optional | Optional | Optional |
| 3       | Top Grate IR 2000 12" X 12"                       | 1233     | 4        | 6        | 8        | 10       | 12       |
| ***     | "S" Grate 6" X 24" Top Grate                      | 33502    | 2        | 3        | 4        | 5        | 6        |
| 4       | Hot Top Polished 12" x 24"                        | 5009     | 2        | 3        | 4        | 5        | 6        |
| 5       | Open Burner Front Venturi                         | 1231     | 2        | 3        | 4        | 5        | 6        |
|         | Anti Clogging Burner Head                         | 2119     | 4        | 6        | 8        | 10       | 12       |
|         | Wok Jet Burner Head                               | 1230-J   | 4        | 6        | 8        | 10       | 12       |
|         | Saute Burner Head                                 | 1230-S   | 4        | 6        | 8        | 10       | 12       |
|         | Open Burner Air Shutter / Mixer Only              | 1007     | 4        | 6        | 8        | 10       | 12       |
| 6       | Open Burner Rear Venturi                          | 1232     | 2        | 3        | 4        | 5        | 6        |
|         | Anti Clogging Burner Head                         | 2119     | 4        | 6        | 8        | 10       | 12       |
|         | Wok Jet burner Head                               | 1230-J   | 4        | 6        | 8        | 10       | 12       |
|         | Saute Burner Head                                 | 1230-S   | 4        | 6        | 8        | 10       | 12       |
|         | Open Burner Air Shutter / Mixer Only              | 1007     | 4        | 6        | 8        | 10       | 12       |
| 7**     | Burner Support Bracket                            | 2682     | 2        | 3        | 4        | 5        | 6        |
| 8       | Pilot Burner Complete Assembly                    | 2683     | 2        | 3        | 4        | 5        | 6        |
|         | Pilot Burner Assembly (5in.)                      | 2684     | 2        | 3        | 4        | 5        | 6        |
| ***     | Pilot Burner Assembly Complete (Open Top Elite)   | 20001    | 2        | 3        | 4        | 5        | 6        |
| ***     | Pilot Burner Assembly (7in.)                      | 10000-7  | 2        | 3        | 4        | 5        | 6        |
|         | Tee (Brass) 3/16"                                 | 3097     | 2        | 3        | 4        | 5        | 6        |
|         | Inlet Tubing                                      | 2100-14  | 2        | 3        | 4        | 5        | 6        |
| 9       | Griddle Or Hot Top Burner ("U" Shape)             | 1032     | 2        | 3        | 4        | 5        | 6        |
| 10      | Air Shutter (Used W / Part 1032)                  | 1024     | 2        | 3        | 4        | 5        | 6        |
| 11      | Griddle Burner ("I" Shape) W / Air Shutter        | 1033     | 1        | 2        | 3        | 4        | 5        |
| 12      | Griddle Or Hot Top Pilot Burner Assembly          | 20020    | 2        | 3        | 4        | 5        | 6        |
| 13      | Wide Grease Can IR 2000 2"                        | 21095    | 1        | 1        | 1        | 1        | 1        |
| 14      | Wide Grease Can IR 2000 (22 x 3-1/2 x 2-3/4)      | 31721    | 1        | 1        | 1        | 1        | 1        |
| 14A     | Grease Can Shield                                 | 33567    | 1        | 1        | 1        | 1        | 1        |
| 15      | Griddle Front Baffle 12"                          | 20031    | 1        | 1        | 1        | 1        | 1        |
|         | Griddle Front Baffle 24"                          | 20032    | 1        | 1        | 1        | 1        | 1        |
|         | Griddle Front Baffle 36"                          | 20033    |          | 1        | 1        | 1        | 1        |
|         | Griddle Front Baffle 48"                          | 20034    |          |          | 1        | 1        | 1        |
|         | Griddle Front Baffle 60"                          | 20035    |          |          |          | 1        | 1        |
|         | Griddle Front Baffle 72"                          | 20036    |          |          |          |          | 1        |
| 16      | Griddle Or RG. / Broiler Orifice NAT.             | 2065     | 2        | 3        | 4        | 5        | 6        |
|         | Griddle Or RG. / Broiler Orifice L.P.             | 2068-1   | 2        | 3        | 4        | 5        | 6        |
| 17      | Orifice 90 Elbow - Brass (With Out Orifice)       | 37188    | 2        | 3        | 4        | 5        | 6        |
| 18      | Gas Pressure Regulator 3/4" NAT.                  | 1050     | 1        | 1        | 1        | 1        | 1        |
|         | Gas Pressure Regulator 3/4" L.P.                  | 1051     | 1        | 1        | 1        | 1        | 1        |
| 19      | Manifold Pipe - <b>CALL FACTORY FOR MORE INFO</b> |          | 1        | 1        | 1        | 1        | 1        |
| 20      | Open Burner Orifice NAT.                          | 2059     | 4        | 6        | 8        | 10       | 12       |
|         | Open Burner Orifice L.P.                          | 2076     | 4        | 6        | 8        | 10       | 12       |
|         | Hot Top Orifice NAT.                              | 2063     | 2        | 3        | 4        | 5        | 6        |
|         | Hot Top Orifice L.P.                              | 2068     | 2        | 3        | 4        | 5        | 6        |
| 21      | Open Burner Valve (With Out Orifice)              | 1610     | 4        | 6        | 8        | 10       | 12       |
| 22      | Stainless Steel Flex Tubing 3/16"                 | 37001-58 | 1        | 1        | 1 or 2   | 1 or 2   | 1 or 2   |
| 23      | Straight Fitting - Brass                          | 30293    | 2        | 2        | 2        | 4        | 4        |
| 24      | Oven Thermostat                                   | 1150     | 1        | 1        | 1        | 2        | 2        |
|         | Griddle Thermostat                                | 1100     | 1        | 2        | 2        | 3        | 3        |
| ****    | New Griddle Thermostat                            | 36015    |          |          |          |          |          |
| 26      | Thermostat Saddle Mount                           | 1104     | 1        | 1 or 2   | 1 or 2   | 2 or 3   | 2 or 3   |
| 27      | Elbow 90 Degree Fitting For Oven Pilot            | 30278    | 1        | 1        | 1        | 2        | 2        |
| 28      | Adjustable Single Pilot Valve                     | 1604     | 1        | 1        | 1        | 2        | 2        |
| ****    | Adjustable Double Pilot Valve                     | 1003     |          |          |          |          |          |
| 29      | Griddle Or RG / Broiler Valve W/O Adapter         | 1610     | 2        | 3        | 4        | 5        | 6        |
| 30      | Adapter Used With PN # 1610                       | 30286    | 2        | 3        | 4        | 5        | 6        |
| 31      | Plug 1/8"   | 30257    | 1 or 2   | 1 or 2   | 1 or 2   | 1 or 2   | 1 or 2   |
| 32      | Valve Cover - S/S                                 |          | 1        | 1        | 1        | 1        | 1        |
| 33      | Thermostat Bezel - Chrome                         | 1103     | 1        | 1        | 1        | 2        | 2        |

## IR 2000 Series Medium Duty Range w/Standard Oven

| ITEM NO                                  | DESCRIPTION                                       | PART #      | 24" | 36" | 48"     | 60"     | 72"     |
|--|---|-------------|-----|-----|---------|---------|---------|
| 34                                       | Oven Thermostat Knob                              | 1151        | 1   | 1   | 1       | 2       | 2       |
| 35                                       | Griddle Thermostat Knob                           | 1101        | 1   | 2   | 2       | 3       | 3       |
| 36                                       | Burner Knob - W / Logo Chrome Blue                | 36330       | 4   | 6   | 8       | 10      | 12      |
| 37                                       | Door Rivets S/S                                   | 1070-SK     | 8   | 8   | 8       | 8 or 16 | 8 or 16 |
| 38                                       | Kick Plate S/S Pivot Style 20" Oven               | 20142       | 1   |     | 2       |         |         |
|  | Kick Plate S/S Pivot Style 26-1/2" Oven           | 20143       |     | 1   | 1       | 2       | 2       |
|  | Kick Plate Bracket                                | 20144       | 1   | 1   | 1       | 8 or 16 | 2       |
| 39                                       | Door Complete Assembly 20" Oven                   | 2685        | 1   |     | 2       |         |         |
|  | Door Complete Assembly 26-1/2" Oven               | 2688        |     | 1   | 1       | 2       | 2       |
| <b>ASSEMBLY CONSISTS OF NEXT 7 ITEMS</b> |   |             |     |     |         |         |         |
| 40                                       | Door Cover S/S 20" Oven                           | 2687        | 1   |     | 2       |         |         |
|  | Door Cover S/S 26-1/2" Oven                       | 2689        |     | 1   | 1       | 2       | 2       |
| 41                                       | Oven Door Handle S/S 20" Oven                     | 36099       | 1   |     | 2       |         |         |
|  | Oven Door Handle S/S 26-1/2" Oven                 | 36100       |     | 1   | 1       | 2       | 2       |
| 42                                       | Oven Handle Right Side                            | 36101       | 2   | 2   | 8 or 16 | 4       | 4       |
| 42A                                      | Oven Handle Left Side                             | 36102       | 2   | 2   | 1 or 2  | 4       | 4       |
| 43                                       | Imperial Logo                                     | 35840       | 1   | 1   | 1 or 2  | 2       | 2       |
|  | Name Plate Speed Nut                              | 36569       | 2   | 2   | 1 or 2  | 2       | 2       |
| 44                                       | Door Insulation 20" Oven                          | 20154       | 1   |     | 2       |         |         |
|  | Door Insulation 26-1/2" Oven                      | 8040-1      |     | 1   | 1       | 2       | 2       |
| 45                                       | Door Closing Mechanism 20" Oven                   | 20160       | 1   |     | 2       |         |         |
|  | Door Closing Mechanism 26-1/2" Oven               | 20161       |     |     | 1       | 2       | 2       |
| 46                                       | Door Liner (20" Oven) - Porcelainized             | 9030        | 1   |     | 2       |         |         |
|  | Door Liner 26-1/2" Oven - Porcelainized           | 2128        |     | 1   | 1       | 1       | 1       |
| 47                                       | Oven Rack 20" Oven                                | 2120        | 1   |     | 2       |         |         |
|  | Oven Rack 26-1/2" Oven                            | 2130        |     | 1   | 1       | 2       | 2       |
| 48                                       | Crumb Tray 12"                                    | 20002       | 1   | 1   | 1       | 1       | 1       |
|  | Crumb Tray 24"                                    | 20003       | 1   |     | 2       |         |         |
|  | Crumb Tray 24" (New Style 4/06)                   | 34683-1     | 1   |     | 2       |         |         |
|  | Crumb Tray 36"                                    | 20004       |     | 1   |         |         | 2       |
|  | Crumb Tray 36" (New Style 4/06)                   | 34683-2     |     | 1   |         |         | 2       |
| 49                                       | Thermostat Bulb Clip                              | 3038        | 1   | 1   | 1 or 2  | 2       | 2       |
| 50                                       | Right Side Front Panel S/S                        | 20110       |     | 1   |         |         | 1       |
|  | Left Side Front Panel S/S                         | 20111       |     |     |         |         | 1       |
| 51                                       | Oven Orifice NAT. 26-1/2"                         | 2061        |     | 1   | 1       | 2       | 2       |
|  | Oven Orifice L.P. 26-1/2"                         | 2065        |     | 1   | 1       | 2       | 2       |
|  | Oven Orifice NAT. 20"                             | 2074        | 1   |     | 2       |         |         |
|  | Oven Orifice L.P. 20"                             | 2076        | 1   |     | 2       |         |         |
| 52                                       | Oven Orifice 90 Degree Elbow Fitting Only         | 1615        | 1   | 1   | 1       | 2       | 2       |
| ***                                      | 90 Deg.Brass Elbow                                | 30118       | 1   | 1   | 1 or 2  | 2       | 2       |
| 53                                       | Oven Safety Valve                                 | 1110        | 1   | 1   | 1       | 2       | 2       |
|  | Inverted Flare Nut                                | 30281       | 2   | 2   | 1 or 2  | 4       | 4       |
|  | Ferrel  | 30280       | 2   | 2   | 2 or 4  | 4       | 4       |
| ***                                      | Oven Safety Valve - BASO                          | 1110-1      | 1   | 1   | 1 or 2  | 2       | 2       |
| 54                                       | Manual Spark Igniter                              | 1075        | 1   | 1   | 1 or 2  | 2       | 2       |
| 55                                       | Oven Thermocouple 12" Long                        | 1121        | 1   | 1   | 1 or 2  | 2       | 2       |
| ***                                      | 12" Inch Thermocouple - BASO                      | 1121-1      | 1   | 1   | 1 or 2  | 2       | 2       |
| 56                                       | Oven Pilot Burner W / Ignition Wire Attach - NAT. | 1120        | 1   | 1   | 1 or 2  | 2       | 2       |
|  | Oven Pilot Burner W / Ignition Wire Attach - L.P. | 1120 & 1018 | 1   | 1   | 1 or 2  | 2       | 2       |
| ***                                      | Oven Pilot Burner W / Out Wire Attach - NAT.      | 1120-1      | 1   | 1   | 1 or 2  | 2       | 2       |
| ***                                      | Oven Pilot Burner W / Out Wire Attach - L.P.      | 1291        | 1   | 1   | 1 or 2  | 2       | 2       |
| ***                                      | 3/8" x 3/8" Mip. St. Fitting W / Nut & Sleeve     | 2995        | 1   | 1   | 1 or 2  | 2       | 2       |
| ***                                      | 3/8" Compression Nut For All                      | 30266       | 1   | 1   | 1 or 2  | 2       | 2       |
| ***                                      | 3/8" Ferrel For All                               | 30272       | 1   | 1   | 1 or 2  | 2       | 2       |
| ***                                      | 1/4" Inverted Brass Flare Nut                     | 30271       | 2   | 2   | 2 or 4  | 2       | 2       |
|  | Ferrel (Oversized) 3/16"                          | 30319       | 1   | 1   | 1 or 2  | 2       | 2       |
|  | Compression Fitting (Nut) 3/16"                   | 30262       | 1   | 1   | 1 or 2  | 2       | 2       |
| 57                                       | Oven Pilot Orifice - NAT. #18                     | 1017        | 1   | 1   | 1 or 2  | 2       | 2       |
|  | Oven Pilot Orifice - L.P. #10                     | 1018        | 1   | 1   | 1 or 2  | 2       | 2       |
| 58                                       | Stainless Steel Flex Tubing 3/16"                 | 37001-58    | 1   | 1   | 1 or 2  | 1 or 2  | 1 or 2  |
| ***                                      | Stainless Steel Flex Tubing 1/4"                  | 34681-60    | 1   | 1   | 1 or 2  | 1 or 2  | 1 or 2  |
| 59                                       | Oven Bottom 20" Oven - Porcelainized              | 20268       | 1   |     | 2       |         |         |
|  | Oven Bottom 26-1/2" - Porcelainized               | 9047        |     | 1   | 1       | 2       | 2       |
| 60                                       | Caster - 6" With Swivel Plate                     | 1060        | 2   | 2   | 2       | 2       | 3       |
| 60                                       | Caster With Brake - 6" With Swivel Plate          | 1061        | 2   | 2   | 2       | 2       | 3       |

## IR 2000 Series Medium Duty Range w/Standard Oven

| ITEM NO | DESCRIPTION  | PART # | 24"      | 36"      | 48"      | 60"      | 72"      |
|---------|--|--------|----------|----------|----------|----------|----------|
| 61      | Leg With Adjustable Foot 6"  | 30555  | 4        | 4        | 4        | 4        | 6        |
| 62      | Screw 14" X 3/4" (4 Per Caster)  | 30358  | 12 or 16 | 12 or 16 | 12 or 16 | 12 or 16 | 18 or 24 |
| 63      | Oven Flame Spreader 26 1/2" Oven   | 20235  |          | 1        | 1        | 2        | 2        |
| ***     | Oven Flame Spreader 26 1/2" Oven (New Style)   | 31584  |          | 1        | 1        | 2        | 2        |
| ***     | Oven Flame Spreader 20" Oven   | 31583  | 1        |          | 2        |          |          |
| 64      | Oven Burner W / Air Shutter  | 2099   | 1        | 1        | 1        | 2        | 2        |
| ***     | Burner Compartment Baffle  |        |          |          |          |          |          |
| 65      | Air Shutter - For Oven Burner  | 1037   | 1        | 1        | 1        | 2        | 2        |
| 66      | Safety Valve Bracket   | 20021  | 1        | 1        | 1        | 2        | 2        |
| 67      | Rear Angle Support 24"   | 20680  | 1        | 1        | 1        | 1        | 1        |
|         | Rear Angle Support 36"   | 20681  |          | 1        | 1        | 1        | 1        |
|         | Rear Angle Support 48"   | 20682  |          |          | 1        | 1        | 1        |
|         | Rear Angle Support 60"   | 20683  |          |          |          | 1        | 1        |
|         | Rear Angle Support 72"   | 20684  |          |          |          |          | 1        |
|         | Rear Angle Support RG. Only 23"  | 20690  | 1        | 1        | 1        | 1        | 1        |
|         | Rear Angle Support RG. Only 35"  | 20691  |          | 1        | 1        | 1        | 1        |
|         | Rear Angle Support RG. Only 47"  | 20692  |          |          | 1        | 1        | 1        |
| 68      | Front Angle Support 24"  | 20685  | 1        | 1        | 1        | 1        | 1        |
|         | Front Angle Support 36"  | 20686  |          | 1        | 1        | 1        | 1        |
|         | Front Angle Support 48"  | 20687  |          |          | 1        | 1        | 1        |
|         | Front Angle Support 60"  | 20688  |          |          |          | 1        | 1        |
|         | Front Angle Support 72"  | 20689  |          |          |          |          | 1        |
|         | Front Angle Support RG. Only 23"   | 20660  | 1        | 1        | 1        | 1        | 1        |
|         | Front Angle Support RG. Only 35"   | 20661  |          | 1        | 1        | 1        | 1        |
|         | Front Angle Support RG. Only 47"   | 20662  |          |          | 1        | 1        | 1        |
| 69      | Landing Ledge 12"  | 21168  | 1        | 1        | 1        | 1        | 1        |
|         | Landing Ledge 24"  | 21160  | 1        | 1        | 1        | 1        | 1        |
|         | Landing Ledge 36"  | 21161  |          | 1        | 1        | 1        | 1        |
|         | Landing Ledge 48"  | 21162  |          |          | 1        | 1        | 1        |
|         | Landing Ledge 60"  | 21163  |          |          |          | 1        | 1        |
|         | Landing Ledge 72"  | 21164  |          |          |          |          | 1        |
|         | Landing Ledge RG. Only 25"   | 21165  | 1        | 1        | 1        | 1        | 1        |
|         | Landing Ledge RG. Only 37"   | 21166  |          | 1        | 1        | 1        | 1        |
|         | Landing Ledge RG. Only 49"   | 21167  |          |          | 1        | 1        | 1        |
| ***     | Note, Landing Ledge after 3/10/03 different  |        |          |          |          |          |          |
| 70      | Manifold Bracket   | 20020  | 1        | 1        | 1        | 1        | 1        |
| 71      | Crumb Tray Back Stop   | 21120  | 1        | 1        | 2        | 2        | 2        |
| 72      | Flue Box   | 21125  | 1        | 1        | 1        | 2        | 2        |
| 73      | Side Panel   | 21140  | 2        | 2        | 2        | 2        | 2        |
|         | Side Panel For RG. Left Or Right   | 21141  | 1        | 1        | 1        | 1        | 1        |
| ***     | IR Side Panel Left Hand  | 31617  | 1        | 1        | 1        | 1        | 1        |
| ***     | IR Side Panel Right Hand   | 31618  | 1        | 1        | 1        | 1        | 1        |
| 74      | Backguard Assembly 24"   | 21200  | 1        |          |          |          |          |
|         | Backguard Assembly 36"   | 21201  |          | 1        |          |          |          |
|         | Backguard Assembly 48"   | 21202  |          |          | 1        |          |          |
|         | Backguard Assembly 60"   | 21203  |          |          |          | 1        | 1        |
|         | Backguard Assembly 72"   | 21204  |          |          |          |          | 1        |
|         | <b>ASSEMBLY CONSISTS OF NEXT 4 ITEMS</b>   |        |          |          |          |          |          |
|         | Shelf S/S 24"  | 21190  | 1        |          |          |          |          |
|         | Shelf S/S 36"  | 21191  |          | 1        |          |          |          |
|         | Shelf S/S 48"  | 21192  |          |          | 1        |          |          |
|         | Shelf S/S 60"  | 21193  |          |          |          | 1        |          |
|         | Shelf S/S 72"  | 21194  |          |          |          |          | 1        |
|         | Backguard 24"  | 21100  | 1        |          |          |          |          |
|         | Backguard 36"  | 21101  |          | 1        |          |          |          |
|         | Backguard 48"  | 21102  |          |          | 1        |          |          |
|         | Backguard 60"  | 21103  |          |          |          | 1        |          |
|         | Backguard 72"  | 21104  |          |          |          |          | 1        |
|         | Outside Back For Backguard 24"   | 21195  | 1        |          |          |          |          |
|         | Outside Back For Backguard 36"   | 21196  |          | 1        |          |          |          |
|         | Outside Back For Backguard 48"   | 21197  |          |          | 1        |          |          |
|         | Outside Back For Backguard 60"   | 21198  |          |          |          | 1        |          |
|         | Outside Back For Backguard 72"   | 21199  |          |          |          |          | 1        |
|         | Channel Support For Standard Backguard   | 21130  |          |          |          |          |          |
|         | <b>REINFORCEMENT CHANNEL TO RANGE MOUNT CHEESEMELTERS OF SALAMANDERS SEE PAGE 11 OR 13</b> |        |          |          |          |          |          |

## IR 2000 Series Medium Duty Range w/Standard Oven

| ITEM NO                                 | DESCRIPTION   | PART #    | 24"        | 36"        | 48"        | 60"        | 72"        |
|---|---|-----------|------------|------------|------------|------------|------------|
| 75                                      | Stub Back Assembly 24"                              | 21175     | 1          |            |            |            |            |
|   | Stub Back Assembly 36"                              | 21176     |            | 1          |            |            |            |
|   | Stub Back Assembly 48"                              | 21177     |            |            | 1          |            |            |
|   | Stub Back Assembly 60"                              | 21178     |            |            |            | 1          |            |
|   | Stub Back Assembly 72"                              | 21179     |            |            |            |            | 1          |
| <b>ASSEMBLY CONSIST OF NEXT 2 ITEMS</b> |   |           |            |            |            |            |            |
|   | Front Panel 24"                                     | 20265     | 1          |            |            |            |            |
|   | Front Panel 36"                                     | 20266     |            | 1          |            |            |            |
|   | Front Panel 48"                                     | 20267     |            |            | 1          |            |            |
|   | Front Panel 60"                                     | 20362     |            |            |            | 1          |            |
|   | Front Panel 72"                                     | 20363     |            |            |            |            | 1          |
|   | Outside Back (Galv.) 24"                            | 20991     | 1          |            |            |            |            |
|   | Outside Back (Galv.) 36"                            | 20992     |            | 1          |            |            |            |
|   | Outside Back (Galv.) 48"                            | 20993     |            |            | 1          |            |            |
|   | Outside Back (Galv.) 60"                            | 20994     |            |            |            | 1          |            |
|   | Outside Back (Galv.) 72"                            | 20995     |            |            |            |            | 1          |
| <b>IR RAISED GRIDDLE/BROILER</b>        |   |           | <b>24"</b> | <b>36"</b> | <b>48"</b> | <b>60"</b> | <b>72"</b> |
| 76                                      | RG. Assembly 12"                                    | 20012     | 1          | 1          | 1          | 1          | 1          |
|   | RG. Assembly 24"                                    | 20013     | 1          | 1          | 1          | 1          | 1          |
| 77                                      | Burner Assembly W / Air Shutter                     | 20125     | 1          | 1          | 1          | 1          | 1          |
|   | Wire Mesh For Raised Griddle Burner                 | 20126     | 1          | 1          | 1          | 1          | 1          |
| 78                                      | Manifold Pipe                                       |           | 1          | 1          | 1          | 1          | 1          |
| 79                                      | Grease Can For Raised Griddle Burner                | 20042     | 1          | 1          | 1          | 1          | 1          |
| 80                                      | Valve Cover S/S <b>CALL FACTORY FOR MORE INFO</b>   |           | 1          | 1          | 1          | 1          | 1          |
| 81                                      | Crumb Tray For Raised Griddle Broiler 12"           | 20017     | 1          | 1          | 1          | 1          | 1          |
|   | Crumb Tray, Raised Griddle Broiler, 19 1/4 X 22 3/8 | 20018     | 1          | 1          | 1          | 1          | 1          |
| 82                                      | Drip Pan For RG. Broiler 12"                        | 20014     | 1          | 1          | 1          | 1          | 1          |
|   | Drip Pan For RG. Broiler 24"                        | 20015     | 1          | 1          | 1          | 1          | 1          |
| 83                                      | Rack For RG. Broiler 12"                            | 2024      | 1          | 1          | 1          | 1          | 1          |
|   | Rack For RG. Broiler 24"                            | 2025      | 1          | 1          | 1          | 1          | 1          |
| <b>IR RADIANT BROILER</b>               |   |           |            |            |            |            |            |
| ****                                    | Rack Guide  | 30922     | 4          | 4          | 4-Jan      | 4          | 4          |
| 84                                      | Top Grate, 3 Bar, 3" X 21"                          | 1201      | 7          | 11         | 15         | 19         | 23         |
|   | <b>Top Grate Opt. For Fish, 4 Bar 3" X 21"</b>      | 1203      | 7          | 11         | 15         | 19         | 23         |
| 85                                      | Burner Radiant - Cast Iron                          | 5025      | 4          | 6          | 8          | 10         | 12         |
|   | Burner Radiant - S/S                                | 1302      | 4          | 4 or 6     | 4 or 6     | 4 or 6     | 4 or 6     |
| 86                                      | Burner W / Air Shutter - S/S                        | 1020      | 4          | 6          | 8          | 10         | 12         |
| 87                                      | Air Shutter   | 1024      | 4          | 6          | 8          | 10         | 12         |
| 88                                      | Compression Fitting (Nut) 3/16"                     | 30277     | 4          | 6          | 8          | 10         | 12         |
| 89                                      | Ferrel 3/16"  | 30280     | 8          | 12         | 16         | 20         | 24         |
|   | Compression Fitting (Nut) 3/8"                      | 30266     | 4          | 6          | 8          | 10         | 12         |
|   | Ferrel 3/8"   | 30272     | 8          | 12         | 16         | 20         | 24         |
| <b>IR RADIANT BROILER</b>               |   |           |            |            |            |            |            |
| 90                                      | Liner 24"   | 11400     | 1          | 1          | 1          | 1          | 1          |
|   | Liner 36"   | 11402     | 1          | 1          | 1          | 1          | 1          |
| 91                                      | Burner Orifice - Brass - NAT.                       | 2065      | 4          | 4 or 6     | 4 or 6     | 4 or 6     | 4 or 6     |
|   | Burner Orifice - Brass - L.P.                       | 2068-1    | 4          | 4 or 6     | 4 or 6     | 4 or 6     | 4 or 6     |
| 92                                      | Burner Gas Valve - Brass                            | 1610      | 4          | 4 or 6     | 4 or 6     | 4 or 6     | 4 or 6     |
| 93                                      | Adjustable Double Pilot Valve - Brass               | 1003      |            |            |            |            |            |
| 94                                      | Burner Knob - Chrome                                | 36330     | 4          | 1 or 2     | 1 or 2     | 1 or 2     | 1 or 2     |
| 95                                      | Crumb Tray 24"                                      | 11412     | 1          | 1          | 1          | 1          | 1          |
|   | Crumb Tray 36"                                      | 11414     | 1          | 1          | 1          | 1          | 1          |
| 96                                      | Pilot Burner Assembly                               | 10000-14  | 4          | 1 or 2     | 1 or 2     | 1 or 2     | 1 or 2     |
|   | Pilot Burner Assembly - S/S                         | 10000-14S | 4          | 1 or 2     | 1 or 2     | 1 or 2     | 1 or 2     |