



**Ice Machine Parts List  
for Models**

**AR1100A**

**AR1101W**

**AD1102A**

**AD1103W**

**AY1104A**

**AY1105W**

**BY1114A**

**BY1115W**

**Remote Cuber**

**AO & BY1190N**

**Remote Condenser**

**AC1195A**

**Manufactured April 1972 through May 1981**

## A1100

<b>STANDARD 1100 SERIES CUBERS</b>	<b>PART NO.</b>	<b>CONTROL GROUP, continued</b>	<b>PART NO.</b>
<b>COMPRESSOR CONDENSER GROUP</b>			
<b>Bristol Compressor</b> , Single Phase. No Longer Available			
Bristol Run Capacitor . . . . .	20-1014-3	High Pressure Control, Cut-out (Water-cooled only) Starting with SN 0-11693 . . . . .	23-5511-3
Start Capacitor . . . . .	85-0364-3	Expansion Valve . . . . .	† 83-6714-9
Bristol Start Relay . . . . .	85-0365-3	Terminal Board . . . . .	25-1013-1
<b>Tecumseh Compressor</b> , Single Phase: (B/M #AH333ET-108-A4)			
Start Relay . . . . .	85-0313-3	Paragon Timer (60 second) Used Up to SN 0-06446 . . . . .	No Longer Available
Start Capacitor . . . . .	† 85-0314-3	Paragon Timer (15 minute) Used Up to SN 0-06446 . . . . .	24-0607-1
Run Capacitor . . . . .	† 85-0439-3	Mounting Track, Solid State Timer . . . . .	44-0784-1
Start Capacitor End Cap . . . . .	85-0308-3	Solid State Timer . . . . .	† 24-0623-9
<b>Copelaweld Compressor</b> , Single Phase: (YSB4-0150-CFV-205)			
Start Relay . . . . .	15-0283-1	Time Delay Relay 70 Second Delay . . . . .	24-0617-1
Start Capacitor . . . . .	† 85-0316-3	Solenoid Valve (Liquid line) Used Up to SN 0-11692 . . . . .	24-0401-1
Run Capacitor . . . . .	15-0284-1	Fan Cycling Switch . . . . .	No Longer Available
Capacitor Strap . . . . .	85-0309-3	Control Panel Front Cover Used Up to SN 0-11692 . . . . .	No Longer Available
Compressor Grommet . . . . .	† 85-0306-9	Control Panel Front Cover Started with SN 0-11693 . . . . .	No Longer Available
Single Phase Contactor with Eyelet Connections . . . . .	24-1004-1	Solenoid Hot Gas Valve Coil (Sporlan) Up to SN ACO 100 . . . . .	No Longer Available
Single Phase Contactor Using Quick Connect Terminals . . . . .	† 24-1016-9	Hot Gas Solenoid Valve . . . . .	† 24-0424-3
<b>3 Phase Compressor</b> . . . . . † 76-2044-3			
3 Phase Contactor . . . . .	No Longer Available	Hot Gas Solenoid Coil Only (Sporlan) No Longer Available	
3 Phase Contactor with Auxiliary Switch — Starting with SN 0-11693 . . . . .	24-1013-3	Hot Gas Solenoid Coil Only (Alco) . . . . .	† 24-0448-3
Drier . . . . .	† 89-3027-9	<b>EVAPORATOR ASSEMBLY GROUP</b>	
Water Regulating Valve (Water-cooled only) † 83-7203-3		Front Evaporator Assembly (Dice) . . . . .	† 680301-9
Condenser Water-Cooled			
Up to SN 0-03467 . . . . .	No Longer Available	Rear Evaporator Assembly (Dice) . . . . .	† 680302-9
Condenser Air-Cooled Starting			
with SN 0-03467 . . . . .	No Longer Available	Front Evaporator Assembly (Regular) . . . . .	No Longer Available
Condenser Assembly (includes fan motor assembly) Starting with SN 0-03467 . . . . .			
No Longer Available			
Condenser Water-Cooled Starting			
with SN 0-03467 . . . . .	† 11-6511-7	Rear Evaporator Assembly (Regular) . . . . .	No Longer Available
Access Service Valve 2-High and Low Side (Starting with SN 0-11693) . . . . .			
	† 13-7305-9	Front Evaporator Assembly (Half dice) . . . . .	† 680311-9
Fan Motor (Upper and lower) . . . . .	24-1207-1	Rear Evaporator Assembly (Half dice) . . . . .	† 680312-9
Fan Motor Bracket . . . . .	† 656861-4	Evaporator Top Grid Extrusion . . . . .	† 15177-1
Fan Blade . . . . .	24-0189-1	Evaporator Bottom Grid Extrusion . . . . .	No Longer Available
Fan Shroud Weldment . . . . .	604871-4	Evaporator Left Hand End Grid Extrusion . . . . .	† 626001-4
Suction Valve Seal (Copeland and Tecumseh Compressor) . . . . .			
	No Longer Available	Nut for Extrusion . . . . .	† 54-2878-9
Suction Valve Only (Copeland and Tecumseh Compressor) Replacement Kit . . . . .			
	07-0050-3	Evaporator Right Hand Grid Extrusion . . . . .	† 626002-4
Discharge Valve Only . . . . . No Longer Available			
Discharge Valve Seal . . . . . 15-0278-1			
Receiver (Water-cooled units only) . . . . . † 12-0022-1			
Receiver (Air-cooled units only) Used Up to SN 0-11693 . . . . .			
	12-0003-1	<b>WATER CIRCUIT GROUP</b>	
Base Valve (Service) Used Up to SN 0-11692 . . . . .			
	13-7302-1	Water Distribution Tube Assembly . . . . .	† 652063-4
<b>CONTROL GROUP</b>			
Main Toggle Switch . . . . .	† 23-0084-9	Water Tube Clip . . . . .	606161-4
Manual Harvest Switch Starting with SN 0-14322 . . . . .	23-0097-3	Water Supply Tube 1-3/8" OD (From water pump to distribution tube) . . . . .	† 44-2036-3
Bin Microswitch (Damper Door) . . . . .	† 23-0079-9	Water Inlet Tube 1-3/8" OD (From 90° elbow to distribution tube) . . . . .	† 44-2036-3
Bin Switch Bracket . . . . .	11089-1	90° PVC Elbow . . . . .	13-9002-1
Thermodisc . . . . .	† 23-5103-3	Water Sump Trough Assembly . . . . .	† 681203-4
Low Pressure Cut-in (Ranco) . . . . .	† 23-5105-3	Sump Hold Down Clip . . . . .	11070-1
High and Low Pressure Cut-out (Ranco Dual) Used Up to SN 0-11692 . . . . .	23-5508-1	Water Curtain . . . . .	† 681332-4
		Left Hand Water Curtain Hook (Metal bracket) . . . . .	609711-4
		Right Hand Water Curtain Hook (Metal bracket) . . . . .	609721-4
		Water Pump 50/60 Cycle . . . . .	† 14-8027-9
		Float Valve Assembly . . . . .	† 83-6904-9
		Float Valve Bracket . . . . .	† 620281-4
		"Y" Type Water Strainer Inlet . . . . .	† 12-6003-3
		Thumb Screw for Harvest Rack, Sump Clip, Ice Chute Clip . . . . .	† 50-0001-3
		Overflow Elbow . . . . .	43-0109-1
		Water Inlet Assembly (Brass) . . . . .	30110-1
		Water Supply Tubing (1/4" OD polyethylene tube) . . . . .	44-2029-1
		Water Inlet Tube Insert (Supply tubing float valve end) . . . . .	† 44-2030-9

† Refer to Cross Reference Guide

## A1100, CONTINUED

ICE CHUTE GROUP	PART NO.
Rear Ice Chute Assembly Up to SN 0-11692 . . . . .	652632-4 & † 681741-4
Rear Ice Chute Assembly Starting with SN 0-11693 & Up to SN 81020032 . . . . .	652632-4
Harvest Rack — without Tabs . . . . .	000000150
Front Ice Chute (For use with harvest rack 000000150) . . . . .	No Longer Available
Rear Ice Chute (For use with harvest rack 000000150) . . . . .	No Longer Available
Harvest Rack — with Tab & Slotted Mounting Hole . . . . .	613491-4
Front Ice Chute (For use with harvest rack with tabs). . . . .	656462-4
Rear Ice Chute (For use with harvest rack 613491-4) . . . . .	656472-4
Harvest Rack — with Tab & Round Mounting Hole For 1/4 Turn Fastener . . . . .	† 000000115
Nylon Rod Bearing For Ice Chute . . . . .	† 37-3005-9
Damper Door Assembly Up to SN 81020032 †	681741-4
Damper Door Assembly After SN 81020032	682621-4
Nylon Rod Bearing for Damper Door . . . . .	† 37-3006-9
Ice Chute Clip (Clip thumb screw, See Water Circuit Group on Page 24) Up to SN 0-11692 . . . . .	No Longer Available
<b>*BY 1100 MODELS</b>	
Bin Thermostat . . . . .	23-5004-1
Toggle Switch . . . . .	No Longer Available
Bracket Assembly . . . . .	No Longer Available
Thumb Screws, Thermostat Bulb . . . . .	† 50-0001-3
Space Bar . . . . .	609121-4
<b>*REMOTE CUBER MODELS</b>	
AR-1190N, AD-1192N, AY-1194N & BY-1194NS (Model Numbers used Starting with SN 0-13350); AY-1190N (Model No. used up to SN 0-13350)	
Thermodisc . . . . .	† 23-5103-3
Head Pressure Control . . . . .	76-2236-3
Headmaster Relocation Package . . . . .	† 76-2237-3
Receiver . . . . .	† 76-2327-3
Low Pressure Cut-out . . . . .	23-5514-3
High Pressure Cut-out . . . . .	23-5511-3
Solenoid Valve Coil (Liquid line pump down) Up to SN AB0100 . . . . .	24-0412-1
Solenoid Valve Body (Liquid line pump down) Up to SN AB0100 . . . . .	No Longer Available
Solenoid Valve Assembly (Liquid line pump down) Starting SN AB0100 . . . . .	† 24-0453-3
Solenoid Valve Coil Only (Starting SN AB0100) . . . . .	No Longer Available
Solenoid Valve Body Only (Starting SN AB0100) . . . . .	No Longer Available
<b>CABINET GROUP</b> (Used Up to SN 0-04244) PAINTED	
Front Panel Trim . . . . .	† 81-3487-3
Front Panel Series Trim Assembly	No Longer Available
Foam Tape (For mounting front panel trim) . . . . .	No Longer Available
Top Cover . . . . .	† 15628-3
Left Hand End Panel Assembly . . . . .	No Longer Available
Right Hand End Panel Assembly . . . . .	No Longer Available
Rear Panel Assembly . . . . .	No Longer Available
Front Panel Assembly . . . . .	No Longer Available

CABINET GROUP	PART NO.
<b>(Starting with SN 0-04244) PAINTED</b>	
Top Cover . . . . .	No Longer Available
Left Hand End Panel Up to SN 0-11692 . . . . .	No Longer Available
Right Hand End Panel . . . . .	† 601383-4
Rear Panel . . . . .	No Longer Available
Front Panel . . . . .	No Longer Available
Left Hand End Panel Only, (Starting with SN 0-11693) . . . . .	No Longer Available
<b>CABINET GROUP (Starting with SN-AH0100)</b>	
<b>SPLIT PANELS PAINTED</b>	
Top Cover . . . . .	No Longer Available
Left Hand Front Panel . . . . .	No Longer Available
Right Hand Louver Front Panel . . . . .	No Longer Available
Right Hand Rear Panel . . . . .	No Longer Available
Left Hand Louver Rear Panel . . . . .	No Longer Available
Left Hand End Panel . . . . .	No Longer Available
Right Hand End Panel . . . . .	† 601383-4
Hex Head Mounting Screw . . . . .	† 51-2464-9
<b>STAINLESS STEEL</b>	
Top Cover . . . . .	No Longer Available
Right Hand End Panel . . . . .	No Longer Available
Rear Panel . . . . .	No Longer Available
Front Panel . . . . .	No Longer Available
Left Hand Panel . . . . .	No Longer Available
Thumb Screw for Front Panel . . . . .	† 50-1205-9
<b>CABINET GROUP (Starting with SN-AH0100)</b>	
<b>SPLIT PANELS STAINLESS STEEL</b>	
Top Cover . . . . .	No Longer Available
Left Hand Front Panel . . . . .	No Longer Available
Right Hand Louver Front Panel . . . . .	No Longer Available
Right Hand Rear Panel . . . . .	No Longer Available
Left Hand Louver Rear Panel . . . . .	No Longer Available
Left Hand End Panel . . . . .	No Longer Available
Right Hand End Panel . . . . .	No Longer Available
<b>McDONALD'S SPLIT PANELS</b> (Starting with SN-AH0100)	
Left Hand Front Panel . . . . .	No Longer Available
Right Hand Louver Front Panel . . . . .	No Longer Available
All Other Panels Same As Other Stainless Steel Models.	
Right Hand Trim for McDonalds. . . . .	No Longer Available
Left Hand Trim for McDonalds . . . . .	No Longer Available
<b>*50 CYCLE MODELS ONLY</b>	
Compressor . . . . .	No Longer Available
<b>Components for Copeland Compressor</b>	
Start Relay . . . . .	15-0296-1
Run Capacitor . . . . .	No Longer Available
Start Capacitor . . . . .	† 85-0422-3
<b>Components for Tecumseh Compressor</b>	
Start Relay . . . . .	85-0313-3
Start Capacitor . . . . .	† 85-0314-3
Run Capacitor . . . . .	† 85-0439-3
Water Pump . . . . .	† 14-8027-9
Condenser Fan Motor . . . . .	24-1214-1
* Use the same parts as previously listed for the standard 1100 cuber with the exception of the changes or additions listed under the special model number.	

† Refer to Cross Reference Guide

# AC1195 REMOTE CONDENSER

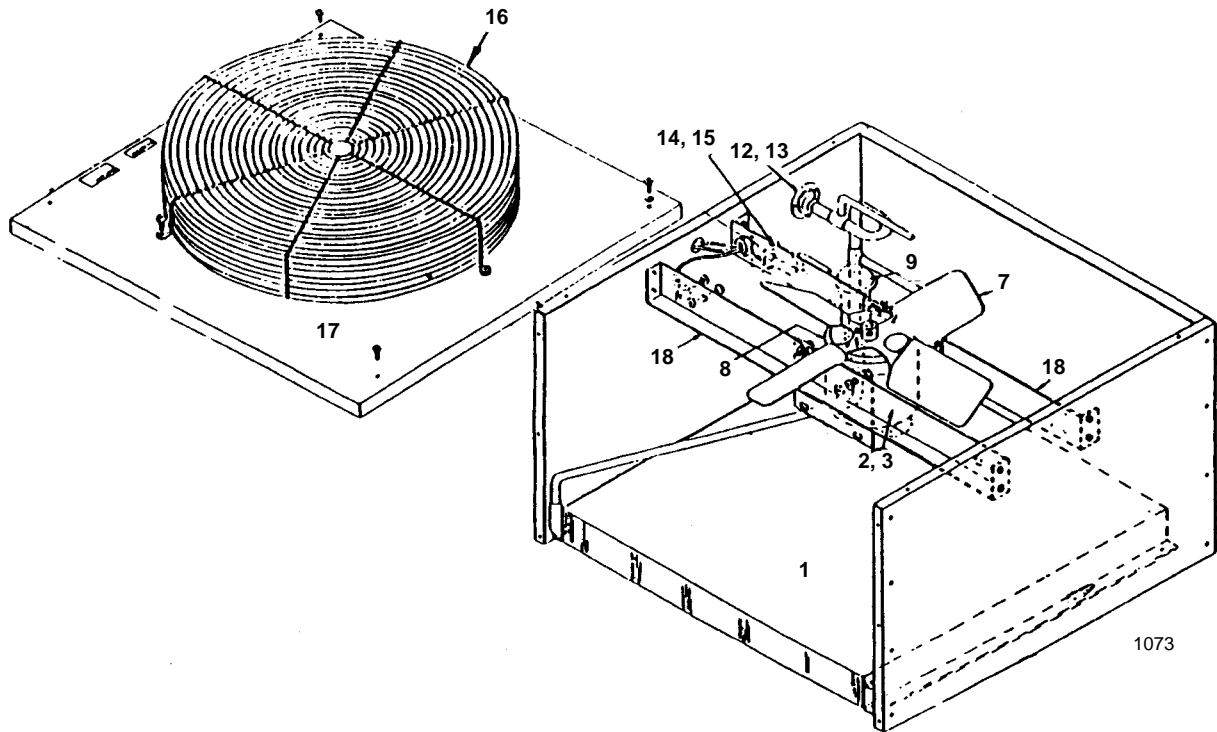

1073

	<b>PART NO.</b>
1 Air Condenser . . . . .	† 88-5062-9
2 Fan Motor, 60 Hz For Dual Bracket Mount* . . . . .	† 76-2941-3
3 Fan Motor, 50 Hz For Dual Bracket Mount* . . . . .	† 76-2941-3
4 Fan Capacitor For Dual Bracket Fan Motor (Emerson) . . . . .	85-0335-3
4 Fan Capacitor For Dual Bracket Fan Motor (Magnatec) . . . . .	85-0352-3
5 Fan Capacitor For Single Bracket Fan Motor . . . . .	24-1502-3
6 Fan Blade For Single Bracket Fan Motor . . . . .	24-1604-3
7 Fan Blade For Dual Bracket Fan Motor . . . . .	24-1611-3
8 Rain Slinger . . . . .	24-1505-3
9 Headmaster Control (See item 21 below) . . . . .	† 83-6804-9
10 Toggle Switch Up to SN 82020001 . . . . .	No Longer Available
11 Toggle Switch After SN 82020001 . . . . .	No Longer Available
12 Coupling Assembly, Male 1/2" . . . . .	† 83-6035-3
13 Mounting Flange 1/2" . . . . .	83-6006-3
14 Coupling Assembly, Male 3/8" . . . . .	† 83-6034-3
15 Mounting Flange 3/8" . . . . .	83-6005-3
16 Fan Grill . . . . .	34-0064-3
17 Top Cover . . . . .	† 601775-1
18 Base Bracket . . . . .	† 601768-1
19 Female Coupling Kit (Not shown) . . . . .	07-0062-3
20 Valve Access Fitting Core . . . . .	† 13-7305-9
21 Headmaster Relocation Kit (Used for units originally built with headmaster in ice machine to relocate to condenser) . . . . .	† 76-2237-3

\*If unit has a fan motor mounted on a single bracket, use replacement kit #76-1984-3 for 60 Hz unit (#76-1985-3 for 50 Hz). This kit includes new fan motor, capacitor, blades, dual brackets and all necessary hardware for installation.

## AC-1195A REMOTE CONDENSER S/N 005522 TO 006715 ONLY

Fan Motor (2 per) . . . . .	24-1207-1
Fan Blade (2 per) . . . . .	24-0189-1
Fan Motor Grill & Bracket (2 per) . . . . .	34-0063-3

† Refer to Cross Reference Guide