



## **Ice Machine Parts List for Series G0600 Cuber Models**

<b>GR0600A</b>	<b>GD0603W</b>
<b>GD0602A</b>	<b>GY0604A</b>
<b>GR0692N</b>	<b>GY0694N</b>
<b>GY0605W</b>	<b>R502 System</b>
<b>GR0601W</b>	

**Manufactured October 1984 through October 1992**

# G0600 CONTROL BOX

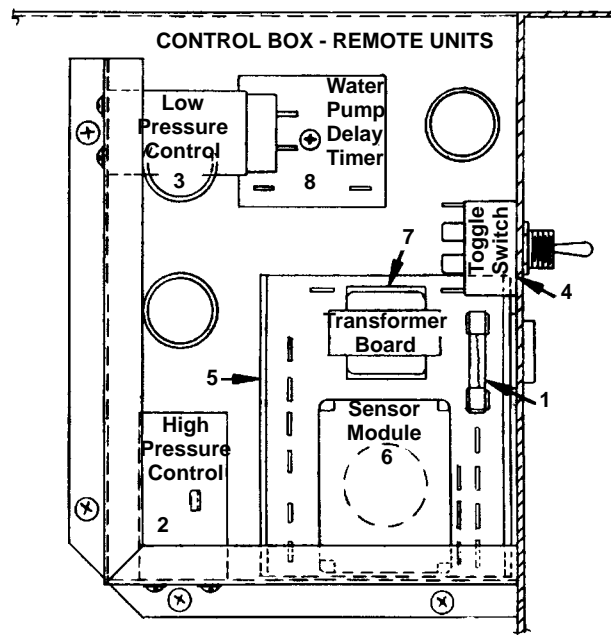
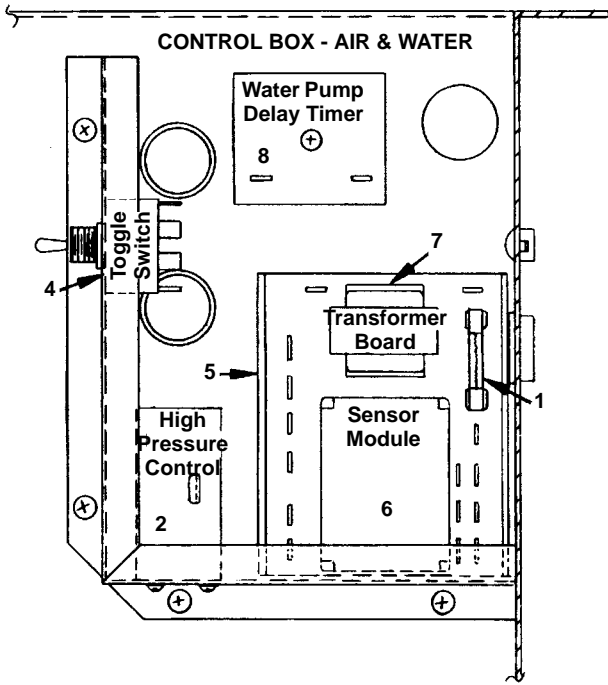

1221

## CONTROL BOX

## PART NO.

1	Fuse .....	† 2510379
2	High Pressure Cut-out Control Air, Water and Remote Up To SN 870860000 .....	2355213
	After SN 870860000 Use .....	NLA
3	Low Pressure Control (Remote) Up To SN 870860000 .....	No Longer Available
	After SN 870860000 Use .....	2355273
4	Main Toggle Switch .....	† 2300849
5	Mounting Track (For transformer board) .....	4408013
6	Sensor Module Use .....	† 7623753
7	Transformer Board 230V Use .....	† 7623753
8	Water Pump Delay Timer .....	† 2406423
9	Unitized Sensor Board .....	† 7623753
10	Water Shield Used When Stacking ...	NLA

## UNITIZED SENSOR BOARD

#7623753

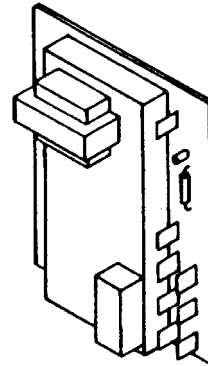

**Unitized sensor board** is used to replace both the transformer board and sensor module

# G0600 WATER DISTRIBUTION

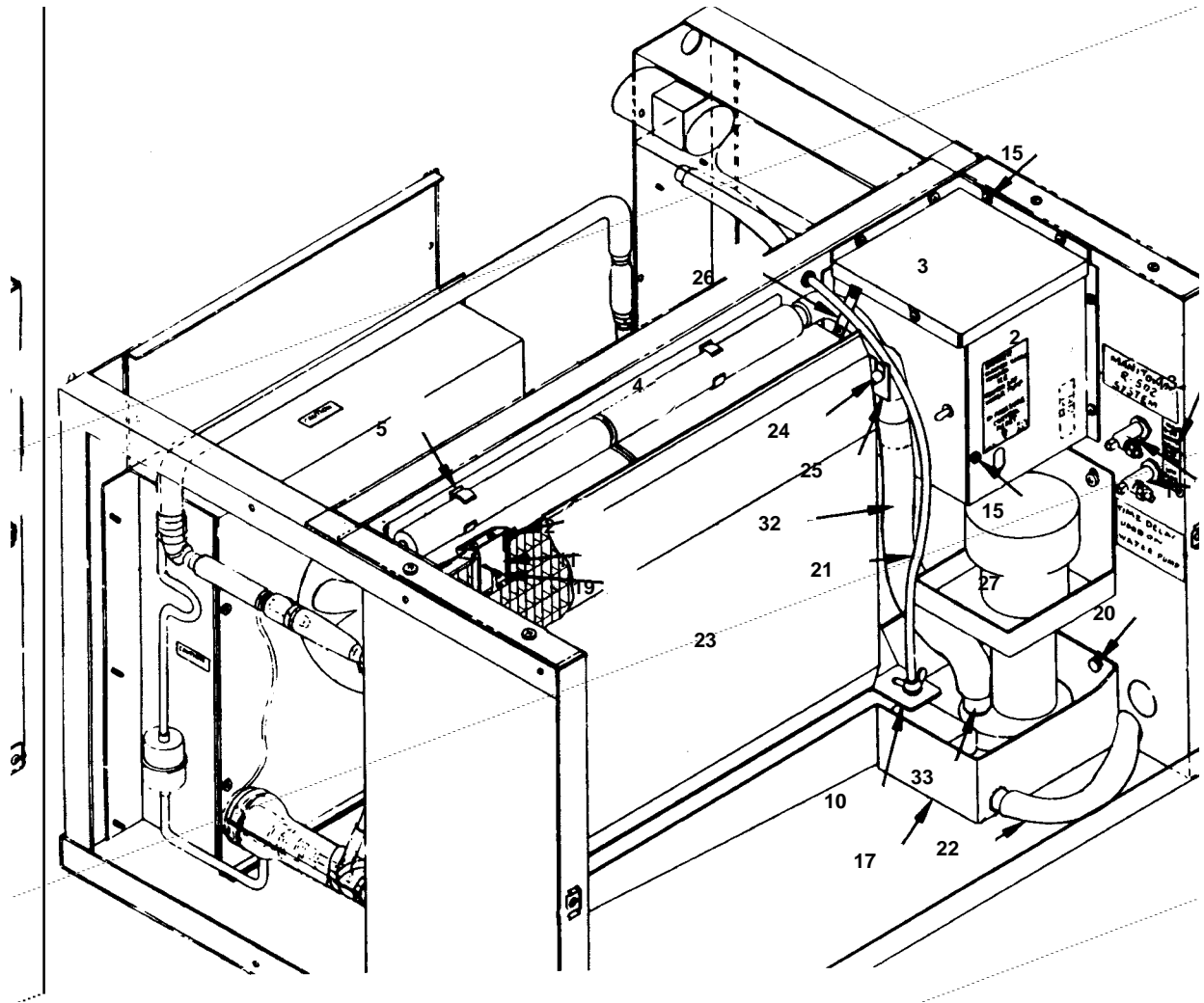

1222

## EVAPORATOR AND WATER DISTRIBUTION

	PART NO.		PART NO.
1	Activating Pin Assembly . . . . .	7620253	
2	Control Box Front Cover . . . . .	No Longer Available	
3	Control Box Top Cover . . . . .	No Longer Available	
4	Distribution Tube Assembly . . . . .	No Longer Available	
5	Distribution Tube Spring Clip . . . . .	No Longer Available	
6	Evaporator, Regular Cube . . . . .	† 6843119	
7	Evaporator, Dice Cube . . . . .	No Longer Available	
8	Evaporator, Half Dice Cube . . . . .	No Longer Available	
9	Float Valve . . . . .	† 8369049	
10	Float Valve Bracket . . . . .	† 7621403	
11	Ice Thickness Control . . . . .	† 7619963	
12	Ice Thickness Control - Bracket . . . . .	6185814	
13	Label (For high and low side service valve) . . . . .	† 8131473	
14	Nylon Nut (For mounting 4302013) . . . . .	† 5429459	
15	Screw 10-24 Phillips Head (Pkg. of 12) . . . . .	† 5202059	
16	Service Valve, High and Low Side . . . . .	† 8373109	
17	Sump Trough . . . . .	6861014	
18	Sump Trough Support Pin . . . . .	† 4302019	
19	Thumb Screw for Ice Thickness Control . . . . .	No Longer Available	
20	Thumb Screw (Mounting sump trough) . . . . .	† 5305049	
21	Tubing, Polyflow 32" Long (Fresh water inlet to float valve) . . . . .	4420291	
22	Tubing 1/2" ID, 15" Long . . . . .	† 4420333	
23	Water Curtain . . . . .	† 7619873	
24	Water Curtain Hanger (White plastic) . . . . .	† 5650459	
25	Water Curtain Side Bracket (Set of right and left hand) . . . . .	† 7621773	
26	Water Flow Clamp Assembly . . . . .	7620543	
27	Water Pump 60 Hz 220V . . . . .	† 7626013	
28	Water Inlet Strainer . . . . .	† 1260033	
29	Water Pump Lead w/Female Plug . . . . .	No Longer Available	
30	Water Siphon Tube Assembly (See Page 4) . . . . .	No Longer Available	
31	Water Tee Break (See Page 4) . . . . .	7621553	
32	Pump Discharge Tube (Units using siphon system) . . . . .	No Longer Available	
	Units with Dump Solenoid Use The Following in Place of 7621823:		
	Vinyl Tubing . . . . .	† 4420333	
	Reducer Assembly . . . . .	7623773	
33	Pump Discharge Tube Clamp . . . . .	† 5650539	

† Refer to Cross Reference Guide

# G0600 AIR-COOLED

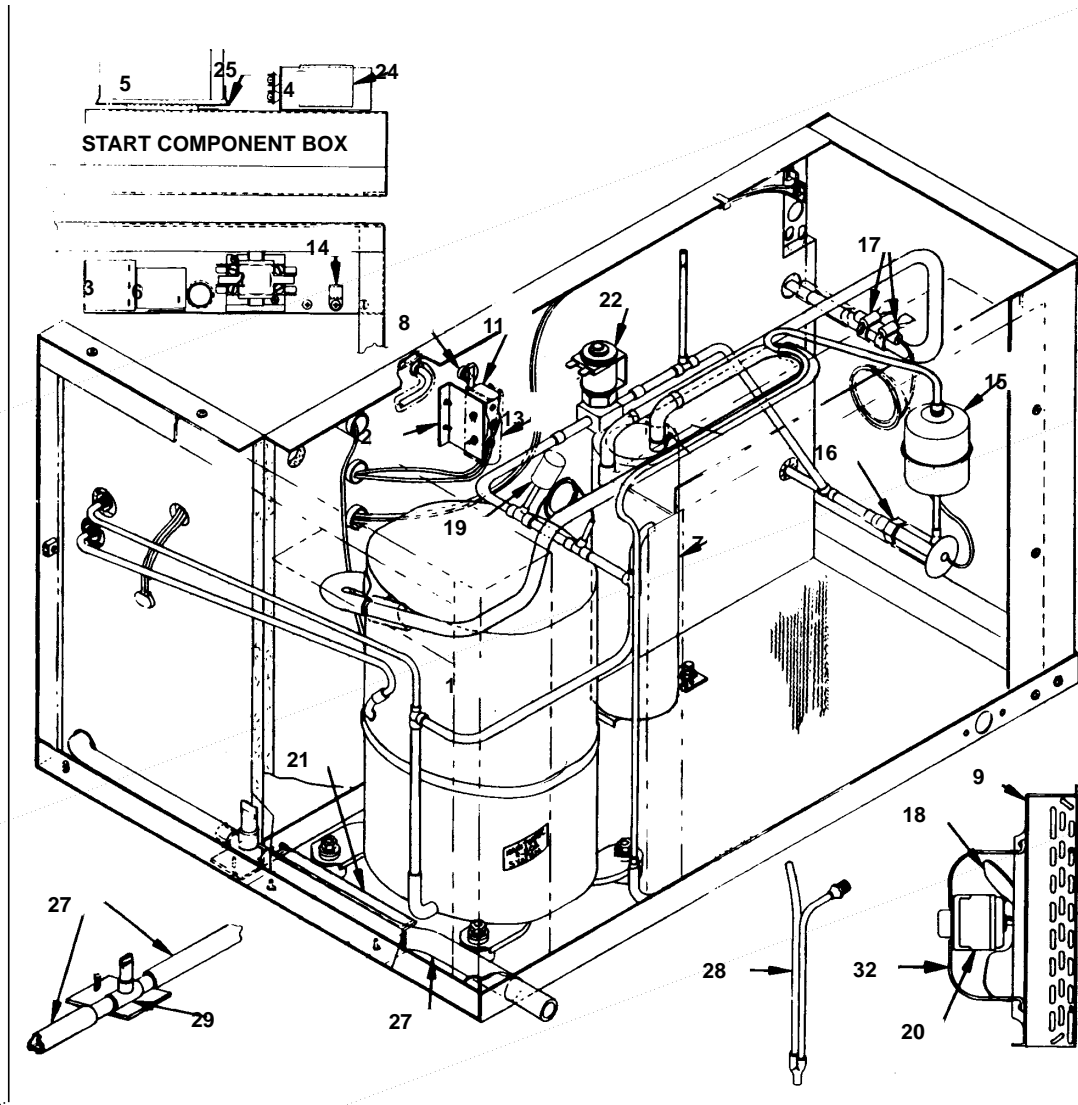

1223

**Air-cooled**

	<b>PART NO.</b>
1 Compressor Assembly 60 Hz 220V	No Longer Available
2 Contactor	No Longer Available
3 Delay Timer (Air and water)	† 2406353
4 Run Capacitor	See Page 9
5 Start Capacitor	See Page 9
6 Start Relay	See Page 9
7 Accumulator	No Longer Available
8 Activating Pin Assembly	7620253
9 Air Condenser with Shroud	No Longer Available
10 Air Condenser Only	No Longer Available
11 Bin Switch	† 2301119
12 Bin Switch Bracket	No Longer Available
13 Bin Switch Mylar Insulation	No Longer Available
14 Cable Clamp, Nylon	No Longer Available
15 Drier	† 8930279
16 Expansion Valve	† 7623983
17 Expansion Valve Stainless Steel Bulb Clamp	† 5650529
18 Fan Blade for Motors ESPOL50EM2 & ESPOL50EM28	No Longer Available
Fan Blade for Motor K33HXCEJ948	2416173

**Air-cooled**

	<b>PART NO.</b>
19 Fan Cycle Control	2301153
20 Fan Motor	† 7626383
21 Hold Down Bracket	No Longer Available
22 Hot Gas Solenoid Valve Assembly	7630101
23 Hot Gas Solenoid Valve Coil Only Alco	† 2404483
24 Run Capacitor Bracket	No Longer Available
25 Start Capacitor Bracket	No Longer Available
26 Tubing, Polyflow 1/4"	4420291
27 Tubing, 1/2" ID	† 4420333
28 Siphon Tube Assembly	No Longer Available
29 Water Tee Break	7621553
30 Water Dump Solenoid Coil Only (Eaton Dole)	No Longer Available
30a Water Dump Solenoid (Alco)	000001768
31 Dump Solenoid Diaphragm Only (Eaton Dole)	2404683
32 Wire Motor Mount	No Longer Available
33 Air Baffle	No Longer Available

**NOTE:** FOR 50 CYCLE PARTS, SEE PAGE 8

† Refer to Cross Reference Guide

# G0600 WATER-COOLED

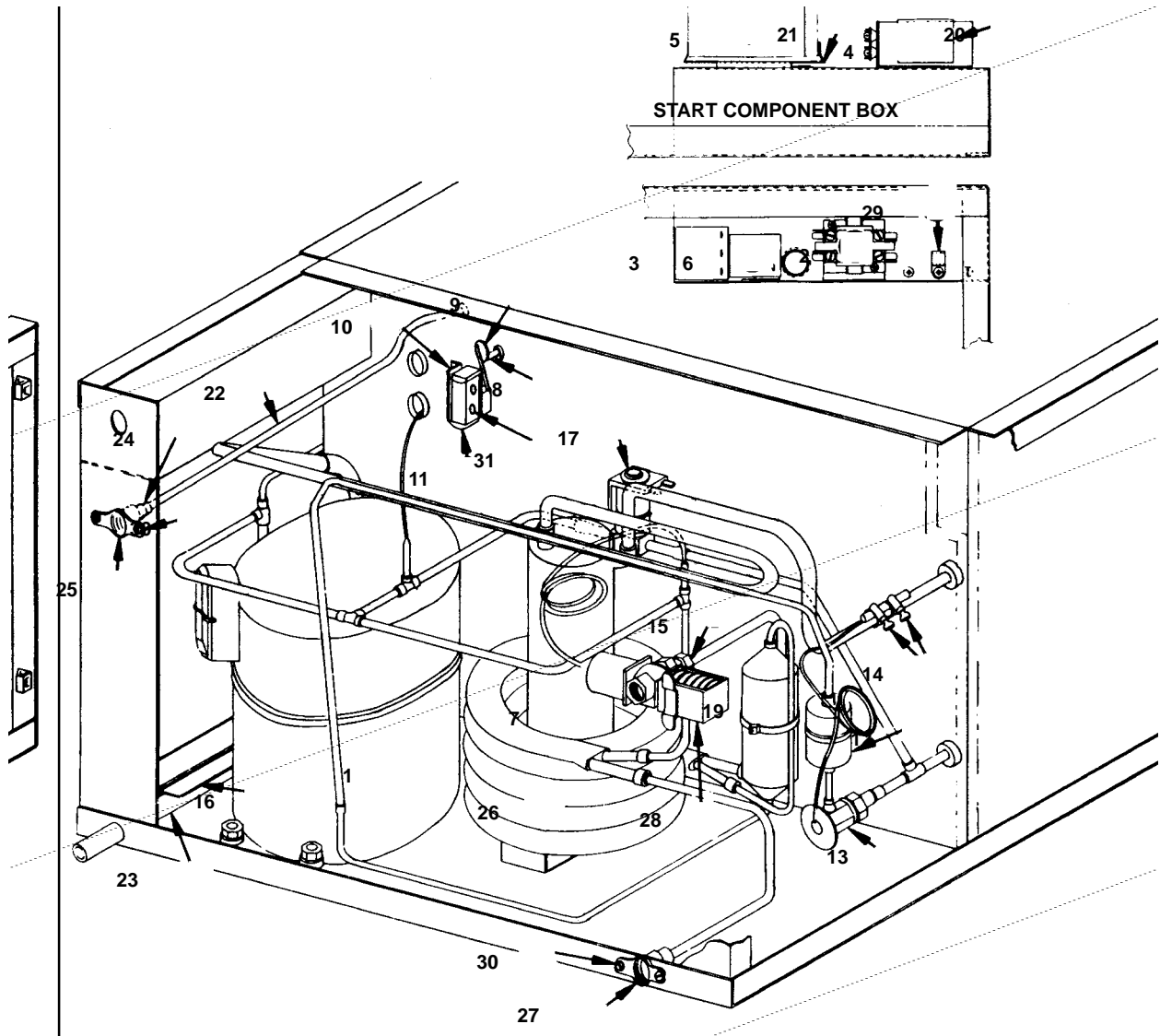

1224

**Water-cooled**

	PART NO.
1 Compressor Assembly 60 Hz 220V .....	No Longer Available
2 Contactor .....	No Longer Available
3 Delay Timer (Air and water) .....	† 2406353
4 Run Capacitor .....	See Page 9
5 Start Capacitor .....	See Page 9
6 Start Relay .....	See Page 9
7 Accumulator .....	No Longer Available
8 Activating Pin Assembly .....	7620253
9 Bin Switch .....	† 2301119
10 Bin Switch Bracket .....	No Longer Available
11 Bin Switch Mylar Insulation .....	No Longer Available
12 Drier .....	† 8930279
13 Expansion Valve .....	† 7623983
14 Expansion Valve Stainless Steel Bulb Clamp .....	† 5650529
15 Half Union Coupling .....	8332023
16 Hold Down Bracket .....	No Longer Available

**PART NO.**

**Water-cooled**

	PART NO.
17 Hot Gas Solenoid Valve Assembly . . .	7630101
18 Hot Gas Solenoid Valve Coil Only Alco	† 2404483
19 Receiver .....	000008892
20 Run Capacitor Bracket .....	No Longer Available
21 Start Capacitor Bracket .....	No Longer Available
22 Tubing, Polyflow 1/4" .....	4420291
23 Tubing, 1/2" ID .....	† 4420333
24 Union .....	1360961
25 Water Adapter .....	6002421
26 Water Condenser .....	† 8865333
27 Water Condenser Outlet Adapter . . .	8706103
28 Water Regulator .....	8372063
29 Cable Clamp, Nylon .....	No Longer Available
30 Screw, 024 Slot Head .....	† 5202069
31 Screw, 6-32 x 1" SHMS .....	No Longer Available
32 Hex Nut for Item 31 .....	No Longer Available

**NOTE:** FOR 50 CYCLE PARTS, SEE PAGE 8

† Refer to Cross Reference Guide

# G0600 REMOTE

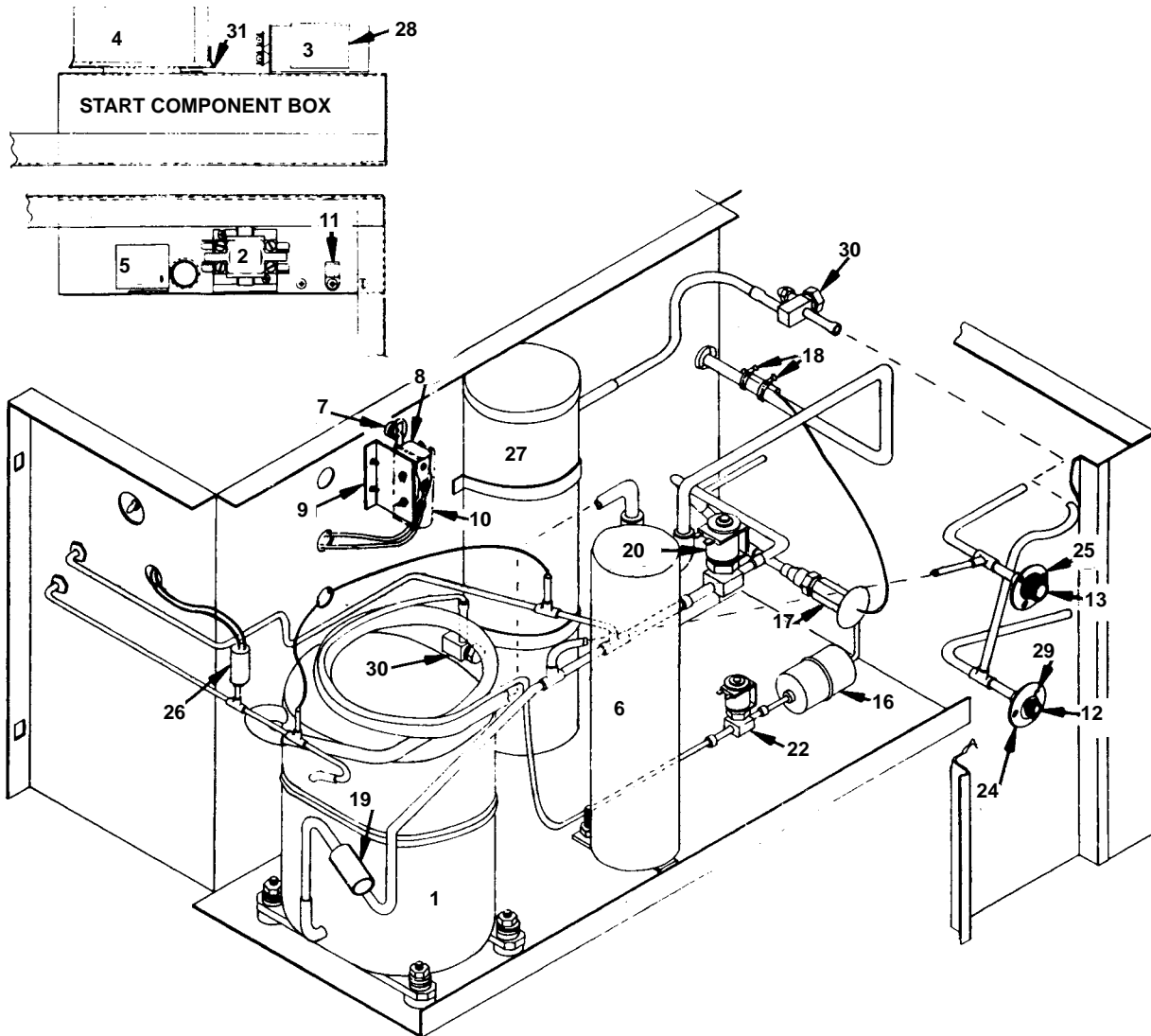

1225

## REMOTE SYSTEM

### COMPRESSOR COMPARTMENT

	PART NO.
1 Compressor Assembly 60 Hz 220V	No Longer Available
2 Contactor	No Longer Available
3 Run Capacitor	See Page 9
4 Start Capacitor	See Page 9
5 Start Relay	See Page 9
6 Accumulator	No Longer Available
7 Activating Pin Assembly	7620253
8 Bin Switch	† 2301119
9 Bin Switch Bracket	No Longer Available
10 Bin Switch Mylar Insulation	No Longer Available
11 Cable Clamp, Nylon	No Longer Available
12 Coupling 1-1/8" - 12 THD	† 8360353
13 Coupling 1-7/16" - 16 THD	No Longer Available
14 Coupling "0" Ring for 8360223	† 8360229
15 Coupling "0" Ring	† 8360239
16 Drier	† 8930279
17 Expansion Valve	† 7623983
18 Expansion Valve Stainless Steel Bulb Clamp	† 5650529
19 Heater (On discharge line)	No Longer Available

	PART NO.
20 Hot Gas Solenoid Valve Assembly	7630101
21 Hot Gas Solenoid Valve Coil Only Alco	† 2404483
22 Liquid Line Pump Down Valve Assembly 208-230V/50-60 Hz (Danfoss)	† 7630081
23 Liquid Line Pump Down Valve Coil Only Alco	† 2404483
24 Mounting Flange 1/2"	8360183
25 Mounting Flange 3/4"	8360173
26 Pressure Limiter Switch	No Longer Available
27 Receiver	† 7629583
27a Fusible Receiver Plug	No Longer Available
28 Run Capacitor Bracket	No Longer Available
29 Screw, 10-24 x 1/2" TC	† 5202069
30 Service Valve for Receiver	† 8373169
31 Start Capacitor Bracket	No Longer Available

### PARTS LOCATED IN REMOTE CONDENSER

Fan Motor	† 7619843
Head Pressure Control	† 8368069
Female Coupling Kit	0700663

**NOTE:** FOR 50 CYCLE PARTS, SEE PAGE 8

† Refer to Cross Reference Guide

**G0600 REMOTE  
AFTER SN 880961220**

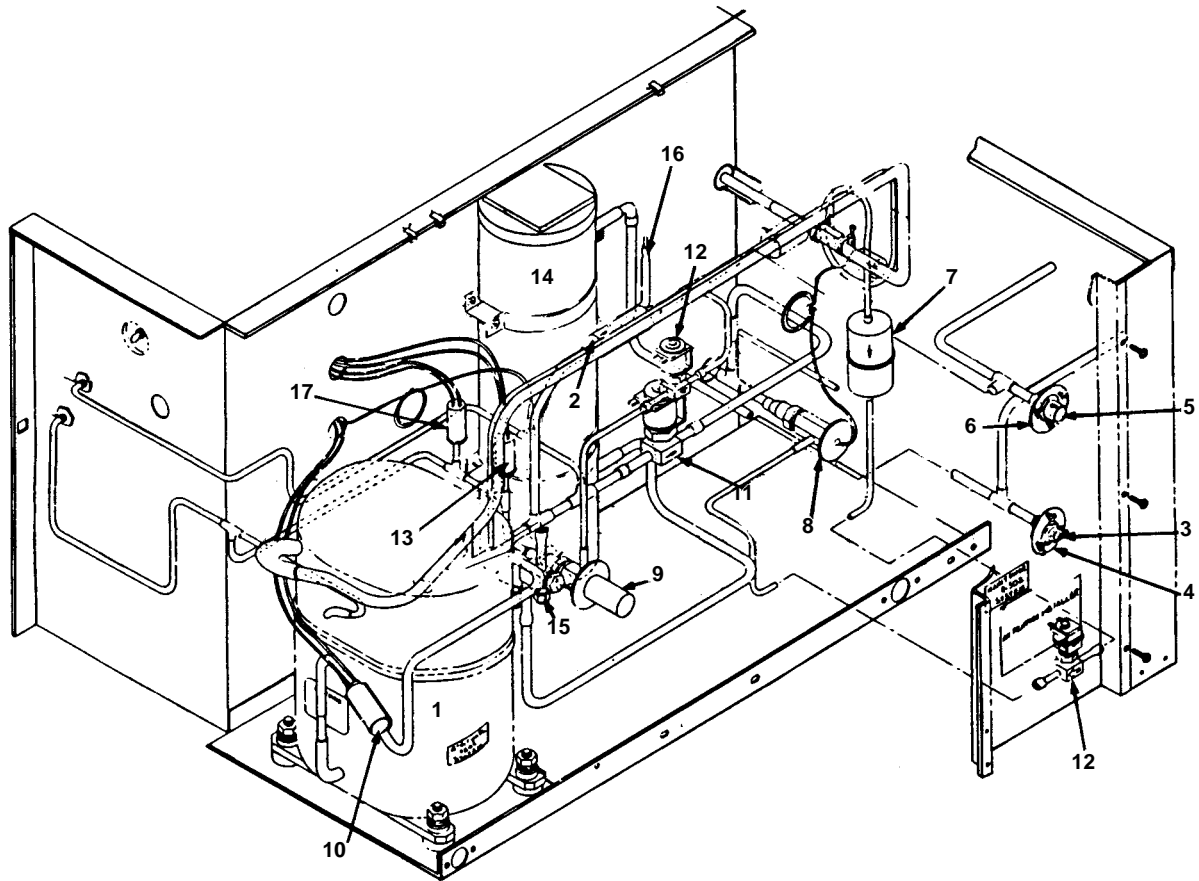

1226

	<b>PART NO.</b>
1 Compressor 60 Hz .....	No Longer Available
2 Check Valve .....	† 8373149
3 Coupling 3/8 OD .....	† 8360353
4 Flange .....	8360183
5 Coupling 1/2 OD .....	No Longer Available
6 Flange .....	8360173
7 Drier .....	† 8930279
8 Expansion Valve .....	† 7623983
9 HPR Valve .....	8367313
10 Heater .....	No Longer Available
11 Hot Gas Solenoid Valve .....	7630101
12 Solenoid Valve 208-230V/50-60 Hz (Danfoss) (Liquid line or harvest assist) .....	† 7630081
13 Low Pressure Control .....	2355273
14 Receiver .....	† 7629583
15 Receiver Service Valve .....	† 8373169
16 Receiver Safety Plug .....	No Longer Available
17 Suction Pressure Limiter Switch (HPL Safety) .....	No Longer Available

† Refer to Cross Reference Guide

# G0600 OUTER PANELS

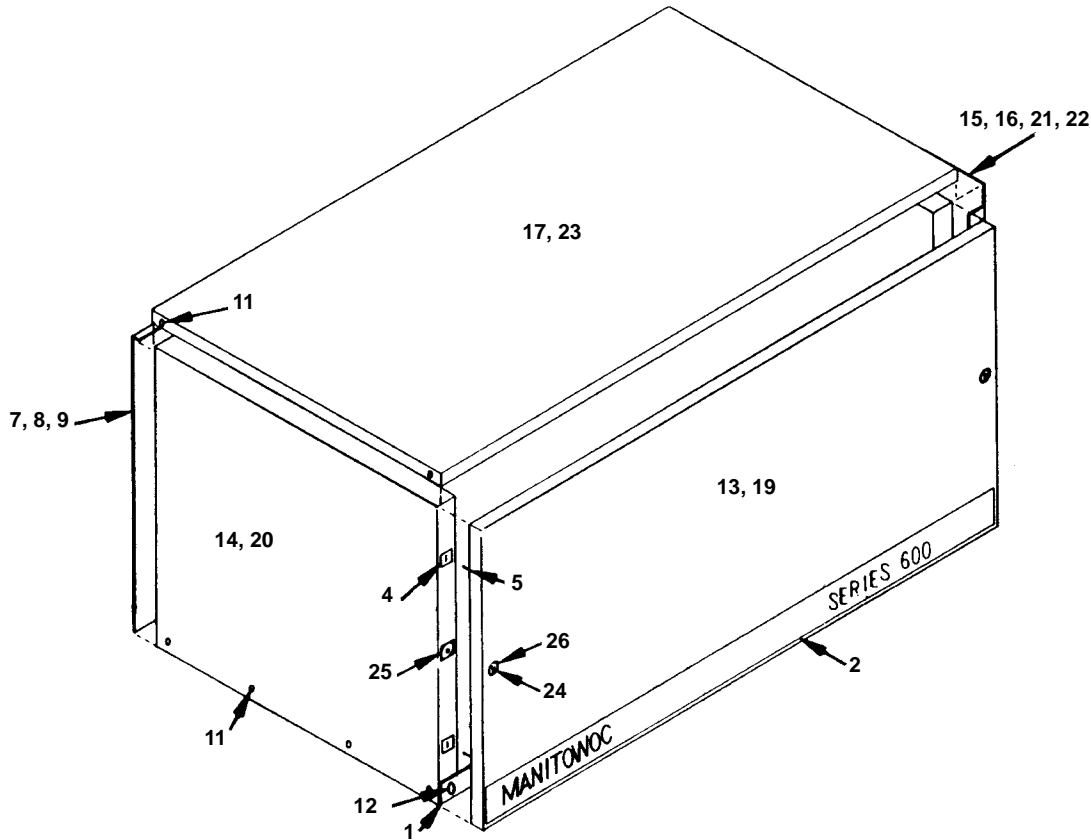

1227

## COMMON PARTS

	PART NO.
1 Front Support Angle . . . . .	† 6580419
2 Front Panel Trim . . . . .	† 8134873
3 Front Panel Seal . . . . .	† 9202509
4 Front Panel Catch Only (Pkg. of 12)	No Longer Available
5 Front Panel Strike Only (Pkg. of 25)	No Longer Available
6 Front Panel Strike-Catch (Pkg. of 4 each) . . . . .	No Longer Available
7 Rear Panel (Air-cooled) . . . . .	No Longer Available
8 Rear Panel (Water-cooled) . . . . .	No Longer Available
9 Rear Panel (Remote) . . . . .	No Longer Available
10 #10-24 Phillips Head Screw (Mounting control box cover) (Pkg. of 12) . . . . .	† 5202059
11 #10-24 Slot Head Screw (Mounting outer panels) (Pkg. of 12) . . . . .	† 5202069
12 #10-24 Phillips Head Screw (Mounting front angle support) (Pkg. of 12) . . . . .	† 5202099

## OUTER PANELS — FAWN

	PART NO.
13 Front Panel . . . . .	No Longer Available
14 LH End Panel . . . . .	No Longer Available
15 RH End Panel (Remote) . . . . .	No Longer Available
16 RH End Panel (Air and water) . . . . .	No Longer Available
17 Top Cover . . . . .	No Longer Available
18 Fawn Touch Up Paint . . . . .	9400931

## OUTER PANELS — STAINLESS STEEL

	PART NO.
19 Front Panel . . . . .	No Longer Available
20 LH End Panel . . . . .	No Longer Available
21 RH End Panel (Remote) . . . . .	No Longer Available
22 RH End Panel (Air/Water) . . . . .	No Longer Available
23 Top Cover . . . . .	No Longer Available
24 Fastener Screw (Pkg. of 12) . . . . .	† 5026689
25 Nut Cage (Pkg. of 12) . . . . .	† 5429109
26 Hole Plug (Pkg. of 10) . . . . .	No Longer Available
27 Spacer for Front Panel Screw . . . . .	† 3718199

## 50 HZ MODELS ONLY

Use same parts as previously listed for standard G0600 except for the following:

Unitized Control Board . . . . .	No Longer Available
Compressor Assembly . . . . .	No Longer Available
<b>Compressor Start Components (See Page 9)</b>	
Remote Fan Motor (Located in remote condenser) . . . . .	No Longer Available
Water Pump . . . . .	† 7626013

† Refer to Cross Reference Guide



## COMPRESSOR COMPONENTS FOR G0600

### 230V/60 HZ/1 PH

Compressor Model Number	Start Relay	Start Capacitor	Run Capacitor
Tecumseh. . . . .	† 2007993	† 8503143	† 8503423
Bristol M52123BBCB. . . . .	No Longer Available	85037033	† 8503413
Bristol M53B982BBCB. . . . .	2007579	8503143	2010143
Copeland RS86CIEPFV218. . . . .	2007539	8503723	2010143
Copeland RS86CIEPFV251. . . . .	2007539	8503723	8503933
Copeland CS08KQEFPV255. . . . .	2007559	† 8503853	8503933

### 230V/50 HZ /1 PH

Compressor Model Number	Start Relay	Start Capacitor	Run Capacitor
Tecumseh. . . . .	No Longer Available	† 8503143	† 8503423
Bristol. . . . .	No Longer Available	8503143	8503933
Copeland RS86CIEPFJ251. . . . .	2007559	8505593	2010143
Copeland CS08KQEFP2255. . . . .	2007559	† 8503853	8503933

† Refer to Cross Reference Guide

# REMOTE CONDENSER AC0895

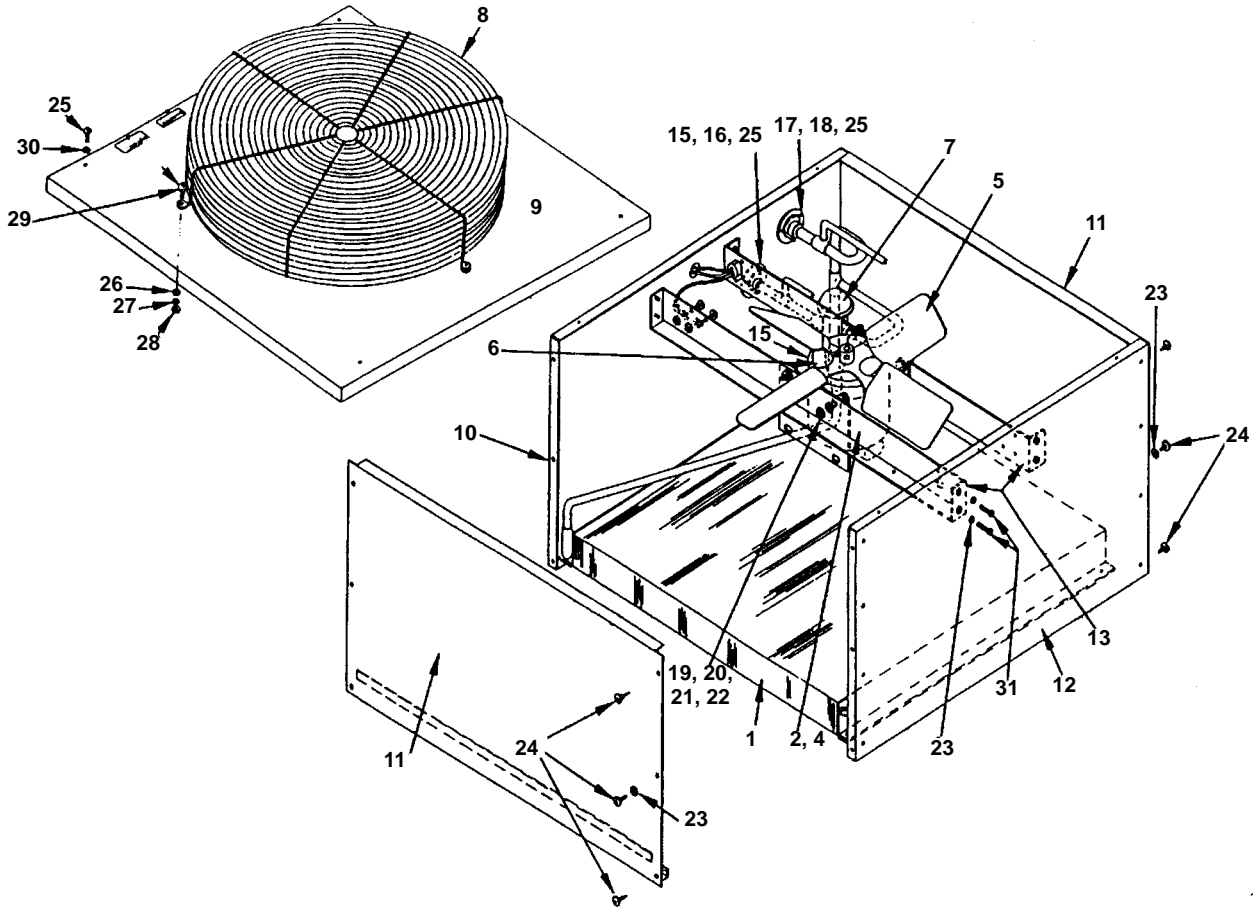

1228

PART NO.		PART NO.	
1	Air Condenser . . . . . † 8850629	17	Coupling Mounting Flange . . . . . 8360173
2	Fan Motor 60 Hz 230V* . . . . . † 7629413	18	Coupling Assembly 1/2 OD . . . . . No Longer Available
3	Run Capacitor (Emerson)* . . . . . 8503353	19	Lockwasher 5/16 Split . . . . . † 5573139
3a	Run Capacitor (Magnatec) . . . . . No Longer Available	20	Flatwasher . . . . . † 5573099
4	Fan Blade* . . . . . 2416113	21	Hex Nut 5/16-18 . . . . . † 5429759
5	Fan Motor 50 Hz 230V* . . . . . † 7629413	22	Screw 5/16-18 Hex Head . . . . . † 5035659
6	Rain Shield* . . . . . 2415053	23	Lockwasher #8 . . . . . † 5544599
7	Head Pressure Control . . . . . † 8368069	24	Screw 8-1/2 . . . . . † 5121539
8	Fan Grill . . . . . 3400643	25	Screw, 10-24 x 5/8 . . . . . † 5202059
9	Top Cover . . . . . † 6017751	26	Hex Nut 1/4-20 . . . . . † 5429529
10	Rear Panel . . . . . No Longer Available	27	Flatwasher 1/4" . . . . . † 5573049
11	Panel, Right and Left End . . . . . No Longer Available	28	Lockwasher 1/4" Split . . . . . † 5545119
12	Front Panel . . . . . † 6017721	29	Screw 1/2-20 x 5/8 . . . . . † 5033459
13	Bracket, Fan Motor & Base . . . . . † 6017681	30	Lockwasher #10 . . . . . † 5544649
14	Legs (Condenser mounting) . . . . . † 6017691	31	Screw, 8-32 x 1/2 . . . . . † 5026249
15	Coupling Mounting Flange . . . . . 8360183	32	Female Coupling Kit . . . . . 0700663
16	Coupling Assembly 3/8 OD . . . . . No Longer Available		

\*Early models used a single bracket to mount the fan motor. Those units use the following parts:

Fan Motor 60 Hz 230V . . . . .	† 7619843
Fan Motor 50 Hz 230V . . . . .	No Longer Available
Rain Shield . . . . .	No Longer Available
Fan Blade . . . . .	No Longer Available
Run Capacitor . . . . .	No Longer Available

† Refer to Cross Reference Guide

## REMOTE CONDENSER DC0896

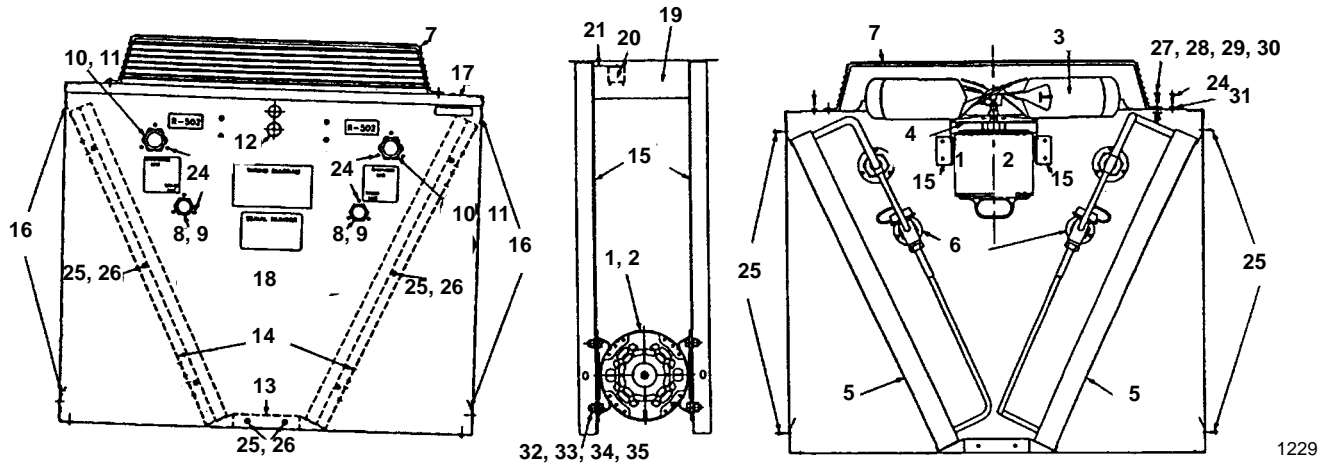

1229

	<b>PART NO.</b>
1 Fan Motor 115V/60 Hz . . . . .	† 7629423
2 Fan Motor 230V/50-60 Hz . . . . .	† 7629413
3 Fan Blade . . . . .	2416113
4 Rain Slinger . . . . .	2415053
5 Air Condenser DC0896A (Uses 2) . . . . .	† 8850629
6 Headmaster Control - R502 . . . . .	† 8368069
7 Fan Guard . . . . .	3400643
8 Male Coupling, 1-1/8 x 3/8 OD . . . . .	No Longer Available
9 Coupling Flange for Male Coupling, 1-1/8" x 3/8 OD . . . . .	8360183
10 Male Coupling, 1-7/16 - 16 x 1/2 OD . . . . .	No Longer Available
11 Coupling Flange . . . . .	8360173
12 Hole Plug for 7/8" Hole . . . . .	4301463
13 Base . . . . .	6017791
14 Condenser Mounting Angle . . . . .	6017771
15 Base Bracket for Fan Mounting . . . . .	† 6017681
16 Support Bracket . . . . .	† 6017781
17 Top Cover . . . . .	6017891
18 Front Panel . . . . .	No Longer Available
19 Electrical Box Cover . . . . .	† 6017761
20 Relay . . . . .	No Longer Available
21 Relay Mounting Bracket . . . . .	No Longer Available
22 Transformer (Not shown) . . . . .	No Longer Available
23 Electrical Junction Box (Not shown) . . . . .	2515013
24 Screw, #10-24 x 0.62 . . . . .	† 5202059
25 Screw, #8 x 0.50 . . . . .	† 5121539
26 Lockwasher, #8 . . . . .	† 5544599
27 Screw, 0.25 x 0.62 . . . . .	† 5033459
28 Lockwasher 0.25 Split SS . . . . .	† 5545119
29 Washer - Flat 0.25 SS . . . . .	† 5573049
30 Nut 0.25-20 Steel Hex . . . . .	† 5429529
31 Lockwasher #10 . . . . .	† 5544649
32 Screw, 0.31-18 x 0.62 Hex Head . . . . .	† 5035659
33 Nut 0.31-18 Steel Hex Head . . . . .	† 5429759
34 Washer, Flat 0.31 ID . . . . .	† 5573099
35 Lockwasher 0.31 Split Zinc . . . . .	† 5573139
36 Back Panel (Not shown) . . . . .	† 6017881

**NOTE:** Items 20, 21, 22 and 23 are used only when the optional K00095 Relay/Transformer Kit has been installed.

† Refer to Cross Reference Guide

**INTENTIONALLY LEFT BLANK**