



Ice Machine Parts List for H0200 Series Cuber Models

HR0200A

HD0203W

HD0202A

HY0205W

HY0204A

R12 System

HR0201W

March 1987 through January 1991

H0200

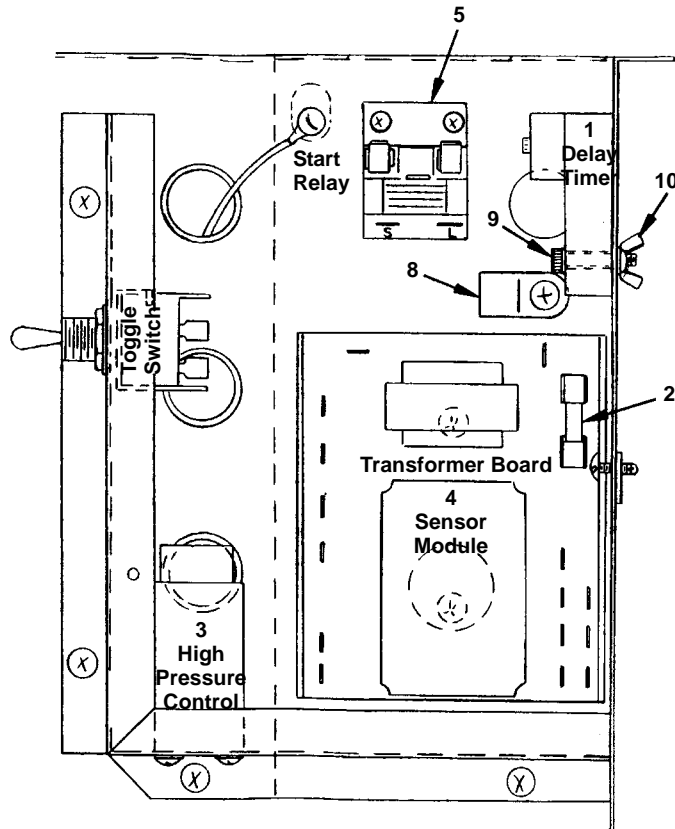

1181

CONTROL BOX ASSEMBLY

PART NO.

1	Delay Timer	† 2406423
2	Fuse	† 2510379
3	High Pressure Control	† 2355011
4	Sensor Module	Replace w/† 7623763
5	Start Relay 115V/60 Hz*	8503743
6	Toggle Switch	† 2300849
7	Transformer Board 115V*	Replace w/† 7623763
8	Plastic Clamp	No Longer Available
9	Nylon Thumbscrew	No Longer Available
10	Wing Nut	† 5489139

Unitized sensor board can be used to replace both the transformer board and sensor module † 7623763

*For 220V 60 Hz and 230V/50 Hz Parts See Page 6

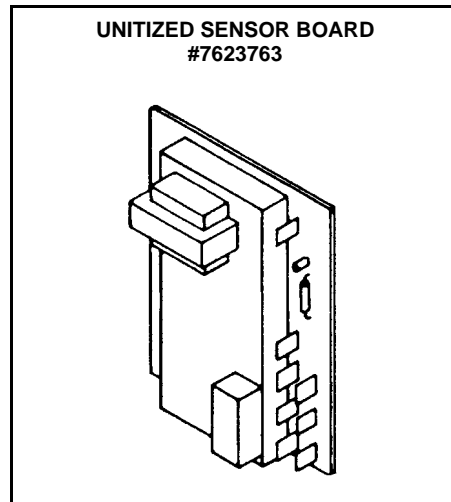

1181a

H0200, CONTINUED

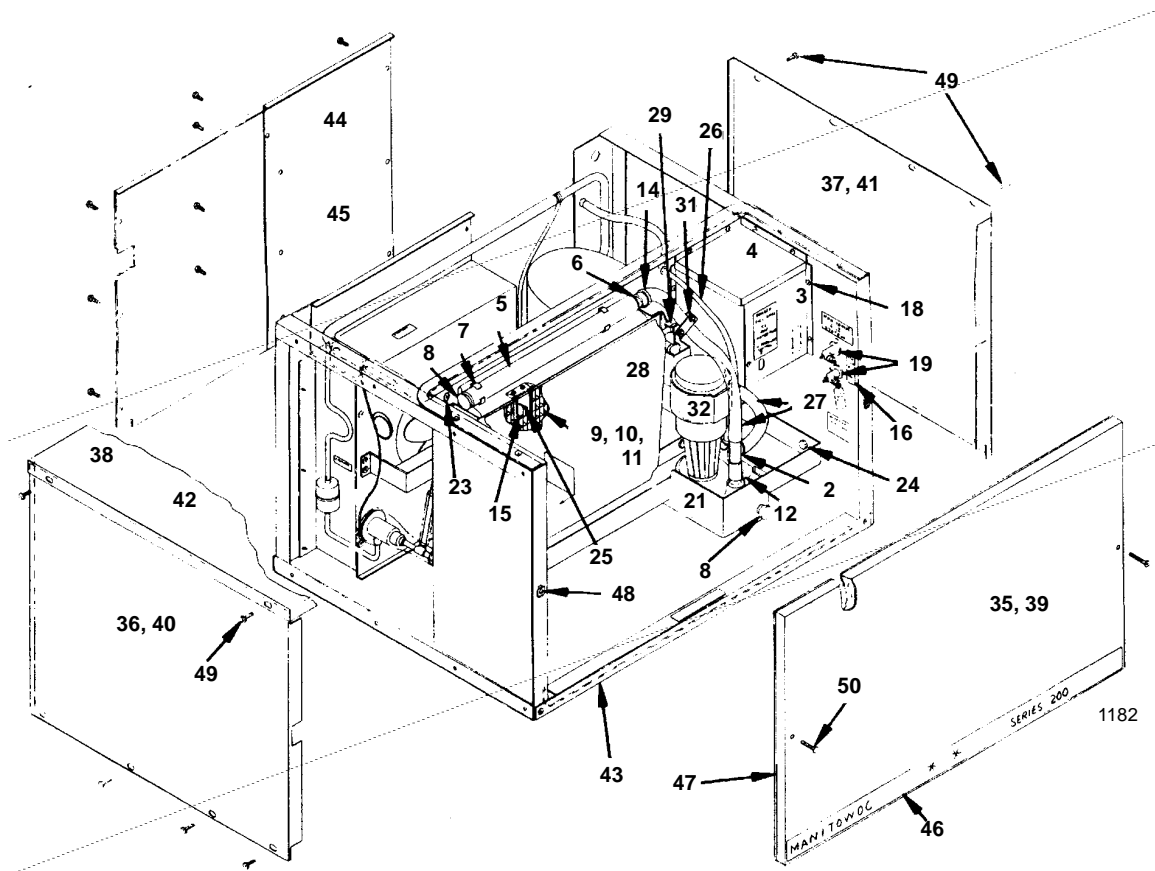

WATER DISTRIBUTION GROUP & OUTER PANELS

	PART NO.
1	Activating Pin Assembly 7620253
2	Barbed Tee No Longer Available
3	Control Box Front Cover No Longer Available
4	Control Box Top Cover No Longer Available
5	Distribution Tube Assembly No Longer Available
6	Distribution Tube Seal † 4408219
7	Distribution Tube Spring Clip No Longer Available
8	End Plug † 4300529
9	Evaporator Assembly, Dice Cube No Longer Available
10	Evaporator Assembly, Half Dice Cube No Longer Available
11	Evaporator, Reg. Cube No Longer Available
12	Float Valve Assembly † 8369049
13	Float Valve Bracket No Longer Available
14	Hose Clamp † 5650649
15	Ice Thickness Control † 7619963
16	Label - Service Valves † 8131473
17	Nylon Nut † 5429459
18	Screw 10-24 Phillips Head † 5202059
19	Service Valves † 8373109
20	Service Valve Cover (Not shown) No Longer Available
21	Pump Trough No Longer Available
22	Support Pin † 4302019
23	Terminal Bushing No Longer Available
24	Thumbscrew † 5305049
25	Thumbscrew, Ice Control No Longer Available
26	Tubing, 1/4" Polyflow 4420291
27	Tygon Tubing, 1/2" ID x 3/4" OD † 4420333
28	Water Curtain † 7620393

	PART NO.
29	Water Curtain Hangers † 5650459
30	Water Curtain Bracket † 7621773
31	Water Flow Clamp Assembly 7620543
32	Water Pump 60 Hz 115V* † 7623063
33	Water Pump 60 Hz 220V † 7626013
34	Water Pump Bracket No Longer Available

OUTER PANELS — FAWN

35	Front Panel - Textured Fawn No Longer Available
36	Left Hand End Panel No Longer Available
37	Right Hand End Panel No Longer Available
38	Top Cover No Longer Available

OUTER PANELS — STAINLESS STEEL

39	Front Panel No Longer Available
40	Left Hand End Panel No Longer Available
41	Right Hand End Panel No Longer Available
42	Top Cover No Longer Available

COMMON PARTS

43	Front Angle Support † 6580419
44	Rear Panel - Air-cooled No Longer Available
45	Rear Panel - Water-cooled No Longer Available
46	Front Panel Trim † 8134863
47	Front Panel Seal 98" Long † 9202509
48	Cage Nut & Screw (2 each) 7622263
49	Slot Head 10-24 Screw † 5202069
50	Phillips Head 10-24 Screw † 5026689
51	Spacer For Front Panel Screw † 3718199
	Complete Cartoning † 7108609

*For 220V 60 Hz and 230V/50 Hz Parts See Page 6

† Refer to Cross Reference Guide

H0200 COMPRESSOR COMPARTMENT

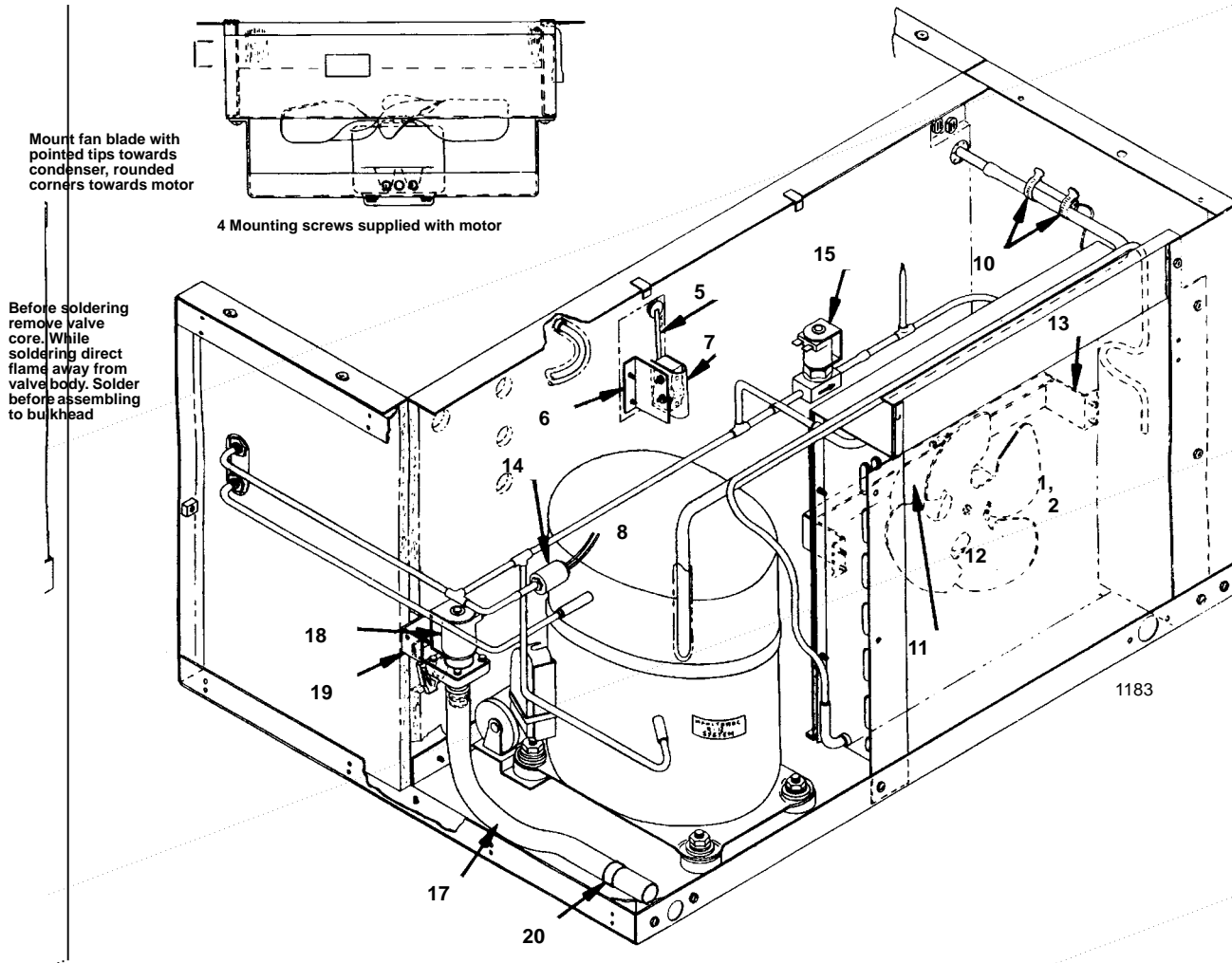

Air-cooled

	PART NO.
1 Air Condenser Only	No Longer Available
2 Shroud Assembly	No Longer Available
3 Air Baffle, Fawn	No Longer Available
4 Air Baffle, Stainless Steel . . .	No Longer Available
5 Bin Switch	† 2301119
6 Bin Switch Mounting Bracket	No Longer Available
7 Bin Switch Mylar Insulation . . .	No Longer Available
8 Compressor 115V/60 Hz*	No Longer Available
9 Expansion Valve — R12	† 7620623
9 Expansion Valve — MP39	No Longer Available
10 Expansion Valve Stainless Steel Bulb Clamp	† 5650529
11 Fan Motor 115V/60 Hz*	No Longer Available
12 Fan Blade	2400151
13 Fan Bracket	No Longer Available
14 Fan Cycling Control	† 2301123

Air-cooled Continued

	PART NO.
15 Hot Gas Solenoid 115V/60 Hz* (Danfoss)	† 7630021
16 Start Capacitor for Tecumseh*	8503713
16 Start Capacitor for Copeland	8505133
17 Tubing, Vinyl	† 4420333
18 Dump Solenoid Coil Only (Eaton-Dole)	No Longer Available
18 Dump Solenoid Diaphragm Only (Eaton-Dole)	2404683
18 Dump Solenoid	00001767
19 Dump Solenoid Mounting Bracket	6260314
20 Hose Clamp	† 5650609
21 Compressor Overload for Tecumseh	No Longer Available
21 Compressor Overload for Copeland	505463

*For 220V 60 Hz and 230V/50 Hz Parts See Page 6

† Refer to Cross Reference Guide

H0200 COMPRESSOR COMPARTMENT WATER-COOLED

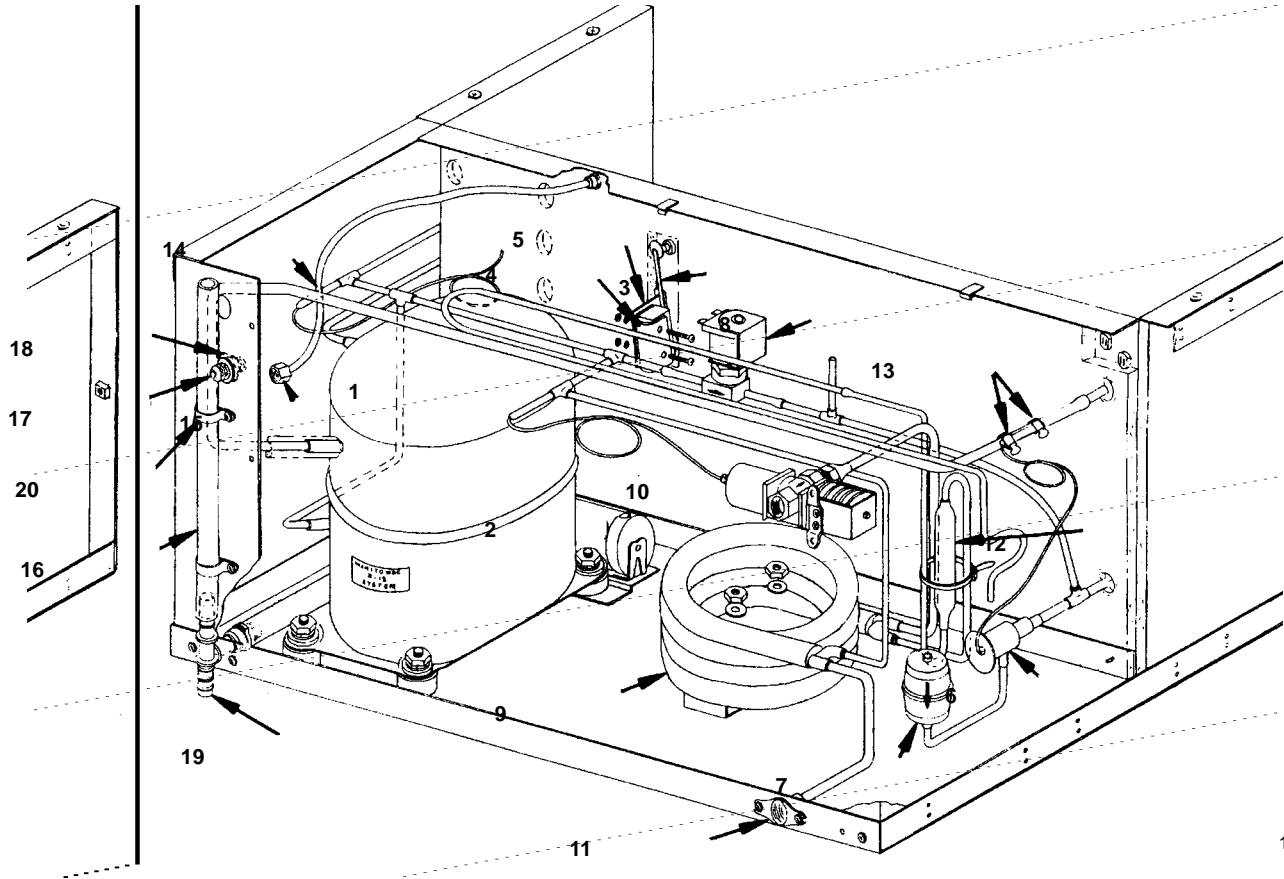

1184

	PART NO.
1 Compressor*	No Longer Available
Overload for Tecumseh	No Longer Available
Overload for Copeland	No Longer Available
2 Start Capacitor for Tecumseh*	8503713
2 Start Capacitor for Copeland	8505133
3 Bin Switch	† 2301119
4 Bin Switch Mylar Insulation	No Longer Available
5 Bin Switch Mounting Bracket	No Longer Available
6 Expansion Valve - R12	† 7620623
6 Expansion Valve - MP39	No Longer Available
7 Drier	† 8930259
8 Hot Gas Solenoid 115V/60 Hz* (Danfoss)	† 7630021
9 Water-cooled Condenser	No Longer Available
10 Water Regulating Valve	† 8372069
11 Water Adapter	8706103
12 Receiver	000008892
13 Worm Drive Stainless Steel Clamp	† 5650529
14 Tubing 1/4" OD	4420291
15 Nut, Celcon	5050729
16 Tubing, 1/2" ID x 3/4" OD	† 4420333
17 Water Inlet Fitting, Male Style, Used only up to SN 880260700	No Longer Available
17 Water Inlet Fitting, Female Type, Used after SN 880260700	6002421
17 Polyflow Union for Female Inlet	1360961
18 Locknut	† 5475039
19 Barbed Tee, Used only up to SN 880260700	No Longer Available
20 Drain Fitting, Used after SN 880260700	1706021
21 Flat Washer	† 5504279

*For 220V 60 Hz and 230V/50 Hz Parts See Page 6

† Refer to Cross Reference Guide

H0200

230V/50 HZ PARTS

	PART NO.
Water Pump	† 7626013
Dump Valve 208-230V	000001768
Fan Motor	No Longer Available
Hot Gas Solenoid 208-230V/50-60V (Danfoss)	† 7630081
Delay Timer	† 2406423
Unitized Sensor Board	No Longer Available
Compressor	No Longer Available
Start Relay for Tecumseh	No Longer Available
Start Relay for Copeland	No Longer Available
Start Capacitor for Tecumseh	No Longer Available
Start Capacitor for Copeland	No Longer Available
Overload for Copeland	No Longer Available

Remaining Parts Are Same As Used on 60 Hz Cuber.

220V 60 HZ PARTS

Water Pump	† 7626013
Dump Valve 208-230V	000001768
Fan Motor	2412333
Hot Gas Solenoid 208-230V/50-60V (Danfoss)	† 7630081
Delay Timer	† 2406423
Unitized Sensor Board	† 7623753
Compressor	† 7621393
Start Relay	No Longer Available
Start Capacitor	8503723

Remaining Parts Are Same As Used on 60 Hz Cuber.