



**ISO 9001 : 2000 REGISTERED**

90 INDUSTRIAL PARK ROAD, SACO, ME/U.S.A. 04072  
(207) 282-1589 800-225-3958 FAX (207) 282-6283

OPERATORS MANUAL  
HOLMAN CHEESE MELTERS  
MODELS F24, F36, F40 & F24W, F36W, F40W  
(For Service Information Call: 800-225-3958)

TABLE OF CONTENTS

|                          |            |
|--------------------------|------------|
| UNCRATING AND INSPECTION | PAGE 1     |
| ASSEMBLY & INSTALLATION  | PAGE 1, 2  |
| ELECTRICAL INSTALLATION  | PAGE 3     |
| OVEN OPERATION           | PAGE 3     |
| CLEANING (DAILY)         | PAGE 3     |
| TROUBLE SHOOTING GUIDE   | PAGE 4 & 5 |
| MAINTENANCE PROCEDURES   | PAGE 5, 6  |
| PARTS LIST               | PAGE 7     |

DRAWINGS

|                          |        |
|--------------------------|--------|
| HEATER TUBE INSTALLATION | PAGE 2 |
| LEFT SIDE EXPLODED VIEW  | PAGE 6 |

WIRING DIAGRAMS

|                        |        |
|------------------------|--------|
| F24(W), F36(W), F40(W) | PAGE 8 |
|------------------------|--------|

OPERATORS MANUAL  
HOLMAN CHEESE MELTERS  
MODELS F24, F36, F40 & F24W, F36W, F40W

### **UNCRATING AND INSPECTION**

Unpack unit and components from container. Remove all visible packing material and inspect unit for damage. If damage is discovered, file a claim immediately with the carrier that handled the shipment.

### **ASSEMBLY AND INSTALLATION**

**A. Counter Mounting (models F24, F36, F40):**

If the unit is to be installed on a counter, attach legs as shown below.

Anti-skid pads are available at no charge and may be adhered to the foot section of each leg to prevent sliding. Call 1-800-225-3958 for details.

(Caution: Use of these pads is not approved by the National Sanitation Foundation).

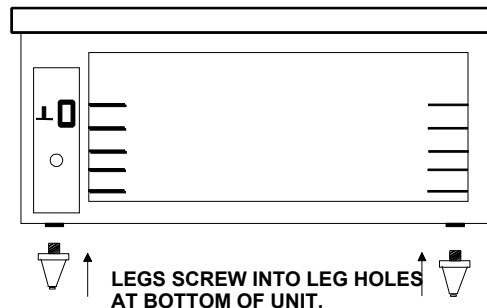

**B. Wall Mounting (models F24W, F36W, F40W):**

Mounting bolts (2 1/2" lag bolts) have been supplied with your Cheese Melter. At the back of the Cheese Melter there are either two (F24) or three (F36) 5/8" holes which are plugged with nickel plated Button Plugs. These holes are on 16" centers and large enough so that the head of the Lag Bolt will slip inside the hole.

Screw the Lag Bolt into wall studs on 16" centers and level. Screw heads should be 1/8" away from the wall as shown below.

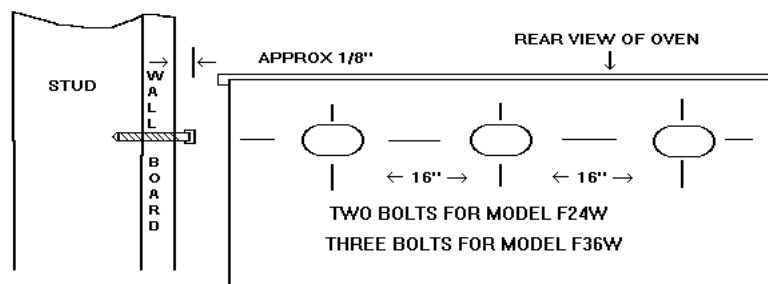

Using a flat tipped screw driver, the Button Plugs can be removed from the holes at the top rear of the unit. Unit may now be hung from wall by inserting the bolt heads into the mounting holes in the unit.

**ASSEMBLY AND INSTALLATION CONTINUED ON PAGE 2**

REVISED 3/30/00 MJC

OPERATORS MANUAL  
HOLMAN CHEESE MELTERS  
MODELS F24, F36, F40 & F24W, F36W, F40W

**ASSEMBLY AND INSTALLATION CON'T.**

C. Heater Tubes:

Models F24, F36, F40 and F24W, F36W, F40W use quartz sheathed Heater Tubes which are held in position by spring loaded Sockets which push on the end of the Heater Tubes. To install or remove a Heater Tube, grasp the end of the Heater Tube (**NEVER THE MIDDLE**), push one end of the Heater Tube into one of the spring loaded Sockets and insert or remove the other end of the Heater Tube into or out of the remaining Socket as shown below.

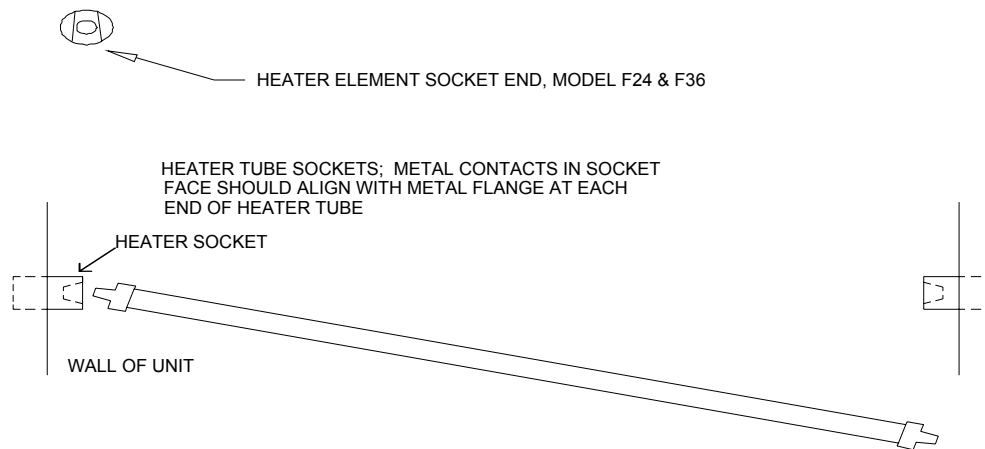

:  
The F24, F36, F40 and F24W, F36W, F40W heater tubes are clear quartz (like glass) and quite fragile. When removing them from the cardboard tubes it is very important that no bending pressures be applied or they will immediately snap in the middle.

**(EXTREME CAUTION SHOULD BE EXERCISED)**

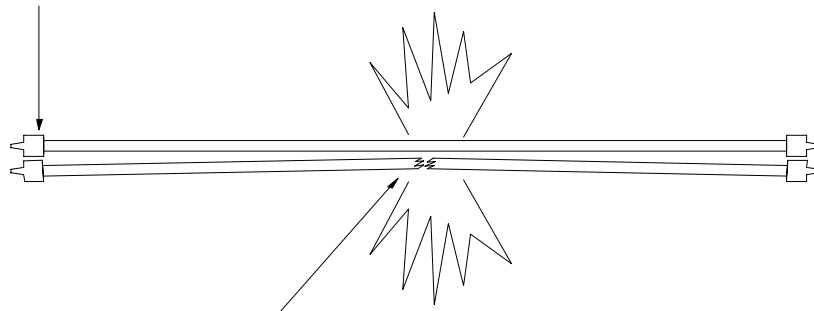

**TUBES ARE VERY FRAGILE**

OPERATORS MANUAL  
HOLMAN CHEESE MELTERS  
MODELS F24, F36, F40 & F24W, F36W, F40W

### **ELECTRICAL INSTALLATION**

**WARNING:** NEVER PLUG A 208 VOLT UNIT INTO 240 VOLTS OR A 240 VOLT UNIT INTO 208 VOLTS. CHECK WITH POWER COMPANY TO DETERMINE ACTUAL VOLTAGE AT THE JOB SITE BEFORE INSTALLING UNIT.

**WARNING:** BE ABSOLUTELY SURE THE GROUND CONNECTION FOR THE RECEPTACLE IS PROPERLY WIRED. NEVER CONNECT UNIT TO POWER WITHOUT PROPER GROUND CONNECTIONS. IMPROPER GROUND CONNECTION MAY RESULT IN SEVERE INJURY OR FATALITY.

Models F24, F36 and F40 are furnished with a 4 foot cord and standard NEMA 6-30 Plug for plug in installation in a grounded 208 or 240 Volt outlet. Models F24W, F36W and F40W are furnished with a 1 1/2 foot cord and NEMA 6-30 Plug. Your HOLMAN oven should be the only appliance connected to the electrical line and should have its own fuse or breaker in the electrical box.

### **OVEN OPERATION**

- A. Pre-heat:  
Put Power Saver Switch into the ON position and set front and rear heat controls to desired settings. Fan Motor will now run and Pilot Light turns on. Allow approximately five minutes for warm up time.
- B. Power Saver:  
Put power Switch into the off position. Pilot light is on and fan continues to run. Front two elements will now turn off while rear two elements continue to run. Unit is now in 1/2 power.
- C. Cooking:  
There are six shelf positions in your Holman Cheese Melter (2 in model F40) with temperatures that range from approximately 300 deg. (F) in the lowest position to approximately 600 deg. (F) in the highest position. Some experimentation between heat control settings and shelf position may be necessary to achieve desired cooking results.

### **CLEANING (DAILY)**

- A. Turn Power Saver to the OFF position. When oven has cooled;
  - 1. Remove shelf or rack. Clean with hot soapy water.
  - 2. Wipe interior and exterior surfaces with a damp cloth.

OPERATORS MANUAL  
HOLMAN CHEESE MELTERS  
MODELS F24, F36, F40 & F24W, F36W, F40W

**TROUBLE SHOOTING GUIDE**

**CAUTION - ALWAYS DISCONNECT UNIT FROM POWER SOURCE BEFORE SERVICING**

**A. UNIT WILL NOT HEAT, FAN MOTOR WORKS.**

1. Disconnect unit from power source and check if heaters are properly installed as shown on page 3.
2. Make sure Power Saver Switch is in the ON position.
3. Press Heat Limit Switch.(If this reactivates heaters, see HEAT LIMIT SWITCH section C ).

**B. UNIT WILL NOT HEAT, FAN WILL NOT WORK, PILOT LIGHT WILL NOT COME ON.**

1. Be sure main Circuit Breaker is switched to the ON position.
2. Check if oven is plugged in.
3. Make sure Power Saver Switch is in the ON position.
4. Call Holman Service Department at 1-800-225-3958 if further assistance is needed.

**C. HEAT LIMIT SWITCH**

Your Holman oven is equipped with an automatically activated temperature (Heat) Limit Switch which interrupts the Heater Tube connections if the air temperature in the Control Box exceeds 190 degrees (F), 87.8 degrees (C). This Heat Limit switch can be reset manually by pushing a button located on the bottom of the unit as shown below.

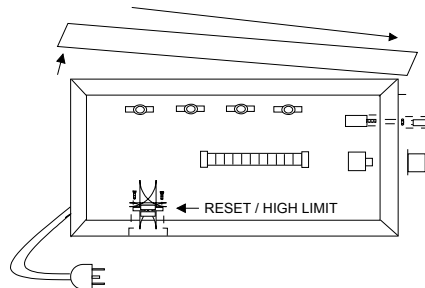

**THIS HEAT LIMIT SWITCH IS ACTIVATED WHEN THERE IS NOT A PROPER AMOUNT OF AIR FLOW BEING GENERATED BY THE COOLING FAN. IF THIS OCCURS:**

1. DISCONNECT UNIT FROM POWER SOURCE.
2. Check to see if the air intake area (louvers in left side panel) is free of dust, grease or other obstructions.

OPERATORS MANUAL  
 HOLMAN CHEESE MELTERS  
 MODELS F24, F36, F40 & F24W, F36W, F40W

HEAT LIMIT SWITCH CON'T.

3. If no obstruction to the Air Intake can be found, call the Holman Service Department for assistance at 1-800-225-3958.

D. NO HEAT IN POWER SAVER MODE

1. Disconnect unit from power source.
2. Check to make sure rear Heater Tubes are properly installed.
3. Call the Holman Factory Service Team for further assistance.

MAINTENANCE PROCEDURES

REPLACING HEATER TUBES

1. Disconnect unit from power source.
2. Gently, pull defective Heater Tube out of unit by pushing from left to right, then slowly guide Heater Tube out of unit.
3. Gently, put new Heater Tube into unit by placing tube end into Socket and pushing into the spring loaded Socket. Guide opposite end of Heater into the remaining Socket.

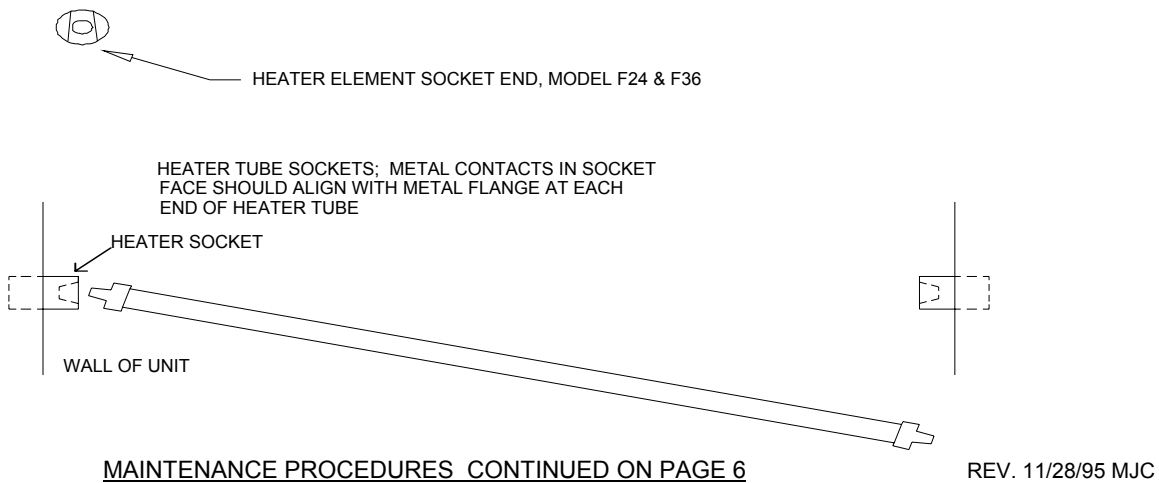

OPERATORS MANUAL  
 HOLMAN CHEESE MELTERS  
 MODELS F24, F36, F40 & F24W, F36W, F40W

MAINTENANCE PROCEDURES CONT.

B. REPLACING FAN MOTOR

1. Disconnect unit from power supply.
2. Remove Top Cover as shown below.
3. Carefully slide right Side Panel up and out away from unit. Fan Motor will be attached to Side Panel.
4. Disconnect motor lead from rear of Fan Motor.
5. Remove Fan Motor and Fan Grill from Side Panel by removing four Mounting Screws on Side Panel.
6. Attach new Fan Motor and Fan Grill to Side Panel with four Mounting Screws
7. Reconnect motor lead to rear of new Fan Motor.
8. Slide new Side Panel with new Fan Motor already attached onto side of unit.
9. Replace Top Cover.

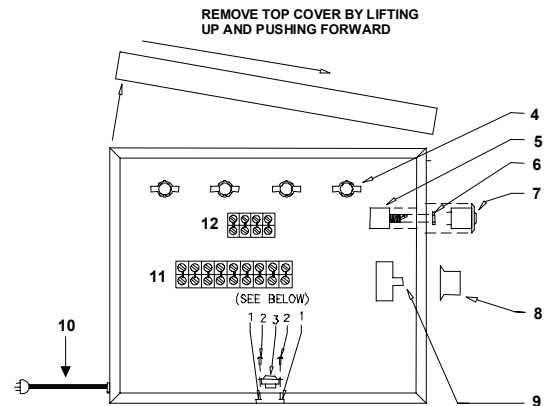
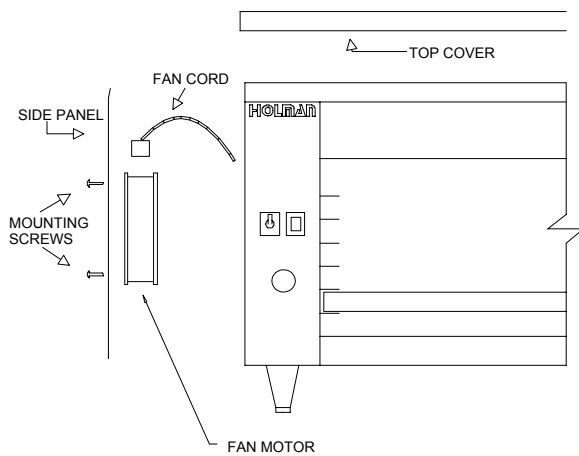

1. MOUNTING BRACKET 2. SCREW
3. RESET / HIGH LIMIT 4. HEATER SOCKET
5. ON / OFF SWITCH 6. TOGGLE NUT
7. PILOT LIGHT 8. KNOBS, INFINITE SWITCH
9. POWER SAVER 10. POWER SUPPLY CORD
11. TERMINAL STRIP 7 POS. 12. TERMINAL STRIP 4 POS.

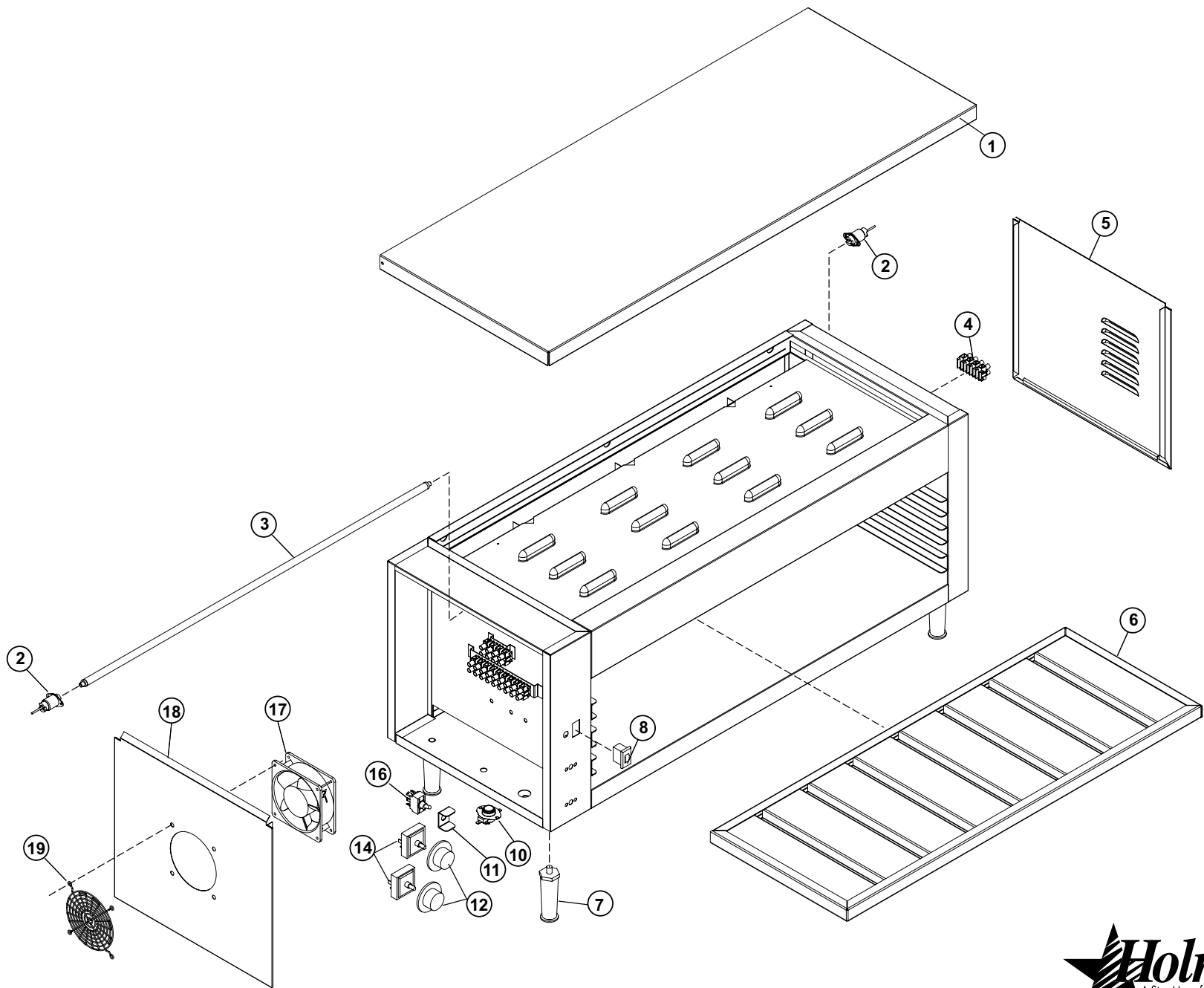

**MODEL: MINIVEYOR**  
 F24 & F36 (manufactured before 2/2000)



This drawing contains information confidential to Star Manufacturing International, Inc. No reproduction or disclosure of its contents is permitted.

SOME ITEMS ARE INCLUDED FOR ILLUSTRATIVE PURPOSES ONLY AND IN CERTAIN INSTANCES MAY NOT BE AVAILABLE

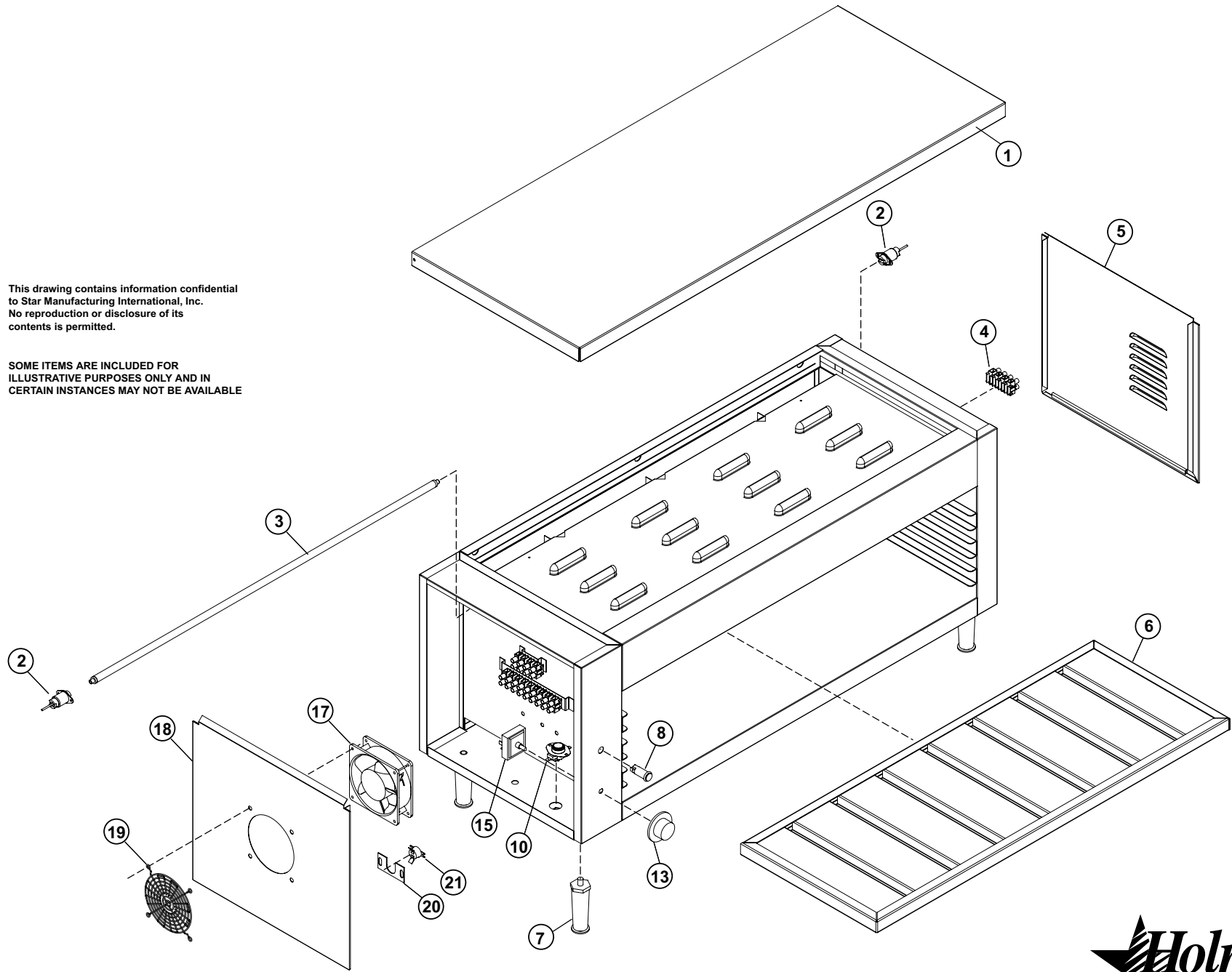

**MODEL: F24PS & F36PS**  
(manufactured after 2/2000)



## F24 - F36 Series Holman Finishing Ovens

| Fig No. | Part Number | Quantity Per | Description            |                               | Fig No. | Part Number | Quantity Per | Description           |                   |
|---------|-------------|--------------|------------------------|-------------------------------|---------|-------------|--------------|-----------------------|-------------------|
| 1       | FB-100801   | 1            | TOP COVER              | 36"                           | NI      | 2P-115501   | 3            | JUMPERS, 2 POS. SMALL |                   |
|         | FA-100800   | 1            | TOP COVER              | 24"                           | NI      | 2P-115502   | 1            | JUMPERS, 3 POS. SMALL |                   |
| 2       | 2E-200409   | 8            | SOCKET, HEATER TUBE    |                               | NI      | 2K-200465   | 1            | BUSHING, CORD HEYCO   |                   |
| 3       | FB-187708   | 4            | HEATERTUBE QUARTZ      | F36 208V                      | NI      | FA-140033   | 1            | CORD SET              | 24"PS, 36"PS      |
|         | FB-187708   | 6            | HEATERTUBE QUARTZ      | F36PSE 208V                   | NI      | HX-140031   | 1            | CORD SET              | F24F6             |
|         | FB-187701   | 4            | HEATERTUBE QUARTZ      | F36 220V                      | NI      | FA-140042   | 1            | CORD SET              | F24W (wall mount) |
|         | FB-187701   | 6            | HEATERTUBE QUARTZ      | F36PSE 220V                   | NI      | 2E-200387   | 1            | CORD SET, FAN MOTOR   |                   |
|         | FB-187709   | 4            | HEATERTUBE QUARTZ      | F36 240V                      |         |             |              |                       |                   |
|         | FB-187709   | 6            | HEATERTUBE QUARTZ      | F36CHPS 240V                  |         |             |              |                       |                   |
|         | FA-187707   | 4            | HEATERTUBE QUARTZ      | F24 240V                      |         |             |              |                       |                   |
|         | FA-187704   | 4            | HEATERTUBE QUARTZ      | F24 208V                      |         |             |              |                       |                   |
|         | FA-187704   | 6            | HEATERTUBE QUARTZ      | F24PSE, F24TE 208V            |         |             |              |                       |                   |
|         | ZZ-187705   | 4            | HEATERTUBE QUARTZ      | F24 220V                      |         |             |              |                       |                   |
| 4       | HA-115386   | 1            | BLOCK TERMINAL, 9 POS. |                               |         |             |              |                       |                   |
|         | HB-115387   | 1            | BLOCK TERMINAL, 8 POS  | 24"PS                         |         |             |              |                       |                   |
|         | HC-115381   | 2            | BLOCK TERMINAL, 4 POS. |                               |         |             |              |                       |                   |
|         | HM-115384   | 1            | BLOCK TERMINAL, 5 POS  | 24"PS                         |         |             |              |                       |                   |
| 5       | FA-400660   | 1            | SIDE PANEL, RIGHT SIDE |                               |         |             |              |                       |                   |
| 6       | F5-53601    | 1            | RACK                   | 36"                           |         |             |              |                       |                   |
|         | FB-100714   | 1            | RACK, CHILLIES SPECIAL | F36CHPS, F36PSE               |         |             |              |                       |                   |
|         | F5-52401    | 1            | RACK                   | 24"                           |         |             |              |                       |                   |
| 7       | 2R-200715   | 4            | LEG, 4" DIE CAST       |                               |         |             |              |                       |                   |
| 8       | 2J-200427   | 1            | PILOT LIGHT, DUALIT    | Power Saver Units             |         |             |              |                       |                   |
| 9       | 2J-200410   | 1            | PILOT LIGHT            | F24, F36 (Before 2/2000)      |         |             |              |                       |                   |
| 10      | 2E-200566   | 1            | SWITCH, RESET          |                               |         |             |              |                       |                   |
| 11      | HA-401780   | 1            | GUARD, TOGGLE          | F24, F36 (Before 2/2000)      |         |             |              |                       |                   |
| 12      | 2R-200702   | 2            | KNOB                   | F24, F36 (Before 2/2000)      |         |             |              |                       |                   |
| 13      | 2R-200703   | 1            | KNOB                   | 24"PS, 36"PS                  |         |             |              |                       |                   |
| 14      | 2J-200538   | 2            | SWITCH, INFINITE       |                               |         |             |              |                       |                   |
| 15      | 2E-200551   | 1            | SWITCH, POWERSAVER     | 524SB, 536SB,<br>F24PS, F36PS |         |             |              |                       |                   |
| 16      | 2E-200543   | 1            | SWITCH, ON/OFF         | F24, F36 (Before 2/2000)      |         |             |              |                       |                   |
| 17      | 2U-200560   | 1            | MOTOR, FAN             |                               |         |             |              |                       |                   |
| 18      | FA-402599   | 1            | SIDE PANEL, LEFT SIDE  |                               |         |             |              |                       |                   |
| 19      | 2R-200562   | 1            | GUARD, FAN             |                               |         |             |              |                       |                   |
| 20      | HG-402144   | 1            | FAN SWITCH BRACKET     | 24"PS, 36"PS                  |         |             |              |                       |                   |
| 21      | 2E-200574   | 1            | SWITCH FAN CERAMIC     | 24"PS, 36"PS                  |         |             |              |                       |                   |

NI = NOT ILLUSTRATED,  
AR = AS REQUIRED

OPERATORS MANUAL  
HOLMAN CHEESE MELTERS  
MODELS F24, F36, F40 & F24W, F36W, F40W

**WIRING DIAGRAM**

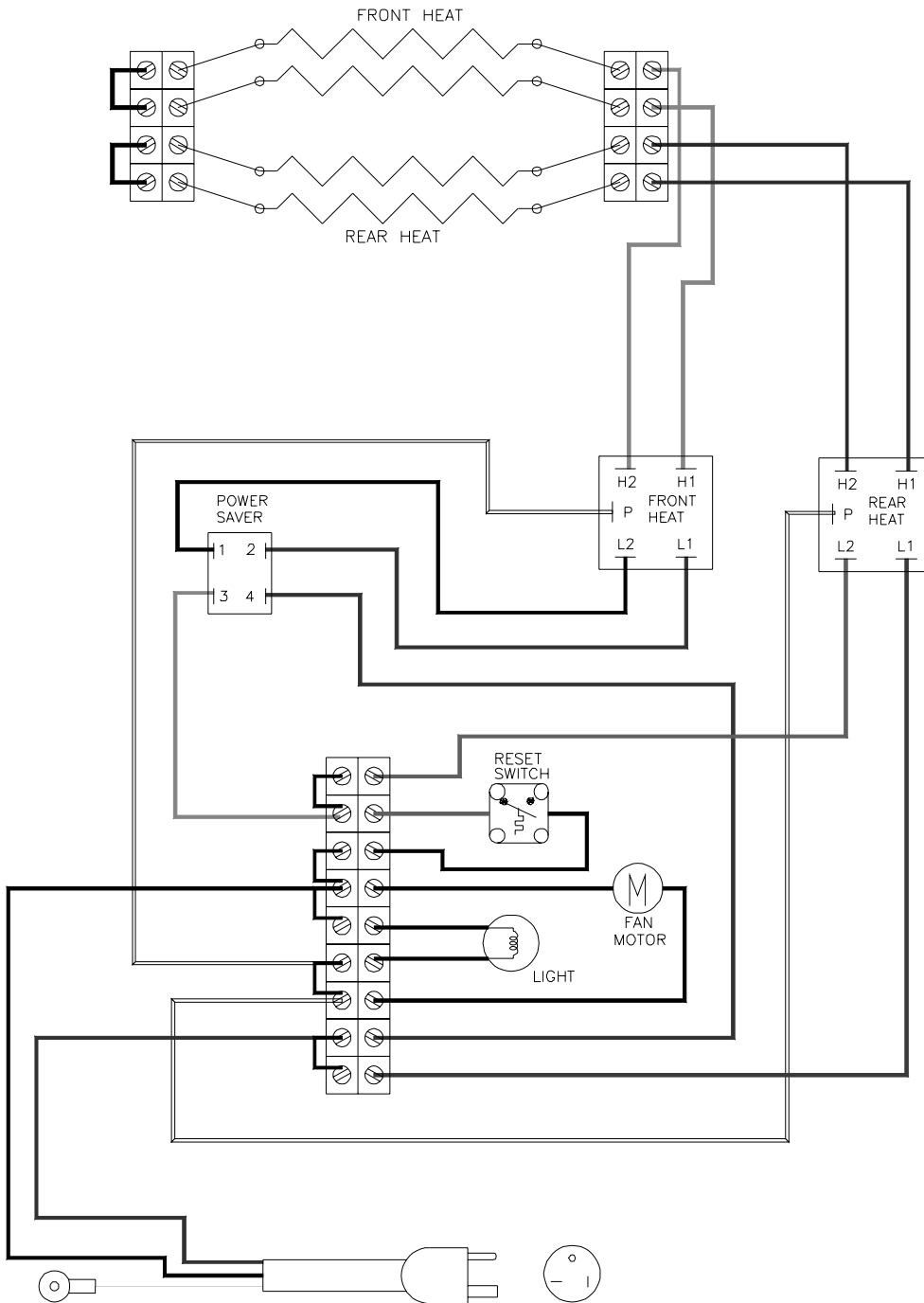

**STAR MANUFACTURING**

10 Sunnen Drive, St. Louis, MO 63143 U.S.A.

(800) 807-9054 (314) 781-2777

Parts & Service (800) 807-9054

[www.star-mfg.com](http://www.star-mfg.com)