

MODEL: QCS/RCS CONVEYOR TOASTER

THIS DRAWING CONTAINS INFORMATION CONFIDENTIAL TO STAR MFG. INT'L. INC.
 NO REPRODUCTION OR DISCLOSURE OF ITS CONTENTS IS PERMITTED.

PARTS LIST

February 6, 2012, Rev. J

QCS-2-600H, QCS-2-800, RCS-2-600 Conveyor Toasters

Key Number	Part Number	Number Per Unit	Description
1	HC-101370	1	ENCLOSURE, QCS/RCS-2
2	HF-402449	1	PANEL, BACK, QCS/RCS-2
5	2U-200560	1	MOTOR, FAN
6	2U-200509	1	MOTOR, DRIVE, FAN BLADE NOT INCLUDED
	2U-200590	1	MOTOR,DRIVE,3286 BB,LOW, FAN BLADE NOT INCLUDED 50Hz CE
	2R-Z8879	1	FAN BLADE, MOTOR
7	2A-202900	1	SHAFT, DRIVE
8	HA-112261	2	BUSHING, REAR
9	2P-Z8779	1	SPROCKET, DRIVEN (25B11 X 5/16")
10	2P-200645	1	SPROCKET, DRIVE (25B17 X 5/16")
11	2P-150013	1	CHAIN, DRIVE (19")
12	2P-115501	3	JUMPER, TERMINAL BLOCK, SMALL, 2 POS.
13	2P-115502	1	JUMPER, TERMINAL BLOCK, SMALL, 3 POS.
14	HC-115381	2	BLOCK, TERMINAL, SMALL, 4 POS.
15	H9-Z10282	1	BLOCK, TERMINAL, SMALL, 10 POS.
16	2R-200562	1	GUARD, FAN MOTOR
17	2R-200709	4	LEG, 1" CHROME PLASTIC
18	2P-200736	2	SPRING, BUSHING, FRONT
19	2P-200700	2	BUSHING, FRONT
20	2A-202904	1	SHAFT, IDLER
21	SP-160027	1	BELT, CONVEYOR (10" X 35 - 1/2")
	2B-200601	AR	INDIVIDUAL BELT LINK
23	HA-100560	1	TRAY, PULL-OUT
24	HC-402457	1	CRUMB TRAY
25	2R-200787	1	CRUMB TRAY GUARD
26	2B-200763	1	LOAD-UP WIRE RACK
28	2A-200284	1	E-CLIP
29	HC-100570	1	BAFFLE, AIR FLOW HI QCS/RCS-600
	HD-100571	1	BAFFLE, AIR FLOW LOW QCS/RCS-800
30	2E-200551	1	SWITCH, ROTARY POWER SAVER
31	2J-200538	2	SWITCH, INFINITE
32	2P-402728	1	ANTI-SPIN PLATE
33	SP-118042	1	SWITCH, SPEED CONTROL, 500 OHM
34	2E-200566	1	SWITCH, HIGH LIMIT RESET
35	2R-200708	4	CAP, KNOB
36	2R-200768	3	KNOB, SPEED CONTROL, INFINITE SWITCH
	2R-200768	1	KNOB, POWER SAVER (manufactured before 11/2001)
	2R-200769	1	KNOB, POWER SAVER (manufactured after 11/2001)
37	2M-200864	1	LABEL, CONTROL PANEL QCS
	2M-200899	1	LABEL, CONTROL PANEL RCS
38	HC-402706	1	RETAINER, ELEMENT, 4 TUBE
	HC-402499	1	RETAINER, ELEMENT, 6 TUBE
	HG-402784	1	RETAINER, ELEMENT RCS
39	HE-197829	6	HEATER TUBE, QUARTS 208V (9.7 Ω, 466W, 6.74A) (UNIT = 14 A)
	HE-198050	6	HEATER TUBE, QUARTS 220V (11.2 Ω, 450W, 6.18A) (UNIT = 13.2 A)
	HF-198051	6	HEATER TUBE, QUARTS 240V (12.6 Ω, 480W, 5.99A) (UNIT = 12.2 A)
	HO-197841	4	HEATER TUBE, QUARTS 208V (15.5 Ω, 703W) (UNIT = 13.52 A)
	HO-197844	4	HEATER TUBE, QUARTS 220V (15.84 Ω, 720W) (UNIT = 13.9A)
	HO-197842	4	HEATER TUBE, QUARTS 240V (19.2 Ω, 707W) (UNIT = 11.78 A)
40	SEE TABLE		ELEMENT, METAL RCS
41	SEE TABLE		ELEMENT, SERPENTINE RCS
42	HF-101115	1	CRUMB TRAY ASSEMBLY, QCS/RCS - 2
43	2A-Z9394	2	SPRING BEARING HOUSING
NI	2B-200600	1	LINK, CONVEYOR BELT
NI	HE-140025	1	CORD, POWER (NEMA 6-20)
NI	2E-Z7242	1	POWER CORD - UK 240V, 50Hz CE
NI	2E-200387	1	CORD, FAN MOTOR
NI	2R-200721	1	BLADE, FAN 2-5/16" (drive motor)
NI	2K-200465	1	BUSHING, CORD HEYCO
NI	2K-200463	1	BUSHING CORD HEYCO 1247
NI	2K-Y2967	1	BUSHING HEYCO 1240 BLK 240V 50Hz CE
NI	1L-Z12397	1	EXTREME PRESSURE MULTIPURPOSE SYNTHETIC GREASE (80°F TO 400°F) 1 oz. TUBE

**IMPORTANT: WHEN ORDERING, SPECIFY VOLTAGE OR TYPE GAS DESIRED
INCLUDE MODEL AND SERIAL NUMBER**

PAGE 1
OF 1

Some items are included for illustrative purposes only and in certain instances may not be available.



PARTS LIST

RCS Conveyor Toasters HEATER TUBES

Key Number	Description	Part Number	Number Per Unit
40	R2-50, 120V	2N-209100	4
	RCS-2-600H, 240V	2N-209106	4
	RCS-2-600H, 208V	2N-209197	4
	RCS-2-600HJ, 208V	2N-209199	4
	RCS-2-600HJ, 240V	2N-209216	4
	RCS-2-800, 240V	2N-209106	4
	RCS-2-800, 208V	2N-209197	4
	RCS-2-1200B, 208V	2N-209198	2
	RCS-3-950H, 208V	2N-209130	4
	RCS-3-950H, 240V	2N-209160	4
	RCS-3-1000, 208V	2N-209130	4
	RCS-3-1000, 240V	N/A	N/A
	RCS-3-1300, 208V	2N-209150	4
	RCS-3-1300, 208V	2N-209131	6
	RCS-3-1300, 240V	2N-209180	4
	RCS-3-1300, 240V	N/A	N/A
	41	9H-R2-12BSH-V02	2N-209108
9H-R2-12BA-V04		2N-209112	2
9H-R2-12BASH-V04		2N-209112	2
9H-R2-12BA-V02		2N-209114	2
9H-R2-12BASH-V02		2N-209114	2

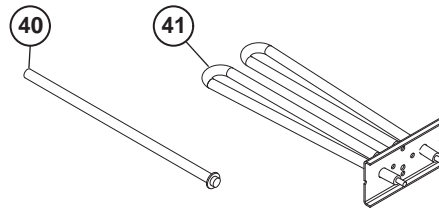

RCS HEATER TUBES