

**T&S BRASS AND BRONZE WORKS, INC.**

2 Saddleback Cove / P.O. Box 1088  
Travelers Rest, SC 29690

Model No.

**BL-5709-08**

Item No.

Travelers Rest, SC: 800-476-4103 • Simi Valley, CA: 800-423-0150 • Fax: 864-834-3518 • www.tsbrass.com

This Space for Architect/Engineer Approval

Job Name \_\_\_\_\_ Date \_\_\_\_\_

Model Specified \_\_\_\_\_ Quantity \_\_\_\_\_

Customer/Wholesaler \_\_\_\_\_

Contractor \_\_\_\_\_

Architect/Engineer \_\_\_\_\_



**ADA Compliant**

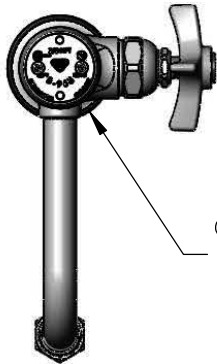

Ø 2 3/16"  
[56mm]

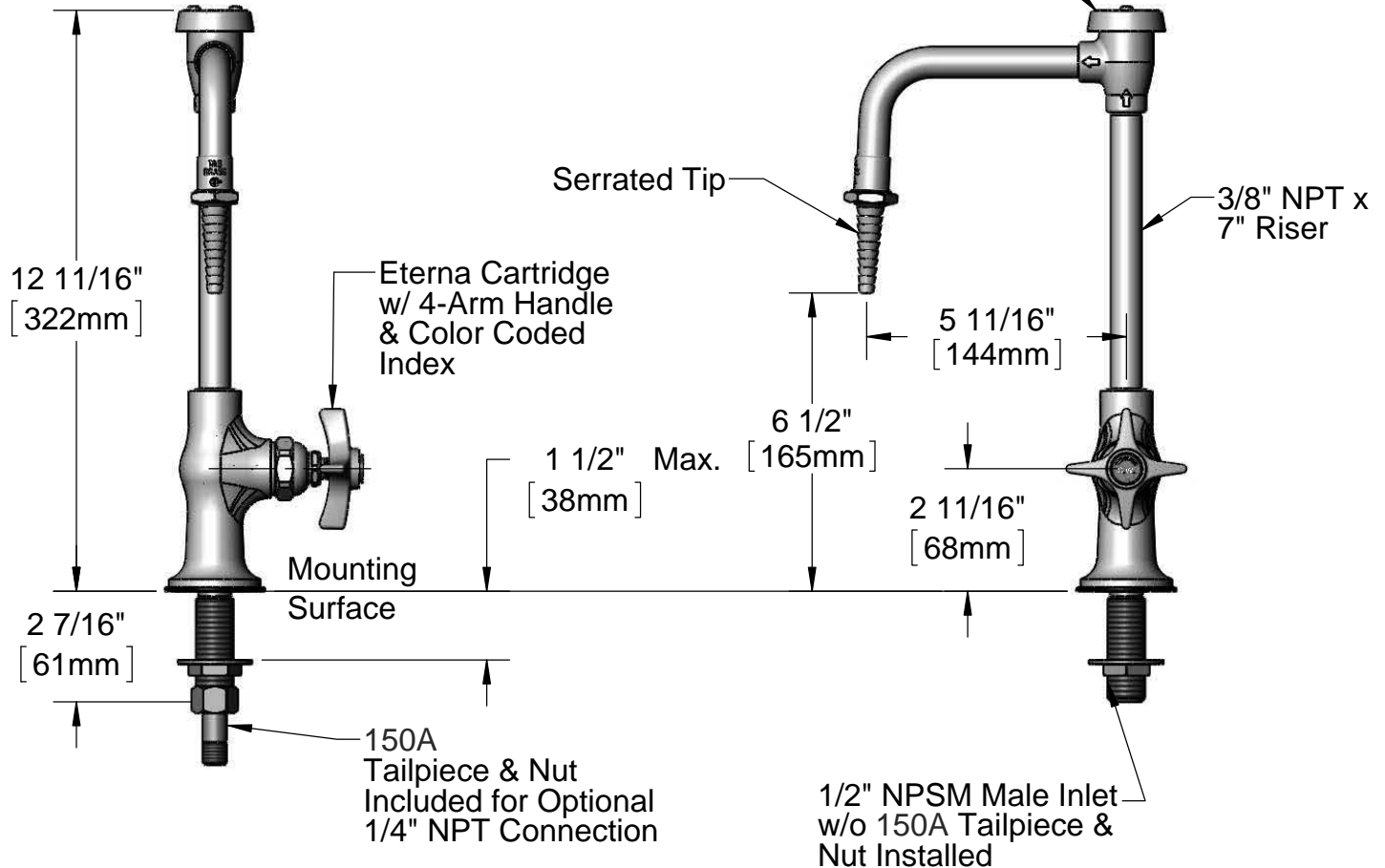

Rough-In Requirement:  
Ø 1" [25mm] Hole

Product Specifications:  
Single Temperature Lab Faucet w/ Rigid Vacuum Breaker Nozzle,  
Serrated Tip & 1/2" NPSM Male Inlet

Drawn <b>DMH</b>	Checked <b>KJG</b>	Approved <b>JHB</b>
Scale: <b>1:4</b>		Date: <b>06/28/12</b>



**T&S BRASS AND BRONZE WORKS, INC.**

2 Saddleback Cove / P.O. Box 1088

Travelers Rest, SC 29690

Model No.

**BL-5709-08**

Item No.

Travelers Rest, SC: 800-476-4103 • Simi Valley, CA: 800-423-0150 • Fax: 864-834-3518 • www.tsbrass.com

ITEM NO.	SALES NO.	DESCRIPTION
1	B-0198	Serrated Tip w/ Washer
2	001051-45	Washer
3	B-0968	Vacuum Breaker Asm, 3/8"
4	000363-40	7" Nipple, 3/8" NPT
5	005960-40	Eterna Cartridge - RTC
6	000059-40	4-Arm Lab Handle
7	000925-45	Lab Handle Screw
8	001191-45	Green CW Snap-In Index
9	144L	Gasket Polypropylene
10	000999-45	Brass Washer
11	002954-45	Shank Lock Nut
12	150A	Bag of (1) Tailpiece & (1) Nut

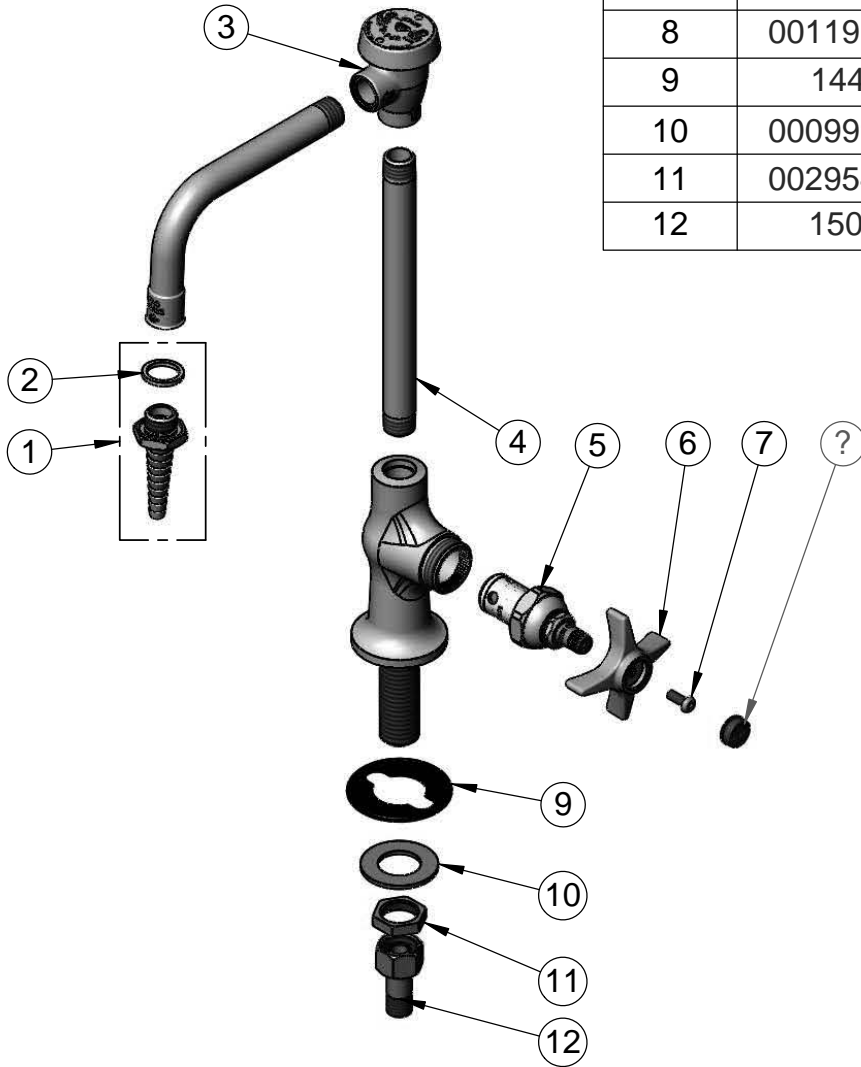

Product Specifications:  
 Single Temperature Lab Faucet w/ Rigid Vacuum Breaker Nozzle,  
 Serrated Tip & 1/2" NPSM Male Inlet

Drawn <b>DMH</b>	Checked <b>KJG</b>	Approved <b>JHB</b>
Scale: <b>NTS</b>		Date: <b>06/28/12</b>